

TABLE OF CONTENTS

PRESSURE GAUGES	2
ELECTRICAL DEVICES	3
FIRE HOSES VALVES & ACCESSORIES.....	5
FIRE DEPARTMENT CONNECTIONS	8
BRASS ADAPTERS	13
BRASS BUTTERFLY VALVE	14
BRASS VALVES.....	15
VALVES	19
COMMERCIAL & RESIDENTIAL RISERS.....	25
RISER ACCESSORIES	28
ESCUTCHEONS.....	29
PIPE HANGERS & FASTENERS	31
FIRE SPRINKLERS & ACCESSORIES	34
SPRINKLER IDENTIFICATION SIGNS.....	36
TOOLS	37
PIPE SEALANTS & LUBRICANTS	39
PIPE NIPPLES	40
GROOVED COUPLINGS & FITTINGS.....	43
DUCTILE IRON THREADED FITTINGS	45

STAINLESS STEEL GAUGES



Brecco gauges are for use with wet or dry systems. Bronze burdon tube movement in a stainless steel case. 4" Diameter. Custom gauges available. Year of gauge manufacture displayed on face of gauge. UL Listed and FM Approved.

DESCRIPTION	ITEM#
Air / Water 300 psi UL/FM	100-325-00040
Air w/ Retard 250 psi UL/FM	100-325-00120
2" Residential Gauge 300 psi w/ Black Steel Case	100-325-00180
Dry Compound Gauge (-30 To 300)	100-325-00900

PLASTIC GAUGES



Brecco Plastic case for corrosion resistance. UL/ ULC Listed and FM Approved. 4" Diameter face. Year of gauge manufacture displayed on face of gauge. UL Listed and FM Approved.

DESCRIPTION	ITEM#
Air w/ Retard - 0-250 psi	100-325-00145
Air Only - 0-300 psi	100-325-00920
Water Only - 0-300 psi	100-325-00160
Water - 0-600 psi	100-325-00150
Air/Water - 0-300 psi	100-325-00140

LIQUID FILLED GAUGES



Brecco Glycerin filled w/ Glass Face & Stainless Steel case. UL Listed and FM Approved.

DESCRIPTION	ITEM#
Gauge (0 To 300)	100-325-00880
Compound Gauge (-30 To 300)	100-325-00860

GAUGE KITS



Brecco Stainless Steel Gauges (UL Listed and FM Approved), Prepackaged with necessary components. UL Listed and FM Approved.

DESCRIPTION	ITEM#
Air/water 300 psi	100-325-00080
1/4" x 4" Nipple, 1/4" 3-way Valve, 1/4" Plug, 1/2" x 1/4" Hex Head Bushing	
Air Only 250 psi	100-325-00760
1/4" x 4" Nipple, 1/4" 3-way Valve, 1/4" Plug, 1/2" x 1/4" Hex Head Bushing	

WATER FLOW DETECTOR



The Lansdale Valve & Manufacturing "System Detective" Waterflow switch is designed for use on fire sprinkler systems. The system detective is compatible with steel pipe, schedule 10 through 40 sizes 1" – 8". The detector's plastic directional cover protects it from any contaminants. With a working pressure of 450 psi and an operating temperature of 32° F to 154° F. Operational flow rate of 4-10 GPM. Designed for indoor and outdoor use on wet systems. The "System Detective" can be mounted both horizontally & vertically. The detector's switch will initiate once detecting water flow through the fire and sprinkler system. Comes equipped with two openings for 1/2" conduits and a tamper resistant screw to prevent damage and/or alteration. UL listed and FM Approved.

DESCRIPTION	ITEM #
1" - 1 1/2" Tee Tap	300-100-00020
2" w/Retard	300-100-00030
2 1/2" w/Retard	300-100-00040
3" w/Retard	300-100-00050
4" w/Retard	300-100-00070
5" w/Retard	300-100-00080
6" w/Retard	300-100-00090
8" w/Retard	300-100-00100
1"-2" CPVC Glue in Adapter	300-100-00140
1"-2" CPVC Thread in Adapter	300-100-00160

PRESSURE SWITCHES

Lansdale Valve & Manufacturing pressure switches are used in fire and sprinkler systems ranging from wet, dry, deluge and pre-action systems. The pressure switch indicates a release of excess pressure from a fire sprinkler system. The switch operates at a decreasing pressure of 30 psi and an increasing pressure of 50 psi. Current operating temperature is -40° to 140° F. UL Listed and FM Approved.

DESCRIPTION	ITEM #
Alarm Press SW-1 SPDT 101	300-150-00070
Alarm Press SW-2 SPDT 102	300-150-00080
Supervisory Low Press-1 SPDT 401	300-150-00050
Supervisory High Press-2 SPDT 402	300-150-00060



SUPERVISORY TAMPER SWITCHES

Lansdale Valve and Manufacturing tamper switches monitor the positions of Outside Screw and Yoke (OS&Y) gate valves and Wall/Vertical Indicator Post Valves. The switch is designed to alert any tampering with its paired valves. The switch will set its alarm upon opening the yoke. Current operating temperature is -40° to 140° F. There are two built in synchronized switches enclosed in a terminal block with one hole for a 1/2" conduit. UL Listed and FM Approved.

DESCRIPTION	ITEM #
OS&Y Tamper w/ Bracket	300-125-00020
P.I.V. or Butterfly Valve Tamper	300-125-00040
Plug-in Special Purpose PSP1	300-125-00030



ELECTRIC BELLS

Features four wires, 120V and 24V red enamel heavy steel gong. Indoor and outdoor installation. UL Listed.

DESCRIPTION	ITEM#
6" 120V AC	300-175-00100
8" 120V AC	300-175-00110
10" 120V AC	300-175-00120
6" 24V DC	300-175-00130
8" 24V DC	300-17500140
10" 24V DC	300-175-00150

**BELL BACK BOX**

Brecco Back Boxes are weatherproof. For use in attaching electric bells to walls. Made from aluminum.

DESCRIPTION	ITEM#
Red	300-175-00080

**WIRE BELL GUARDS**

Lansdale Valve and Manufacturing Wire Bell Guards are made with heavy wire construction applicable to water motor gongs. Will fit 6", 8", and 10" bells with 4 quick cuts.

DESCRIPTION	ITEM#
Red	100-350-00380



HOSE RACKS

Hose Racks are Rated for Class II Service under NFPA/FEMA class of service. Racks are available with:

- 1½" x 1½" Hose Rack Assembly
- 1½" Single Jacket Lined Hose - UL, ULC/FM
- 1½" Cast Brass Coupling
- 1½" Fog Nozzle - UL, ULC/FM (Brass or Plastic)
- 1½" Angle Valve F x F
- 1½" Brass Rack Nipple
- Red Enamel Pin Back - UL, ULC/FM

DESCRIPTION	ITEM#
RACK with HOSE	
1½" RACK w 50' Hose	350-100-00020
1½" RACK w 75' Hose	350-100-00040
1½" RACK w 100' Hose	350-100-00060
2½" RACK w 125' Hose	350-100-00580
RACK with HOSE, and RACK NIPPLE	
1½" x 50'	350-100-00080
1½" x 75'	350-100-00100
1½" x 100'	350-100-00120
RACK with HOSE, RACK NIPPLE & BRASS FOG NOZZLE	
1½" x 50'	350-100-00140
1½" x 75'	350-100-00160
1½" x 100'	350-100-00180
RACK with HOSE, RACK NIPPLE, BRASS FOG NOZZLE & 1½" FxF HOSE	
1½" x 50'	350-100-00200
1½" x 75'	350-100-00220
1½" x 100'	350-100-00240
RACK with HOSE, RACK NIPPLE, BRASS NOZZLE & 1½" FxF PRESS. RESTRICTING HOSE VALVE	
1½" x 100'	350-100-00370
RACK with HOSE, RACK NIPPLE & PLASTIC FOG NOZZLE	
1½" x 50'	350-100-00260
1½" x 75'	350-100-00280
1½" x 100'	350-100-00300
RACK with HOSE, RACK NIPPLE, PLASTIC FOG NOZZLE & 1½" FxF HOSE VALVE	
1½" x 50'	350-100-00320
1½" x 75'	350-100-00340
1½" x 100'	350-100-00360



NOZZLES

Lansdale Valve and Manufacturing Lexan Nozzle is rated for Class II Service under NFPA/ FEMA class of service. Recommended For fire hose cabinets and fire hose racks, for lined or unlined fire hose. Both the 1½" NST Lexan adjustable fog nozzle & 1½" NST cast brass adjustable fog nozzle are capable of complete shutoff or any degree of conical FOG. Brass nozzle comes in Satin Brass and has optional chrome plating. Lansdale Valve and Manufacturing Play Pipe is 30" long and made with rugged brass construction. Equipped with NST thread inlet w/swivel handle and 1/8" orifice.

DESCRIPTION	ITEM#
1½" Plastic Fog Nozzle (RED) NST	350-100-00780
1½" Adj Fog Nozzle - Brass NST	350-100-00820
1½" Adj Fog Nozzle - Chrome Plated	350-100-00860
2½" Play Pipe	350-100-00880
1½" Adj Fog Nozzle - Brass NPSH	350-100-00840
1½" Plastic Fog Nozzle (RED) NPSH	350-100-00850



RACK AND REEL FIRE HOSE

Emergency fire hose for interior use. Hose is designed for racks and reels with a 100% Synthetic woven jacket and single ply with thermoplastic lining.

- Available with Brass or Chrome couplings

DESCRIPTION	ITEM#
1½" x 50' Hose w/BR CPLG	350-100-00380
1½" x 75' Hose w/BR CPLG	350-100-00400
1½" x 100' Hose w/BR CPLG	350-100-00420



RACK NIPPLES

Cast brass w/ Male hose thread x Male pipe thread. For use with hose racks.

DESCRIPTION	THREAD	ITEM#
1½"	MNPT x MNST	350-100-00720
2½"	MNPT x MNST	350-100-00740



ACCESSORIES

Swing Rack for 1½" HOSE RACKS UL, ULC and FM Listed.

DESCRIPTION	ITEM#
RED Swing Rack	350-100-00620
C.P. Swing Rack	350-100-00640
Hose Rack - PLASTIC COVER	350-100-00760



HOSE CABINETS

Lansdale Valve and Manufacturing Hose Cabinets are constructed of 16 gauge Cold Rolled Steel and come with valve knockouts. The door is fitted with 3/16" clear glass, stainless steel concealed latch, and reinforced piano hinges.

Finish Options Include: Satin Stainless Steel, White, Red
Options for Glass: ¼" Doulite, Lexan, or Georgian Wire
Options for Mount: Surface, Recessed
Options for Door: Full Metal, Glass, Stainless Steel



DESCRIPTION	ITEM#
30" x 30" x 8" Recessed Glass	350-100-00920
30" x 30" x 8" Recessed Metal	350-100-00930
30" x 30" x 8" Surface Glass	350-100-00900
30" x 30" x 8" Surface Metal	350-100-00910
30" x 30" x 6" Surface Glass	350-100-00890
30" x 30" x 6" Recessed Glass	350-100-00935

ANGLE HOSE VALVES



Lansdale Valve and Manufacturing Angle Hose Valves feature all brass construction with cast bodies for rigidity and light weight. Rated to 300 Lbs. Compatible with a Fire Hose Rack Assembly or as a Fire Department Connection Outlet. UL and FM approved. Comes with optional chrome plate finish.

• Contains lead. Not for use in water systems intended for human consumption

SIZE	THREAD	ITEM#
1½"	NST M x F	350-125-00820
1½"	NPT F x F	350-125-00900
2½"	NPT F x F	350-125-00920
2½"	NST G x M	350-125-01140
2½"	NST M x F	350-125-00840
2½"	PHX M x F	350-125-01060
2½"	TEMPE M x F	350-125-01100
2½"	NYCC	350-125-00860
2½"	NYFD	350-125-01040
2½"	G x NYCC	350-125-00980
1½"	HANDLE	350-125-01180
2½"	HANDLE	350-125-01200

**Other thread types are available, but not listed.

Please call for the specific thread you need.

ANGLE HOSE VALVES - PRESSURE RESTRICTING

Heavy Duty 2½" angle hose valve is 300 lb pressure tested as an approved restricting valve. Constructed with a lightweight cast brass body, Forged line Bonnet, and Seat Assembly. Water pressure is controlled by an adjustable flow restrictor. If full flow is required the restrictor may be overridden. Item comes furnished with field setting chart. UL/ULC Listed and FM Approved. Specify regional hose thread for outlet. FINISH: Cast Brass

• Contains lead. Not for use in water systems intended for human consumption

SIZE	THREAD	ITEM#
1½"	F x F NST	350-125-01130
2½"	M x F NST	350-125-01132
2½"	M x F NYFD	350-125-01134



STRAIGHT HOSE VALVE

Straight Hose Globe Valve is a Heavy Duty 2½" straightway hose valve. Pressure tested at 300 lb, it comes constructed with a lightweight cast brass body and a Forged Bonnett. Includes Seat Assembly and Cast Brass finish. Optional Polished Chromed or Brass finishes available. Regional hose thread for outlet available upon request. Our 2.5" Straight Hose Gate Valve is made up of a brass body, brass trim, a red hand wheel, and a non-rising stem with a female NPT inlet and male hose thread outlet (specify threads when ordering). Made for use on hydrants, standpipes, and fire pumps. Pressure rated for 300 psi. UL Listed / FM Approved. Finishes: Cast Brass, Cast Chrome. Options: Round Handle with Speed Chuck.

• Contains lead. Not for use in water systems intended for human consumption

SIZE	THREAD	ITEM#
2½"	FNPT x MNST Gate	350-125-01970
2½"	FNPT x MNST Globe	350-125-01965



CAP & CHAIN

Lansdale Valve and Manufacturing Cap & Chains are available in solid brass, aluminum, and plastic. Each is constructed with Female Caps w/ pins and come attached with a hook and chain. Plastic can prevent debris buildup but is not pressure testing suitable. For use with hose valves.

SIZE		FINISH	ITEM#
1½"	NST	Brass	350-125-01480
2½"	NST	Aluminum	350-125-01730
2½"	NST	Chrome	350-125-01720
2½"	NST	Brass	350-125-01580
2½"	PHX	Brass	350-125-01640
2½"	TMP	Brass	350-125-01680
1½"	NST - RED	Plastic	350-125-01540
2½"	NST - RED	Plastic	350-125-01760
2½"	NYCC	Brass	350-125-01600
2½"	NYFD	Brass	350-125-01620
HOOK & CHAIN		Brass	350-125-01220



BRASS REDUCERS

Lansdale Valve and Manufacturing Brass Reducers are Cast Brass. Constructed with 2½" Female NST x 1½" Male NST.

DESCRIPTION	ITEM#
2½" FNST x 1½" MNST- RED	350-125-01240
2½" FNST x ¾" MGHT	350-125-01880
2½" FNST x 2" MNPT	350-125-01960
2½" FNST x 1½" MNPSH- RED	350-125-01940
2½" NYCC x 1½" NST	350-125-01900
2½" NYFD x 1½" MNST	350-125-01905



90° 4" x 2½" x 2½" - SINGLE CLAPPER



Lansdale Valve and Manufacturing FDCs are UL Listed and FM Approved in accordance with NFPA. Each FDC is of solid brass construction and single clapper design. **

THREAD		ITEM#
NST		350-175-02420
NST	Chrome	350-175-02440
PHX/PIT		350-175-02460
TEMPE		350-175-02480
NYCC		350-175-02500
NYFD		350-175-02520
GRV	NST	350-175-02400

STRAIGHT 4" x 2½" x 2½" - SINGLE CLAPPER



Lansdale Valve and Manufacturing FDCs are UL Listed and FM Approved in accordance with NFPA. Each FDC is made of solid brass construction and single clapper design. **

THREAD	FINISH	ITEM#
NST	Brass	350-175-02540
NST	Chrome	350-175-02560
NPT	Pol. Brass	350-175-02565
PHX/PIT		350-175-02620
TEMPE		350-175-02640
NYCC		350-175-02580
NYFD		350-175-02600
GRV	NST	350-175-02700

STRAIGHT EXPOSED SIAMESE - DOUBLE CLAPPER



FDCs are UL Listed and FM Approved in accordance with NFPA. Each FDC is made of solid brass construction and double clapper design. **

STYLE	THREAD	ITEM#
4" NPT x 2½" x 2½"	NST	350-175-02650
4" NPT x 3" x 3"	NYFD	350-175-02720
6" NPT x 2½" x 2½"	NYFD	350-175-02785
6" NPT x 3" x 3"	NYFD	350-175-04385
6" NPT x 2½" x 2½"	NST	350-175-04399

90° EXPOSED SIAMESE - DOUBLE CLAPPER



Lansdale Valve and Manufacturing FDCs are UL Listed and FM Approved in accordance with NFPA. Each FDC is made of solid brass construction and double clapper design. 4" x 2½" x 2½" **

STYLE	THREAD	ITEM#
4" NPT x 2½" x 2½"	NST	350-175-02651
4" NPT x 3" x 3"	NYFD	350-175-02660
6" NPT x 2½" x 2½"	NST	350-175-04398
6" NPT x 3" x 3"	NYFD	350-175-04380
6" NPT x 2½" x 2½"	NYFD	350-175-02784

STRAIGHT CONCEALED SIAMESE - DOUBLE CLAPPER/ BODY ONLY



Used as a flush mount double clapper Fire Department Connection. The double clapper design ensures water supply from supplementary sources, connected to either one or two servicing hoses. The Auxiliary Inlet Connection allows in excess of 500 G.P.M. supplementary water supply for fire protection system. UL Listed FM Approved. **

STYLE	THREAD	ITEM#
4" GRV x 2½" x 2½"	NST	350-175-03380
4" Grooved x 3" x 3"	NPT	350-175-02705
4" NPT x 3" x 3"	NYFD	350-175-02680
6" GRV x 3" x 3"	NPT	350-175-02745
6" NPT x 3" x 3"	NYFD	350-175-04390

90° CONCEALED SIAMESE - DOUBLE CLAPPER/ANGLE BODY ONLY



Applicable as a flush mount double clapper Fire Department Connection. Double clapper design ensures water supply from supplementary source(s). The Auxiliary Inlet Connection allows in excess of 500 G.P.M. supplementary water supply for fire protection system. Angle body and field adjustable clappers allow for a top or bottom inlet. UL Listed FM Approved. **

DESCRIPTION	THREAD	ITEM#
4" GRV x 2 1/2" x 2 1/2"	NPT	350-175-02755
4" GRV x 3" x 3"	NST	350-175-03400
4" NPT x 3" x 3"	NYFD	350-175-02760
6" GRV x 3" x 3"	NPT	350-175-04394
6" NPT x 3" x 3"	NYFD	350-175-04395

STRAIGHT CONCEALED GROOVED BODY - Complete Pack W/PLATE, SNOOTS & P & C



Lansdale Valve and Manufacturing's FDC Straight Concealed Grooved Body is a flush mounted straight body, back outlet, double Clapper, Fire Department Connection. The body is cast brass with 4" grooved inlet and two 2 1/2" NPT outlets. Package includes: A Plate and 2 plug & chains. 2 Snoot and Swivels. *1/2" or 3/4" ball drip available. With polished brass or chrome finishes. UL Listed FM Approved. **

SIZE	FINISH	ITEM#
4 x 2 1/2" x 2 1/2"	Brass	350-175-03420
4 x 2 1/2" x 2 1/2"	Chrome Plated	350-175-03440

90° CONCEALED GROOVED BODY - Complete Pack W/PLATE, SNOOTS & P & C



UL Listed FM Approved. Constructed as Fire Department Connection package with a flush mounted angle body. Clappers are field adjustable to provide either a top or bottom inlet. Body Design: Cast brass with 4" grooved inlet and two 2 1/2" NPT outlets. Package includes: A Plate and 2 plug & chains. 2 Snoot and Swivels. *1/2" or 3/4" ball drip available. Polished brass or chrome finishes available. **

SIZE	FINISH	ITEM#
4 x 2 1/2" x 2 1/2"	Brass	350-175-03460
4 x 2 1/2" x 2 1/2"	Chrome Plated	350-175-03480

ROOF MANIFOLDS



Roof Manifolds are cast brass body, combined with gate or angle hose valves for flow control. NPT Threads. Optional Finish includes: Chrome, Polished Brass, or Polished Chrome Optional addition: 2 1/2" angle valves and 2 1/2" brass caps and chains. UL Listed. **

SIZE	FINISH	ITEM#
4" x 2 1/2" x 2 1/2"	90°	350-175-03500
4" x 2 1/2" x 2 1/2"	Straight	350-175-03520
6" x 3" x 3" x 3"	90°	350-175-04510
6" x 3" x 3" x 3"	Straight	350-175-04500
6" x 3" x 3" x 3" x3"	90°	350-175-04515
6" x 3" x 3" x 3" x3"	Straight	350-175-04505
6" x 3" x 3" x 3" x3"	Square	350-175-04520

PLUG & CHAINS



Used with hose valves or Fire Department Connections.**

SIZE/THREAD	FINISH	ITEM#
1½" NST	Brass	350-125-01260
2½" NST	Aluminum	350-125-01410
2½" NST	Chrome	350-125-01380
2½" NST	Brass	350-125-01280
2½" PHX	Brass	350-125-01300
2½" TEM	Brass	350-125-01320
2½" NYCC	Brass	350-125-01340
2½" NYFD	Brass	350-125-01360

BREAK CAPS



Lansdale Valve and Manufacturing Break Caps come in aluminum or plastic. Break Caps are packaged two per set and are equipped with eye bolts and nuts. Designed to break in an emergency.

SIZE	MATERIAL	COLOR	ITEM#
2½" (2pcs)	Metal	RED	350-125-01800
2½" (2pcs)	Plastic	RED	350-125-01780
3" (2pcs)	Alum	GREEN	350-125-01840

IDENTIFICATION SIGNS



Fire Department Connection Signs come in aluminum, brass, chrome, or plastic.

DESCRIPTION	FINISH	ITEM#
2½" IPS Round W.P. Auto SPKR	Brass	350-150-02100
4" IPS Round W.P. Auto SPKR	Brass	350-150-02180
4" IPS Round W.P. Auto SPKR	Chrome	350-150-02200
4" IPS Round W.P. Combo STD Pipe	Brass	350-150-02220
4" IPS Round W.P. Dry STD Pipe	Brass	350-150-02240
4" IPS Round W.P. Wet STD Pipe	Brass	350-150-02260
4" IPS Round W.P. Auto SPKR	Alum	350-150-02140
4" IPS Round W.P. Auto SPKR	Plastic	350-150-02160
8" X 4" Rectangle F.D.C.	Alum	350-150-02300
4" IPS Wall Hydrant	Brass	350-150-02270
6" IPS Round W.P. Auto SPKR	Brass	350-150-02274

FDC FLUSH MOUNT WALL PLATE - 2 HOLE



Lansdale Valve and Manufacturing FDC Wall Plate includes standard plate lettering for flush mount Siamese: A Polished Brass finish with an optional polished Chrome or Stainless Steel finish. Plate lettering includes: Stand Pipe, Stand Pipe/Auto Sprinkler, Pump Test, Auto Sprinkler, Wall Hydrant.

DESCRIPTION	FINISH	ITEM#
2½" 15" x 9" AUTO SPKR	BRASS	350-175-03540
2½" 15" x 9" AUTO SPKR	C.P.	350-175-03560
2½" 15" x 9" STANDPIPE	BRASS	350-175-03600
2½" 15" x 9" STANDPIPE	C.P.	350-175-03580
2½" 15" x 9" AUTO SPKR/S.P.	BRASS	350-175-03620
2½" 15" x 9" AUTO SPKR/S.P.	C.P.	350-175-03640
3" 15" x 9" FLUSH MT WP-AUTO SPKR	BRASS	350-150-02280
3" 15" X 9" FLUSH MT WP-STAND PIPE	BRASS	350-150-02281
3" 15" X 9" FLUSH MT WP-STAND PIPE AUTO SPKR COMBO	BRASS	350-150-02282

SLEEVES for REMOTE FDC



Lansdale Valve and Manufacturing Remote FDC Sleeve is used to conceal incoming pipe of free-standing fire department connection. Comes in a polished brass finish with optional polished chrome plated finish.

DESCRIPTION	FINISH	ITEM#
4" x 18"	Aluminum	350-175-03880
6" x 18"	Aluminum	350-175-03890

1½" SINGLE SNOOT - w/WALL PLATE, PLUG & CHAIN



Lansdale Valve and Manufacturing's 1½" Single Snoot is all brass. Ideal for residential applications where needed. Comes as a complete unit with brass wall plate, plug and chain. UL Listed/ FM Approved. **

THREAD	FINISH	ITEM#
NST X NPT	Brass	350-175-02320
NST X NPT	Chrome	350-175-02860

2½" SINGLE SNOOT



Lansdale Valve and Manufacturing FDC Single Snoot is all brass. Available with 7" O.D., brass wall plate, and plug and chain or solely with Body & Swivel. UL Listed/ FM Approved. **

BODY & SWIVEL ONLY

THREAD	ITEM#
NST	350-175-02960
PHX / PIT	350-175-03000
TEMPE	350-175-03020
NYCC	350-175-02980

w/WALL PLATE, PLUG & CHAIN

NST	350-175-02340
PHX/ PIT	350-175-02920
TEMPE	350-175-02940
NYCC	350-175-02900

STORZ CONNECTIONS - COMPLETE W/ CAP & SCREEN



STORZ connections provide "quick connection" of large diameter hose by Fire Service Professionals to fire sprinkler or standpipe systems. Each can be assembled or disassembled quickly with simple engagement of the lugs and approximately one quarter turn. Hose ends on Fire Service hoses have an integrated "lever type lock" to keep connection from disconnecting while under pressure. In accordance with NFPA requirements. Available with UL Listing.

DESCRIPTION	ITEM#
4" STORZ X 4" NPT w/Cap & Screen Straight	350-175-03900
5" STORZ X 4" NPT w/Cap & Screen Straight	350-175-03920
5" STORZ X 5" NPT w/Cap & Screen Straight	350-175-03930
5" STORZ X 6" NPT w/Cap & Screen Straight	350-175-04235
4" STORZ X 4" NPT w/Cap & Screen 30°Elbow	350-175-03940
5" STORZ X 4" NPT w/Cap & Screen 30°Elbow	350-175-04120
5" STORZ X 6" NPT w/Cap & Screen 30°Elbow	350-175-04140

CHECK SNOOT - w/ PIN LUG SWIVEL



Lansdale Valve and Manufacturing Check Snoots are brass made and help prevent water backflow into connected supply lines. An NST plug should be used to prevent debris from waterway entrance. Available in all rough and polished brass. UL Listed/ FM Listed and Approved.

SIZE/DESCRIPTION	ITEM#
3" MNPT x 2½" FNST Swivel	350-175-03040
3" FNPT x 2½" FNST Swivel	350-175-03060

PRE-ASSEMBLED FIRE DEPARTMENT CONNECTIONS



PRE-ASSEMBLED ALSO AVAILABLE WITH STORZ

Our pre-built FDC includes:

- 72" Galvanized Sched 40 pipe
- UL/FM Wafer Check Valve
- Ductile Iron MJ x Flange 90° Elbow
- 90 degree Single Clapper Siamese, complete with plugs and Identification plate

SIZE

ITEM#

4"

350-175-06000

6"

350-175-06020

SWIVEL KIT



Lansdale Valve and Manufacturing Swivel Kit comes with brass swivel, gasket, and ball bearings with brass set screw. **

SIZE

THREAD

ITEM#

2 1/2"

NST

350-175-03140

2 1/2"

PHX

350-175-03180

2 1/2"

TEMPE

350-175-03220

2 1/2"

NYCC

350-175-03260

SWIVEL GASKETS



Black rubber swivel gasket. For use with 1 1/2" and 2 1/2" swivels.

SIZE

ITEM#

1 1/2"

350-175-03280

2 1/2"

350-175-03320

BALL BEARING PACKS



Lansdale Valve and Manufacturing Ball Bearing Packs are applicable to 1 1/2" and 2 1/2" swivels. Comes in plastic bag with 50 ball bearings and brass set screw.

DESCRIPTION

ITEM#

**BALL BEARINGS
w/SET SCREW**

350-175-03340

MxM BRASS HEX



Lansdale Valve and Manufacturing's M x M Brass Hex Adapter is equipped as hexagon hose nipple, with Male NPT x Male regional hose thread. Cast Brass finish with an optional chrome finish.**

SIZE	THREAD	ITEM#
1 1/2"	MNPT x MNST	350-125-00320
2 1/2"	MNPT x MNST	350-125-00020
2 1/2"	MNST x MNST	350-125-00080
2 1/2"	MNST x 2" MNPT	350-125-00300
2 1/2"	MNPT x MNYCC	350-100-00060
2 1/2"	MNPT x MNYFD	350-125-00280

FxF BRASS HEX



Lansdale Valve and Manufacturing's F x F Brass Hex Adapter is equipped as a hexagon hose connector, with Female NPT x Female NST. Cast Brass finish with an optional chrome finish.**

SIZE	THREAD	ITEM#
1 1/2"	FNPT x FNST	350-125-00360
2 1/2"	FNPT x FNST	350-125-00380

FxM BRASS HEX



Lansdale Valve and Manufacturing's F x M Hexagon hose adapter is equipped with Female NPT x Male regional hose threads. Finish: Cast Brass; Optional Finish: Chrome**

SIZE	THREAD	ITEM#
1 1/2"	FNPT x MNST	350-125-00660
1 1/2"	FNPT x MNPSH	350-125-00680
2 1/2"	FNPT x MNST	350-125-00420
2 1/2"	FNPT x MPIT	350-125-00760
2 1/2"	FNST x MNYCC	350-125-00730
2 1/2"	FNPT x MNYFD	350-125-00700

MxF BRASS



Lansdale Valve and Manufacturing's M x F Hexagon hose adapter is equipped with Female NPT x Male regional hose threads. Finish: Cast Brass; Optional Finish: Chrome**

SIZE	THREAD	ITEM#
1 1/2"	MNPT x FNST	350-125-00390
2 1/2"	MNPT x FNST	350-125-00400

MxF BRASS SWIVEL



Lansdale Valve and Manufacturing's hexagon swivel hose adapter comes equipped with Male NPT x Female regional hose thread swivel. Comes with ball bearings and Chrome*

SIZE	THREAD	ITEM#
1 1/2"	MNPT x FNST	350-125-00755
2 1/2"	MNPT x FNST	350-125-00720
2"	MNPT x 2 1/2" FNST	350-125-00710

FxF BRASS DOUBLE SWIVEL



Lansdale Valve and Manufacturing's Cast Brass Double Swivel is used to connect a fire hose to a standpipe or sprinkler system. Comes with a cast brass finish and a chrome or polish brass optional finish.**

SIZE	THREAD	ITEM#
2 1/2"	FNST Swivel x FNST	350-125-00745
3" x 2 1/2"	MNPT x 2 1/2" Swivel	350-125-00796

FxM BRASS BUSHING



Lansdale Valve and Manufacturing's F x M brass hex bushing is equipped with male NST x female NPT or NST threads.**

SIZE	THREAD	ITEM#
2 1/2"	MNST x 2" FNPT	350-125-00770
2 1/2"	MNST x 1 1/2" FNST	350-125-00765

POWERBALL 300

SPRINKLER CONTROL VALVE

Lansdale Valve and Manufacturing Powerball eliminates water hammer and is applicable to indoor an outdoor usage. Constructed with a brass body, chrome plated brass disc, and 300 psi. Available in threaded and grooved. Available threaded sizes 1" to 2½" and grooved from 1¼" to 2½". Complete with Position Indicator and Integral Tamper Switch.

- Rated 300 psi
- Indoor/Outdoor use
- Integral tamper switch
- Eliminates water hammer
- Slow open/Slow close
- UL Listed/FM Approved

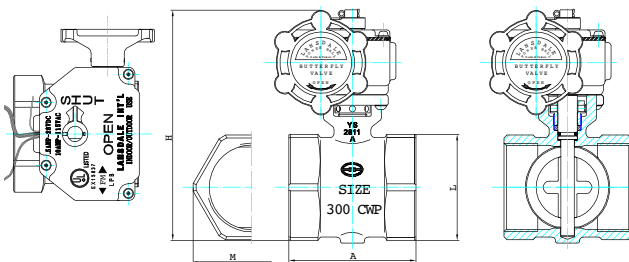

DIMENSIONS (IN)

SIZE	1"	1¼"	1½"	2"	2½"
A	±0.08	2.125	2.626	2.874	3.252
H	±0.12	4.937	5.126	5.595	6.126
L		1.563	1.937	2.189	2.756
M		1.752	2.165	2.374	3.11

SIZE	THREAD	ITEM#
1"	TxT	700-350-00020
1¼"	TxT	700-350-00040
1½"	TxT	700-350-00060
2"	TxT	700-350-00080
2½"	TxT	700-350-00100

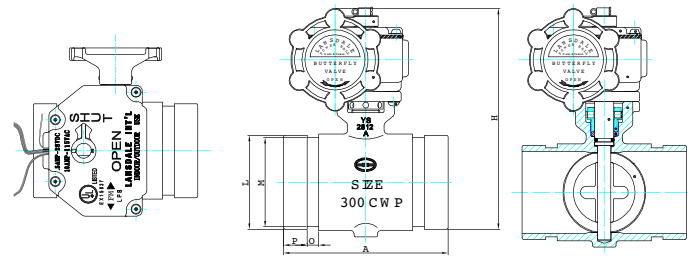

DIMENSIONS (IN)

SIZE	1¼"	1½"	2"	2½"
A	±1.78	±2.03	±2.03	±2.5
H	±2.54	±2.54	±2.54	±2.5
P	±0.76	±0.76	±0.76	±0.7
O	±0.76	±0.76	±0.76	±0.7
M	+0 -0.38	+0 -0.38	+0 -0.38	+0 -0.4
L	±0.41	±0.48	±0.61	±0.7

SIZE	THREAD	ITEM#
1¼"	GxG	700-350-00120
1½"	GxG	700-350-00140
2"	GxG	700-350-00160
2½"	GxG	700-350-00180

GAS COCKS

DESCRIPTION	ITEM#
1/2" Gas Cock	700-425-00020
3/4" Gas Cock	700-425-00040
1" Gas Cock	700-425-00060



BRASS IN-LINE CHECK VALVE

LEAD FREE

Lansdale Valve and Manufacturing In-Line Check Valves are Lead Free brass constructed and equipped with both an O-ring seat and a spring loaded clapper. Brass is Lead Free. Rated at 200 psi.

SIZE	ITEM#
1"	700-225-02200
1 1/4"	700-225-02202
1 1/2"	700-225-02204
2"	700-225-02206



BRASS IN - LINE CHECK VALVE

Lansdale Valve and Manufacturing In-Line Check Valves are brass constructed and equipped with both an O-ring seat and a spring loaded clapper. Brass is Lead Free. Rated at 200 psi.

SIZE	ITEM#
1"	700-225-00260
1 1/4"	700-225-00280
1 1/2"	700-225-00300
2"	700-225-00320



ANGLE VALVES

Lansdale Valve and Manufacturing Brass Angle Valves with rubber disc are specifically designed for use in sprinkler systems. Typically used in Trim or Drain application. Rated at 200 psi.

- Contains lead. Not for use in water systems intended for human consumption

SIZE	ITEM#
1/4"	700-125-00100
3/8"	700-125-00120
1/2"	700-125-00140
3/4"	700-125-00160
1"	700-125-00180
1 1/4"	700-125-00200
1 1/2"	700-125-00220
2"	700-125-00240



GLOBE VALVES

Bronze globe valves with rubber disc. Rated at 200 psi. Lansdale Valve and Manufacturing bronze globe valves are specifically designed for use in fire sprinkler systems. Typically used in drain or trim applications.

- Contains lead. Not for use in water systems intended for human consumption

SIZE	ITEM#
1/4" 200 WOG	700-100-00020
3/8" 200 WOG	700-100-00040
1/2" 200 WOG	700-100-00060
3/4" 200 WOG	700-100-00080
1" 200 WOG	700-100-00100
1 1/4" 200 WOG	700-100-00120
1 1/2" 200 WOG	700-100-00140
2" 200 WOG	700-100-00160
3" 200 WOG	700-100-00180
1" PRTDV	700-100-00200
1" Handle	700-100-00500



BRASS SWING CHECK VALVE

Lansdale Valve and Manufacturing Brass Swing Check Valves come constructed with rubber seats, nuts, and washer. Brass body. Rated at 200 psi. Lansdale Valve and Manufacturing small pipe check valves are brass made with a rubber seat feature and a full floating clapper assembly.

- Contains lead. Not for use in water systems intended for human consumption

SIZE	ITEM#
1/2"	700-225-00020
3/4"	700-225-00040
1"	700-225-00060
1 1/4"	700-225-00080
1 1/2"	700-225-00100
2"	700-225-00120



SWING CHECK VALVE

LEAD FREE

SIZE	ITEM#
1"	700-225-02300
1 1/4"	700-225-02302
1 1/2"	700-225-02304
2"	700-225-02306



TEST & DRAIN VALVES

Lansdale Valve and Manufacturing Test & Drain Valves are used to test water-flow through sprinkler systems. Constructed with forged brass body, three position ball valve, and 1/2" restricted orifice. UL Listed/ FM Approved. Pressure reducing kit available.

- Contains lead. Not for use in water systems intended for human consumption

SIZE	ITEM#
1"	700-400-00020
1 1/4"	700-400-00040
1 1/2"	700-400-00060
2"	700-400-00080



PRESSURE RELIEF VALVES

Lansdale Valve and Manufacturing Pressure Relief Valve is set on a single setting. It is designed to be used in "grid type" and residential sprinkler systems or release system pressure when required. Bronze constructed w/ Rubber seat.

- Contains lead. Not for use in water systems intended for human consumption

SIZE	ITEM#
1/2" x 1/2" (150 psi)	700-375-00080
1/2" x 1/2" (175 psi)	700-375-00040
3/4" x 3/4" (175 psi)	700-375-00060



OS&Y GATE VALVES

Lansdale Valve and Manufacturing OS&Y Gate Valve is exclusively crafted with Brass Screwed Ends outside Screw & Yoke. UL Listed/ FM Approved @ 175 lbs. WOG 100% Pressure Tested Rising Stem.

- Contains lead. Not for use in water systems intended for human consumption

SIZE	ITEM#
1"	700-250-00020
1 1/4"	700-250-00040
1 1/2"	700-250-00060
2"	700-250-00080



BRASS CHECK VALVE

Lansdale Valve and Manufacturing Check Valves close to prevent backward flow of liquid. UL Listed.

- Contains lead. Not for use in water systems intended for human consumption

SIZE	THREAD	ITEM#
2"	GxG	700-225-00410
2 1/2"	GxG	700-225-00420
3"	GxG	700-225-00440
4"	GxG	700-225-00350
4"	(GRVxMT) GxT	700-225-00340
4"	(FTxMT) TxT	700-225-00360



WAFER CHECK VALVES

UL Listed and FM Approved as anti-water hammer check valve for fire pump service only. 250 WOG @ 180° Max. 100% Pressure Tested. Contains Lead. Not intended for use in Potable Water Systems.

SIZE	ITEM#
4"	700-225-01080
6"	700-225-01100
8"	700-225-01120



THREE WAY VALVES

Lansdale Valve and Manufacturing Brass 1/4" Three Way Valve is designed for use with air or water gauges. Constructed with brass.

- Contains lead. Not for use in water systems intended for human consumption

SIZE	ITEM#
1/4"	700-100-00220



BALL DRIP VALVES

Automatic drain device - To be installed horizontally only. Designed to prevent accumulation of moisture on the dry side of Fire Department Connections when used with approved check valves. Brass body with brass ball.

SIZE	ITEM#
1/2"	700-150-00060
3/4"	700-150-00080



BALL VALVES

Lansdale Valve and Manufacturing Full Port Ball Valves are constructed with forged brass and hard chrome plated bronze ball. Designed for trim or test valve usage. Suitable for use with flammable liquid. 600 psi non-shock WOG. UL Listed and FM Approved.

• Contains lead. Not for use in water systems intended for human consumption

SIZE/DESCRIPTION	ITEM#
1/4" Full Port	700-200-00020
3/8" Full Port	700-200-00040
1/2" Full Port	700-200-00060
3/4" Full Port	700-200-00080
1" Full Port	700-200-00100
1 1/4" Full Port	700-200-00120
1 1/2" Full Port	700-200-00140
2" Full Port	700-200-00160



BALL VALVES - LEAD FREE

LEAD FREE

SIZE/DESCRIPTION	ITEM#
1/4" IPS Ball Valve UL/FM	700-200-00205
3/8" IPS Ball Valve UL/FM	700-200-00210
1/2" IPS Ball Valve UL/FM	700-200-00215
1/2" Swt Ball Valve UL/FM	700-200-00255
3/4" IPS Ball Valve UL/FM	700-200-00220
3/4" Swt Ball Valve UL/FM	700-200-00260
1" IPS Ball Valve UL/FM	700-200-00225
1" Swt Ball Valve UL/FM	700-200-00265
1 1/4" IPS Ball Valve UL/FM	700-200-00230
1 1/4" Swt Ball Valve UL/FM	700-200-00270
1 1/2" IPS Ball Valve UL/FM	700-200-00235
1 1/2" Swt Ball Valve UL/FM	700-200-00275
2" IPS Ball Valve UL/FM	700-200-00240
2" Swt Ball Valve UL/FM	700-200-00280
2 1/2" IPS Ball Valve	700-200-00245
2 1/2" Swt Ball Valve	700-200-00285
3" IPS Ball Valve	700-200-00250
3" Swt Ball Valve	700-200-00290



BOILER DRAINS

Drain complies w/ANSI B1.20.1 Hose threads comply with ANSI B1.20.7

SIZE	ITEM#
1/2"	700-150-00020
3/4"	700-150-00040



BOILER DRAINS - LEAD FREE

LEAD FREE

DESCRIPTION	ITEM#
1/2" Female Boiler Drain	700-155-00020
3/4" Female Boiler Drain	700-155-00040
1/2" Boiler Drain	700-155-00060
3/4" Boiler Drain	700-155-00080
1/2" 1/4 Turn Boiler Drain	700-155-00100
3/4" 1/4 Turn Boiler Drain	700-155-00120



PEX BALL VALVES- LEAD FREE

LEAD FREE

DESCRIPTION	ITEM#
700-205-00020	1/2" Pex Ball Valve
700-205-00040	3/4" Pex Ball Valve
700-205-00060	1" Pex Ball Valve
700-205-00080	1/2" Pex Ball Valve W Drain
700-205-00100	3/4" Pex Ball Valve W Drain
700-205-00120	1" Pex Ball Valve W Drain
700-205-00140	1/2" Pex X Male Ball Valve
700-205-00160	3/4" Pex X Male Ball Valve
700-205-00180	1" Pex X Male Ball Valve



RISER CHECK ASSEMBLY

- Designed to be compact, lightweight, & cost effective
- Grooved end connections for easy installation
- Non-slamming, spring loaded clapper prevents water hammer
- Elastomer coated clapper provides positive leak-free sealing
- Approved for vertical or horizontal operation
- Designed for low friction loss



Kit includes: riser check valve, angle valve, nipples, 1/4" 3 way valves, water gauges, & 1/4" plugs. All parts pre-assembled, excluding top water gauge.

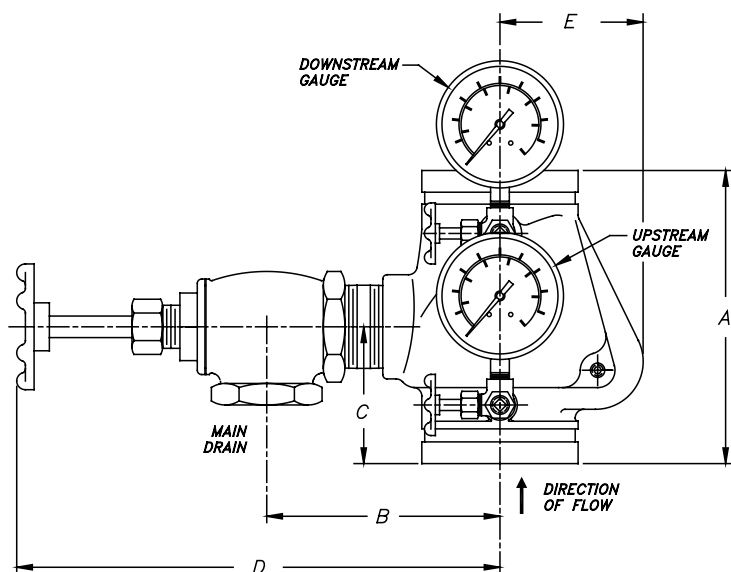

SIZE	A	B	C	D	E
2"	6.65"	5"	3 1/4"	9 1/2"	2 1/2"
2 1/2"	7"	5"	3 1/4"	9 1/2"	3"
3"	8"	5"	3 1/4"	9 1/2"	3 1/2"
4"	8 3/4"	7"	4 1/4"	13 1/2"	4 1/4"
6"	10 3/4"	8"	6"	14 1/2"	4 3/4"

GROOVED BUTTERFLY VALVE

- UL Listed/FM Approved
- Indoor/Outdoor use
- Pressure rated for 300 psi
- Flag type position indicator
- Prewired Double Tamper Switch
- Slow open/close
- Ductile Iron body

SIZE	ITEM#
2 1/2"	700-325-00160
3"	700-325-00180
4"	700-325-00200
5"	700-325-00220
6"	700-325-00240
8"	700-325-00260
10"	700-325-00265



NORMALLY CLOSED AVAILABLE

WAFER BUTTERFLY VALVE

Lansdale Valve and Manufacturing Wafer Butterfly Valve closes slowly to prevent water hammer. Equipped with a double tamper switch and pressure rated for 300 psi. Applicable to indoor/outdoor use.

- UL Listed/FM Approved.

SIZE	ITEM#
4"	700-325-00280
6"	700-325-00300
8"	700-325-00320



LEVER HANDLE BUTTERFLY VALVE

SIZE	ITEM#
2"	700-325-00700
2.5"	700-325-00720
3"	700-325-00740
4"	700-325-00760
5"	700-325-00780
6"	700-325-00800
8"	700-325-00820



Gear Operated

10"	700-325-00840
12"	700-325-00860



SHOTGUN RISER TRIM KITS

SIZE	ITEM#
2 1/2" & 3"	650-275-00270
4", 6" & 8"	650-275-00280

1 1/4" Angle Valve, 1 1/4 x Close Nipple, 1/4" Nipples, Air/Water Gauges, 1/4" Plugs, 1/4" 3-Way Valves, and 1/2 x 1/4 Bushings for 2 1/2" & 3"

1 1/4" Angle Valve, 1 1/4 x Close Nipple, 1/4" Nipples, Air/Water Gauges, 1/4" Plugs, 1/4" 3-Way Valves, and 1/2 x 1/4 Bushings for 2 1/2" & 3"



GROOVED CHECK VALVE

Lansdale Valve and Manufacturing Cast Iron Check Valves are approved for installation in both horizontal or vertical line with upward flow. Easier and faster to maintain and install. Low pressure drop. EPDM non-stick leak tight sealing. All Stainless steel wetted parts to provide superior corrosion resistance.

- UL Listed/FM Approved

SIZE	ITEM#
2"	700-225-00500
2 1/2"	700-225-00520
3"	700-225-00540
4"	700-225-00560
5"	700-225-00380
6"	700-225-00580
8"	700-225-00400
10"	700-225-00401
12"	700-225-00403



RISER CHECK VALVE

Lansdale Valve and Manufacturing's Riser Check Valves (Shotgun Risers) are intended for use in wet pipe fire protection systems as well as pre-action systems where there is no need for a mechanical alarm. The use of a water flow switch can provide an electric alarm. Grooved ends provide for a fast and economical installation. When installed vertically, the direction of flow arrow should point upward. For horizontal installation, the hinge pin must be located at the top.

If used in a pre-action system, the valve must be installed vertically. Rated for 200 psi.

SIZE	THREAD	ITEM#
2"	GxG	650-275-00010
2 1/2"	GxG	650-275-00020
3"	GxG	650-275-00040
4"	GxG	650-275-00060
6"	GxG	650-275-00080
8"	GxG	650-275-00090



OS&Y RESILIENT SEATED GATE VALVE W/ FLANGE ENDS

Features:

- Lansdale Valve and Manufacturing valves are constructed with a high quality graphite stem seal
- NPT brass plug on the body
- A heavy duty nut attaches the hand wheel to the yoke
- Internally and externally fusion bonded epoxy powder coated for corrosion protection
- Flange designed to EN1092-2 PN10 / PN16, ANSI B16.1 Class 125 (others available upon request)
- Maintains working pressure of 300 psi & working temperature of 33.08°F to 125.6°F.
- Valves comply with AWWA C515.
- UL Listed/ FM Approved

SIZE	ITEM#
2.5"	700-250-00100
3"	700-250-00120
4"	700-250-00140
5"	700-250-00160
6"	700-250-00180
8"	700-250-00200
10"	700-250-00220
12"	700-250-00240
14"	
16"	



OS&Y Flanged Gate Valve - Untapped

SIZE	ITEM#
2"	700-250-00700
2.5"	700-250-00705
3"	700-250-00710
4"	700-250-00721
5"	700-250-00730
6"	700-250-00740
8"	700-250-00760
10"	700-250-00780

OS&Y GROOVED VALVE

Features:

- Lansdale Valve and Manufacturing valves comply with AWWA C515
- Valves with an indicator flange and a 2" square wrench nut
- Triple O-rings stem seal
- NPT brass plug on body
- Groove to Metric or AWWA C606 standard
- Working pressure 300 psi
- Working pressure 200 psi and 250 psi available on request
- Working Temp 33.08°F to 125.6°F.
- Internally and externally fusion bonded epoxy powder coated (FBE)
- UL Listed/FM Approved

SIZE	ITEM#
2.5"	700-250-00510
3"	700-250-00520
4"	700-250-00540
6"	700-250-00580
8"	700-250-00600
10"	700-250-00620
12"	700-250-00640



NON-RISING STEM GATE VALVE VALVES

General Specifications:

- Lansdale Valve and Manufacturing valves comply with AWWA C515-15 Standard
- Non-Rising Stem, Resilient Seated (EDPM encapsulated wedge)
- Triple O-Ring Seal
- Available with Optional Test Plug on valve body (special order)
- Post Indicator Valves provided with universal "Indicator Post Plate"
- Mechanical Joint Ends to AWWA C153 / A21.53 Standard
- Flanged Ends to ANSI B16.1, Class 125
- UL Listed / FM Approved at 300 psi water working pressure rating
- NSF-61 and NSF-372 Certified as Lead-Free for use in Drinking Water Systems
- Temperature Range: 42° - 180° F.
- Fusion Bonded Epoxy Coated Interior and Exterior to AWWA C550 Standard
- Flanged Valves available with Hand Wheel or Operating Nut

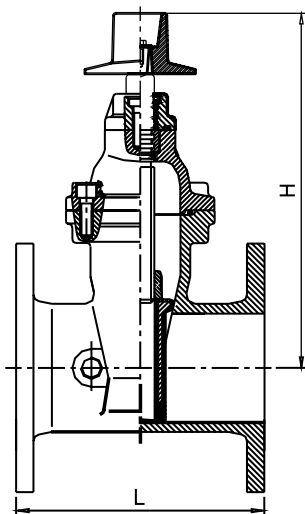

Part Name	Material	ASTM Spec.
Body	Ductile Iron	A536 65-45-12
Wedge	Ductile Iron, EPDM Encapsulated	
Wedge Nut	Bronze	B62 C83600
Stem	Stainless Steel	AISI 304
Bonnet	Ductile Iron	A536 65-45-12
Gasket	Rubber	EPDM
Gland	Ductile Iron	A536 65-45-12
Thrust Collar	Bronze	B62 C83600
O-Ring	Rubber	EPDM
Post Flange	Ductile Iron	A536 65-45-12
Operating Nut	Ductile Iron	A536 65-45-12
NPT Plug	Bronze	Commercial
Post Flange	Bolt	Stainless Steel AISI 316
Bonnet Bolt	Stainless Steel	AISI 304



NRS SEATED GATED MECHANICAL JOINT X MECHANICAL JOINT



SIZE	ITEM#
3"	700-275-00460
4"	700-275-00480
6"	700-275-00500
8"	700-275-00520
10"	700-275-00540
12"	700-275-00560

MJ x MJ

Dimensions (Inch)						
Size	3"	4"	6"	8"	10"	12"
L	9 1/2	10	11 1/2	12 1/2	14 3/4	14 7/8
H	11 5/8	13 3/4	17 15/16	21 7/16	25 3/8	28 3/4
D		12	12	12	12	12
Weight (Lbs)	45	71	116	176	280	386

NRS SEATED GATED FLANGE ENDS X FLANGE ENDS



SIZE	ITEM#
3"	700-275-00360
4"	700-275-00365
6"	700-275-00370
8"	700-275-00375
10"	700-275-00380
12"	700-275-00385
14"	700-275-00390
16"	700-275-00395

Flanged

Dimensions (Inch)						
Size	3"	4"	5"	6"	8"	10"
L	8	9	10	10 1/2	11 1/2	13
H	11 5/8	13 3/4	16 1/8	17 15/16	21 7/16	25 3/8
D		12	12	12	12	12
Weight (Lbs)	41	64	79	103	161	235

POST INDICATOR VALVES

General Specifications:

- Lansdale Valve and Manufacturing valves comply with AWWA C515-15 Standard
- Non-Rising Stem, Resilient Seated (EDPM encapsulated wedge)
- Triple O-Ring Seal
- Available with Optional Test Plug on valve body (special order)
- Post Indicator Valves provided with universal "Indicator Post Plate"
- Mechanical Joint Ends to AWWA C153 / A21.53 Standard
- Flanged Ends to ANSI B16.1, Class 125
- UL Listed / FM Approved at 300 psi water working pressure rating
- NSF-61 and NSF-372 Certified as Lead-Free for use in Drinking Water Systems
- Temperature Range: 42° - 180° F.
- Fusion Bonded Epoxy Coated Interior and Exterior to AWWA C550 Standard
- Flanged Valves available with Hand Wheel or Operating Nut

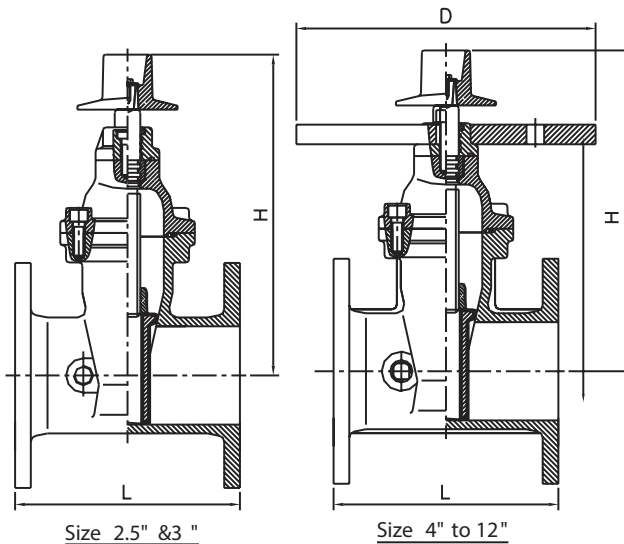

Part Name	Material	ASTM Spec.
Body	Ductile Iron	A536 65-45-12
Wedge	Ductile Iron, EPDM Encapsulated	
Wedge Nut	Bronze	B62 C83600
Stem	Stainless Steel	AISI 304
Bonnet	Ductile Iron	A536 65-45-12
Gasket	Rubber	EPDM
Gland	Ductile Iron	A536 65-45-12
Thrust Collar	Bronze	B62 C83600
O-Ring	Rubber	EPDM
Post Flange	Ductile Iron	A536 65-45-12
Operating Nut	Ductile Iron	A536 65-45-12
NPT Plug	Bronze	Commercial
Post Flange Bolt	Stainless Steel	AISI 316
Bonnet Bolt	Stainless Steel	AISI 304



POST INDICATOR VALVE - MECHANICAL JOINT



SIZE	ITEM#
4"	700-275-00100
6"	700-275-00120
8"	700-275-00140
10'	700-275-00145
12'	700-275-00150

MJ x MJ

Dimensions (Inch)						
Size	3"	4"	6"	8"	10"	12"
L	9 1/2	10	11 1/2	12 1/2	14 3/4	14 7/8
H	11 5/8	13 3/4	17 15/16	21 7/16	25 3/8	28 3/4
D		12	12	12	12	12
Weight (Lbs)	45	71	116	176	280	386

POST INDICATOR VALVE - FLANGED



SIZE	ITEM#
4"	700-275-00020
6"	700-275-00040
8"	700-275-00060
10'	700-275-00065
12'	700-275-00075

Flanged

Dimensions (Inch)						
Size	3"	4"	5"	6"	8"	10"
L	8	9	10	10 1/2	11 1/2	13
H	11 5/8	13 3/4	16 1/8	17 15/16	21 7/16	25 3/8
D		12	12	12	12	12
Weight (Lbs)	41	64	79	103	161	235

SWING CHECK VALVE W/FLANGE ENDS 300 PSI

Lansdale Valve Manufacturing Swing Check Valves come equipped with two brass plugs screwed on one side of the body. Valves comply with AWWA C508, clear waterway design. Seating type is resilient material to bronze seat construction. Flanges designed to EN1092 - PN10 / PN16, ANSI B16.1 Class 125 (others available upon request). Internally and externally fusion bonded epoxy powder coated for corrosion protection. Maintains working pressure of 300 psi with 200 psi and 250 psi upon request. Working temperature of 33.08°F to 125.6°.

- UL Listed/FM Approved

SIZE	ITEM#
3"	700-225-00940
4"	700-225-00960
6"	700-225-01000
8"	700-225-01020
10"	700-225-01040
12"	700-225-01060



LEVER & WEIGHT CHECK VALVES W/FLG X FLG

General Specifications:

- Resilient seated (EPDM rubber face on the ductile iron disc)
- Bronze seat ring
- "Clear Waterway" design per AWWA C508 Standard
- Flanged ends to ANSI B16.1, Class 125
- Fusion Bonded Epoxy Coated Interior and Exterior per AWWA C550 Standard
- Rated at 200 psi (working pressure)
- 33.8° - 125.6° temperature range

SIZE	ITEM#
3"	700-225-02400
4"	700-225-02405
6"	700-225-02410
8"	700-225-02415
10"	700-225-02420
12"	700-225-2425



VERTICAL INDICATOR POST

Lansdale Valve and Manufacturing Vertical Indicator Post indicates if valve is in the open or shut position. The indicator post creates a way to operate a buried/inaccessible valve. Indicator post's adjustment range reaches 34.5" and can be easily adjusted on site. The wrench handle fits over a "U" bracket on the barrel, and may be fixed with a padlock to secure the operating wrench to the barrel. Ability to open left or right. Internally and externally red epoxy coated RAL3000 for corrosion protection.

- UL Listed/FM Approved

ITEM# 700-275-00180



WALL INDICATOR POST

Lansdale Valve and Manufacturing Wall Indicator Post indicates if the valve is in the open or shut position. It is operated by a hand wheel and used to operate a valve installed behind a wall. Comes equipped with a 12" O.D. post flange to mount on a wall. Ability to open left or right. UL Listed/FM Approved. Internally and externally red epoxy coated RAL3000 for corrosion protection.

- UL Listed/FM Approved

ITEM# 700-275-00160



DUCTILE IRON SPOOL PIECES

- Available in Flange x Flange and Flange x Plain End
- Meets or exceeds ANSI / AWWA CC115 / A21.15 Standard
- Available in sizes 3" thru 12" Diameter

COATING SYSTEMS

Unless otherwise specified, flanged pipe will be furnished with a standard thickness cement-mortar lining with asphaltic coating inside and outside. Primer coatings are available upon request.



DIMENSIONS (In.)

Size (In.)	OD	BC	T	Bolt Hole Diameter	Bolt Diameter & Length	Qty. of Bolts
3"	7.50	6.00	.75 ± .12	3/4	5/8 x 2 1/2	4
4"	9.00	7.50	.94 ± .12	3/4	5/8 x 3	8
6"	11.00	9.50	1.00 ± .12	7/8	3/4 x 3 1/2	8
8"	13.50	11.75	1.12 ± .12	7/8	3/4 x 3 1/2	8
10"	16.00	14.25	1.19 ± .12	1	7/8 x 4	12
12"	19.00	17.00	1.25 ± .12	1	7/8 x 4	12

Y STRAINER W/ GROOVED ENDS

General Specifications:

- Lansdale Valve and Manufacturing
Connection Ends: Grooved to AWWA C606
- Working Pressure: 300 psi
- Working Temperature: 0°C - 100°C
- Coating: Fusion Bonded Epoxy Coating in accordance with ANSI/AWWA C550 or painting upon request
- UL Listed



SIZE	ITEM#
2 1/2"	700-225-02700
3"	700-225-02710
4"	700-225-02720
5"	700-225-02730
6"	700-225-02740
8"	700-225-02750
10"	700-225-02760
12"	700-225-02770

STANDARD SCREEN

Size	Sieve No.	Hole Dia. (In.)	Free Flow Area (%)
2" ~ 2.5"	25	.16	48
3" ~ 4"	19	.2	59
5"	14	.24	63
6" ~ 12"	13	.25	64

Note: For special material request other than standard specification, please indicate clearly on the inquiry or order list.

Dimensions (Inch)

SIZE	L	OD	D
2"	9.75	2.40	2.25
2.5"	10.75	2.90	2.72
3"	11.75	3.50	3.35
4"	14.25	4.50	4.33
5"	16.5	5.56	5.40
6"	18.5	6.63	6.50
8"	24.0	8.63	8.45
10"	27.0	10.75	10.56
12"	30.0	12.75	12.53

Y STRAINER W/ FLANGED ENDS

General Specifications:

- Lansdale Valve and Manufacturing
Flange drilling to ANSI B16.1 Class 125
- Grooved Ends to AWWA C606
- Working Pressure 300 psi
- Working Temperature: 32° to 176° F (0° to 80° C) rubber gasket
- Fusion bonded epoxy coated interior and exterior (FBE) in accordance with ANSI AWWA C5
- UL Listed



SIZE	ITEM#
2 1/2"	700-225-02600
3"	700-225-02610
4"	700-225-02620
6"	700-225-02640
8"	700-225-02650
10"	700-225-02660
12"	700-225-02670

	DN	Dimensions (In.)				
Inch	L	D	D1	b	n-Φd	H
2.5"	10	7	5.5	.69	4-Φ .75	6.5
3"	10.12	7.52	6	.75	4-Φ .75	7.01
4"	12.125	9.02	7.5	.94	8-Φ .75	9.02
5"	15.63	10	8.5	.94	8-Φ .87	11.22
6"	18.5	10.98	9.51	1	8-Φ .87	12.24
8"	21.6	13.5	11.75	1.12	8-Φ .87	15.51
10"	25.75	15.98	14.25	1.2	12-Φ 1	19.17
12"	29.88	19.02	17.01	1.26	12-Φ 1	21.54

COMMERCIAL RISERS

Floor Control Valve

Lansdale Valve and Manufacturing Commercial Risers are factory assembled with brass and galvanized trim. Each riser is factory tested at 200 psi and available with "Test and Drain" or Ball Valve designs.

- Lansdale Valve and Manufacturing Water Flow Switch assures optimum sensitivity
- Built in port allows hydrostatic testing without draining the system
- 1/4" 3-way valve allows for easy testing and replacing of pressure gauge
- UL Listed

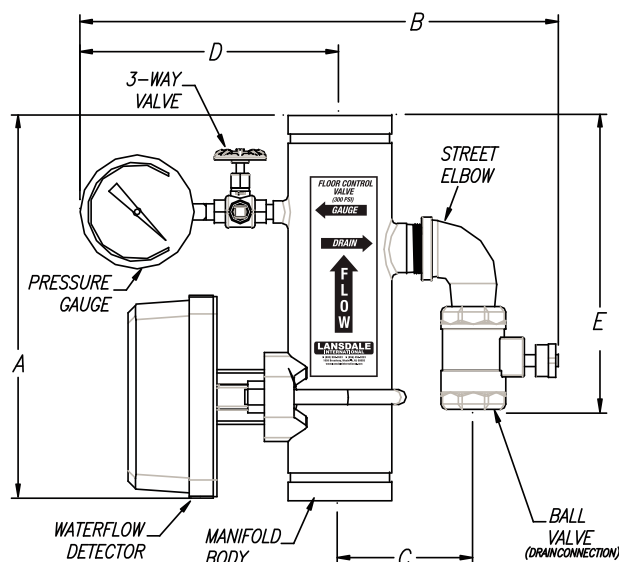

BASIC ASSEMBLY (3" (80MM) VERSION SHOWN)

Nominal Size	2"	2.5 "	3"	4"	6"
A	13"	13"	13"	13"	13"
B (Ball Valve)	13"	13¾"	15¾"	19½"	20"
B (Test & Drain)	13½"	14¼"	16¼"	19"	20¾"
C	5¼"	5"	5½"	7"	8¼"
D	9¼"	9½"	9½"	10¾"	11"
E (Ball Valve)	5⅝"	7⅞"	9⅞"	12⅞"	13½"
E (Test & Drain)	10"	10¼"	12¼"	14¾"	14½"
F	3½"	3½"	3½"	3½"	3½"
G	4½"	4½"	4½"	4½"	4½"
H	3½"	3½"	3½"	3½"	3½"



RESIDENTIAL RISERS

Lansdale Valve and Manufacturing Residential Riser is a cost effective, factory assembled riser assembly. The assembly comes in various configurations to meet all of your needs. Featuring cast-in place mounting brackets for ease of installation. The assembly has a working pressure of 175 psi. UL Listed. Choice of 4 kinds of trim: Basic Trim, Basic Trim w/Pressure Relief Kit, Test & Drain, and Test & Drain w/Pressure Relief Kit.

Features:

- Lead Free stainless steel body construction with all brass trim
- Factory assembled
- Factory pressure tested at 200 psi (13.8 bar)
- NPT (female x female) connections
- Slim design allows for easy installation
- Optimum sensitivity is assured through a dedicated FM Approved/UL and ULC Listed Water Flow Detector



Size	A
1"	.75"
1¼"	1.02"
1½"	1.02"
2"	1.02"

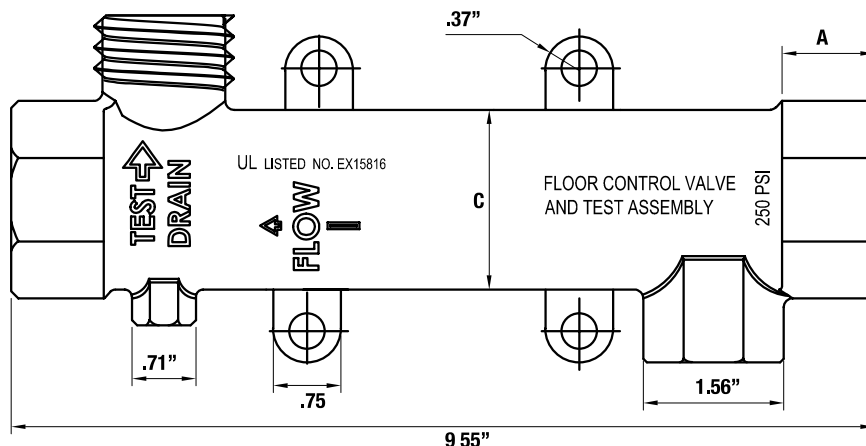

COMMERCIAL RISERS



COMMERCIAL RISER W/BASE TRIM

SIZE	ITEM#
2"	650-375-00400
2½"	650-375-00420
3"	650-375-00440
4"	650-375-00460
6"	650-375-00480

COMMERCIAL RISER - W/TEST & DRAIN

SIZE	ITEM#
2"	650-375-00540
2.5"	650-375-00560
3"	650-375-00580
4"	650-375-00600
6"	650-375-00620

PRESSURE RELIEF KIT (SOLD SEPARATE)

SIZE	ITEM#
2"	650-375-00545
2½" & 3"	650-375-00585
4" & 6"	650-375-00605

RESIDENTIAL RISERS



RESIDENTIAL RISER W/BASE TRIM

SIZE	ITEM#
1"	650-375-00100
1¼"	650-375-00120
1½"	650-375-00160
2"	650-375-00180

RESIDENTIAL RISER W/PRESSURE RELIEF VALE TRIM

SIZE	ITEM#
1"	650-375-00200
1¼"	650-375-00220
1½"	650-375-00240
2"	650-375-00260

RESIDENTIAL RISER W/TEST & DRAIN

SIZE	ITEM#
1"	650-375-00280
1¼"	650-375-00740
1½"	650-375-00760
2"	650-375-00840

DRUM DRIP

- Ready to Install
- Hot Dipped Galv.
- Rated to 175 psi
- Tested to 700 psi
- 36 Hour ice build up test with no damage
- Made in the USA
- 1" UL/FM Ball Valves

DESCRIPTION

Drum Drip Assembly

ITEM#

650-225-06450



TEST & DRAIN PRV KIT

- 300 psi rated Test & Drain, UL listed & FM approved
- Tamper Resistant 5.6k test orifice & sight glass
- Factory set 175 psi pressure relief valve
- Pre-assembled for field installation saving time & money!
- Available in 1", 1-1/4", 1-1/2", 2"

SIZE**ITEM#**

1"	700-400-00081
1 1/4"	700-400-00082
1 1/2"	700-400-00083
2"	700-400-00084



SEMI RECESSED COMPRESSION - LARGE

MODEL A

SIZE	FINISH	ITEM#
1/2"	CP	100-225-02440



SEMI RECESSED - STANDARD SKIRT

MODEL B-2PC

For use with 1/2" and 3/4" IPS sprinkler heads.
Canopies have approximately 3/4" adjustment.

SIZE	FINISH	ITEM#
1/2"	Brass	100-225-00200
3/4"	Brass	100-225-02480
1/2"	Black	100-225-02500
3/4"	Black	100-225-02520
1/2"	Chrome	100-225-00160
3/4"	Chrome	100-225-00220
1/2"	White	100-225-00180
3/4"	White	100-225-00240



SEMI RECESSED - SHORT SKIRT

MODEL C-2PC

For use with 1/2" and 3/4" IPS sprinkler heads.
Canopies have approximately 3/4" adjustment.

SIZE	FINISH	ITEM#
1/2"	Brass	100-225-02700
3/4"	Brass	100-225-02720
1/2"	Chrome	100-225-00260
3/4"	Chrome	100-225-00300
1/2"	White	100-225-00280
3/4"	White	100-225-02800



ESCUTCHEONS- CUP- STEEL

For use with 1/2" and 3/4" IPS sprinkler heads.
Cup #1 is 1 3/4" deep, Cup #2 is 1" depth.

STYLE	SIZE	FINISH	ITEM#
CUP #1	1/2"	Brass	100-225-01640
CUP #1	3/4"	Brass	100-225-01660
CUP #1	1/2"	Chrome	100-225-01680
CUP #1	3/4"	Chrome	100-225-01700
CUP #1	1/2"	White	100-225-01720
CUP #1	3/4"	White	100-225-01740
CUP #2	1/2"	Brass	100-225-01760
CUP #2	3/4"	Brass	100-225-01780
CUP #2	1/2"	Chrome	100-225-01800
CUP #2	3/4"	Chrome	100-225-01820
CUP #2	1/2"	White	100-225-01840
CUP #2	3/4"	White	100-225-01860



KYDEX RING - WHITE

Covers holes that are too large for standard escutcheons.

DESCRIPTION	ITEM#
1 3/4" ID x 4 1/16" OD	100-225-03160



ESCUTCHEONS - SKIRT - STEEL

For use with 1/2" and 3/4" IPS sprinkler heads. Skirts are interchangeable with either cup to allow maximum adjustment without having to recut drops.

SIZE	FINISH	ITEM#
SKIRT A	Brass	100-225-01940
SKIRT A	Chrome	100-225-01960
SKIRT A	White	100-225-01980
SKIRT B	Brass	100-225-02000
SKIRT B	Chrome	100-225-02020
SKIRT B	White	100-225-02040
SKIRT C	Brass	100-225-02060
SKIRT C	Chrome	100-225-02080
SKIRT C	White	100-225-02100



NOTE: Skirt A- 1.25" Deep, Skirt B- Flush, Skirt C- Short Tapered

ESCUTCHEONS - RETROFIT - STEEL (SPLIT)

Used to replace escutcheons without having to drain the sprinkler system.

SIZE	FINISH	ITEM#
RECESSED		
1/2"	Chrome	100-225-02660
3/4"	Chrome	100-225-02680
1/2"	White	100-225-02685

CUP #1

1/2"	Chrome	100-225-01900
1/2"	Brass	100-225-01880
1/2"	White	100-225-01920

CUP #1 to be used with Skirts A, B, or C.

FLAT

1/2"	Chrome	100-225-01600
3/4"	Chrome	100-225-01620



EXTENSION RING

For semi rec. escutcheons and concealed cover plates.

SIZE	FINISH	ITEM#
RECESSED		
5"	Chrome	100-225-02620
5"	White	100-225-02640

CONCEALED

4 1/2"	Chrome	100-250-00810
4 1/2"	White	100-250-00820



THREADED SEMI RECESSED - MODEL D

For use with 1/2" IPS sprinkler heads.
Canopies have over a 1/2" adjustment.

SIZE	FINISH	ITEM#
1/2"	CP	100-225-00320
1/2"	White	100-225-02840



ROD BUTTONS - PLASTIC

Used to cover holes in ceiling for hanger rods.

SIZE	FINISH	ITEM#
3/8"	White	100-225-03120
3/8"	Chrome	100-225-03100



ONE PIECE CANOPY

For use with 1/2" and 3/4" IPS sprinkler heads with weep hole for leak detection. These canopies are made of heavy steel, making them hard to bend.



MODEL	SIZE	FINISH	ITEM#
C-25	1/2"	Brass	100-225-00600
C-25	3/4"	Brass	100-225-00620
C-25	1/2"	Chrome	100-225-00640
C-25	3/4"	Chrome	100-225-00660
C-25	1/2"	White	100-225-00680
C-25	3/4"	White	100-225-00700
C-50	1/2"	Brass	100-225-00720
C-50	3/4"	Brass	100-225-00740
C-50	1/2"	Chrome	100-225-00760
C-50	3/4"	Chrome	100-225-00780
C-50	1/2"	White	100-225-00800
C-50	3/4"	White	100-225-00820
C-75	1/2"	Brass	100-225-00840
C-75	3/4"	Brass	100-225-00860
C-75	1/2"	Chrome	100-225-00880
C-75	3/4"	Chrome	100-225-00900
C-75	1/2"	White	100-225-00920
C-75	3/4"	White	100-225-00940
C-100	1/2"	Brass	100-225-00960
C-100	3/4"	Brass	100-225-00980
C-100	1/2"	Chrome	100-225-01000
C-100	3/4"	Chrome	100-225-01020
C-100	1/2"	White	100-225-01040
C-100	3/4"	White	100-225-01060
C-125	1/2"	Chrome	100-225-01120
C-125	3/4"	Chrome	100-225-01140
C-125	1/2"	White	100-225-01160
C-125	3/4"	White	100-225-01180
C-150	1/2"	Chrome	100-225-01240
C-150	3/4"	Chrome	100-225-01260
C-150	1/2"	White	100-225-01280
C-150	3/4"	White	100-225-01300
C-175	1/2"	Chrome	100-225-01360
C-175	3/4"	Chrome	100-225-01380
C-175	1/2"	White	100-225-01400
C-175	3/4"	White	100-225-01420
C-200	1/2"	Chrome	100-225-01480
C-200	3/4"	Chrome	100-225-01500
C-200	1/2"	White	100-225-01520
C-200	3/4"	White	100-225-01540
C-50	1/2"	White Plastic	100-225-01580

GALVANIZED WALL PLATE - WITH SCREW SET

Made from malleable iron and galvanized for superior corrosion resistance.

SIZE	ITEM#
1"	100-575-00020
1 1/4"	100-575-00040
1 1/2"	100-575-00060
2"	100-575-00080
2 1/2"	100-575-00100
3"	100-575-00120
4"	100-575-00140



EXTENSION TUBES

For use with cup & skirt escutcheons. Tubes are wrapped for protection of surface. Made from stainless steel. To be used with our 2-Piece retrofit escutcheons.

SIZE	FINISH	ITEM#
4"	Chrome	100-225-02160
6"	Chrome	100-225-02180
8"	Chrome	100-225-02200
10"	Chrome	100-225-02220
4"	White	100-225-02300
6"	White	100-225-02320
8"	White	100-225-02340
10"	White	100-225-02360

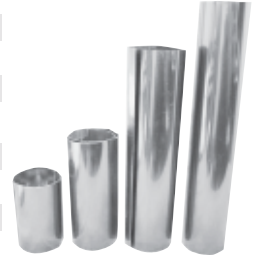

FLOOR & CEILING PLATES - PLASTIC

1 Piece plastic plates come with a split for ease of installation.

SIZE	FINISH	ITEM#
1/2"	Chrome	100-250-00320
3/4"	Chrome	100-250-00340
1"	Chrome	100-250-00360
1 1/4"	Chrome	100-250-00380
1 1/2"	Chrome	100-250-00400
2"	Chrome	100-250-00420
2 1/2"	Chrome	100-250-00440
3"	Chrome	100-250-00460
4"	Chrome	100-250-00500
5"	Chrome	100-250-00520
6"	Chrome	100-250-00540
8"	Chrome	100-250-00560
1/2"	White	100-250-00580
3/4"	White	100-250-00600
1"	White	100-250-00620
1 1/4"	White	100-250-00640
1 1/2"	White	100-250-00660
2"	White	100-250-00680
2 1/2"	White	100-250-00700
3"	White	100-250-00720
4"	White	100-250-00740
5"	White	100-250-00760
6"	White	100-250-00780
8"	White	100-250-00800



FLOOR & CEILING PLATES - METAL

Chrome plated heavy gauge steel with locking tab and spring inserts for tight fit.

SIZE	ITEM#
1/2"	100-250-00020
3/4"	100-250-00040
1"	100-250-00060
1 1/4"	100-250-00080
1 1/2"	100-250-00100
2"	100-250-00120
2 1/2"	100-250-00140
3"	100-250-00160
4"	100-250-00200
5"	100-250-00220
6"	100-250-00240
8"	100-250-00260
10"	100-250-00280



ROD COUPLINGS

- Zinc-plated for corrosion resistance
- Material: Steel
- Standard Finish: Electroplated
- Designed for coupling two hanger rods of equal sizes

SIZE	ITEM#
3/8" x 1 1/8"	500-500-00100
3/8" x 1 3/4"	500-500-00120
1/2" x 1 3/4"	500-500-00140
5/8" x 2 1/8"	500-500-00160
3/4" x 2 1/4"	500-500-00180
3/4" x 5/8"	500-500-00200

Reducing, R.C.



DROP-IN ANCHOR

- Zinc plated steel
- Used in concrete and stone.
- Use with machine screw, bolt or threaded rod
- For flush mounted installations

SIZE	ITEM#
3/8"	500-450-00020
3/8" Short UL/FM	500-450-00010
1/2"	500-450-00040
1/2" Short UL/FM	500-450-00015
3/8" Setting Tool	100-525-01320
1/2" Setting Tool	100-525-01300



FLAT WASHERS

Zinc plated for corrosion resistance.

SIZE	ITEM#
3/8"	500-600-01060
1/2"	500-600-01100
5/8"	500-600-01160
3/4"	500-600-01180
7/8"	500-600-01200



FENDER WASHERS

SIZE	ITEM#
3/8" x 2"	500-600-01080
1/2" x 2"	500-600-01140

HEX HEAD BOLTS

Grade 2 Zinc coated to ensure corrosion resistance.

SIZE	ITEM#
5/8" x 2 1/2"	500-600-00340
5/8" x 3"	500-600-00360
3/4" x 3 1/2"	500-600-00400
7/8" x 4"	500-600-00460



HEX NUTS

Grade 2 Zinc coated to ensure corrosion resistance.

SIZE	ITEM#
3/8"	500-600-00120
1/2"	500-600-00140
5/8"	500-600-00160
3/4"	500-600-00180
5/8"	500-600-00200



DRIVE SCREWS

For use with U-Hooks.

SIZE	ITEM#
#16 x 2	500-550-00280



COACH ROD SCREW (HANGER ROD)

Zinc plated for Corrosion resistance.

SIZE	ITEM#
3/8" x 4"	500-550-00160
3/8" x 6"	500-550-00180
3/8" x 8"	500-550-00200
3/8" x 10"	500-550-00220
1/2" x 4"	500-550-00240

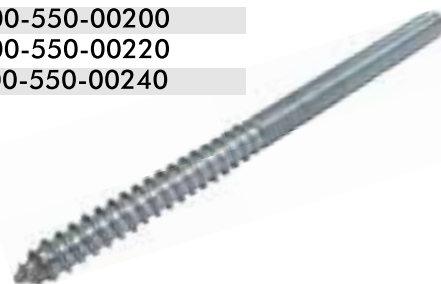

CLEVIS HANGERS

Lansdale Valve and Manufacturing Clevis Hangers are designed to suspend light stationary pipe and allow room for vertical adjustments. Made from steel with a galvanized finished. UL Listed for 3/4" thru 12". Complies with Federal Specification WW-H-171E Type 12Riser.



SIZE	ITEM#
3/4"	500-250-00040
1"	500-250-00060
1 1/4"	500-250-00080
1 1/2"	500-250-00100
2"	500-250-00120
2 1/2"	500-250-00140
3"	500-250-00160
4"	500-250-00180
5"	500-250-00200
6"	500-250-00220
8"	500-250-00240
10"	500-250-00260
12"	500-250-00280

TOGGLE WING

Lansdale Valve and Manufacturing Riser Clamps are made to support and stabilize vertical pipe runs. The Clamp is fitted for steel pipe and usually installed below a coupling or shear lugs. Riser Clamps are steel made and available in plain and galvanized finish. Complies with Federal Specification WW-H-171E Type 8. UL Listed.



SIZE	ITEM#
1/2"	500-200-00020
3/4"	500-200-00040
1"	500-200-00060
1 1/4"	500-200-00080
1 1/2"	500-200-00100
2"	500-200-00120
2 1/2"	500-200-00140
3"	500-200-00160
3 1/2"	500-200-00180
4"	500-200-00200
5"	500-200-00220
6"	500-200-00240
8"	500-200-00260
10"	500-200-00280
12"	500-200-00300

TOGGLE WING

Zinc plated to ensure corrosion resistance.

SIZE	ITEM#
3/8"	500-500-00220



CPVC HANGERS

Designed to be used as a hanger and restrainer for CPVC piping. Lansdale Valve and Manufacturing "standoff" design eases installation by eliminating the need for wood blocking. Packaged separately with approved screws. UL Listed.



1-Hole Strap

SIZE	ITEM#
3/4"	500-300-00220
1"	500-300-00240
1 1/4"	500-300-00260
1 1/2"	500-300-00280
2"	500-300-00300



2-Hole Strap

SIZE	ITEM#
3/4"	500-300-00320
1"	500-300-00340
1 1/4"	500-300-00360
1 1/2"	500-300-00380
2"	500-300-00400



Stand Off

SIZE	ITEM#
3/4"	500-300-00420
1"	500-300-00440
1 1/4"	500-300-00460
1 1/2"	500-300-00480
2"	500-300-00500



Side Mount

SIZE	ITEM#
1"	500-300-00540
1 1/4"	500-300-00560
1 1/2"	500-300-00580



LAG BOLTS - HEX HEAD

Zinc plated for corrosion resistance. Used in heavier load applications.

SIZE	ITEM#
3/8" x 2"	500-600-00800
3/8" x 2 1/2"	500-600-00820
3/8" x 3"	500-600-00840
1/2" x 2 1/2"	500-600-00860
1/2" x 3"	500-600-00880



SAMMYS® - WOOD



The original threaded rod anchoring system is used for vertical suspension of threaded rods within fire protection and other pipe hanging applications. UL/FM approved. The vertical, horizontal, and sidewinder models allow you to hang pipe where needed, saving you time and lowering your install costs. Additional models in stock.

SIZE/DESCRIPTION

ITEM#

2" Swivel for 3/8" Rod	SH-GST 20	500-850-01300
2 1/2" for 3/8 Rod	GST25-380	500-850-00100
2" for 3/8 Rod	GST 20	500-850-00020
3" for 3/8 Rod	GST 30	500-850-00120
2" for 1/2 Rod	GST 2	500-850-00140
1" for 3/8 Rod	GST10	500-850-00160
2" Sidewinder for 3/8 Rod	SWG 20	500-850-00080
2 1/2" Sidewinder for 3/8 Rod	SWG 25-380	500-850-00040
3" Sidewinder for 3/8 Rod	SWG30	500-850-00060

SAMMYS® - STEEL



The original threaded rod anchoring system is used for vertical suspension of threaded rods within fire protection and other pipe hanging applications. UL/FM approved. The vertical, horizontal and sidewinder models allow you to hang pipe where needed, saving you time and lowering your install costs. Additional models in stock.

SIZE/DESCRIPTION

ITEM#

1" for 3/8 Rod w/nut	DSTR 1	500-850-00220
1 1/4" for 3/8 Rod w/nut	DSTR 516	500-850-00260
1 1/4" for 3/8 Rod	DST 516	500-850-00320
2" for 3/8 Rod	DST 20	500-850-00280
1" Sidewinder for 3/8 Rod w/nut	SWDR 1	500-850-00240
1 1/4" Sidewinder for 3/8 Rod	SWD 516	500-850-00340
1 1/4" Sidewinder for 3/8 Rod w/nut	SWDR 516	500-850-00360
X-Press for Deck 3/8 Rod	XP 20	500-850-00520
Swivel X-Press for Deck 3/8 Rod	SXP 20	500-850-00560
Swivel X-Press for Purlin 3/8 Rod	SXP 35	500-850-00540

SAMMYS® - CONCRETE



The original threaded rod anchoring system is used for vertical suspension of threaded rods within fire protection and other pipe hanging applications. UL/FM approved. The vertical, horizontal and sidewinder models allow you to hang pipe where needed, saving you time and lowering your install costs. Additional models in stock.

SIZE/DESCRIPTION

ITEM#

1 3/4" for 3/8 Rod	CST20	500-850-00440
1 3/4" Sidewinder for 3/8 Rod	SWC20	500-850-00460
3" Drywall Toggle for 3/8 Rod	SST 30	500-850-00480

SAMMYS® - TOOL



Used for the installation of Sammys Threaded Rod Anchors.

SIZE/DESCRIPTION

ITEM#

Drive Socket #14 Vertical Black	500-850-02240
Drive Socket #14 Sidewinder Red	500-850-02260
X-Press It Tool - XPIT	500-850-02300
XPBD 25/64" Drill Bit for XPIT	500-850-02320
Spot Rite Level	100-525-01280

GASKETS - FULL FACED (RED RUBBER)

Lansdale Valve and Manufacturing Full Face Gaskets are 1/8" thick red rubber. For 150 lb pipe flanges.

SIZE	ITEM#
2"	100-300-00790
2½"	100-300-00220
3"	100-300-00240
4"	100-300-00260
6"	100-300-00280
8"	100-300-00810
10"	100-300-00300
12"	100-300-00830



GASKETS - FULL FACED (RED RUBBER)

Lansdale Valve and Manufacturing Ring Gaskets are 1/8" thick red rubber. 150W - Suitable for 125 lb flanges.

SIZE	ITEM#
2"	100-300-00020
2½"	100-300-00040
3"	100-300-00060
4"	100-300-00100
5"	100-300-00120
6"	100-300-00140
8"	100-300-00160
10"	100-300-00180
12"	100-300-00200



GASKETS - NON ASBESTOS - 150 & 300 lb

Lansdale Valve and Manufacturing Full Face Gaskets are Non Asbestos formed. Styled for 150 lb. & 300 lb pipe flanges.



GREEN 150 lb

SIZE	ITEM#
2"	100-275-00700
2½"	100-275-00720
3"	100-275-00740
4"	100-275-00760
6"	100-275-00780
8"	100-275-00800
10"	100-275-00820
12"	100-275-00840

GREEN 300 lb

SIZE	ITEM#
2"	100-275-00880
2½"	100-275-00860
3"	100-275-00900
4"	100-275-00920
6"	100-275-00940
8"	100-275-00960
10"	100-275-00980
12"	100-275-01000

WATERSHIELD

Lansdale Valve and Manufacturing Water Shields are for use in the pendant position. Fits both one or two piece head guards. 4 Inch Sheet Metal.

SIZE	ITEM#
Round	100350-00260
Square	100-350-00240



FLANGE PACKS W/RED RUBBER GASKET

Grade 2 zinc coated hex bolts and nuts with 1/8" thick 150 lb Red rubber ring gaskets. Our Flange Packs can be made with any gaskets we sell; full face or non-asbestos. Enough for one flanged connection.

SIZE	ITEM#
2"	100-275-00020
2½"	100-275-00040
3"	100-275-00060
4"	100-275-00080
5"	100-275-00100
6"	100-275-00120
8"	100-275-00140
10"	100-275-00160
12"	100-275-00180



Full Face, 150 & 300 lb Ring Gasket, 150 & 300 lb Full Face Non-Asbestos Flange Accessory kits also available upon request

WATER METER COUPLING

- Bronze
- Lead Free



SIZE	ITEM#
½" MIP x ¾" FIP	200-225-00200
¾" MIP x 1" FIP	200-225-00220
1" MIP x 1¼" FIP	200-225-00240

WATER METER FLANGE

- Bronze
- Lead Free



SIZE	ITEM#
1½" FIP	200-225-00260
2" FIP	200-225-00280
1½" CxC	200-225-00300
2" CxC	200-225-00320

SPARE HEAD CABINETS



Lansdale Valve and Manufacturing Spare Head Cabinets are constructed with "knockouts" to accommodate specific sized sprinkler heads. Spare Head Cabinets are welded with ½" holes with ¾" knock outs or sizes as noted.

SPRINKLER HEADS NOT INCLUDED

SIZE	ITEM#
3 Head	100-375-00020
6 Head	100-375-00040
12 Head	100-375-00060
6 Head	100-375-00080

- ESFR ¾" Holes w/ 1" Knockouts

SIGHT GLASS

Flow can be viewed through two high impact acrylic windows on either side of the sight glass. Used for sprinkler systems inspectors' test trim. We offer our Bronze Male & Female Sight Glasses in both "full flow" and "restricted orifice" design.



SIZE/DESCRIPTION		ITEM#
1" with 1/2" ORIFICE	M x F	100-450-00020
1" with 1/2" ORIFICE	F x F	100-450-00100
1" with 7/32" ORIFICE	M x F	100-450-00040
1" Full Flow	M x F	100-450-00060
1 1/4" Full Flow	M x F	100-450-00080

BREAK LOCKS

Break shackle locks are to prevent tampering with control valves. Locks are keyed alike to allow easy access to secured valves by authorized personnel. Two keys included with each Lock.



SIZE	ITEM#
Lg/Steel	100-400-00040
Sm/Brass	100-400-00020

HEADGUARDS

Lansdale Valve and Manufacturing Sprinkler Head Guards provide protection from occasional light contact in warehouses, institutional and other applications. Sprinkler head guards do not protect sprinkler heads from direct impact or abuse.

1-PIECE	
Chrome	100-350-00060
Red	100-350-00020
White	100-350-00100

1-PIECE (Semi Recessed)	
Chrome	100-350-00120

2-PIECE CHROME	
1/2"	100-350-00420
3/4"	100-350-00080

2-PIECE RED	
1/2"	100-350-00440
3/4"	100-350-00040

BAFFLE FOR 2-PC	
Red Only	100-350-00220

1-Piece w/BAFFLE RED	
STD	100-350-00160
Short	100-350-00140



BRASS EXTENSIONS

Different lengths designed to ease sprinkler head elevation by eliminating the need to use multiple smaller extensions on one head. (This product is covered by additional disclaimers regarding suitability and use. Purchaser and user take full responsibility for the use of this product. Lansdale Valve and Manufacturing will not be held liable for product failure or damage caused by use.)

SIZE	ITEM#
KNURL	
1/2" X 1/2"	100-125-00020
HEX	
1/2" X 1/2"	100-125-00025
1/2" X 3/4"	100-125-00040
1/2" X 1"	100-125-00060
1/2" X 1 1/2"	100-125-00080
1/2" X 2"	100-125-00100
3/4" X 1/2"	100-125-00120
3/4" X 3/4"	100-125-00140
3/4" X 1"	100-125-00160



STRAINERS

Brass Y Type 50 Mesh

SIZE	ITEM#
1/4"	650-225-05430



ORIFICE UNIONS

1/2" IPS with 3/32" ORIFICE
Brass union with orifice is specifically design for use in the pressure sensing line for fire pump systems.

SIZE	ITEM#
1/2"	100-125-00220



PIPE PAINT MARKERS - MEDIUM POINT

- Outdoor & Indoor use.
- Quick drying.
- Waterproof.
- Highly visible.
- Resists abrasions.
- Fade resistant paint.
- For industrial use only.



COLOR	ITEM#
Yellow	100-425-00020
White	100-425-00040
Red	100-425-00060
Black	100-425-00080
Blue	100-425-00100
Green	100-425-00120
Orange	100-425-00140
Lite Blue	100-425-00141
Lite Green	100-425-00142
Pink	100-425-00143
Silver	100-425-00144

SIGNS

Lansdale Valve and Manufacturing Aluminum Signs are painted white then printed with "fade resistant" red ink and designed in accordance with NFPA Standards. Equipped with 3/16" diameter attaching holes. Each sign is drilled for easy installation. Plastic coated to prevent scratching during shipment and final installation. Custom signs can be made upon request. Please call for more information.

AIR CONTROL	SIZE	DESCRIPTION	ITEM#
AUXILIARY DRAIN	6" X 2"	Air Control	100-475-00600
ANTI-FREEZE SYSTEM	6" X 2"	Auxiliary Drain	100-475-00020
AIR LINE	6" X 2"	Anti-Freeze	100-475-00620
ALARM LINE	6" X 2"	Anti-Freeze System	100-475-00280
ALARM TEST	6" X 2"	Air Line	100-475-00420
	6" X 2"	Alarm Line	100-475-00640
	6" X 2"	Alarm Test	100-475-00200
	6" X 2"	Blank Sign (White W/Red Border)	100-475-00680
	6" X 2"	Blank Sign (Raw Aluminum)	100-475-00660
COMB. STANDPIPE SYSTEM	6" X 2"	Comb. Standpipe System	100-475-00980
CONTROL VALVE	6" X 2"	Control Valve	100-475-00340
	9" X 7"	Control Valve	100-475-00320
	12" X 6"	Curb Valve	100-475-00480
SPRINKLER CONTROL VALVE	6" X 2"	Drain	100-475-01020
	6" X 2"	Do Not Close	100-475-01040
DRAIN	6" X 2"	Drain Valve	100-475-01080
DO NOT CLOSE	6" X 2"	Drum Drip	100-475-00430
	6" X 2"	Dry Standpipe	100-475-01060
	6" X 2"	Entire System	100-475-01100
	6" Rnd	Fire Alarm Bell-Dial 911	100-475-01180
	6" Rnd	Fire Alarm Bell-Call Fire Dept.	100-475-01160
	6" X 2"	Fire Dept Conn	100-475-01220
	6" X 2"	From City Main	100-475-01200
	9" X 7"	Fire Spkr Riser Inside	100-475-01240
	6" X 2"	Fire Spkr Riser Inside	100-475-00425
	6" X 2"	Fire Spkr Valve	100-475-01260
	6" X 2"	Fire Spkr Valve/ Do Not Close	100-475-01280
	5" X 7"	Hydra. Sys Calc Plate - Comm	100-475-00160
	5" X 7"	Hydra. Sys Calc Plate - Comm	100-475-01400
NFPA 13 LONG VERSION			
	8½"X11"	Hydra. Sys Calc Plate - Comm	100-475-02255
INSPECTOR'S TEST	6" X 2"	Inspector's Test	100-475-00180
IN THIS BLDG.	6" X 2"	In This Bldg.	100-475-01440
MAIN DRAIN	6" X 2"	In This Section	100-475-01460
	6" X 2"	Main Control	100-475-00380
NORMALLY CLOSED	6" X 2"	Main Drain	100-475-00120
NORMALLY OPEN	6" X 2"	Normally Closed	100-475-01480
MAIN CONTROL	6" X 2"	Normally Open	100-475-01500
OPEN SPKR. DRAIN	6" X 2"	Open Spkr. Control	100-475-01520
SPKR. CONTROL ROOM	6" X 2"	Open Spkr Drain	100-475-01540
	6" X 2"	Spkr. Control Room	100-475-01560
	6" X 2"	Spkr. Control Valve	100-475-01580
	9" X 7"	Sprinkler Fire Alarm-CALL 911	100-475-01170
	9" X 7"	Sprinkler Fire Alarm-Call Fire Dept	100-475-00240
	6" X 2"	Sprinkler Riser	100-475-01600
	6" X 2"	Sprinkler Riser Room	100-475-01610
	5" X 7"	Sprinkler Sys "General Info"	100-475-01620

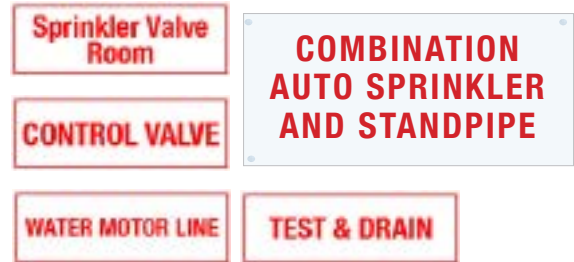

SIZE	DESCRIPTION	ITEM#
6" X 2"	Standpipe System	100-475-00220
6" X 2"	Spkr Valve Room	100-475-00260
6" X 2"	Spkr Valve	100-475-01820
6" X 2"	Test & Drain	100-475-00300
6" X 2"	Test Valve	100-475-00400
8" X 1¼"	Valve Shut	100-475-00140
4" X 6"	Valve Controls Auto Sprinkler	100-475-01000
5" X 7"	Warning - "Multi Use"	100-475-01910
6" X 2"	Water Motor Line	100-475-00360
6" X 2"	Wet Standpipe	100-475-01760
12" X 6"	Auto Spkr Shut Off Valve	100-475-00520
12" X 6"	Auto Spkr / Standpipe	100-475-00560
12" X 8"	Standpipe Sign	100-475-00540
12" X 10"	Siamese Conn For Fire Dept	100-475-00442
12" X 10"	Sprinklers Throughout Bldg	100-475-00462
12" X 10"	Blank (White W/Red Border)	100-475-00580

STICKERS / DECALS

3"	Round - Do Not Hang	100-475-02020
6" X 2"	Fire Sprinkler Line	100-475-00060
6" X 2"	Auxiliary Drain	100-475-01920
6" X 2"	Control Valve	100-475-00100
6" X 2"	Inspectors Test	100-475-00080
6" X 2"	Main Drain	100-475-02160
6" X 2"	Fire Sprinkler Riser	100-475-02040
5" X 7"	Commercial Calc Sticker	100-475-02100

SIGN CHAIN

Lansdale Valve and Manufacturing sign chains are Zinc plated for corrosion resistance & suitable for use in exposed areas.

100'	#16 ZINC Jack Chain	100-475-02260
250'	#16 ZINC Jack Chain	100-475-02280



PILOT CLAMP & PARTS



Lansdale Valve and Manufacturing Pilot Clamp (Complete Kit) is used to drill/cut holes for mechanical tee's, crosses, welded outlets, thread-o-lets, and detection devices (flow switch and pressure switches).

Kit Includes:

- Pilot Clamp® with levels
- Carrying case
- Two Lenox® arbors
- Pilot bit
- Six Lenox® Bi-Metal hole saws
- Six interchangeable hole saw guides:
- Hole size chart (1", 1 3/16", 1 1/4", 1 1/2", 1 3/4", and 2")

Design Features And Benefits:

- Cuts a cleaner hole with no wobble in tight cramped areas
- No special drills needed
- Save money with extended hole saw life
- Increases the diameter of an existing hole (replacement of flow switches)

DESCRIPTION	ITEM#
Pilot Clamp (Complete Kit)	100-525-00740
Clamp ONLY - w/ Head & Jaw	100-525-00940
Replacement Head	100-525-00880
Replacement Jaw	100-525-00900
Replacement Level	100-525-00920
1" Replacement Guide	100-525-00760
1 3/16" Replacement Guide	100-525-00780
1 1/4" Replacement Guide	100-525-00800
1 1/2" Replacement Guide	100-525-00820
1 3/4" Replacement Guide	100-525-00840
2" Replacement Guide	100-525-00860

HOLE SAWS



Black Belt Hole Saws are Bi-Metal made with 8% Cobalt Tooth Tip. Performs 13/8" Depth cuts through 2" x 4" in one easy pass. Cuts holes in wood, plastic, or any machinable metal, including nail-embedded wood, plywood, pipe, and stainless steel.

- Reduced vibration
- Deep Gullet design, for improved chip removal
- Faster cutting allows for more holes per saw

DESCRIPTION	SIZE	ITEM#
Hole Saw	1"	100-525-00180
Hole Saw	1 3/8"	100-525-00220
Hole Saw	1 1/4"	100-525-00300
Hole Saw	1 3/16"	100-525-00240
Hole Saw	1 3/8"	100-525-00260
Hole Saw	1 1/2"	100-525-00320
Hole Saw	1 3/4"	100-525-00360
Hole Saw	2"	100-525-00380
Hole Saw	2 1/8"	100-525-00400
Hole Saw	2 1/4"	100-525-00420
Hole Saw	2 1/2"	100-525-00440
Hole Saw	2 3/4"	100-525-00480
Hole Saw	3"	100-525-00520
Hole Saw	3 1/2"	100-525-00580
Hole Saw	4"	100-525-00640
Hole Saw	4 1/2"	100-525-00700
Arbor	A-1	100-525-00020
Arbor	A-2	100-252-00060
Arbor A-10 (Quick Hitch)		100-525-00040
Pilot Bit	1/4"	100-525-00080

ALL THREAD CHASER

Designed to chase damaged hanger rod threads. Quickly chase the damaged thread after cutting rod with a bolt cutter.

DESCRIPTION

3/8" All Thread Rod Chaser

ITEM#

100-525-01385



POST INDICATOR WRENCH

Lansdale Valve and Manufacturing Post Indicator Wrench is a Universal Post Indicator Valve Wrench. One wrench fits most indicator posts. Tamper-proof slide nut adjusts to desired location and locks into place.

DESCRIPTION

Adjustable Wrench for PIV

ITEM#

100-525-02000



HYDRANT & SPINNER WRENCHES

Heavy Duty Hydrant Wrench 350-125-02092

Lansdale Valve and Manufacturing Heavy Duty Adjustable Hydrant Wrench is equipped with a malleable iron head 7/8" and a plated steel handle. It is used for pentagon hydrant nuts up to 1 3/4" from point to flat. The Spanner is used with pin lug or rocker lug couplings 1 1/2" – 6".

Hose and Hydrant Wrench 350-125-02094

Lansdale Valve and Manufacturing Combo Spanner Wrench comes in Cast Aluminum

- Combination 1 1/2" (38mm) and 2 1/2" (65mm) Coupling Spanner
- For use on rocker lug or pin lug

Combo Spanner for 1 1/2" & 2 1/2" 350-125-02090

Lansdale Valve and Manufacturing Adjustable Hose and Hydrant Wrench is a cast plated malleable iron head with a 1/2" plated steel handle.

- Adjustable for Pentagon nuts up to 1 3/4"
- Built in spanner for rocker lug or pin lug couplings



HYDROSTATIC TEST PUMP

- 1/2 H.P. Ball bearing motor (115V) with capacitor starting
- All brass pipe and fittings, up to 300 psi operating design
- Check valve holds system pressure if pump is unplugged
- Liquid-filled pressure gauge positioned on system-side of check valve for convenient reading
- Sturdy, easy-carry handle, carrying weight only 32 lbs
- Furnished with 10 ft. of hose with a quick-disconnect and check valve
- Suction-side strainer to minimize the potential of plugging

DESCRIPTION

HT-90E Test Pump

ITEM#

100-525-01220



SET TOOL

Setting tool for drop-in anchors.

DESCRIPTION

3/8" Setting Tool

ITEM#

100-525-01320

1/2" Setting Tool

100-525-01300



GROOVING WHEEL

Lansdale Valve and Manufacturing Grooving wheel is used to make roll grooves in the field and can replace the cutting wheel on select pipe cutters.

DESCRIPTION

Roll Groove Wheel

ITEM#

100-525-01140



TEFLON TAPE

Lansdale Valve and Manufacturing thread sealing tape is made from pure virgin Teflon.

- Manufactured to ML SPEC T27730A
- Teflon® is a registered trademark of E.I. Dupont

DESCRIPTION	ITEM#
1/2" x 520"	100-500-00020
3/4" x 520"	100-500-00040



PIPE DOPE

Lansdale Valve and Manufacturing Pipe Dope is a Power Plus Thread Sealant Paste w/ PTFE. Formulated as a low cost, high performance thread sealant. Now FBC approved for use with CPVC.

DESCRIPTION	ITEM#
1 Qt Brush Top	250-250-00240
1 Qt Metal Can	250-250-00280
1 Qt Screw Top	250-250-00260
1 Gal Friction Top	250-250-00300
5 Gal Friction Top	250-250-00320
55 Gal Friction Top	250-250-00340



ANAEROBIC PIPE SEALANT - BRECCO

Brecco Sealant uses anaerobic technology to prevent leaks in sprinkler system fabrication and improve installation in the field. Unlike traditional pipe dope, this sealant cures to a plastic seal initiated by the presence of metal and the absence of air.

- Allows disassembly with normal tools
- Easy to clean excess with soap and water
- 100% leak-free seal
- Eliminates repair costs due to call-backs
- Seals cuts and misthreaded fittings
- Will not dry out when container is left open
- Will not thin in summer or thicken in winter
- Replaces pipe dope and sealing tapes
- UL Listed



DESCRIPTION	ITEM#
250 MI - Tube	250-250-00020
750 ml - Friction Top	250-250-00040
1 Quart - Friction Top	250-250-00060

CUTTING OIL - DARK

Brecco Cutting Oil extends threading machine die life and the quality of the threads. Has several times the film strength of ordinary cutting oils. Its high percentage of sulfur and chlorine absorbs and radiates heat. It is positively non-gumming.

DESCRIPTION	ITEM#
1 Gal (Jug)	250-200-00020
5 Gal (Pail)	250-200-00040
55 Gal (Drum)	250-200-00060



PIPE DOPE

Lansdale Valve and Manufacturing Weld Seal is a porosity sealant applicable to most metallic surfaces. Seals "pin hole" leaks. Used for quality control after welding. Low cost, high performance sealant.

DESCRIPTION	ITEM#
50 MI Bottle	250-250-00015
250 MI Bottle	250-250-00420
1 Liter Bottle	250-250-00440



COUPLING GREASE - PIPE LUBE

Lansdale Valve and Manufacturing's Phoenix Coupling Grease eases the installation of mechanical fittings. Specifically designed for mechanical couplings. Will not dry out or freeze in normal applications. Now FBC approved for use with CPVC.

DESCRIPTION	ITEM#
1 QT	250-150-00040





BLACK 1/8" - 6"

Size	Close Length	Close	1-1/2"	2"	2-1/2"	3"	3-1/2"	4"	4-1/2"	5"	5-1/2"	6"
1/8"	3/4"	3.31	4.02	4.02	4.74	4.74	5.68	5.68	10.74	10.74	11.85	11.85
1/4"	7/8"	3.95	4.20	4.20	5.44	5.44	6.24	6.24	9.48	9.48	11.22	11.22
3/8"	1"	4.02	4.58	4.58	5.93	5.93	6.94	6.94	9.95	9.95	11.07	11.07
1/2"	1-1/8"	3.39	3.39	3.39	4.02	4.02	4.91	4.91	5.68	5.68	6.33	6.33
3/4"	1-3/8"	3.96	4.20	4.20	4.74	4.74	5.93	5.93	7.44	7.44	8.38	8.38
1"	1-1/2"	5.68	-	6.23	6.55	6.55	8.22	8.22	9.63	9.63	11.46	11.46
1-1/4"	1-5/8"	7.18	-	8.14	8.69	8.69	10.28	10.28	12.24	12.24	14.55	14.55
1-1/2"	1-3/4"	8.93	-	9.63	10.74	10.74	12.09	12.09	14.79	14.79	16.91	16.91
2"	2"	12.17	-	-	13.97	13.97	16.91	16.91	19.52	19.52	22.83	22.83
2-1/2"	2-1/2"	38.09	-	-	-	39.03	45.91	45.91	50.42	50.42	52.62	52.62
3"	2-5/8"	45.20	-	-	-	49.14	58.22	58.22	64.15	64.15	69.77	69.77
3-1/2"	2-3/4"	69.05	-	-	-	-	86.05	86.05	99.16	99.16	111.40	111.40
4"	2-7/8"	68.10	-	-	-	-	78.76	78.76	89.90	89.90	96.15	96.15
5"	3"	184.56	-	-	-	-	197.82	197.82	216.38	216.38	237.33	237.33
6"	3-1/8"	207.46	-	-	-	-	217.99	217.99	244.11	244.11	270.74	270.74
8"		422.67	-	-	-	-	-	481.69	481.69	481.69	570.08	570.08

BLACK 6 1/2" - 12"

Size	6-1/2"	7"	7-1/2"	8"	8-1/2"	9"	9-1/2"	10"	10-1/2"	11"	11-1/2"	12"
1/8"	16.28	16.28	16.28	16.28	18.57	18.57	18.57	18.57	18.97	18.97	18.97	18.97
1/4"	17.23	17.23	17.23	17.23	20.23	20.23	20.23	20.23	22.29	22.29	22.29	22.29
3/8"	19.52	19.52	19.52	19.52	21.88	21.88	21.88	21.88	24.90	24.90	24.90	24.90
1/2"	11.37	11.37	11.37	11.37	13.74	13.74	13.74	13.74	16.28	16.28	16.28	16.28
3/4"	13.97	13.97	13.97	13.97	16.20	16.20	16.20	16.20	18.10	18.10	18.10	18.10
1"	18.64	18.64	18.64	18.64	21.79	21.79	21.79	21.79	25.03	25.03	25.03	25.03
1-1/4"	23.47	23.47	23.47	23.47	28.13	28.13	28.13	28.13	31.84	31.84	31.84	31.84
1-1/2"	26.86	26.86	26.86	26.86	31.44	31.44	31.44	31.44	36.26	36.26	36.26	36.26
2"	38.15	38.15	38.15	38.15	44.86	44.86	44.86	44.86	51.67	51.67	51.67	51.67
2-1/2"	66.91	66.91	66.91	66.91	75.21	75.21	75.21	75.21	83.59	83.59	83.59	83.59
3"	94.09	94.09	94.09	94.09	105.70	105.70	105.70	105.70	117.25	117.25	117.25	117.25
3-1/2"	126.41	126.41	126.41	126.41	138.89	138.89	138.89	138.89	156.51	156.51	156.51	156.51
4"	111.00	111.00	111.00	111.00	126.41	126.41	126.41	126.41	148.13	148.13	148.13	148.13
5"	282.75	282.75	282.75	282.75	324.08	324.08	324.08	324.08	377.87	377.87	377.87	377.87
6"	326.28	326.28	326.28	326.28	377.87	377.87	377.87	377.87	444.87	444.87	444.87	444.87
8"	766.96	766.96	766.96	766.96	825.82	825.82	825.82	825.82	983.12	983.12	983.12	983.12



• Black Standard Weight Nipples
Nominal Pipe Size: 1/8" - 8"
Nominal Length: Close - 12"

• Black Extra Long Nipples
Nominal Pipe Size: 1/8" - 2"
Nominal Length: 18" - 12"

• Custom Nipples
Any length as specified

• Butt Nipples
Nominal Pipe Size: 1/8" - 4"

• Tank Nipples
Nominal Pipe Size: 1/8" - 2"

GALVANIZED 1/8" - 6"

Size	Close Length	Close	1-1/2"	2"	2-1/2"	3"	3-1/2"	4"	4-1/2"	5"	5-1/2"	6"
1/8"	3/4"	4.11	5.75	5.75	7.59	7.59	8.93	8.93	15.09	15.09	16.91	16.91
1/4"	7/8"	4.43	5.22	5.22	6.79	6.79	8.14	8.14	11.06	11.06	12.41	12.41
3/8"	1"	4.80	5.52	5.52	7.43	7.43	8.77	8.77	12.09	12.09	13.42	13.42
1/2"	1-1/8"	3.95	4.11	4.11	4.91	4.91	5.99	5.99	7.18	7.18	8.22	8.22
3/4"	1-3/8"	4.74	5.14	5.14	5.68	5.68	7.43	7.43	8.77	8.77	10.60	10.60
1"	1-1/2"	6.55	-	7.67	8.30	8.30	9.96	9.96	12.24	12.24	13.91	13.91
1-1/4"	1-5/8"	8.77	-	9.47	10.28	10.28	12.24	12.24	15.16	15.16	17.61	17.61
1-1/2"	1-3/4"	10.28	-	10.98	12.24	12.24	15.49	15.49	18.72	18.72	21.02	21.02
2"	2"	14.37	-	-	16.20	16.20	19.66	19.66	25.21	25.21	29.22	29.22
2-1/2"	2-1/2"	42.89	-	-	-	44.56	51.74	51.74	57.68	57.68	63.36	63.36
3"	2-5/8"	51.43	-	-	-	58.53	68.64	68.64	79.95	79.95	84.62	84.62
3-1/2"	2-3/4"	90.61	-	-	-	-	93.69	93.69	109.89	109.89	118.27	118.27
4"	2-7/8"	77.03	-	-	-	-	92.12	92.12	103.26	103.26	114.15	114.15
5"	3"	369.18	-	-	-	-	395.50	395.50	432.78	432.78	474.40	474.40
6"	3-1/8"	414.77	-	-	-	-	436.48	436.48	488.64	488.64	541.49	541.49
8"		845.49	-	-	-	-	-	963.37	963.37	963.37	1140.49	1140.49

GALVANIZED 6 1/2" - 12"

Size	6-1/2"	7"	7-1/2"	8"	8-1/2"	9"	9-1/2"	10"	10-1/2"	11"	11-1/2"	12"
1/8"	22.29	22.29	22.29	22.29	26.22	26.22	26.22	26.22	29.00	29.00	29.00	29.00
1/4"	21.18	21.18	21.18	21.18	24.66	24.66	24.66	24.66	27.41	27.41	27.41	27.41
3/8"	21.48	21.48	21.48	21.48	25.60	25.60	25.60	25.60	28.37	28.37	28.37	28.37
1/2"	14.31	14.31	14.31	14.31	17.05	17.05	17.05	17.05	19.35	19.35	19.35	19.35
3/4"	18.34	18.34	18.34	18.34	20.30	20.30	20.30	20.30	22.83	22.83	22.83	22.83
1"	23.23	23.23	23.23	23.23	26.54	26.54	26.54	26.54	30.89	30.89	30.89	30.89
1-1/4"	28.45	28.45	28.45	28.45	34.06	34.06	34.06	34.06	40.85	40.85	40.85	40.85
1-1/2"	32.63	32.63	32.63	32.63	38.09	38.09	38.09	38.09	43.54	43.54	43.54	43.54
2"	47.63	47.63	47.63	47.63	55.70	55.70	55.70	55.70	63.91	63.91	63.91	63.91
2-1/2"	81.52	81.52	81.52	81.52	92.91	92.91	92.91	92.91	103.97	103.97	103.97	103.97
3"	113.92	113.92	113.92	113.92	129.96	129.96	129.96	129.96	146.08	146.08	146.08	146.08
3-1/2"	139.84	139.84	139.84	139.84	166.54	166.54	166.54	166.54	190.24	190.24	190.24	190.24
4"	136.21	136.21	136.21	136.21	157.93	157.93	157.93	157.93	179.73	179.73	179.73	179.73
5"	565.28	565.28	565.28	565.28	648.47	648.47	648.47	648.47	755.59	755.59	755.59	755.59
6"	652.63	652.63	652.63	652.63	756.23	756.23	756.23	756.23	889.49	889.49	889.49	889.49
8"	1533.61	1533.61	1533.61	1533.61	1651.64	1651.64	1651.64	1651.64	1966.07	1966.07	1966.07	1966.07



• Galvanized Standard Weight Nipples
Nominal Pipe Size: 1/8" - 8"
Nominal Length: Close - 12"

• Galvanized Extra Long Nipples
Nominal Pipe Size: 1/8" - 2"
Nominal Length: 18" - 12"

• Grooved Nipples
Nominal Pipe Size: 1 1/4" - 10"
Black & Galvanized Available
Lengths as specified

• Right and Left Nipples
Nominal Pipe Size: 1/8" - 4"
Nominal Length: 4" & 6"

LW FLEXIBLE COUPLINGS

ITEM	SIZE
400-210-04220	1-1/2"
400-210-04240	2"
400-210-04260	2-1/2"
400-210-04280	3"
400-210-04300	4"
400-210-04320	5"
400-210-04340	6"
400-210-04360	8"



GROOVED FLANGE

ITEM	SIZE	GALVANIZED
400-210-02960	2"	
400-210-02980	2-1/2"	
400-210-03000	3"	
400-210-03020	4"	400-210-06440
400-210-03040	5"	
400-210-03060	6"	400-210-06460
400-210-03080	8"	
400-210-03100	10"	



RIGID GROOVED COUPLINGS

ITEM	SIZE	GALVANIZED
400-210-00020	1"	
400-210-00040	1-1/4"	400-210-05020
400-210-00060	1-1/2"	400-210-05020
400-210-00080	2"	400-210-05060
400-210-00100	2-1/2"	400-210-05080
400-210-00120	3"	400-210-05100
400-210-00160	4"	400-210-05120
400-210-00180	5"	
400-210-00200	6"	400-210-05160
400-210-00220	8"	400-210-05180
400-210-00240	10"	
400-210-00245	12"	



GROOVED CAPS

ITEM	SIZE	GALVANIZED
400-210-02660	1"	
400-210-02680	1-1/4"	
400-210-02700	1-1/2"	400-210-05800
400-210-02720	2"	400-210-05820
400-210-02740	2-1/2"	400-210-05840
400-210-02760	3"	400-210-05860
400-210-02800	4"	400-210-05880
400-210-02820	5"	
400-210-02840	6"	400-210-05900
400-210-02860	8"	



REDUCING COUPLINGS

ITEM	SIZE	GALVANIZED
400-210-00260	2"x1-1/2"	
400-210-00280	2-1/2"x 2"	400-210-06300
400-210-00300	3"x2"	400-210-06320
400-210-00320	3"x2-1/2"	400-210-06340
400-210-00340	4"x2"	
400-210-00360	4"x2-1/2"	400-210-06380
400-210-00380	4"x3"	400-210-06400
400-210-00420	6"x4"	400-210-06420
400-210-00460	8"x6"	



THREADED MECHANICAL TEE

ITEM	SIZE	GALVANIZED
400-210-01580	2 x 1	400-210-05930
400-210-01600	2 x 1-1/4	400-210-05940
400-210-01620	2 x 1-1/2	
400-210-01640	2-1/2 x 1	400-210-05960
400-210-01660	2-1/2 x 1-1/4	400-210-05980
400-210-01680	2-1/2 x 1-1/2	400-210-06000
400-210-01700	3 x 1	400-210-06020
400-210-01720	3 x 1-1/4	400-210-06040
400-210-01740	3 x 1-1/2	400-210-06060
400-210-01760	3 x 2	400-210-06080
400-210-01780	4 x 1	400-210-06100
400-210-01800	4 x 1-1/4	400-210-06120
400-210-01820	4 x 1-1/2	400-210-06140
400-210-01840	4 x 2	400-210-06160
400-210-01860	4 x 2-1/2	400-210-06180
400-210-01880	4 x 3	
400-210-01900	5 x 1-1/2	
400-210-01920	5 x 2	
400-210-01980	6 x 1-1/4	
400-210-02000	6 x 1-1/2	400-210-06200
400-210-02020	6 x 2	
400-210-02040	6 x 2-1/2	400-210-06260
400-210-02060	6 x 3	
400-210-02100	8 x 2	
400-210-02120	8 x 2-1/2	
400-210-02160	8 x 4	



GROOVED TEE - STANDARD RADIUS

ITEM	SIZE	GALVANIZED
400-210-01360	1-1/4"	
400-210-01380	1-1/2"	400-210-05640
400-210-01400	2"	400-210-05660
400-210-01420	2-1/2"	400-210-05680
400-210-01440	3"	400-210-05700
400-210-01480	4"	400-210-05720
400-210-01500	5"	
400-210-01520	6"	400-210-05760
400-210-01540	8"	400-210-05780
400-210-01560	10"	
400-210-01570	12"	



GROOVED TEE - SHORT RADIUS

ITEM	SIZE	GALVANIZED
400-210-04080	1-1/2"	
400-210-04100	2"	400-210-05783
400-210-04120	2-1/2"	400-210-05784
400-210-04140	3"	400-210-05785
400-210-04160	4"	400-210-05786
400-210-04180	6"	400-210-05787
400-210-04200	8"	



GROOVED MECHANICAL TEE

ITEM	SIZE
400-210-02180	2-1/2 x 1-1/4
400-210-02200	2-1/2 x 1-1/2
400-210-02220	3 x 1-1/4
400-210-02240	3 x 1-1/2
400-210-02260	3 x 2
400-210-02280	4 x 1-1/4
400-210-02300	4 x 1-1/2
400-210-02320	4 x 2
400-210-02340	4 x 2-1/2
400-210-02360	4 x 3
400-210-02400	5 x 2
400-210-02440	5 x 3
400-210-02460	6 x 1-1/4
400-210-02480	6 x 1-1/2
400-210-02500	6 x 2
400-210-02520	6 x 2-1/2
400-210-02540	6 x 3
400-210-02560	6 x 4
400-210-02580	8 x 2
400-210-02600	8 x 2-1/2
400-210-02620	8 x 3
400-210-02640	8 x 4



GROOVED REDUCING TEE

ITEM	SIZE
400-210-04580	2-1/2 x 2-1/2 x 2
400-210-04600	3 x 3 x 2
400-210-04620	3 x 3 x 2-1/2
400-210-04680	4 x 4 x 2
400-210-04700	4 x 4 x 2-1/2
400-210-04720	4 x 4 x 3
400-210-04760	5 x 5 x 3
400-210-04780	5 x 5 x 4
400-210-04800	6 x 6 x 2
400-210-04820	6 x 6 x 2-1/2
400-210-04840	6 x 6 x 3
400-210-04860	6 x 6 x 4
400-210-04960	8 x 8 x 4



GROOVED CROSS

ITEM	SIZE
400-210-03620	2"
400-210-03640	2-1/2"
400-210-03660	3"
400-210-03680	4"
400-210-03720	6"
400-210-03740	8"



GROOVED ELBOWS 90° - STANDARD RADIUS

ITEM	SIZE	GALVANIZED
400-210-00500	1-1/4"	400-210-05280
400-210-00520	1-1/2"	400-210-05300
400-210-00540	2"	400-210-05320
400-210-00560	2-1/2"	400-210-05340
400-210-00580	3"	400-210-05360
400-210-00620	4"	400-210-05380
400-210-00640	5"	
400-210-00660	6"	400-210-05420
400-210-00680	8"	400-210-05440
400-210-00700	10"	
400-210-00720	12"	



GROOVED ELBOWS 45° - STANDARD RADIUS

ITEM	SIZE	GALVANIZED
400-210-00740	1-1/4"	
400-210-00760	1-1/2"	
400-210-00780	2"	400-210-05460
400-210-00800	2-1/2"	400-210-05480
400-210-00820	3"	400-210-05500
400-210-00860	4"	400-210-05520
400-210-00880	5"	
400-210-00900	6"	400-210-05560
400-210-00920	8"	
400-210-00940	10"	
400-210-00950	12"	



GROOVED ELBOWS 90° - SHORT RADIUS

ITEM	SIZE	GALV
400-210-03760	1-1/2"	
400-210-03780	2"	400-210-05444
400-210-03800	2-1/2"	400-210-05445
400-210-03820	3"	400-210-05446
400-210-03840	4"	400-210-05447
400-210-03860	6"	400-210-05448
400-210-03880	8"	



GROOVED ELBOWS 22-1/2°

ITEM	SIZE	
400-210-00960	2"	GRV
400-210-00980	2-1/2"	GRV
400-210-01000	3"	GRV
400-210-01040	4"	GRV
400-210-01080	6"	GRV
400-210-01100	8"	GRV



GROOVED CONCENTRIC REDUCER

ITEM	SIZE
400-210-03120	2 x 1
400-210-03140	2 x 1-1/4
400-210-03160	2 x 1-1/2
400-210-03180	2-1/2 x 1-1/2
400-210-03200	2-1/2 x 2
400-210-03240	3 x 2
400-210-03260	3 x 2-1/2
400-210-03320	4 x 2
400-210-03340	4 x 2-1/2
400-210-03360	4 x 3
400-210-03400	5 x 4
400-210-03420	6 x 2
400-210-03440	6 x 3
400-210-03460	6 x 4
400-210-03480	6 x 5
400-210-03500	8 x 3
400-210-03520	8 x 4
400-210-03540	8 x 5
400-210-03560	8 x 6
400-210-03580	10 x 6
400-210-03600	10 x 8



GROOVED ELBOWS 11-1/4°

ITEM	SIZE	
400-210-01120	1-1/2"	GRV
400-210-01140	2"	GRV
400-210-01160	2-1/2"	GRV
400-210-01180	3"	GRV
400-210-01200	4"	GRV
400-210-01220	6"	



GROOVED END OF RUN FITTING

ITEM	SIZE
400-210-06480	1-1/4 x 1/2
400-210-06500	1-1/4 x 3/4
400-210-06520	1-1/4 x 1
400-210-06540	1-1/2 x 1/2
400-210-06560	1-1/2 x 3/4
400-210-06580	1-1/2 x 1
400-210-06620	2 x 3/4
400-210-06640	2 x 1
400-210-06680	2-1/2 x 3/4
400-210-06700	2-1/2 x 1



90° ELBOW

SIZE	ITEM#
1" X 1/2"	400-150-00150
1" X 3/4"	400-150-00160
1"	400-150-00010
1 1/4" X 1/2"	400-150-00170
1 1/4" X 3/4"	400-150-00180
1 1/4" X 1"	400-150-00190
1 1/4"	400-150-00020
1 1/2" X 1"	400-150-00200
1 1/2" X 1 1/4"	400-150-00210
1 1/2"	400-150-00030
2 X 1/2"	400-150-00220
2 X 3/4"	400-150-00230
2 X 1"	400-150-00240
2 X 1 1/4"	400-150-00250
2 X 1 1/2"	400-150-00260
2"	400-150-00040



45° ELBOW

SIZE	ITEM#
1"	400-150-00110
1 1/4"	400-150-00120
1 1/2"	400-150-00130
2"	400-150-00140



CROSS

SIZE	ITEM#
1"	400-150-00270
1 1/4"	400-150-00280
1 1/2"	400-150-00290
2"	400-150-00300



REDUCING CROSS

SIZE	ITEM#
1 1/4" x 1 1/4" x 1" x 1"	400-150-00310
1 1/2" x 1 1/2" x 1" x 1"	400-150-00320
2" x 2" x 1" x 1"	400-150-00330

CAPS

SIZE	ITEM#
1"	400-150-00460
1 1/4"	400-150-00470
1 1/2"	400-150-00480
2"	400-150-00490



COUPLING

SIZE	ITEM#
1"	400-150-00420
1 1/4"	400-150-00430
1 1/2"	400-150-00440
2"	400-150-00450
1 X 1/2"	400-150-00050
1 X 3/4"	400-150-00060



BUSHINGS

SIZE	ITEM#
1" x 1/2"	400-150-00500
1" x 3/4"	400-150-00510
1 1/4" x 1"	400-150-00520
1 1/2" x 1"	400-150-00535
1 1/2" x 1 1/4"	400-150-00530
2" x 1"	400-150-00540
2" x 1 1/4"	400-150-00550
2" x 1 1/2"	400-150-00560



TEES

1" x 1/2" x 1"	400-150-00570
1" x 3/4" x 1"	400-150-00580
1" x 1" x 1/2"	400-150-00590
1" x 1" x 3/4"	400-150-00600
1"	400-150-00070
1" x 1" x 1 1/4"	400-150-00340
1" x 1" x 1 1/2"	400-150-00350
1 1/4" x 1" x 1/2"	400-150-00610
1 1/4" x 1" x 3/4"	400-150-00620
1 1/4" x 1" x 1"	400-150-00630
1 1/4" x 1" x 1 1/4"	400-150-00640
1 1/4" x 1" x 1 1/2"	400-150-00360
1 1/4" x 1 1/4" x 1/2"	400-150-00650
1 1/4" x 1 1/4" x 3/4"	400-150-00660
1 1/4" x 1 1/4" x 1"	400-150-00370
1 1/4"	400-150-00080
1 1/4" x 1 1/4" x 1 1/2"	400-150-00380
1 1/4" x 1 1/4" x 2"	400-150-00390
1 1/2" x 1" x 1/2"	400-150-00680
1 1/2" x 1" x 3/4"	400-150-00690
1 1/2" x 1" x 1"	400-150-00700
1 1/2" x 1" x 1 1/4"	400-150-00710
1 1/2" x 1" x 1 1/2"	400-150-00720
1 1/2" x 1 1/4" x 1/2"	400-150-00730
1 1/2" x 1 1/4" x 3/4"	400-150-00740
1 1/2" x 1 1/4" x 1"	400-150-00750
1 1/2" x 1 1/4" x 2"	400-150-00400
1 1/2" x 1 1/2" x 1/2"	400-150-00760
1 1/2" x 1 1/2" x 3/4"	400-150-00770
1 1/2" x 1 1/2" x 1"	400-150-00780
1 1/2" x 1 1/2" x 1 1/4"	400-150-00790
1 1/2"	400-150-00090
1 1/2" x 1 1/2" x 2"	400-150-00410
2" x 1" x 2"	400-150-00800
2" x 1 1/4" x 2"	400-150-00810
2" x 1 1/2" x 1/2"	400-150-00820
2" x 1 1/2" x 3/4"	400-150-00830
2" x 1 1/2" x 1"	400-150-00840
2" x 1 1/2" x 1 1/4"	400-150-00850
2" x 1 1/2" x 1 1/2"	400-150-00860
2" x 1 1/2" x 2"	400-150-00870
2" x 2" x 1/2"	400-150-00880
2" x 2" x 3/4"	400-150-00890
2" x 2" x 1"	400-150-00900
2" x 2" x 1 1/4"	400-150-00910
2" x 2" x 1 1/2"	400-150-00920
2"	400-150-00100

