

NON-SKID TEXTURED
BOTTOM SURFACE

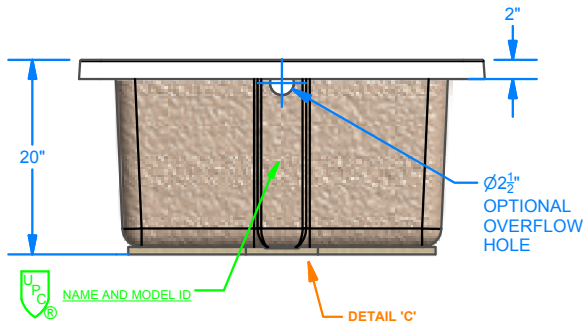

DETAIL 'C'

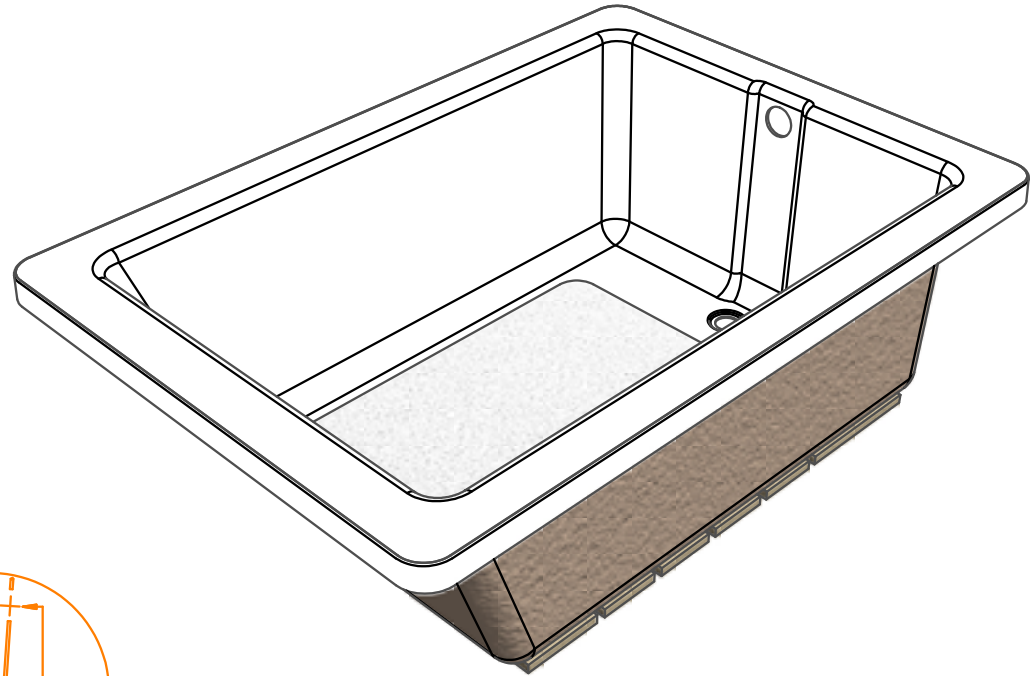

NOTES:

THIS UNIT IS IAPMO LISTED.

- 1ST LAMINATE MADE FROM DUPONT ACRYLIC.
- REINFORCED BY GLASS AND POLYESTER COMPOSITE.
- BOTTOM REINFORCED WITH WOOD TO MEET 300# LOAD TEST.
- 2ND LAMINATE COVERS ALL REINFORCEMENTS PLUS .100" ADDED TO UNREINFORCED AREAS.
- ¼" PER FT. TO SLOPE.



UNIT PART NUMBERS		UNLESS OTHERWISE SPECIFIED TOLERANCES ARE AS FOLLOWS		Fiber Care Baths, Inc.			
RIGHT HAND UNIT	ART60-42DI	DECIMAL:	FRACTIONAL: $\pm \frac{1}{16}$ "	TITLE: ACRYLIC RECTANGULAR TUB, DROP IN			
LEFT HAND UNIT	ART60-42DI	.XX = +.010 .XXX = +.005	ANGULAR: $\pm \frac{1}{2}^\circ$				
<small>THE INFORMATION CONTAINED IN THIS DRAWING IS THE SOLE PROPERTY OF FIBER CARE BATHS, INC. ANY REPRODUCTION OR UNAUTHORIZED USE IN PART OR AS A WHOLE WITHOUT THE WRITTEN PERMISSION OF FIBER CARE BATHS, INC. IS STRICTLY PROHIBITED. PRODUCT CONFIGURATION, DIMENSIONS, STANDARD ACCESSORIES, MATERIALS COMPOSITION AND CONSTRUCTION ARE SUBJECT TO CHANGE WITHOUT NOTICE.</small>		CAPACITY / OPERATING LEVEL:		GAL	DRAWN: DANIEL SIZE: A MODEL #: ART60-42DI REV A		
		CAPACITY / OVERFLOW LEVEL:		GAL			
		APPROX. UNIT WEIGHT:		LBS	DATE: 1/28/2013 SCALE: NTS STATUS: IAPMO LISTED		
		APPROX. SHIPPING WEIGHT:		LBS			

9832 Yucca Rd.
Adelanto, CA 92301
Phone: 760-246-0019
Fax: 760-246-5189