



TOLCO Fig. 29 series size range expansion

Double offset hanger and restrainer for CPVC plastic pipe & IPS steel pipe

The TOLCO™ Fig. 29 is designed as a hanger and restrainer for CPVC applications such as plastic fire sprinkler pipe. It provides a double offset from mounting surface to help eliminate abrasion, plus its unique design eliminates the need for wood block extension, allowing for retrofit attachment of hanger to the sprinkler pipe.

And now, in addition to the existing ¾" and 1" sizes, the Fig. 29 includes a 1¼" solution to round out the Fig. 29 product size offering. The addition of the 1¼" size provides hanger and restrainer solutions for larger size CPVC pipe installations and projects leading to gained efficiency and cost savings.

Part No.	Pipe Size in. (mm)	Approx. Wt./100 lbs. (kg)
29-¾	¾" (20)	18 (8.1)
29-1	1" (25)	19 (8.6)
29-1¼	1¼" (32)	24 (10.8)

US Patent No. 9,726,304
Can. Pat. No. 2618941



Features and benefits

- UL Listed as a hanger and restraint to support fire sprinkler systems
- Offset edge helps eliminate abrasion
- Attaches easily to wood structure
- Thumb tab provides protection to restrain pipe in rough job site conditions, but is not required to be bent for listed installation
- Can be used as a single offset hanger by aligning "dimples" with top of mounting surface and utilizing two fasteners in two of the three holes provided
- Attaches easily to wood structure with two special #10 x 1" hex head self-threading screws furnished with product
- Ideal for mechanical, plumbing and fire sprinkler applications

Specifications

- Pipe size range: Available in ¾" (20mm), 1" (25mm), and 1¼" (32mm)
- Material finish: Pre-galvanized steel offers corrosion resistance

Approvals

- Approved by Underwriters Laboratories Listed in the USA (UL) and Canada (cUL) as a hanger and restrainer to support thermoplastic fire sprinkler systems*
- Meets or exceeds requirements of NFPA 13, 13R and 13D.



TOLCO Fig. 29

Installation instructions

- Install using a rechargeable electric drill fitted with a $\frac{5}{16}$ " (8mm) socket attachment using the special hex head self-tapping screws provided.
- Install screws until they bottom out.
- Pipe can be "snapped" into the hanger before or after the installation of the screws to the mounting surface.
- "Thumb tab" may be bent up to provide additional protection for the pipe but is not required for performance of the hanger or restraint function.

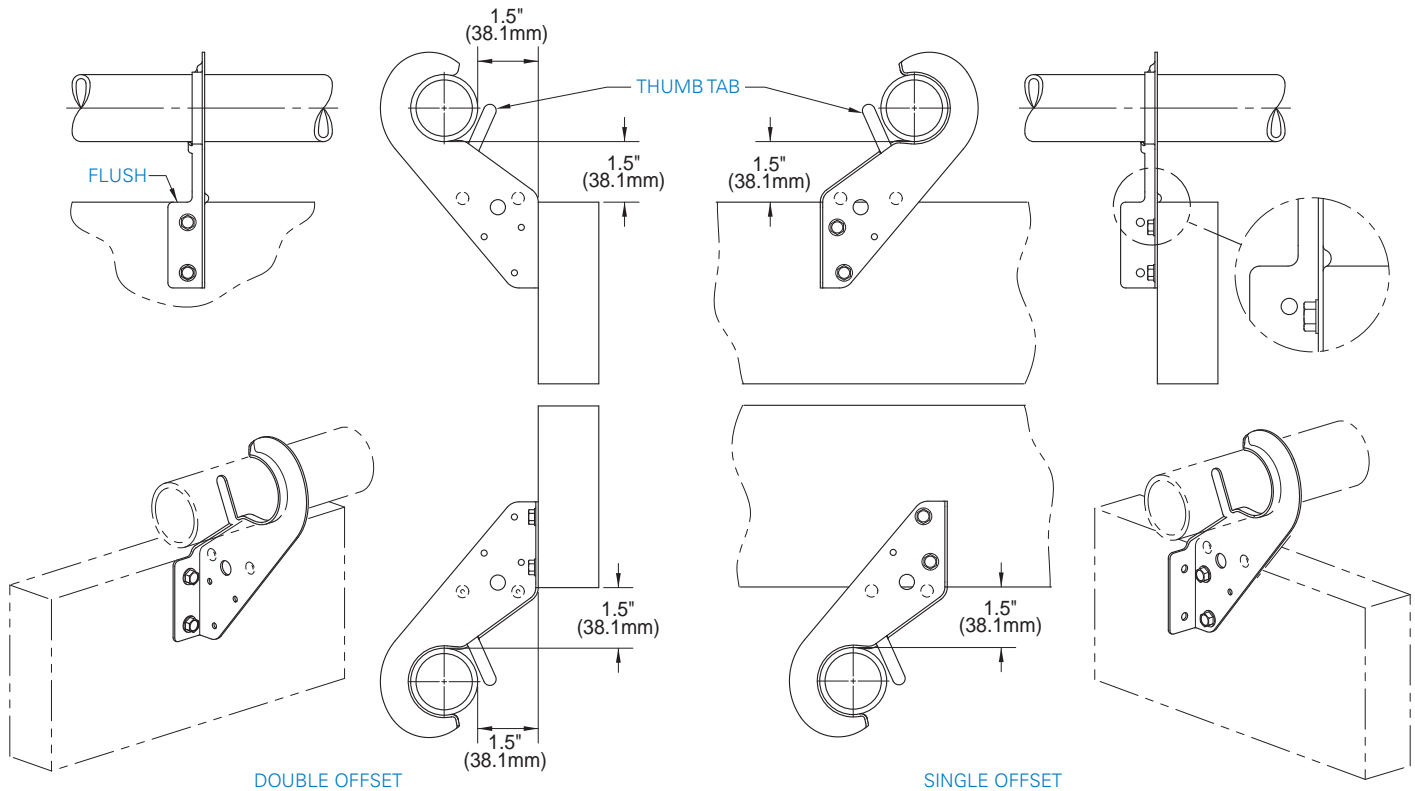

**For more information,
visit Eaton.com/Fig-29.**

Eaton
1000 Eaton Boulevard
Cleveland, OH 44122
United States
Eaton.com

13201 Dahlia Street, Suite 200
Fontana, CA 92337
United States
Phone: 800-851-7415

© 2021 Eaton
All Rights Reserved
Printed in USA
Publication No. SA310018EN
July 2021 B-Line Division

Eaton is a registered trademark.

All other trademarks are property
of their respective owners.

Follow us on social media to get the
latest product and support information.

