

PROJECT: _____	UNIT TAG: _____	QUANTITY: _____
REPRESENTATIVE: _____	TYPE OF SERVICE: _____	DATE: _____
ENGINEER: _____	SUBMITTED BY: _____	DATE: _____
CONTRACTOR: _____	APPROVED BY: _____	DATE: _____
	ORDER NO.: _____	DATE: _____

MQ3-45



Grundfos MQ booster are an all-in-one unit, designed for pumping clean water from break tanks and shallow wells, and for general pressure-boosting in private homes, farms, and irrigation. The boosters are suitable for both indoor and outdoor use.

Note! Product picture may differ from actual product

Conditions of Service		Pump Data		Motor Data	
Flow:	3.08 m³/h	Maximum operating pressure:	7.5 bar	Rated voltage:	110-120 V
Head:	24.25 m	Liquid temperature range:	0 .. 35 °C	Mains frequency:	60 Hz
Efficiency:	17.4 %	Maximum ambient temperature:	45 °C	Enclosure class:	IP54
Liquid:	Water	Approvals:	CSACUS	Insulation class:	B
Temperature:	20 °C	Shaft seal:	BVBP		
NPSH required:	m	Pipe connection:	NPT1		
Viscosity:		Product number:	96860195		
Specific Gravity:	1.000				

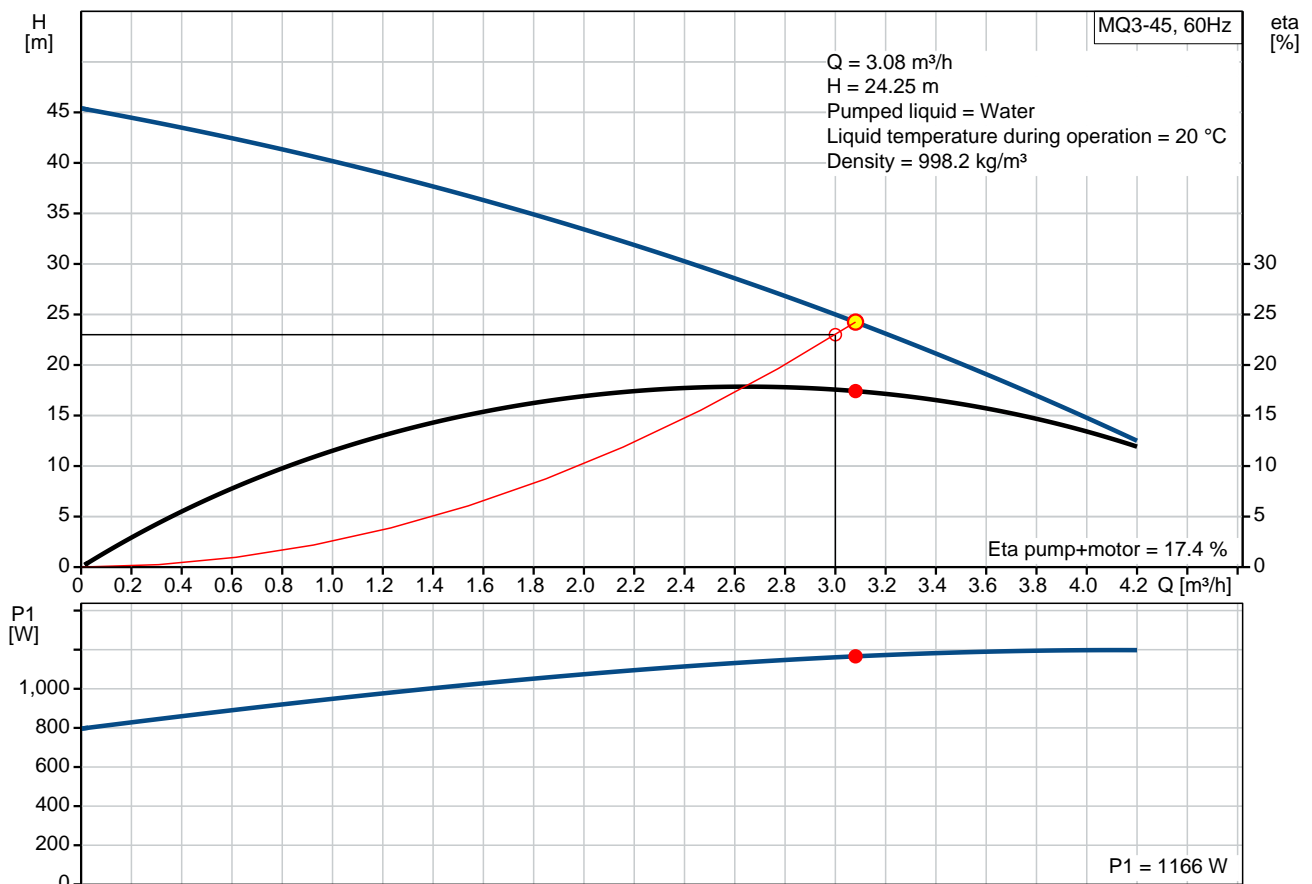

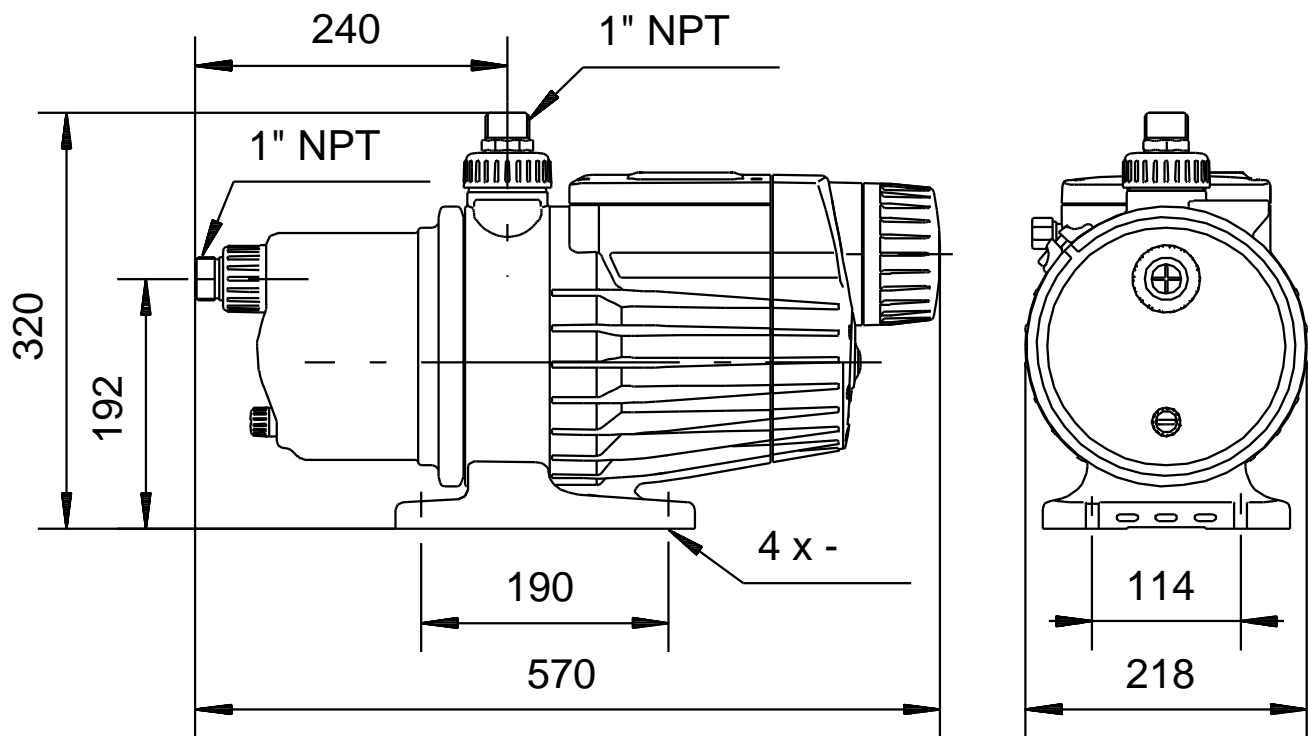

Materials:

Pump housing: POM + 25% glass fibre

Impeller: PPO + 20% glass fibre-PTFE

Material code: A

Tender Text



Note! Product picture may differ from actual product

Product No.: [96860195](#)

MQ3-45 A-B-A-BVBP

Complete system

The MQ is a complete, all-in-one unit, incorporating pump, motor, diaphragm tank, pressure and flow sensor, controller and non-return valve.

The controller ensures that the pump starts automatically when water is consumed and stops automatically when the consumption ceases. In addition, the controller protects the pump in case of faults.

Installation

Due to its compact design, the pump does not take up much space and is easy to install. No space around the pump is required.

Simple operation

The pump features a user-friendly control panel with ON/OFF button and indicator lights for indication of the operational state of the pump.

Self-priming pump

As it is self-priming, the MQ is able to pump water from a level below the pump. Provided it is filled with water, the pump is able to lift water from a depth of 8 m in less than 5 minutes. This facilitates installation and start-up of the pump and provides more reliable water supply in installations where there is a risk of dry running and leakages in suction hose or pipes.

Built-in protective functions

If exposed to dry running or excessive temperature, for example in case of seizure or overload, the pump will stop automatically, thus preventing a motor burnout.

Automatic reset

The pump features an automatic reset function. In case of dry running or similar alarm, the pump will stop. Restarting will be attempted every 30 minutes for a period of 24 hours. The reset function can be deactivated.

Low noise level

Thanks to its hydraulic design and internal cooling, the pump is extremely low-noise, which makes it suitable for indoor as well as outdoor use.

Pressure tank

The built-in pressure tank reduces the number of starts and stops in case of leakages in the pipe system, causing less wear on the pump.

Maintenance

No maintenance of the pump is required.

Liquid:

Pumped liquid: Water

Liquid temperature range: 0 .. 35 °C

Liquid temperature during operation: 20 °C

Density: 998.2 kg/m³

Technical:

Actual calculated flow: 3.08 m³/h
Resulting head of the pump: 24.25 m
Primary shaft seal: BVBP
Approvals on nameplate: CSACUS
Curve tolerance: ISO9906:2012 3B

Materials:

Pump housing: POM + 25% glass fibre
Impeller: PPO + 20% glass fibre-PTFE

Installation:

Range of ambient temperature: 0 .. 45 °C
Maximum operating pressure: 7.5 bar
Pipe connection: NPT1

Electrical data:

Power input - P1: 1150 W
Mains frequency: 60 Hz
Rated voltage: 1 x 110-120 V
Rated current: 10 A
Enclosure class (IEC 34-5): IP54
Insulation class (IEC 85): B
Length of cable: 2 m
Type of cable plug: NEMA

Others:

Net weight: 13 kg
Gross weight: 15.5 kg
Shipping volume: 0.055 m³

Position	Qty.	Description
	1	<p>MQ3-45 A-B-A-BVBP</p>  <p>Note! Product picture may differ from actual product</p> <p>Product No.: 96860195</p> <p>Complete system The MQ is a complete, all-in-one unit, incorporating pump, motor, diaphragm tank, pressure and flow sensor, controller and non-return valve. The controller ensures that the pump starts automatically when water is consumed and stops automatically when the consumption ceases. In addition, the controller protects the pump in case of faults.</p> <p>Installation Due to its compact design, the pump does not take up much space and is easy to install. No space around the pump is required.</p> <p>Simple operation The pump features a user-friendly control panel with ON/OFF button and indicator lights for indication of the operational state of the pump.</p> <p>Self-priming pump As it is self-priming, the MQ is able to pump water from a level below the pump. Provided it is filled with water, the pump is able to lift water from a depth of 8 m in less than 5 minutes. This facilitates installation and start-up of the pump and provides more reliable water supply in installations where there is a risk of dry running and leakages in suction hose or pipes.</p> <p>Built-in protective functions If exposed to dry running or excessive temperature, for example in case of seizure or overload, the pump will stop automatically, thus preventing a motor burnout.</p> <p>Automatic reset The pump features an automatic reset function. In case of dry running or similar alarm, the pump will stop. Restarting will be attempted every 30 minutes for a period of 24 hours. The reset function can be deactivated.</p> <p>Low noise level Thanks to its hydraulic design and internal cooling, the pump is extremely low-noise, which makes it suitable for indoor as well as outdoor use.</p> <p>Pressure tank The built-in pressure tank reduces the number of starts and stops in case of leakages in the pipe system, causing less wear on the pump.</p> <p>Maintenance No maintenance of the pump is required.</p> <p>Liquid: Pumped liquid: Water Liquid temperature range: 0 .. 35 °C Liquid temperature during operation: 20 °C</p>

Position	Qty.	Description
		<p>Density: 998.2 kg/m³</p> <p>Technical:</p> <p>Actual calculated flow: 3.08 m³/h</p> <p>Resulting head of the pump: 24.25 m</p> <p>Primary shaft seal: BVBP</p> <p>Approvals on nameplate: CSACUS</p> <p>Curve tolerance: ISO9906:2012 3B</p> <p>Materials:</p> <p>Pump housing: POM + 25% glass fibre</p> <p>Impeller: PPO + 20% glass fibre-PTFE</p> <p>Installation:</p> <p>Range of ambient temperature: 0 .. 45 °C</p> <p>Maximum operating pressure: 7.5 bar</p> <p>Pipe connection: NPT1</p> <p>Electrical data:</p> <p>Power input - P1: 1150 W</p> <p>Mains frequency: 60 Hz</p> <p>Rated voltage: 1 x 110-120 V</p> <p>Rated current: 10 A</p> <p>Enclosure class (IEC 34-5): IP54</p> <p>Insulation class (IEC 85): B</p> <p>Length of cable: 2 m</p> <p>Type of cable plug: NEMA</p> <p>Others:</p> <p>Net weight: 13 kg</p> <p>Gross weight: 15.5 kg</p> <p>Shipping volume: 0.055 m³</p>

96860195 MQ3-45 60 Hz

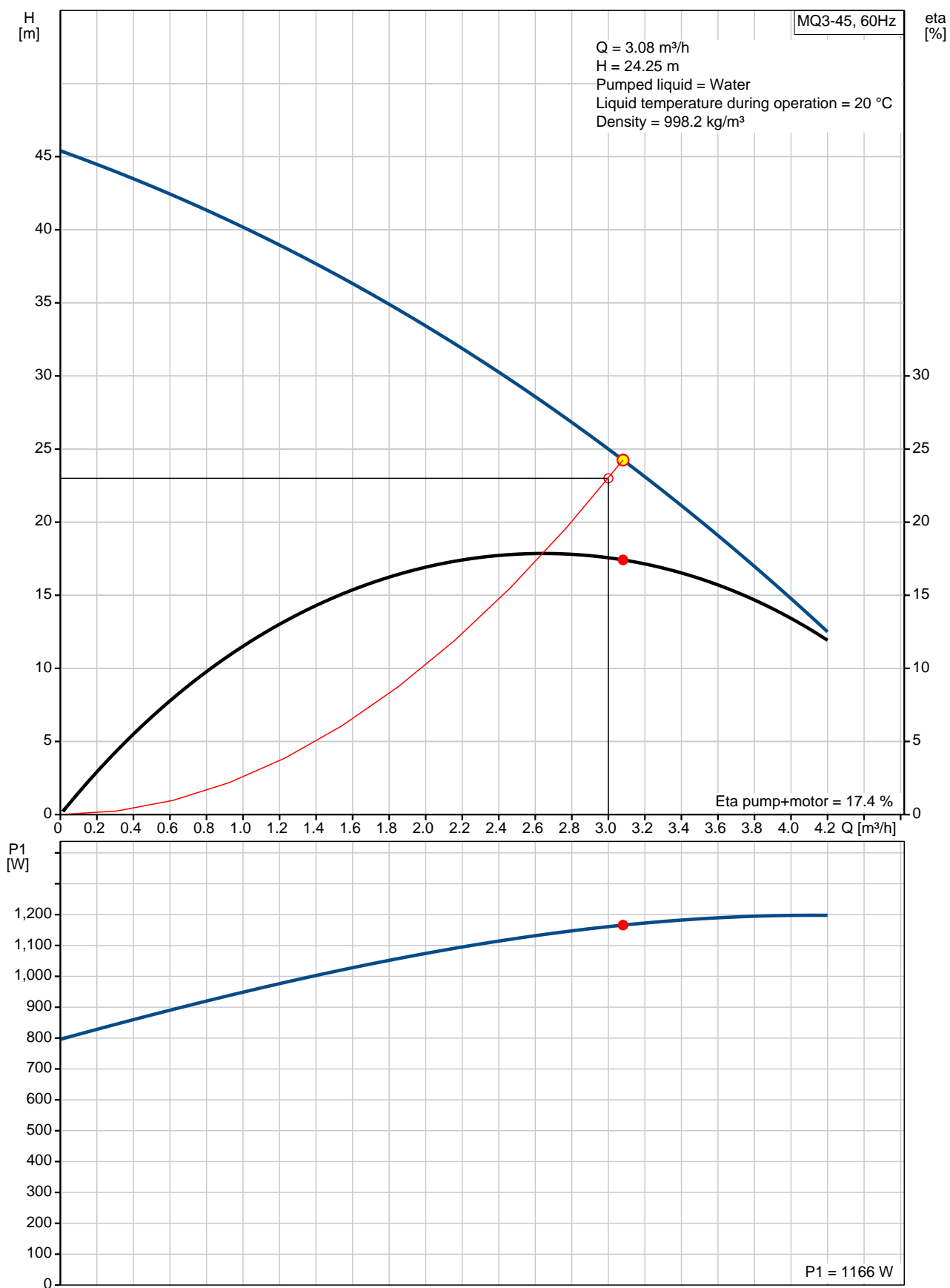

Description	Value
General information:	
Product name:	MQ3-45 A-B-A-BVBP
Product No:	96860195
EAN number:	5700312084204
Technical:	
Actual calculated flow:	3.08 m³/h
Resulting head of the pump:	24.25 m
Head max:	45 m
Primary shaft seal:	BVBP
Approvals on nameplate:	CSACUS
Curve tolerance:	ISO9906:2012 3B
Pump version:	A
Model:	B
Materials:	
Pump housing:	POM + 25% glass fibre
Impeller:	PPO + 20% glass fibre-PTFE
Material code:	A
Installation:	
Range of ambient temperature:	0 .. 45 °C
Maximum operating pressure:	7.5 bar
Connect code:	B
Pipe connection:	NPT1
Liquid:	
Pumped liquid:	Water
Liquid temperature range:	0 .. 35 °C
Liquid temperature during operation:	20 °C
Density:	998.2 kg/m³
Electrical data:	
Power input - P1:	1150 W
Mains frequency:	60 Hz
Rated voltage:	1 x 110-120 V
Rated current:	10 A
Enclosure class (IEC 34-5):	IP54
Insulation class (IEC 85):	B
Length of cable:	2 m
Type of cable plug:	NEMA
Controls:	
Switch:	on/off switch included
Others:	
Net weight:	13 kg
Gross weight:	15.5 kg
Shipping volume:	0.055 m³
Sales region:	Namreg

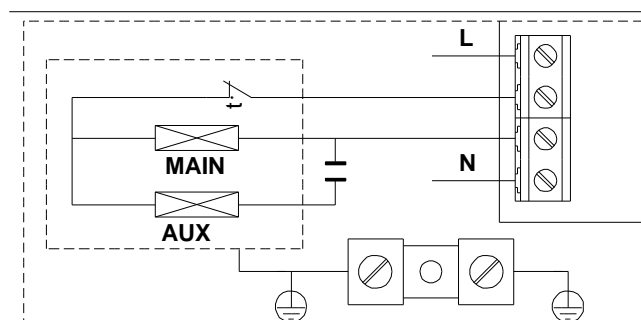
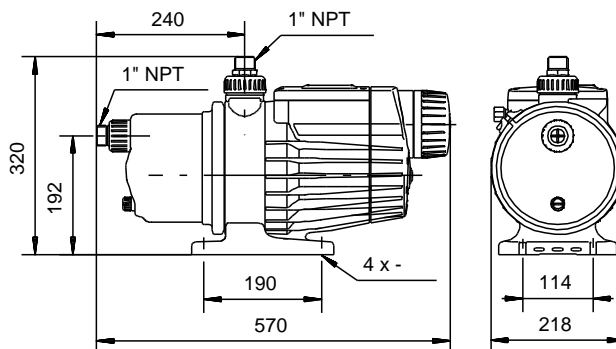
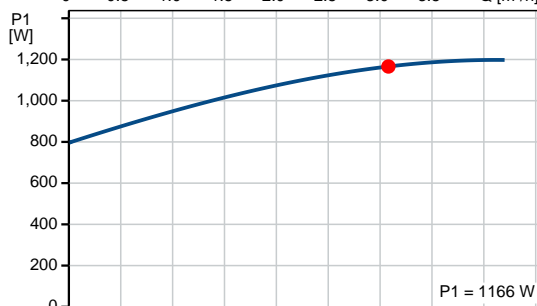
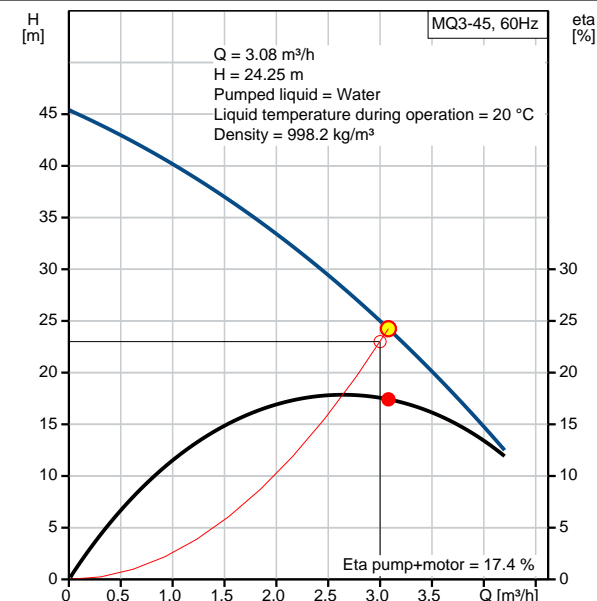

96860195 MQ3-45 60 Hz

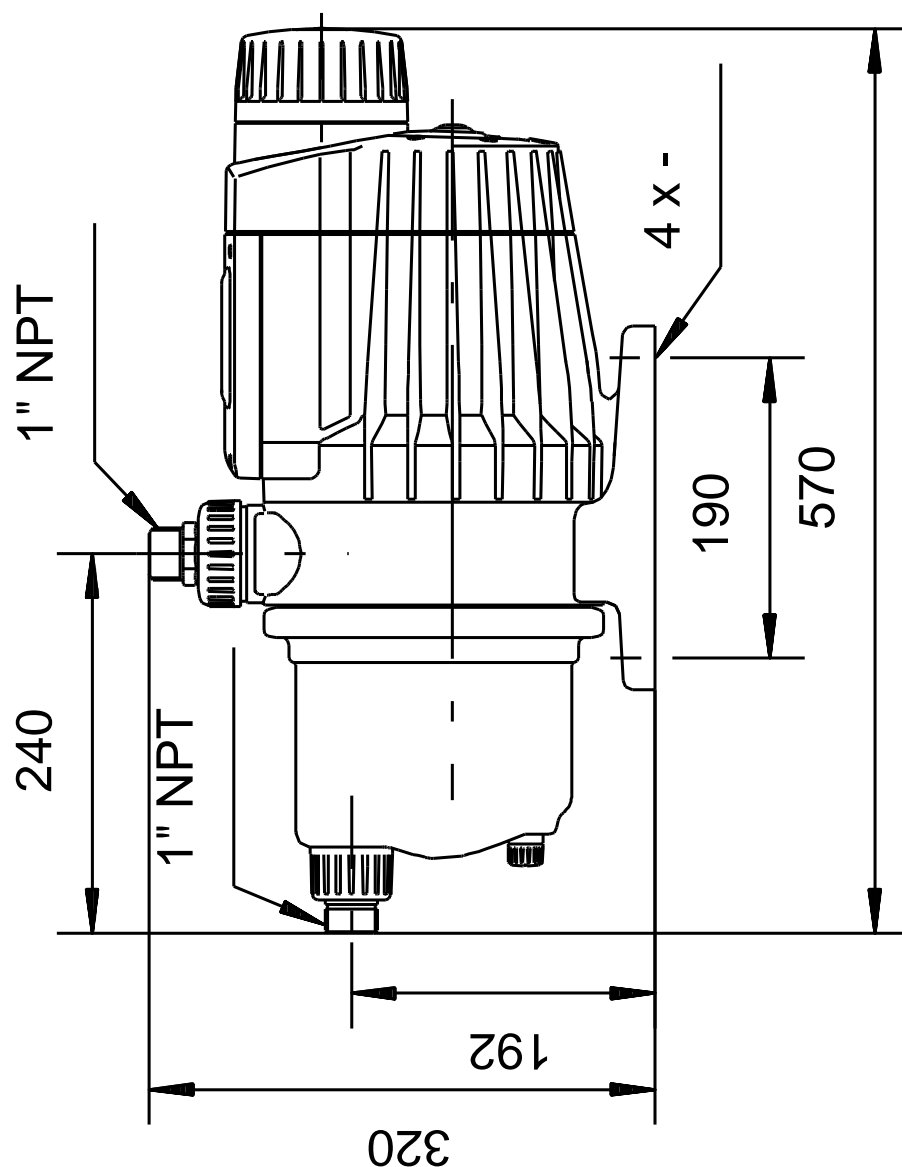
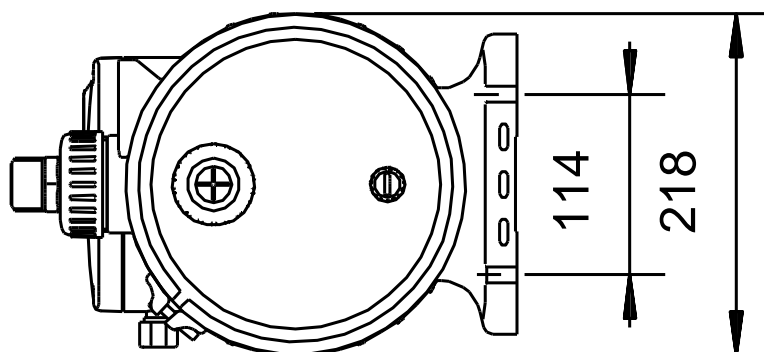

Note! All units are in [mm] unless others are stated.
Disclaimer: This simplified dimensional drawing does not show all details.

96860195 MQ3-45 60 Hz

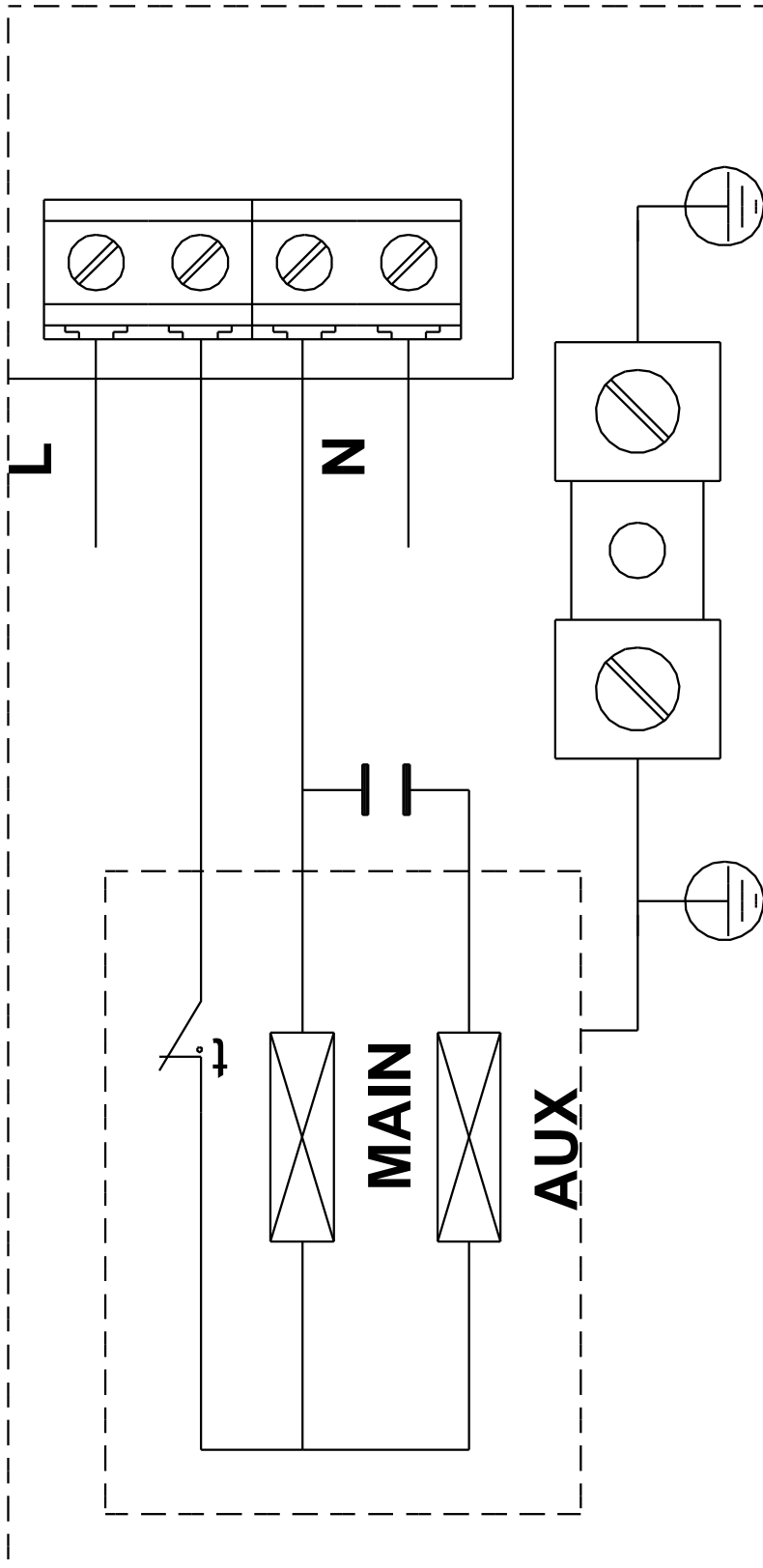

Note! All units are in [mm] unless others are stated.



Company name:

Created by:

Phone:

Date:

21/02/2018

Order Data:

Product name: MQ3-45 A-B-A-BVBP

Amount: 1

Product No: 96860195

Total: Price on request

Exploded view (TM055952 for MQ)

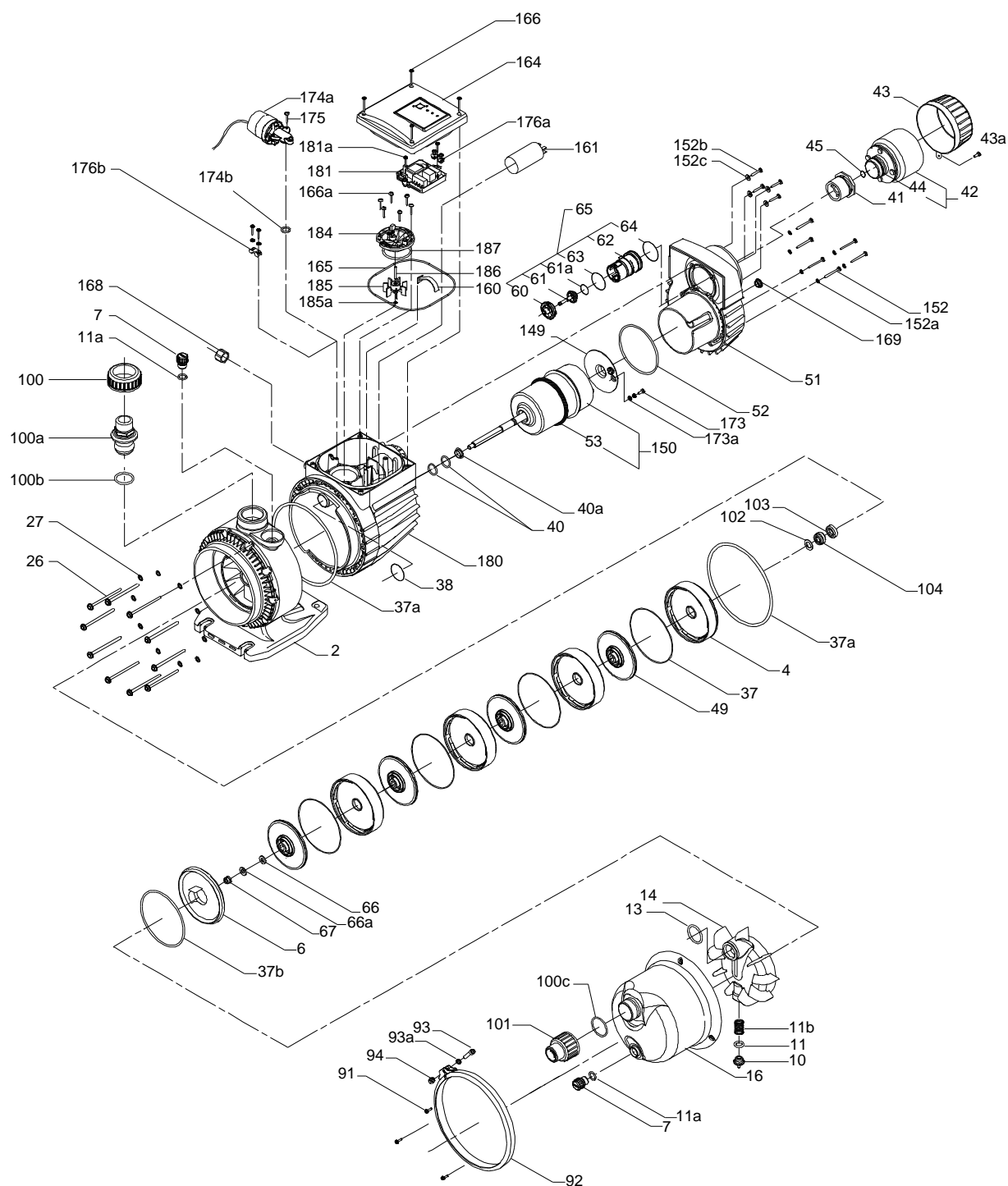

Sectional drawing (TM064501 for MQ)

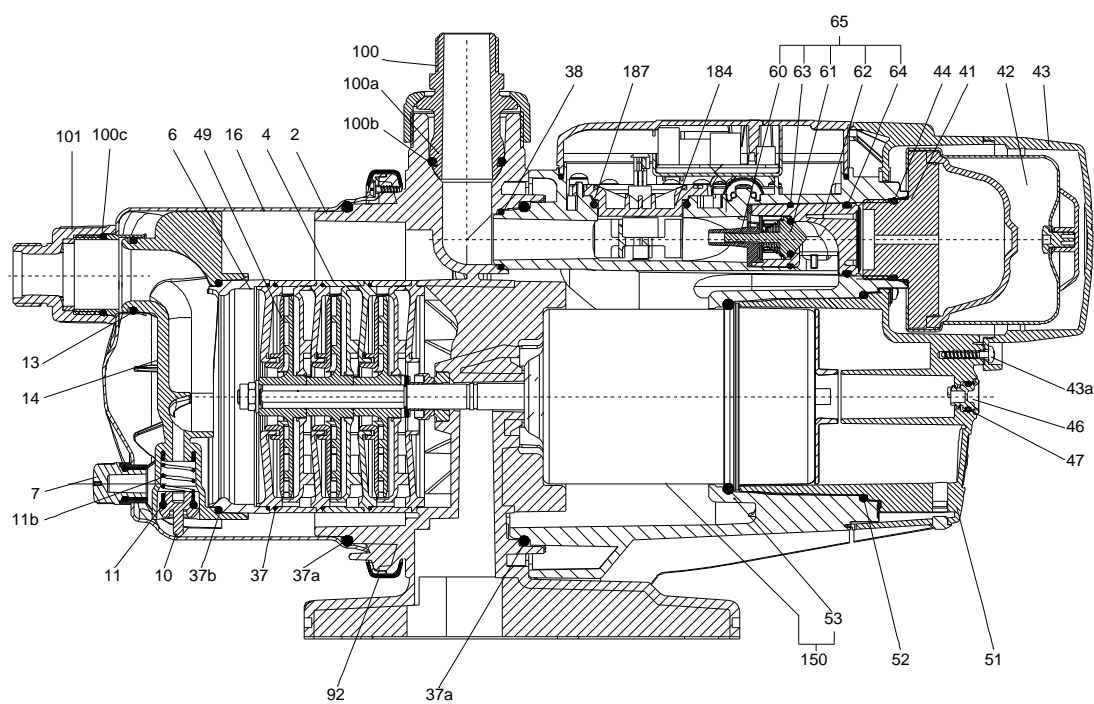

Parts list MQ3-45, Product No. 96860195

Valid from 22.1.2009 (0904)

Pos	Description	Annotation	Classification Data	Part no.	Qty.	Unit
-	Kit, hydraulic parts				1	pcs
4	Chamber				3	
4a	Chamber, empty				1	
6	Inlet part				1	
10	Valve seat				1	
11	O-ring		Diameter: 12,29		1	
			Material type: NBR			
			Thickness: 3,53			
11b	Flat spring				1	
13	O-ring		Diameter: 31,34		1	
			Material type: NBR			
			Thickness: 3,53			
14	Self-priming part				1	
37	O-ring		Diameter: 105,0		5	
			Material type: NBR			
			Thickness: 1,5			
37a	O-ring		Diameter: 164,46		1	
			Material type: NBR			
			Thickness: 5,34			
37b	O-ring		Diameter: 110,7		1	
			Material type: NBR			
			Thickness: 3,53			
49	Impeller				3	
66	Washer		Internal diameter: 8,5		1	
			Outer diameter: 17,0			
66.a	Disc spring				1	
67	Nut		Thread: M8		1	