



Stargaze®

60" x 34" freestanding bath w/Bask® and straight shroud
K-24010-W1

Features

- Three heat settings allow you to customize the surface temperature.
- Freestanding design creates a striking focal point in your bathing area.
- Integral lumbar support on both ends.
- 18" bathing depth offers a deep soaking experience.
- Wide deck along one side simplifies installation and provides support for getting in and out of bath.
- Straight shroud.
- Textured bottom surface.
- Center drain.

Material

- Acrylic.

Installation

- Freestanding.

Recommended Products/Accessories

K-37380 30" Rough-in Cable Bath Drain
K-24916 Wireless Music Kit
K-T37391 Rotary-turn bath drain trim
K-T37392 Rotary-turn bath drain trim
K-T37393 Rotary-turn bath drain trim
K-T37394 Rotary-turn bath drain trim
K-T37395 Bath drain trim
K-T37396 Push-button bath drain trim
K-T37397 Push-button bath drain trim
K-7265 Brass toe tap bath drain
K-37383 Rough-in cable bath drain, PVC, 30" cable with tubing
K-37386 rough-in cable drain, PVC, 30" cable
K-23726 Drain treatment
K-23732 Tub & shower cleaner



Codes/Standards



None Applicable

**KOHLER® Hydrotherapy
Components Five-Year Limited
Warranty KOHLER® Plastic Baths
and Receptors Lifetime Limited
Warranty**

See website for detailed warranty information.

Available Colors/Finishes

Color tiles intended for reference only.

Color	Code	Description
	0	White
	96	Biscuit

KOHLER®

60" x 34" freestanding bath w/Bask® and straight shroud K-24010-W1

Stargaze®

No change in measurements if connected with drain illustrated. (K-37386)

 Recommended Faucet Location

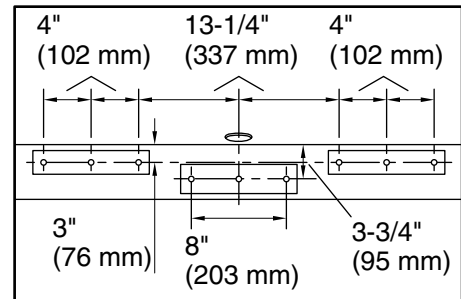

Recommended Faucet Hole Location

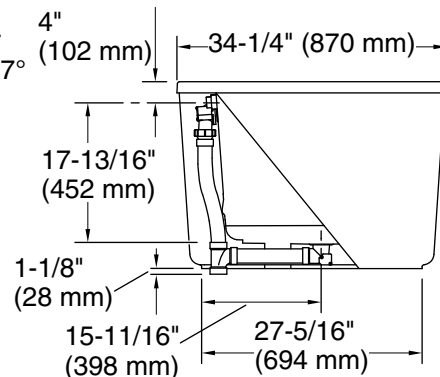
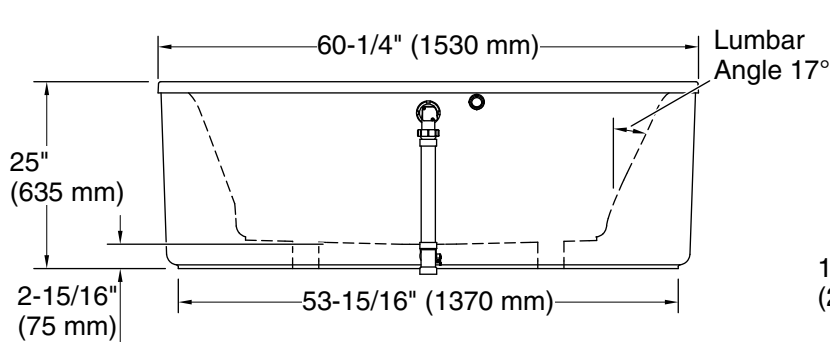
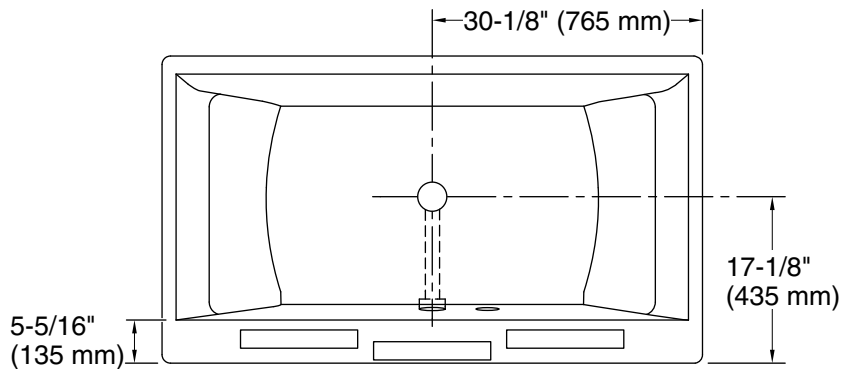

Required Electrical Service

One circuit required, protected with Class A Ground-Fault Circuit-Interrupter (GFCI). Outside North America, this device may be known as a Residual Current Device (RCD).

Heated Surface: 120 V, 15 A, 60 Hz

Technical Information

All product dimensions are nominal.

Installation: Freestanding

Basin area, bottom: 40-5/16" x 22-1/2" (1024 mm x 572 mm)

Basin area, top: 49-3/8" x 25-7/8" (1254 mm x 657 mm)

Weight: 156 lbs (70.8 kg)

Minimum floor load: 54 lbs/ft² (263.7 kg/m²)

Water depth: 18" (457 mm)

Water capacity: 60 gal (227.1 L)

Template: 1364289, not required, not included

Electrical component rating: Heated Surface: 120 V, 0.5 A, 50/60 Hz, 65 W

Notes

Measure your actual product for rough-in details.

Install this product according to the installation instructions.

The hot water supply should be 70% of the capacity of the bath or greater. Installations will vary.

If installing a rim-mount faucet, make sure there is no interference above or below the deck before drilling any holes.

1-800-4KOHLER (1-800-456-4537)

Kohler Co. reserves the right to make revisions without notice to product specifications.

For the most current Specification Sheet, go to www.kohler.com.

THE BOLD LOOK
OF **KOHLER®**