

200 PSI Butterfly Valves

Cast Iron Body • Extended Neck • Geometric Drive • Molded-In Seat Liner • Lug and Wafer Style

Sizes 2" through 12"

Install between Std. ASME Class 125 flanges†.

Lug Style 200 PSI bi-directional dead end service rating without a downstream flange required.

THIRD PARTY CERTIFIED BY QAI TO MEET MSS SP-67 STANDARD •
US COAST GUARD "CATEGORY A" • CERTIFIED LEAD-FREE* BY
TRUESDAIL LABS TO NSF/ANSI/CAN 61-8 COMMERCIAL HOT 180°F
AND NSF/ANSI/CAN 61 AND 372

MATERIAL LIST

| PART | SPECIFICATION |
|-------------------|------------------------------------|
| 1. Stem | Stainless Steel ASTM A582 Type 416 |
| 2. Collar Bushing | Brass ASTM B16 |
| 3. Stem Seal | EPDM Rubber |
| 4. Body Seal | EPDM Rubber |
| 5. Nameplate | Aluminum |
| 6. Upper Bushing | Copper CDA 122 |
| 7. Liner | EPDM Rubber |
| 8. Disc | Alum. Brz. ASTM B148 Alloy 955 |
| 9. Lower Bushing | Copper CDA 122 |
| 10. Body Wafer | Cast Iron |
| 11. Body Lug | Cast Iron |

DIMENSIONS — WEIGHTS

| Size | In. mm. | A | B | C | D | E | F | G | Metal | Rubber | J | N |
|-------|---------|-------|-------|------|-------|------|-----|------|-------|--------|--------|-------|
| | | | | | | | | Flat | H | I | Square | Dia. |
| 2 | 50 | 2.53 | 4.00 | 1.25 | 5.38 | 2.88 | .38 | .312 | 1.688 | 1.812 | 3.25 | .500 |
| 2 1/2 | 65 | 2.90 | 4.69 | 1.25 | 5.88 | 3.27 | .38 | .370 | 1.812 | 1.938 | 3.25 | .562 |
| 3 | 80 | 3.15 | 5.12 | 1.25 | 6.12 | 3.40 | .38 | .370 | 1.812 | 1.938 | 3.25 | .562 |
| 4 | 100 | 4.09 | 6.12 | 1.25 | 6.88 | 4.00 | .38 | .403 | 2.062 | 2.188 | 3.25 | .625 |
| 5 | 125 | 5.13 | 7.25 | 1.25 | 7.38 | 4.75 | .38 | .496 | 2.188 | 2.312 | 3.25 | .750 |
| 6 | 150 | 6.13 | 8.25 | 1.25 | 8.00 | 5.29 | .38 | .496 | 2.188 | 2.312 | 3.25 | .750 |
| 8 | 200 | 8.13 | 10.41 | 1.25 | 9.25 | 6.50 | .50 | .560 | 2.375 | 2.500 | 3.25 | .875 |
| 10 | 250 | 10.13 | 12.52 | 1.25 | 10.50 | 8.00 | .50 | .686 | 2.688 | 2.812 | 4.75 | 1.125 |
| 12 | 300 | 12.13 | 15.00 | 1.25 | 12.00 | 9.25 | .50 | .748 | 3.000 | 3.125 | 4.75 | 1.250 |

| Size | | Capscrew/Stud Data | | | | | | Lug Weight | | Wafer Weight | |
|-------|-----|--------------------|--------|--------|-------|-----------|---|------------|--------|--------------|------|
| In. | mm. | O B.C. | P Dia. | R Dia. | K No. | L Dia. | Wafer Length | Lug Length | M B.C. | Lbs. | Kg. |
| 2 | 50 | 3.25 | .437 | .437 | 4 | 5/8-11unc | Refer to butterfly valve technical information for bolt lengths | | 4 3/4 | 7 | 3.2 |
| 2 1/2 | 65 | 3.25 | .437 | .500 | 4 | 5/8-11unc | | | 5 1/2 | 9 | 4.1 |
| 3 | 80 | 3.25 | .437 | .500 | 4 | 5/8-11unc | | | 6 | 9.5 | 4.3 |
| 4 | 100 | 3.25 | .437 | .562 | 8 | 5/8-11unc | | | 7 1/2 | 15 | 6.8 |
| 5 | 125 | 3.25 | .437 | .656 | 8 | 3/4-10unc | | | 8 1/2 | 21 | 9.5 |
| 6 | 150 | 3.25 | .437 | .656 | 8 | 3/4-10unc | | | 9 1/2 | 24 | 10.9 |
| 8 | 200 | 3.25 | .437 | .781 | 8 | 3/4-10unc | | | 11 3/4 | 34 | 15.4 |
| 10 | 250 | 5.00 | .562 | 1.000 | 12 | 7/8-9unc | | | 14 1/4 | 62 | 28.1 |
| 12 | 300 | 5.00 | .562 | 1.062 | 12 | 7/8-9unc | | | 17 | 90 | 40.9 |
| | | | | | | | | | | 70 | 31.8 |

†NOTE: lug style valves - extra care should be used when installing with raised face flanges. Over-tightening can result in broken lugs.

Visit our website for the most current information.

*Weighted average lead content ≤ 0.25%



WC-2000

Wafer Style
EPDM Liner
and Aluminum
Bronze Disc



LC-2000

Lug Style
EPDM Liner
and Aluminum
Bronze Disc

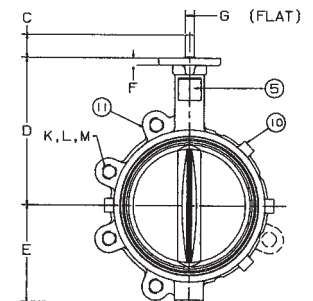
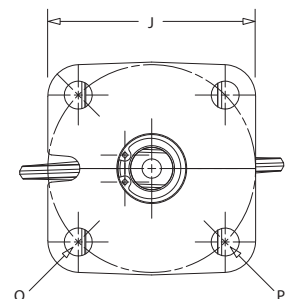
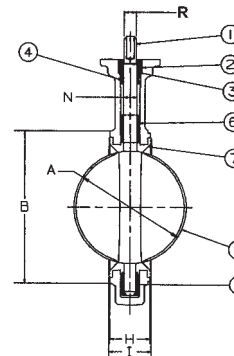

WARNING: This product can expose you to chemicals including lead, which is known to the State of California to cause cancer and birth defects or other reproductive harm. For more information go to www.P65Warnings.ca.gov.

NOT RECOMMENDED
FOR STEAM SERVICE