



model **5510LF**  
Sink Faucet

## FEATURES & BENEFITS

### VALVE

Polished chrome-plated, lead-free brass, lever handle stay-open valve features automatic pressure compensation stream control.

### QUALITY

Gooseneck valve is pre-built and fully water and pressure tested to ensure no leaks and proper function for reduced installation time and added peace of mind.

## OPTIONS

For more information, visit [www.hawesco.com](http://www.hawesco.com) or call (888) 640-4297.



## SPECIFICATIONS

Model 5510LF is a polished chrome-plated brass stay-open lever handle, compression gooseneck faucet with a vandal-resistant .5 gpm (1.9 L) aerator, vandal-resistant lock pin, and 1/2" O.D. (1.3 cm) slip-joint inlet.

## APPLICATIONS

Perfect for either public or private indoor settings, the 5510LF is a great fit in areas where a sink is present. Specifically, this type of deck mounted glass-filler faucet may be placed in settings such as: schools, classrooms, laboratories, restaurants, and other facilities where the need for a deck mounted source of water is present. Haws manufactures drinking fountains and electric water coolers to be lead-free by all known definitions including NSF/ANSI Standard 61, Section 9, NSF/ANSI 372, California Proposition 65, and the Federal Safe Drinking Water Act.



THIS DOCUMENT IS TRUE AND CORRECT AT TIME OF PUBLICATION. CONTINUED PRODUCT IMPROVEMENTS MAKE SPECIFICATIONS AND MEASUREMENTS SUBJECT TO CHANGE WITHOUT NOTICE.

**NOTE:**

1. BE SURE INDEXING PINS ARE INSTALLED AND ORIENTED TO ACCOMMODATE YOUR DESIRED MOUNTING.

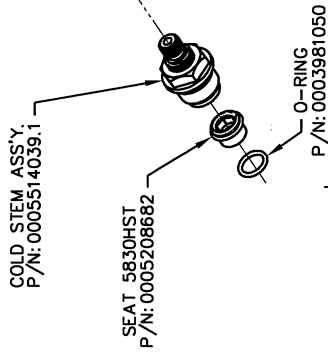
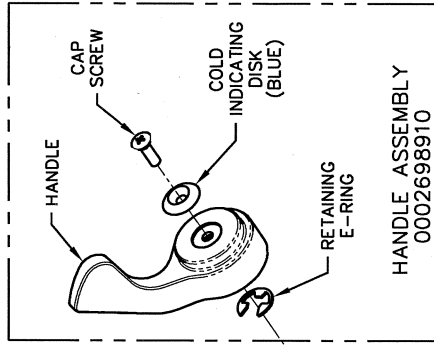
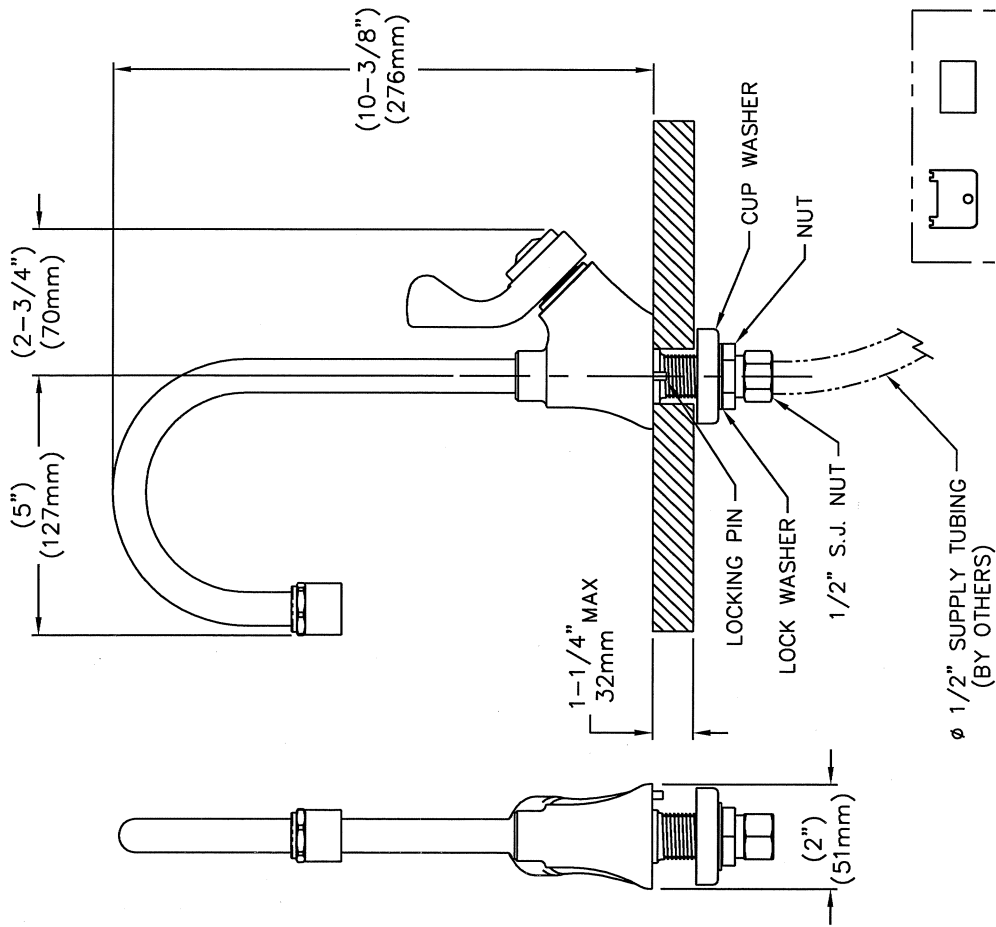
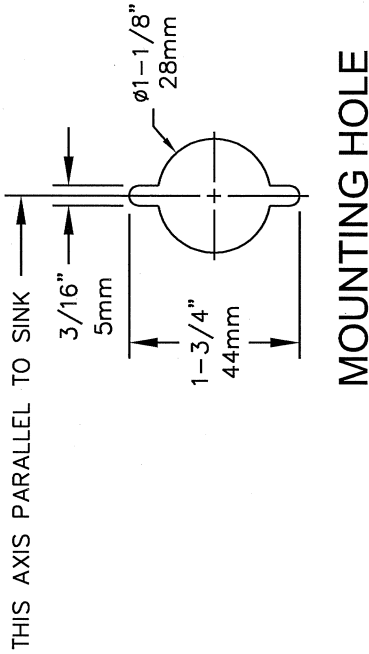

**REPLACEMENT PARTS AVAILABLE**

**REPLACEMENT PARTS AVAILABLE**

AERATOR W/KEY 0000086686.8



1455 KLEPPE LANE  
SPARKS, NEVADA 89431  
(775) 359-4712 FAX (765) 359-7424  
E-MAIL: HAWS@HAWS.CO.COM  
WEBSITE: WWW.HAWS.CO.COM

DESIGNED BY: [Signature]	MODEL(S)	5510LF
DRAWN: [Signature]	GOOSENECK VALVE	GOOSENECK VALVE
DATE: 05/04/07	SCALE: 12.5	DRAWING TYPE: DEVELOPMENT
APPROVED: [Signature]	SIZE: A	SHEET 1 OF 1
REVISED PER BY: [Signature]	REV	0002077529
DATE: 05/04/07	DRAWING NO.	11405A00
GE: 504		7