



## UNIVERSAL STRUCTURAL BRACKET, EG, 9/16" HOLE

### CATALOG NUMBER

**CSBU1**



### CERTIFICATIONS



### FEATURES

Universal design allows one product to attach directly to concrete, wood, bar joist or I-beam adapters

Integrated angle gauge easily displays brace member angle of installation

Snap-off bolt head helps enable easy installation and inspection of seismic sway braces

Works with 1" through 2" brace pipes to reduce inventory

Low profile minimizes prying effect on concrete fasteners

Meets NFPA® 13 as pre-qualified for seismic applications

FM® Specification Tested

### PRODUCT ATTRIBUTES

Material: Steel

Finish: Electrogalvanized

Hole Size: 9/16"

Width: 1 15/16"

Thickness: 3/16"

A: 2 1/16"

B: 1 5/16"

C: 1 3/8"

D: 1 1/4"

E: 1 3/4"

UL Listed Load: 2,000 lb

FM Loads					
Part Number	Brace Member	Horizontal Capacity per Installation Angle from Vertical			
		30°- 44°	45°- 59°	60°- 74°	75°- 90°
CSBU1xx	Schedule 40 Pipe	1,690 lb	2,210 lb	2,660 lb	3,090 lb
	1" EMT Conduit	530 lb	911 lb	1108 lb	1223 lb
	1" Rigid Conduit	1,690 lb	2,210 lb	2,660 lb	3,090 lb
CSBU2xx	Schedule 40 Pipe	1,480 lb	2,290 lb	2,860 lb	3,090 lb
	1" EMT Conduit	530 lb	911 lb	1108 lb	1223 lb
	1" Rigid Conduit	1,480 lb	2,290 lb	2,860 lb	3,090 lb

## DIAGRAMS

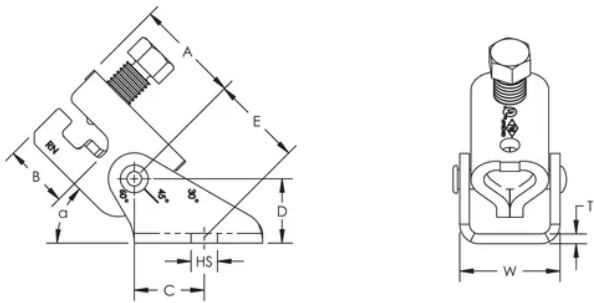

## WARNING

nVent products shall be installed and used only as indicated in nVent's product instruction sheets and training materials. Instruction sheets are available at [www.nvent.com](http://www.nvent.com) and from your nVent customer service representative. Improper installation, misuse, misapplication or other failure to completely follow nVent's instructions and warnings may cause product malfunction, property damage, serious bodily injury and death and/or void your warranty.

**North America**

+1.800.753.9221

Option 1 – Customer Care

Option 2 – Technical Support

**Europe**

Netherlands:

+31 800-0200135

France:

+33 800 901 793

**Europe**

Germany:

800 1890272

Other Countries:

+31 13 5835404

**APAC**

Shanghai:

+ 86 21 2412 1618/19

Sydney:

+61 2 9751 8500



Our powerful portfolio of brands:  
**nVent.com CADDY ERICO HOFFMAN RAYCHEM SCHROFF**  
**TRACER**