

# Threaded Accessories

## B3224 - Hanger Adjuster

### B3224CT - Copper Tubing Hanger Adjuster

**Size Range:** 1/4"-20 thru 3/4"-10 rod

**Material:** Malleable Iron

**Function:** To provide an adjustable threaded connection for hanger rods.

**Approvals:** Conforms to Federal Specification WW-H-171E & A-A-1192A, Type 15 and Manufacturers Standardization Society ANSI/MSS SP-69 & SP-58, Type 15.

**Finish:** Plain. Contact customer service for alternative finishes and materials.

**Order By:** Part number, rod size and finish



B3224



B3224CT

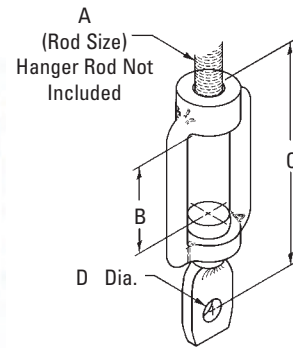

Part No.	Rod Size		For Pipe Sizes		B		C		D		Design Load Lbs. (kN)	Approx. Wt./100 Lbs. (kg)
	A		in.	(mm)	in.	(mm)	in.	(mm)	in.	(mm)		
B3224-1/4	1/4"-20		3/8"	(10)	1 3/4"	(44.4)	3 7/8"	(98.4)	7/32"	(5.5)	230 (1.02)	9 (4.1)
B3224-3/8	3/8"-16		1/2" to 2"	(15 to 50)	1 3/4"	(44.4)	3 7/8"	(98.4)	13/32"	(10.3)	730 (3.25)	28 (12.7)
B3224-1/2	1/2"-13		2 1/2" to 3 1/2"	(65 to 90)	1 3/4"	(44.4)	3 7/8"	(98.4)	13/32"	(10.3)	730 (3.25)	29 (13.1)
B3224-5/8	5/8"-11		4" to 5"	(100 to 125)	2 1/4"	(57.1)	5 1/8"	(130.2)	1/2"	(12.7)	730 (3.25)	30 (13.6)
B3224-3/4	3/4"-10		6"	(150)	2 1/4"	(57.1)	5 1/8"	(130.2)	9/16"	(14.3)	860 (3.82)	74 (33.5)

## B3202 - Turnbuckle

**Size Range:** 3/8"-16 thru 2"-4 1/2 machine thread

**Material:** Forged Steel

**Function:** Standard turnbuckle tapped right and left hand which provides 6" (152.4mm) take up (3" (76.2mm) rod take out).

**Approvals:** Conforms to Federal Specification WW-H-171E & A-A-1192A, Type 13, 3/8"-16 thru 1 1/2"-6 rod, and Manufacturers Standardization Society ANSI/MSS SP-69 & SP-58, Type 13.

**Finish:** Plain. Contact customer service for alternative finishes and materials.

**Order By:** Part number, rod size and finish

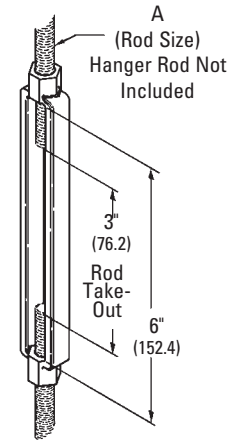

Part No.	Rod Size A	Design Load				Approx. Wt./100 Lbs. (kg)
		650°F (343°C)		750°F (399°C)		
		Lbs.	(kN)	Lbs.	(kN)	
B3202-3/8	3/8"-16	730	(3.25)	572	(2.54)	38 (17.2)
B3202-1/2	1/2"-13	1350	(6.00)	1057	(4.70)	54 (24.5)
B3202-5/8	5/8"-11	2160	(9.61)	1692	(7.52)	91 (41.3)
B3202-3/4	3/4"-10	3230	(14.37)	2530	(11.25)	130 (58.9)
B3202-7/8	7/8"-9	4480	(19.93)	3508	(15.60)	202 (91.6)
B3202-1	1"-8	5900	(26.24)	4620	(20.55)	270 (122.5)
B3202-1 1/8	1 1/8"-7	7450	(33.14)	5830	(25.93)	354 (160.6)
B3202-1 1/4	1 1/4"-7	9500	(42.25)	7440	(33.09)	445 (201.8)
B3202-1 1/2	1 1/2"-6	13800	(61.38)	10807	(48.07)	640 (290.3)
B3202-1 3/4	1 3/4"-5	18600	(82.73)	14566	(64.79)	1100 (498.9)
B3202-2	2"-4 1/2	24600	(109.42)	19625	(87.29)	1490 (675.8)

All dimensions in charts and on drawings are in inches. Dimensions shown in parentheses are in millimeters unless otherwise specified.