

PALM  **TECH**

home inspection software

V E R S I O N 9

HOW TO:

Delete Lines in the App

This step by step How To article explains how to delete lines in the Palm-Tech App

For a complete list of available How To documents, visit the Support section of our website: www.palm-tech.com/support/

HOW TO: Delete Lines in the App

You can delete lines from your inspections when using the Palm-Tech App. There are two ways to delete lines which are covered below.

Deleting Lines from the Edit Category Screen

1. Tap on the icon to the right of the line you want to delete. This will bring up the edit icons. In this example we'll delete the 'Deck' line.

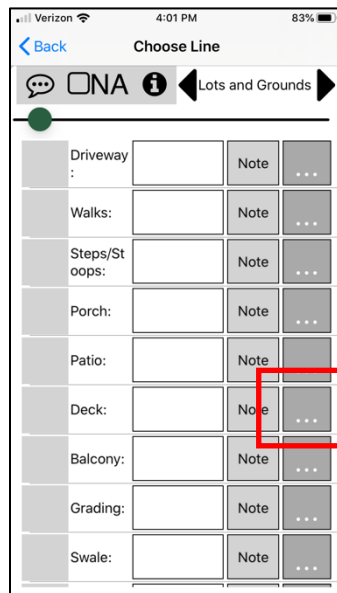

2. This will bring up the 'Edit' options for the line. Tap on the 'Delete' icon to delete the line.

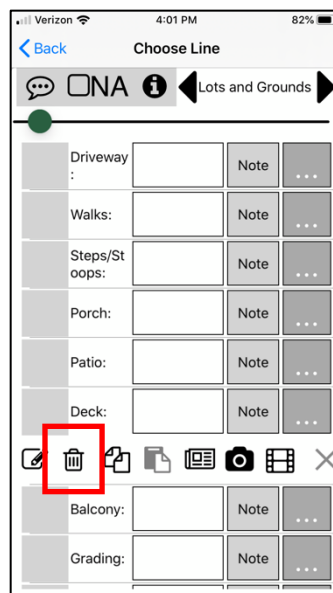

HOW TO: Delete Lines in the App

3. You will now see a prompt asking 'Are you sure you want to delete this line?'. Tap 'Yes' and the line will be removed from the inspection.

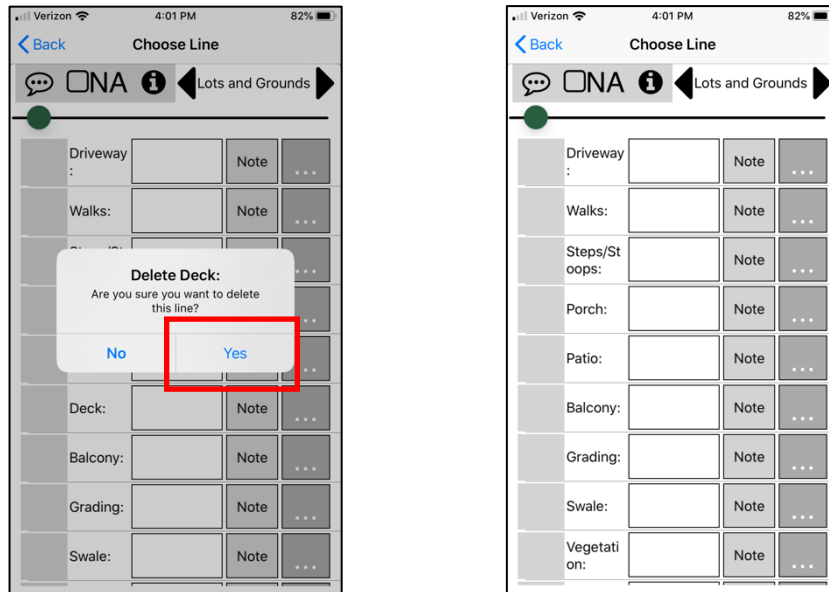

Deleting Lines from the Edit Line Screen

1. To delete a line from the Edit Line screen tap on the 'Delete' icon from the toolbar.

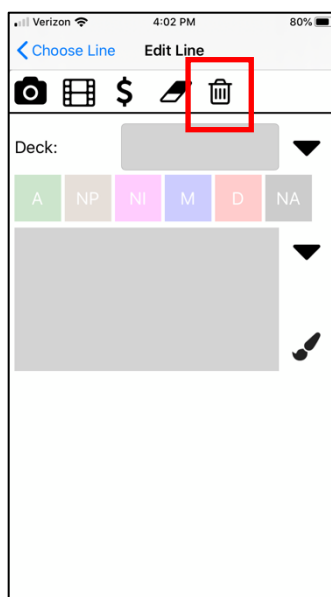

HOW TO: Delete Lines in the App

- Next you will see a prompt asking 'Are you sure you want to delete it?'. Tap 'Yes' and the line will be removed from the inspection.

