

## Soils Map

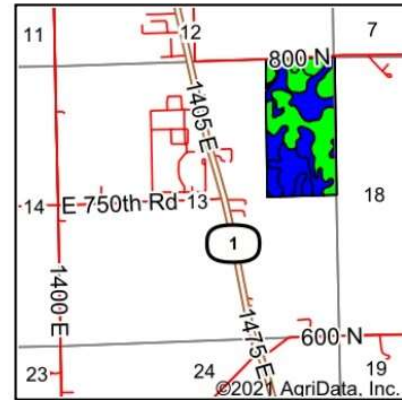
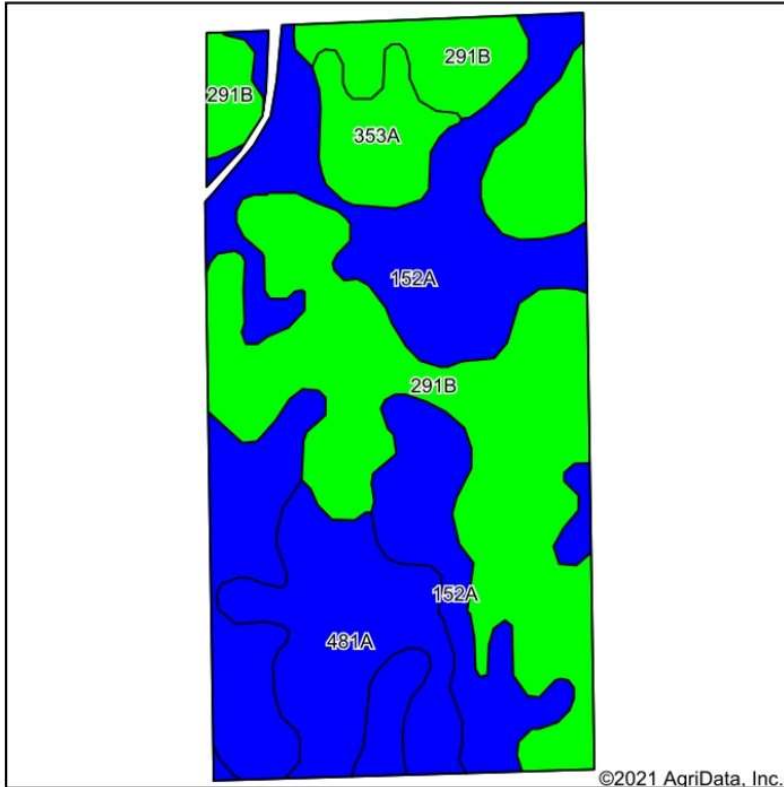

State: **Illinois**  
 County: **Edgar**  
 Location: **13-13N-12W**  
 Township: **Paris**  
 Acres: **77.77**

**FIRST ILLINOIS**  
**AG GROUP**

Maps Provided By  
  
**surety**<sup>®</sup>  
CUSTOMIZED ONLINE MAPPING  
© AgriData, Inc. 2021      www.AgriDataInc.com



Soils data provided by USDA and NRCS.

Area Symbol: IL045, Soil Area Version: 15

Code	Soil Description	Acres	Percent of field	Il. State Productivity Index Legend	Subsoil rooting <sup>a</sup>	Corn Bu/A	Soybeans Bu/A	Wheat Bu/A	Crop productivity index for optimum management
**291B	Xenia silt loam, Bloomington Ridged Plain, 2 to 5 percent slopes	32.95	42.4%		FAV	**160	**50	**63	**117
152A	Drummer silty clay loam, 0 to 2 percent slopes	30.41	39.1%		FAV	195	63	73	144
481A	Raub silt loam, non-densic substratum, 0 to 2 percent slopes	10.44	13.4%		FAV	183	58	73	134
353A	Toronto silt loam, Bloomington Ridged Plain, 0 to 2 percent slopes	3.97	5.1%		FAV	174	56	69	128
<b>Weighted Average</b>						<b>177.5</b>	<b>56.5</b>	<b>68.6</b>	<b>130.4</b>

**Table: Optimum Crop Productivity Ratings for Illinois Soil by K.R. Olson and J.M. Lang, Office of Research, ACES, University of Illinois at Champaign-Urbana.** Version: 1/2/2012 Amended Table S2 B811

Crop yields and productivity indices for optimum management (B811) are maintained at the following NRES web site: <http://soilproductivity.nres.illinois.edu/>

\*\* Indexes adjusted for slope and erosion according to Bulletin 811 Table S3

<sup>a</sup> UNF = unfavorable; FAV = favorable