

Soils Map

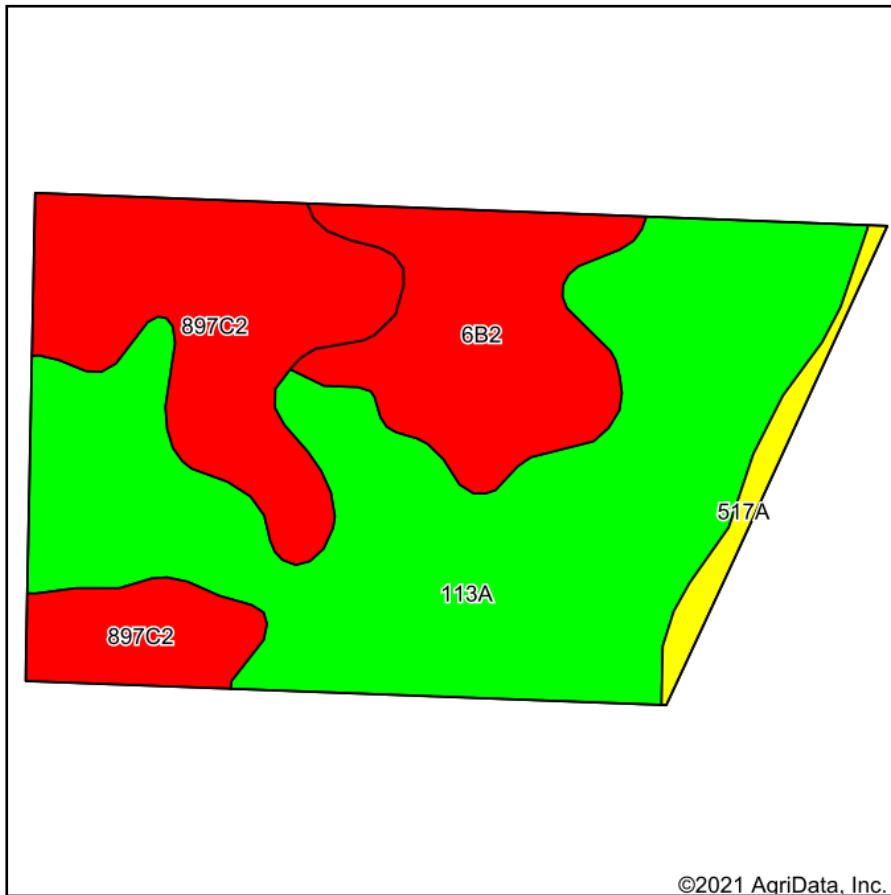

Soils data provided by USDA and NRCS.

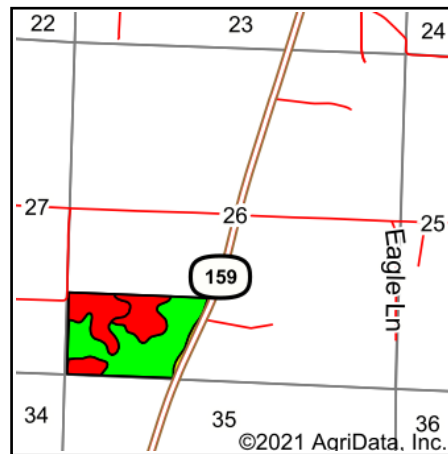

State: **Illinois**
 County: **Macoupin**
 Location: **26-7N-8W**
 Township: **Bunker Hill**
 Acres: **59.4**
 Date: **9/20/2021**

FIRST ILLINOIS
AG GROUP

Maps Provided By:



Area Symbol: IL117, Soil Area Version: 15

Code	Soil Description	Acres	Percent of field	Il. State Productivity Index Legend	Subsoil rooting ^a	Corn Bu/A	Soybeans Bu/A	Wheat Bu/A	Crop productivity index for optimum management	
113A	Oconee silt loam, 0 to 2 percent slopes	32.67	55.0%		FAV	164		50	63	119
**897C2	Bunkum-Atlas silt loams, 5 to 10 percent slopes, eroded	15.32	25.8%		UNF	**122	**42	**47		**94
**6B2	Fishhook silt loam, 2 to 5 percent slopes, eroded	9.67	16.3%		UNF	**123	**39	**47		**90
517A	Marine silt loam, 0 to 2 percent slopes	1.74	2.9%		FAV	144		45	56	104
Weighted Average						145.9		46	56.1	107.4

Table: Optimum Crop Productivity Ratings for Illinois Soil by K.R. Olson and J.M. Lang, Office of Research, ACES, University of Illinois at Champaign-Urbana. Version: 1/2/2012 Amended Table S2 B811

Crop yields and productivity indices for optimum management (B811) are maintained at the following NRES web site: <http://soilproductivity.nres.illinois.edu/>

** Indexes adjusted for slope and erosion according to Bulletin 811 Table S3

^a UNF = unfavorable; FAV = favorable

Soils data provided by USDA and NRCS. Soils data provided by University of Illinois at Champaign-Urbana.