

FLAGSTAFF

meetings



Meeting Planner *guide*

meetinflagstaff.org



WINTER IN FLAGSTAFF

Designated as Arizona's winter wonderland, Flagstaff attracts visitors from all over to our snowy playground. Accumulating an average of 100 inches of snow annually in downtown, the surrounding ponderosa forests are blanketed with even more, welcoming winter enthusiasts to partake in a multitude of winter activities, such as skiing, snowshoeing, sledding and snowbiking.

EXPERIENCE WINTER TO ITS FULLEST:

- Grab your skis or snowboard and head up to **Arizona Snowbowl** for a day on the slopes.
- Visit the Arizona **Nordic Village** to experience cross country skiing and snowshoeing on the 25 miles of groomed trails. Or grab the sled and to have a fun day playing in the snow.
- Head indoors for some ice skating fun at the **Jay Lively Activity Center** or catch an NAU hockey game for an exciting family night.
- Take a trip to **Mormon Lake lodge** and hop on a snowmobile for a guided tour through the winter wonderland of the **Coconino National Forest**.
- Experience the variety of shopping, dining, and nightlife during a winter evening in the **Historic Downtown Flagstaff**.
- For a fun time check out the **Flagstaff Snow Park** for a winter experience complete with snow tubing, hot coco and outdoor fire pits.

alluring golden brown, red and orange autumn colors. Those interested in absorbing the scenery by foot might consider hiking some of Flagstaff's **prominent trails**. There are many trails, ranging in difficulty, which will provide stunning views of the changing landscape. Another great option for taking in the fall colors is on the scenic chairlift ride at **Arizona Snowbowl**.



SUMMER IN FLAGSTAFF

At 7,000 feet summer means mild sunny days where the sweet scent of ponderosa pine beckons and visitors find endless opportunities for outdoor adventure and countless special events and festivals to fill the inviting cool evenings.

FLAGSTAFF COMES TO LIFE IN THE SUMMER WITH:

- Events
- Festivals
- Farmer's markets
- Hiking
- Mountain Biking
- Brewery Trail
- Vibrant Historic Downtown District with restaurants, galleries and shopping

FALL IN FLAGSTAFF

As the fall months begin to emerge, the warming autumn colors will descend from the **San Francisco Peaks** to the streets of Flagstaff. Flagstaff offers many opportunities to explore and witness the

High Country Conference Center



HIGH COUNTRY CONFERENCE CENTER

highcountryconferencecenter.com
17,478 sq ft

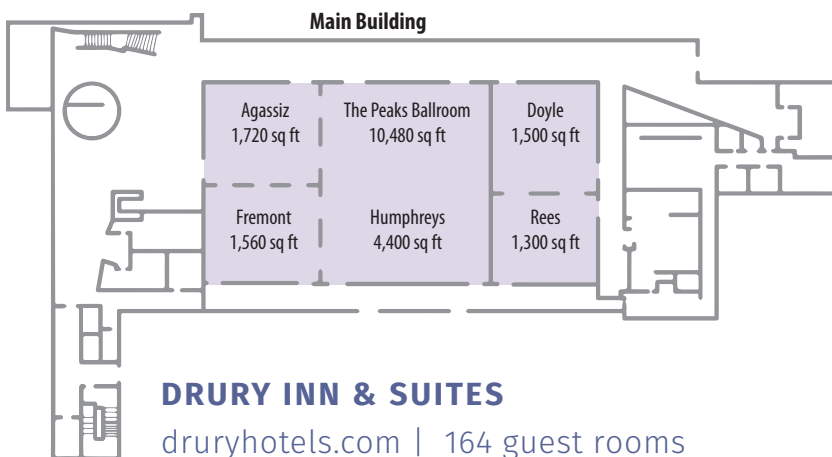

DRURY INN & SUITES

druryhotels.com | 164 guest rooms

1899 BAR & GRILL

1899barandgrill.com

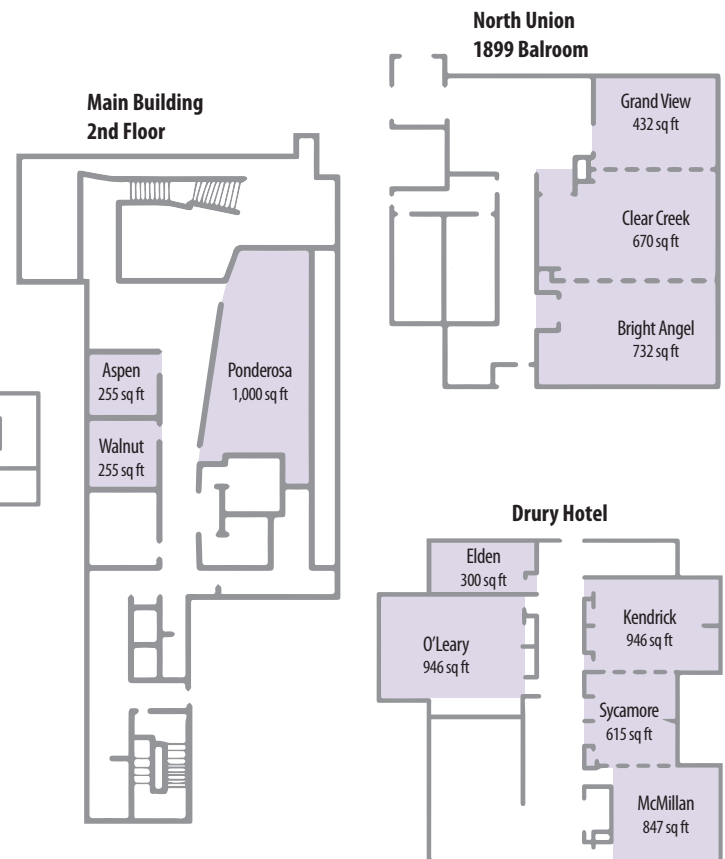

Unique Meeting Venues

AMERICAN LEGION

928.774.7682 | 1,800 sq ft

THE AQUAPLEX

flagstaffaquaplex.org | 2,670 sq ft

ELKS LODGE | elks.org | 3,000 sq ft

FOREST HIGHLANDS GOLF CLUB

CANYON CLUBHOUSE | fhgc.com | 6,299 sq ft

FOREST HIGHLANDS GOLF CLUB

MEADOW CLUBHOUSE | fhgc.com
2,517 sq ft indoor | 37,000 sq ft outdoor

FLAGSTAFF RANCH | flagstaffranch.com

ROUX 66

roux66.com | 1,000 sq ft

THORNAGER'S ON KILTIE LANE

thornagers.com | 1,600 sq ft



Venues at Local Attractions

THE ARBORETUM AT FLAGSTAFF

thearb.org | 925 sq ft

ARIZONA SNOWBOWL

arizonasnowbowl.com | 9,620 sq ft

Full Service Property



DOUBLETREE BY HILTON

flagstaff.doubletree.com

183 guest rooms

6,243 sq ft

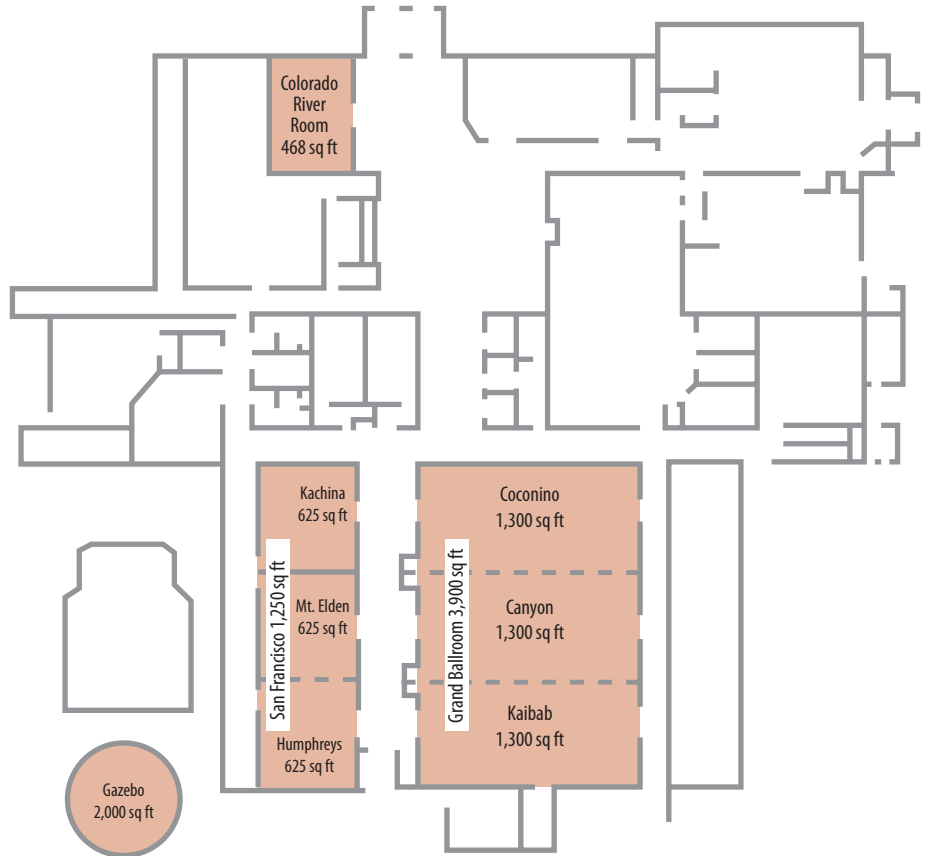

COCONINO CENTER FOR THE ARTS

culturalpartners.org | 7,580 sq ft

LOWELL OBSERVATORY

lowell.edu | 2,682 sq ft

MUSEUM OF NORTHERN ARIZONA | musnaz.org

HISTORIC COLTON HOUSE

MUSEUM OF NORTHERN ARIZONA | musnaz.org | 1,514 sq ft

ORPHEUM THEATER

orpheumpresents.com | seating for 950

PEPSI AMPHITHEATER AT FORT TUTHILL PARK

pepsiamp.com

RIORDAN MANSION STATE HISTORIC PARK

azstateparks.com | 1,000 sq ft



Northern Arizona University

ARDREY AUDITORIUM

nau.edu | 156,777sq ft | fixed seating for 1,492

ASHURST AUDITORIUM

nau.edu | seating for 250

DU BOIS CENTER | nau.edu | 16,824 sq ft

PROCHNOW AUDITORIUM | nau.edu | fixed seating for 941

UNIVERSITY UNION | nau.edu | 6,114 sq ft

J.L. LAWRENCE WALKUP SKYDOME

nau.edu | 272,000 sq ft | fixed seating for 15,000

Full Service Property



LITTLE AMERICA HOTEL

flagstaff.littleamerica.com

247 guest rooms

13,770 sq ft

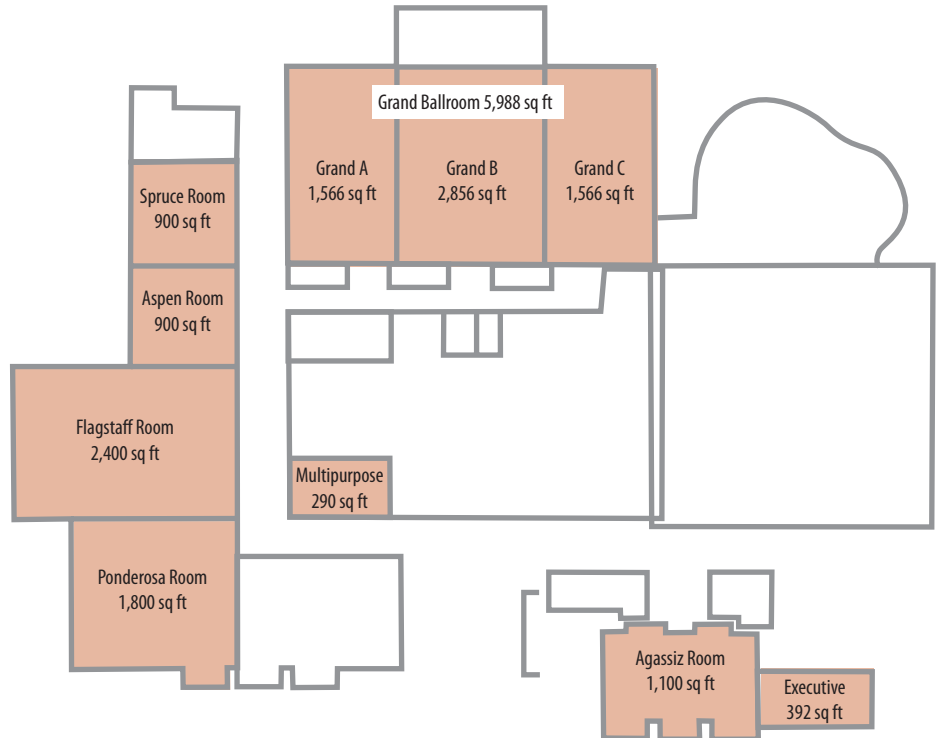

Limited Service Properties



COMFORT INN

choicehotels.com/hotel/az080

85 guest rooms | 400 sq ft

COURTYARD BY MARRIOTT

164 guest rooms | flagstaffcourtyard.com | 954 sq ft

DAYS INN WEST

120 guest rooms | daysinn.com | 1,161 sq ft

EMBASSY SUITES

119 guest rooms | flagstaff.embassysuites.com | 700 sq ft

HAMPTON INN & SUITES

126 guest rooms | flagstaffsuites.hamptoninn.com | 2,265 sq ft

HAMPTON INN & SUITES FLAGSTAFF EAST

103 guest rooms | hamptoninn3.hilton.com | 371 sq ft

HOLIDAY INN EXPRESS

155 guest rooms | hiflagstaff.com | 900 sq ft

HISTORIC HOTEL WEATHERFORD

11 guest rooms
weatherfordhotel.com | 4,200 sq ft

LA QUINTA INN & SUITES

128 guest rooms | 939.lq.com | 1,200 sq ft

SPRINGHILL SUITES BY MARRIOTT

112 guest rooms | flagstaffspringhillsuites.com | 375 sq ft



Drive time from Flagstaff

Grand Canyon National Park	1h, 20 min
Canyon de Chelly National Monument	2h, 55 min
Hoover Dam	3h, 10 min
Lake Powell and Page	2h, 10 min
Las Vegas, NV	3h, 50 min
Laughlin, NV	2h, 40 min
Los Angeles, CA	6h, 50 min
Meteor Crater	45 min
Monument Valley	2h, 50 min
Painted Desert and Petrified Forest	1h, 50 min
Phoenix	2h, 10 min
Tucson	4h
Sedona	45 min
Tuba City	1h, 30 min
Chinle	3h
Window Rock	2h, 50 min
Kayenta	2h, 30 min
Sunset Crater Volcano National Monument	30 min
Walnut Canyon National Monument	20 min
Wupatki National Monument	1h

Average Flagstaff Temperatures

	High F°	Low F°	Precipitation inches
January	43	16	2.18
February	46	19	2.56
March	50	23	2.62
April	58	27	1.29
May	68	34	0.80
June	79	41	0.43
July	82	50	2.40
August	80	49	2.89
September	74	42	2.12
October	63	31	1.93
November	51	22	1.86
December	44	17	1.83



Grand Canyon National Park | Only 80 miles from Flagstaff



Flagstaff

Situated in the world's largest ponderosa pine forest, yet readily accessible by air and interstate, Flagstaff is a spectacular location

for meetings, events and incentive groups. With a wide variety of dining and nightlife and conveniently located near attractions like Grand Canyon national Park, Flagstaff is the perfect home base from which to explore northern Arizona. The city offers a wide array of conventional and unique meeting facilities, including full service conference hotels and conference center, each beckoning with beautiful natural surroundings.

The staff at the Flagstaff Convention and Visitors Bureau would be happy to assist you with the following aspects of your next meeting event:

- Non-biased information
- Personalized site inspections
- Promotion of your event through collateral materials and photos
- Planning assistance
- Providing leads to the community on your behalf
- Publicizing your event
- Area Information for Registration Table and Welcome Bags
- DMC referrals

Team Building:

- Beer/Wine and Food Tours
- Bike Tours
- Bowling
- Challenge Courses
- Escape Rooms
- Horseback Riding, Wagon Rides & BBQs
- Jeep Tours
- National/State Parks
- Scenic Train Rides
- Star Gazing

For information on these and other creative team building opportunities please contact Jessica Young.



Jessica Young

Sales and Marketing Manager · Meetings and Events
928-213-2920 · JYoung@flagstaffaz.gov

meetinflagstaff.org

Nice to meet you!