



PANDUIT PART NUMBER	WEIGHT
FROVRA6X4	0.84 LB/EACH (382g/EACH)



**J** NOTES:

1. SEE CURRENT CATALOG FOR ADDITIONAL PART SUFFIXES TO INDICATE COLOR AND/OR PACKAGE QUANTITY.
2. THE FIBERRUNNER 6x4 OUTSIDE VERTICAL RIGHT ANGLE FITTING IS DESIGNED WITH A MINIMUM 2" (50.8) BEND RADIUS TO PROTECT FIBER OPTIC CABLES.
3. DIMENSIONS IN PARENTHESES ARE IN METRIC.

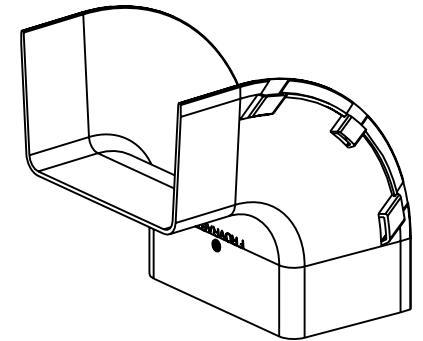
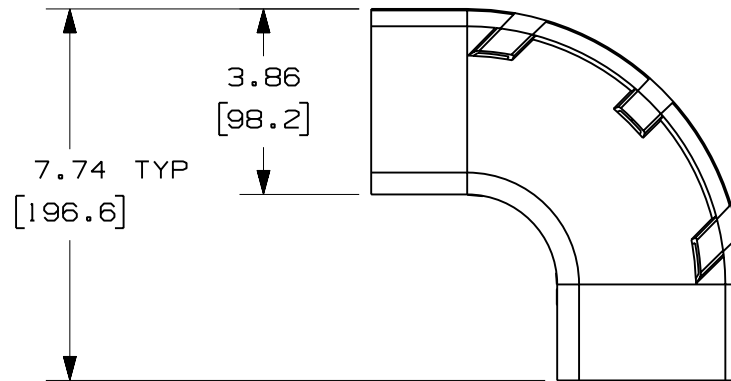
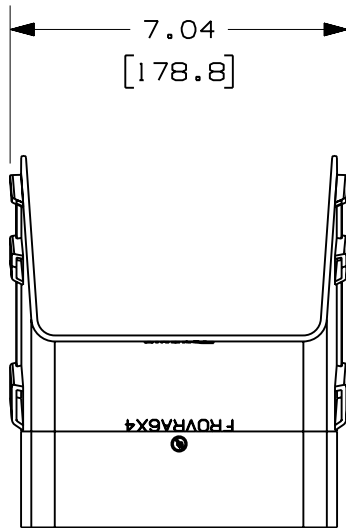

ENG. REF.: D37185E0\_DC\_FROVRA6X4\_02.prt

CAD FILENAME/LAYERS

**I** FROVRA6X4.pdf

**PANDUIT** CORP TINLEY PARK, ILLINOIS  
 FIBERRUNNER 6x4 OUTSIDE VERTICAL  
 RIGHT ANGLE FITTING (FROVRA6X4)  
 CUSTOMER DRAWING

UNLESS OTHERWISE SPECIFIED,  
 DIMENSIONAL TOLERANCES ARE:

(.X) ± (.XXX) ±  
 (.XX) ± .03 (.8) ANGLES ±

UNLESS OTHERWISE SPECIFIED,  
 ALL DIMENSIONS ARE GIVEN IN  
 INCHES, THIRD ANGLE PROJECTION.

DRAWN BY: REWE  
 DATE: 4-28-00  
 CHK'D: HIW

MAT'L:

ABS

SCALE: NONE

DRAWING NO.: 37185-61 DWG SIZE: A

-	-----	---	---	K. REVISED PART WEIGHT J. REVISED GENERAL NOTES	-----	--	--					
3	7-10-06	DTP	RN	I. REVISED CAD FILENAME H. REVISED AND REDRAWN	37185-61	RN	RN					
REV	DATE	BY	CHK	DESCRIPTION	ECN	R	CUST	SUP	GMBH			