

2120 DUAL CRADLE BIN DUMPER, ELECTRO-HYDRAULIC

*Introducing the newest, most advanced Bin Dumper on the market!
Order yours today!*

FEATURES

- Innovative Channelized™ Stainless Steel Construction
- Dual cradle with “LIFT” and “TILT” action to empty bin contents
- Extraordinary 130-180 degrees of rotation ensures complete product dump
- Pallet stays away from the product zone
- Includes “SHAKE” cycle when bin is in “TILT” position
- Sloped forklift entry deck for easy access
- Slip tube leveling pads
- Stainless steel safety sides for pinch point guard system
- NEMA 4x stainless steel motor control center
- Self-contained hydraulic power unit with reservoir

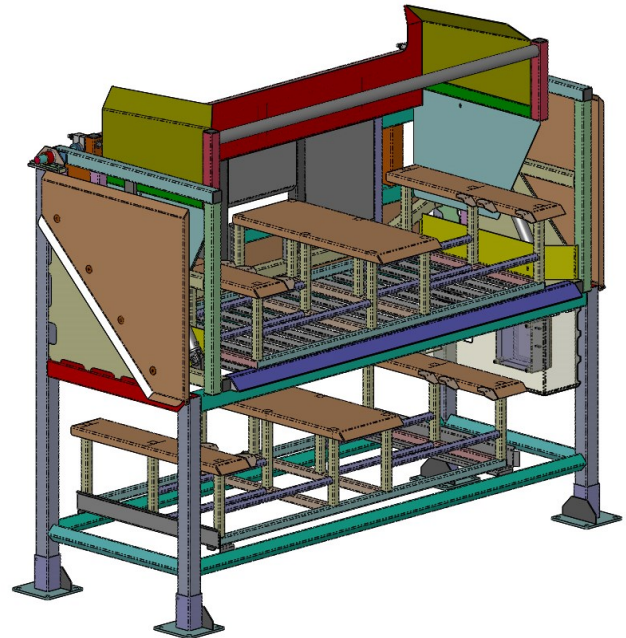

OPTIONS/SPECIFICATIONS

- Available in single (48”x48”) or double bin capacity (custom-sized for each application)
- Short bin insert with undercarriage storage available. Lifts short bins to correct discharge height.
- Optional safety floor loop. Interlocked to UP/DOWN control to disable when forklift present.
- 5hp/1750RPM/208-230/460V wash down motor with fixed displacement pump with stainless steel power unit.
- 5 GPM hydraulic flow
- Drive: Electrically activated hydraulic control valves/controls: Proximity switches with UP/DOWN push buttons
- Capacity: Single: 1,000lbs / Double: 2,000lbs.

PRODUCT APPLICATIONS

- Raw Product Bins on Wooden Pallets
- Bins that use Liners
- Product that requires full discharge rotation

HEINZEN™

YOUR PARTNER IN FOOD SAFE INNOVATION