

### Building Sketch

Borrower	N/A		
Property Address	4959 Habersham Walk		
City	Gainesville	County	HALL
Lender/Client	N/A	State	GA
		Zip Code	30504-5145

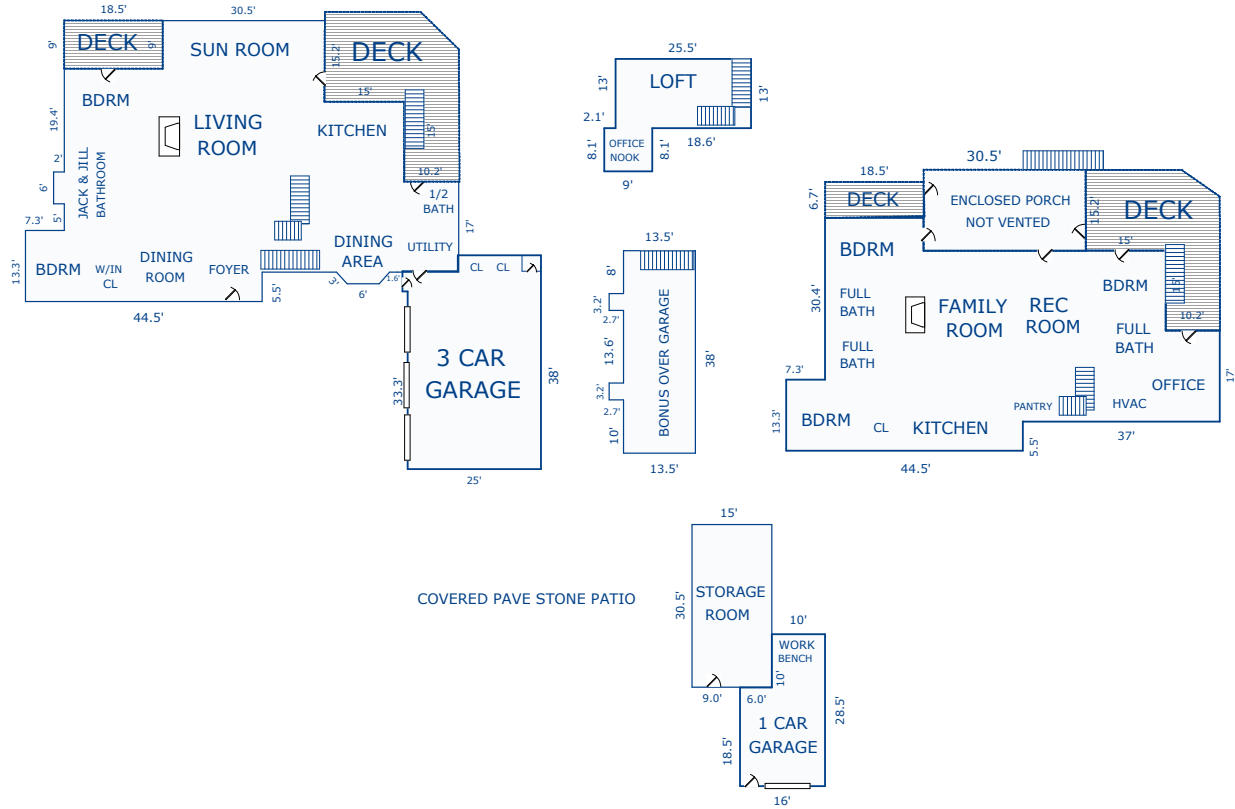

Sketch by Apex Sketch v5 Standard™

Comments:

AREA CALCULATIONS SUMMARY			
Code	Description	Net Size	Net Totals
GLA1	First Floor	3130.99	3130.99
GLA2	Second Floor	404.40	404.40
BSMT	Basement	2637.79	2637.79
GAR	Garage	978.10	
	BASEMENT GARAGE	396.00	1374.10
P/P	SUN ROOM	463.60	
	COVERED DECK	121.84	
	DECK	555.06	
	DECK	166.50	
	DECK	515.40	1822.40
OTH	BONUS OVER GARAGE	530.28	
	Storage lower level	457.50	987.78
Net LIVABLE Area		(rounded)	3535

LIVING AREA BREAKDOWN			
	Breakdown		Subtotals
First Floor			
0.5 x	2.2 x	2.0	2.20
	44.5 x	5.5	244.75
0.5 x	2.0 x	2.2	2.20
	6.0 x	2.2	13.20
	81.5 x	7.8	635.70
	1.8 x	66.0	118.80
	4.2 x	76.2	320.04
	5.0 x	74.2	371.00
	6.2 x	49.0	303.80
	13.2 x	64.0	844.80
	9.0 x	30.5	274.50
Second Floor			
	25.5 x	13.0	331.50
	8.1 x	9.0	72.90
13 Items	(rounded)		3535