

116 Ivy Road
Mills River, NC 28759

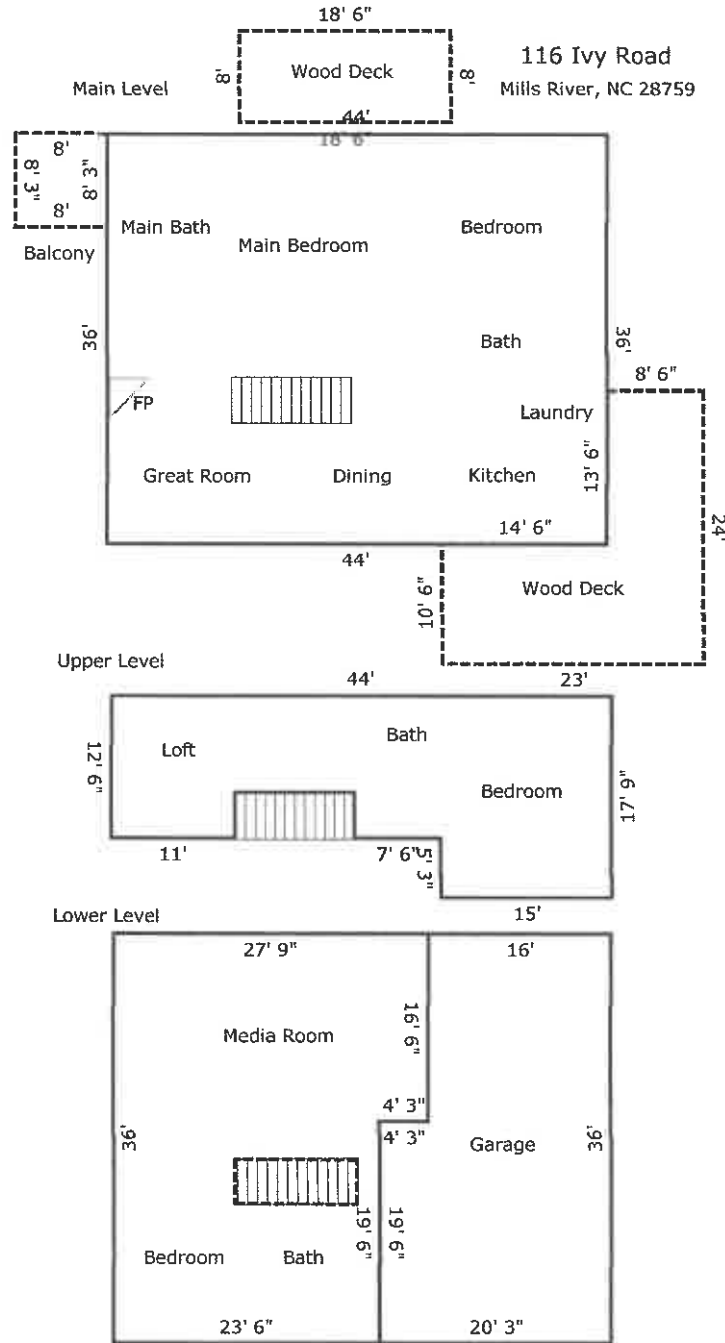

TOTAL Sketch by a la mode, inc.

Area Calculations Summary

Living Area	
Main Level	1584 Sq ft
Upper Level	586.71 Sq ft
Lower Level	916.13 Sq ft
Staircase	-41.8 Sq ft
Total Living Area (Rounded):	3045 Sq ft
Non-living Area	
Wood Deck	356.25 Sq ft
Wood Deck	66 Sq ft
Wood Deck	148 Sq ft
2 Car Attached	658.88 Sq ft