

Building Sketch (Page - 1)

Borrower	N/A						
Property Address	3143 Winding Lake Dr						
City	Gainesville	County	Hall	State	GA	Zip Code	30504
Lender/Client	Kim Waters						

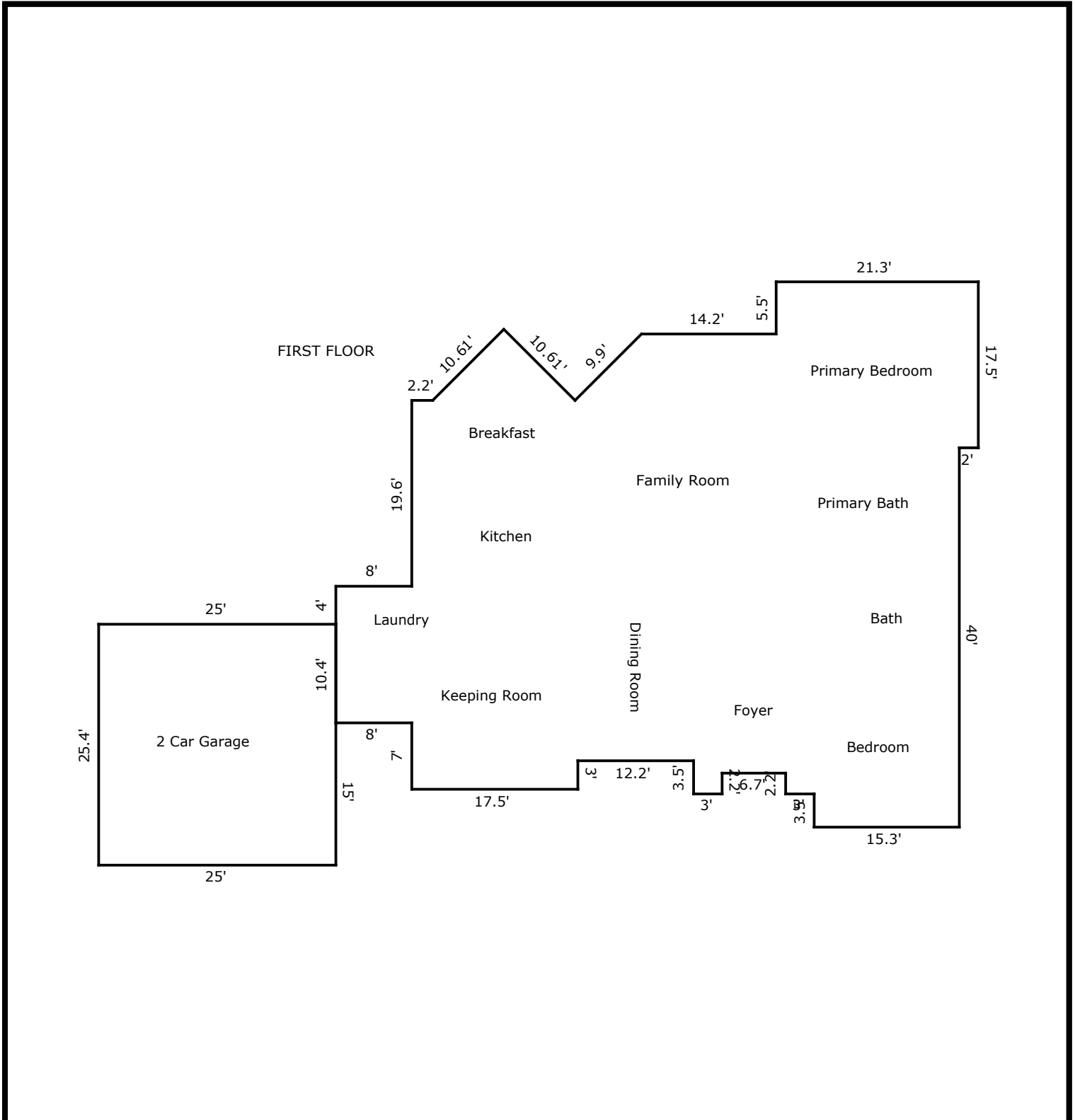

TOTAL Sketch by a la mode

Area Calculations Summary

Living Area	Calculation Details	
First Floor	2953.51 Sq ft	$14.4 \times 8 = 115.2$ $21.3 \times 5.5 = 117.15$ $15.3 \times 3.5 = 53.55$ $12 \times 2 = 24$ $48.5 \times 18.3 = 887.55$ $3 \times 2.2 = 6.6$ $46.3 \times 9.7 = 449.11$ $17.5 \times 3 = 52.5$ $29.7 \times 38 = 1128.6$ $7 \times 5.5 = 38.5$ $0.5 \times 7 \times 7 = 24.5$ $0.5 \times 15 \times 7.5 = 56.25$
Total Living Area (Rounded):	2954 Sq ft	
Non-living Area		
2 Car Garage	635 Sq ft	$25 \times 25.4 = 635$

Building Sketch (Page - 2)

Borrower	N/A			
Property Address	3143 Winding Lake Dr			
City	Gainesville	County Hall	State	GA
Lender/Client	Kim Waters		Zip Code	30504

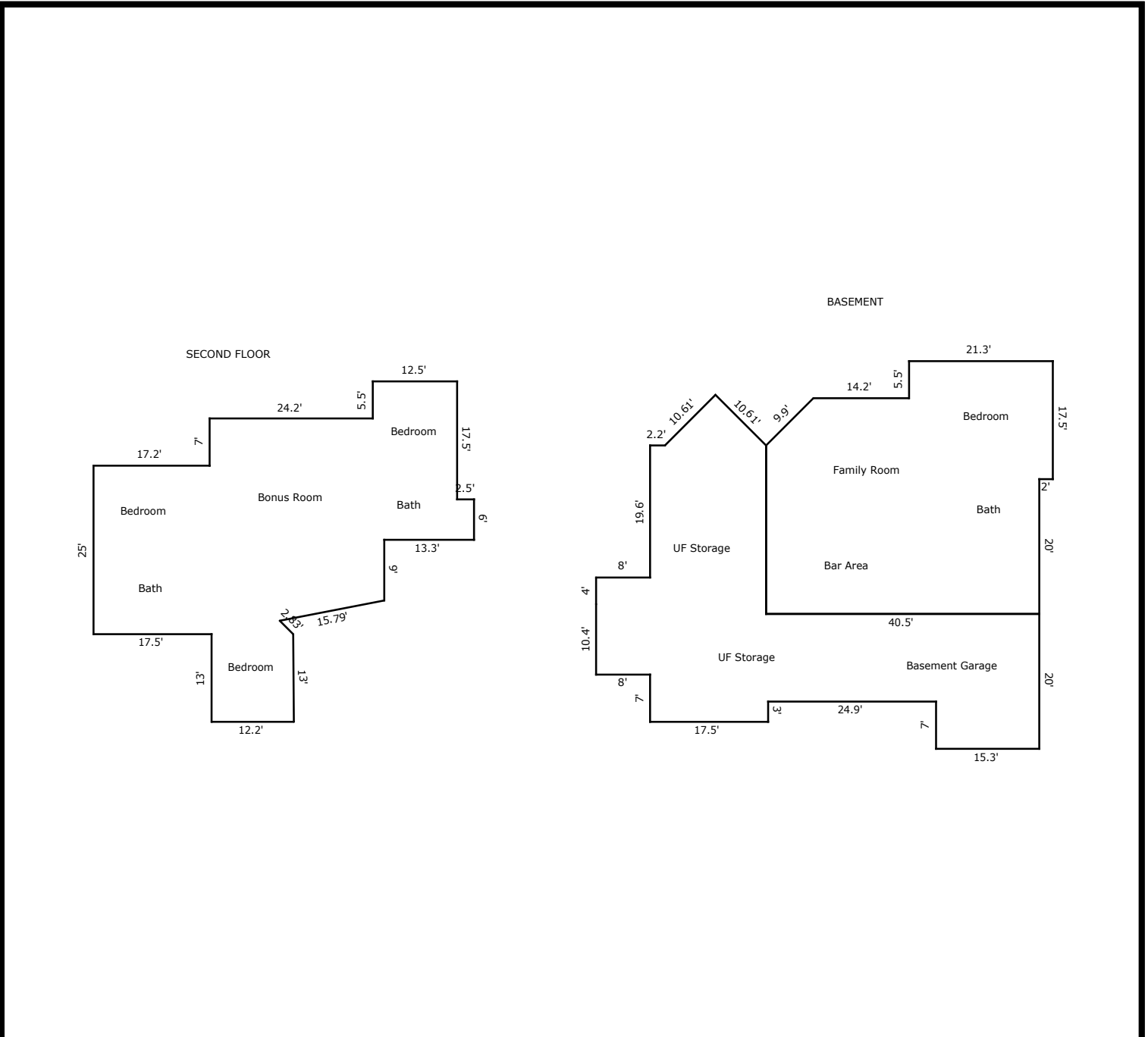

TOTAL Sketch by a la mode

Area Calculations Summary

Living Area	Calculation Details	
Second Floor	1642.65 Sq ft	
		$0.5 \times 13 \times 0.1 = 0.65$
		$12.1 \times 13 = 157.3$
		$25 \times 17.2 = 430$
		$12.5 \times 5.5 = 68.75$
		$6 \times 2.5 = 15$
		$18 \times 10.8 = 194.4$
		$25.9 \times 27 = 699.3$
		$5 \times 10.4 = 52$
		$0.5 \times 2 \times 2 = 2$
		$0.5 \times 3 \times 15.5 = 23.25$
Total Living Area (Rounded):	1643 Sq ft	
Non-living Area		
Unfinished Basement	1511.15 Sq ft	
		$14.4 \times 8 = 115.2$
		$20 \times 15.3 = 306$
		$13 \times 24.9 = 323.7$
		$17.5 \times 16 = 280$
		$17.2 \times 25 = 430$
		$0.5 \times 15 \times 7.5 = 56.25$
Finished Basement	1412.65 Sq ft	
		$40.5 \times 20 = 810$
		$17.5 \times 21.3 = 372.75$
		$12 \times 14.2 = 170.4$
		$7 \times 5 = 35$
		$0.5 \times 7 \times 7 = 24.5$