



US006691707B1

(12) **United States Patent**
Gunaratnam et al.

(10) **Patent No.:** **US 6,691,707 B1**
(45) **Date of Patent:** **Feb. 17, 2004**

(54) **CONNECTOR FOR A RESPIRATORY MASK
AND A RESPIRATORY MASK**

(75) **Inventors:** **Michael K. Gunaratnam**, Marsfield
(AU); **Joanne E. Drew**, Balgowlah
(AU); **Geoffrey Crumblin**, Baulkham
Hills (AU); **Phillip Jenkinson**, Epping
(AU); **Susan R. Lynch**, Rodd Point
(AU)

(73) **Assignee:** **ResMed Limited**, North Ryde (AU)

(*) **Notice:** Subject to any disclaimer, the term of this
patent is extended or adjusted under 35
U.S.C. 154(b) by 0 days.

(21) **Appl. No.:** **09/594,775**

(22) **Filed:** **Jun. 16, 2000**

(30) **Foreign Application Priority Data**

Jun. 18, 1999 (AU) PQ 1029

(51) **Int. Cl.⁷** **A62B 18/02**

(52) **U.S. Cl.** **128/206.21; 128/207.13**

(58) **Field of Search** 128/206.21, 207.13,
128/207.18, 206.28, 205.27, 205.28, 204.18,
202.27, 912, 207.12, 206.12, 206.15, 206.18

(56) **References Cited**

U.S. PATENT DOCUMENTS

4,015,598 A * 4/1977 Brown 128/203.23
4,463,755 A 8/1984 Suzuki
4,794,921 A * 1/1989 Lindkvist 128/203.29
5,018,519 A * 5/1991 Brown 128/203.29

5,560,354 A * 10/1996 Berthon-Jones
et al. 128/205.25
5,694,922 A * 12/1997 Palmer 128/202.27
5,871,011 A * 2/1999 Howell et al. 128/206.22
5,921,239 A * 7/1999 McCall et al. 128/205.25
5,937,851 A * 8/1999 Scrowski et al. 128/202.27
5,975,077 A * 11/1999 Hofstetter et al. 128/204.24
6,196,223 B1 * 3/2001 Belfer et al. 128/206.25

FOREIGN PATENT DOCUMENTS

CA 1039144 9/1978
DE 197 57 703 C1 10/1999
WO WO 98/34665 8/1998

* cited by examiner

Primary Examiner—Weilun Lo

Assistant Examiner—Tenna Mitchell

(74) *Attorney, Agent, or Firm*—Nixon & Vanderhye, P.C.

(57) **ABSTRACT**

A connector includes a mask end for connecting with the interior of a respiratory mask, a supply conduit end, and a gas washout vent passage having an inlet adjacent to, or forming part of, the mask end in fluid communication with the interior of the respiratory mask and an outlet in fluid communication with atmosphere. The vent outlet of the vent passage is disposed on the side of the connector remote from the mask end. A respiratory mask includes a mask shell, a mask inlet for connecting with the outlet of a breathable gas supply conduit, and a gas washout vent passage. A vent outlet is disposed on the side of the mask remote from the mask interior and is adapted to direct the washout gas in a direction substantially parallel to the longitudinal axis of the mask inlet and away from the mask inlet.

14 Claims, 9 Drawing Sheets

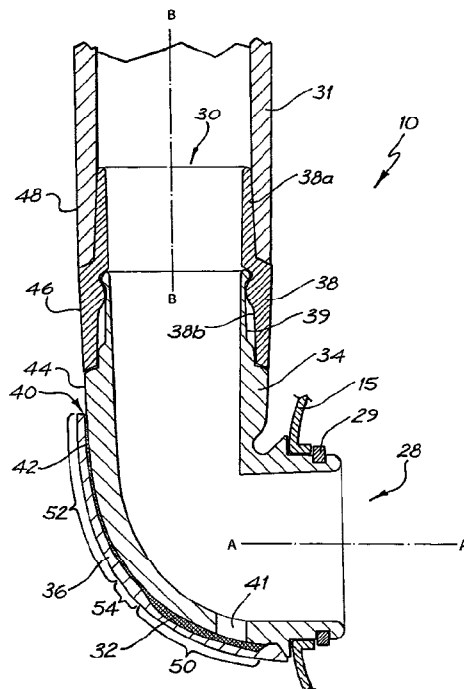

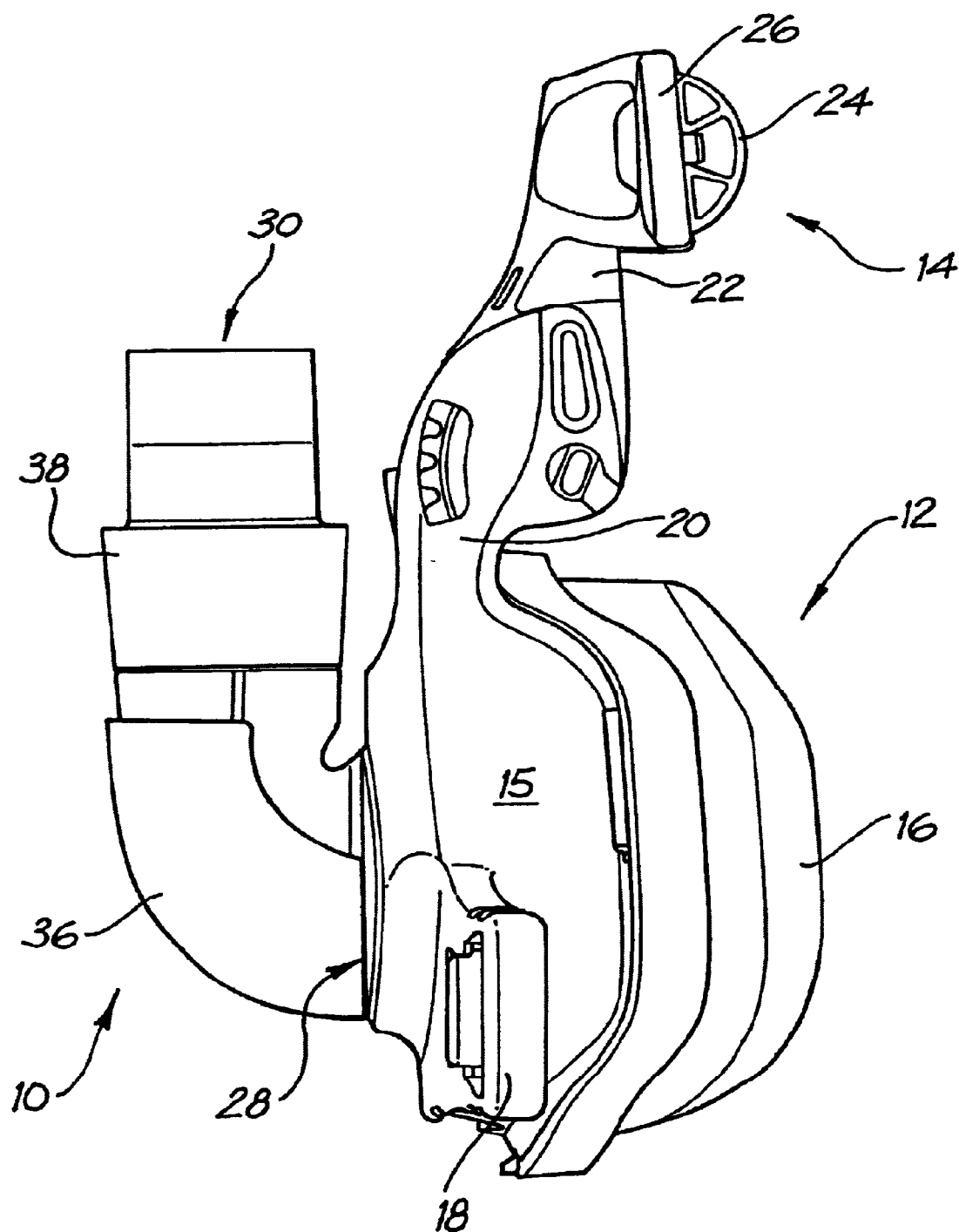
**FIG. 1**

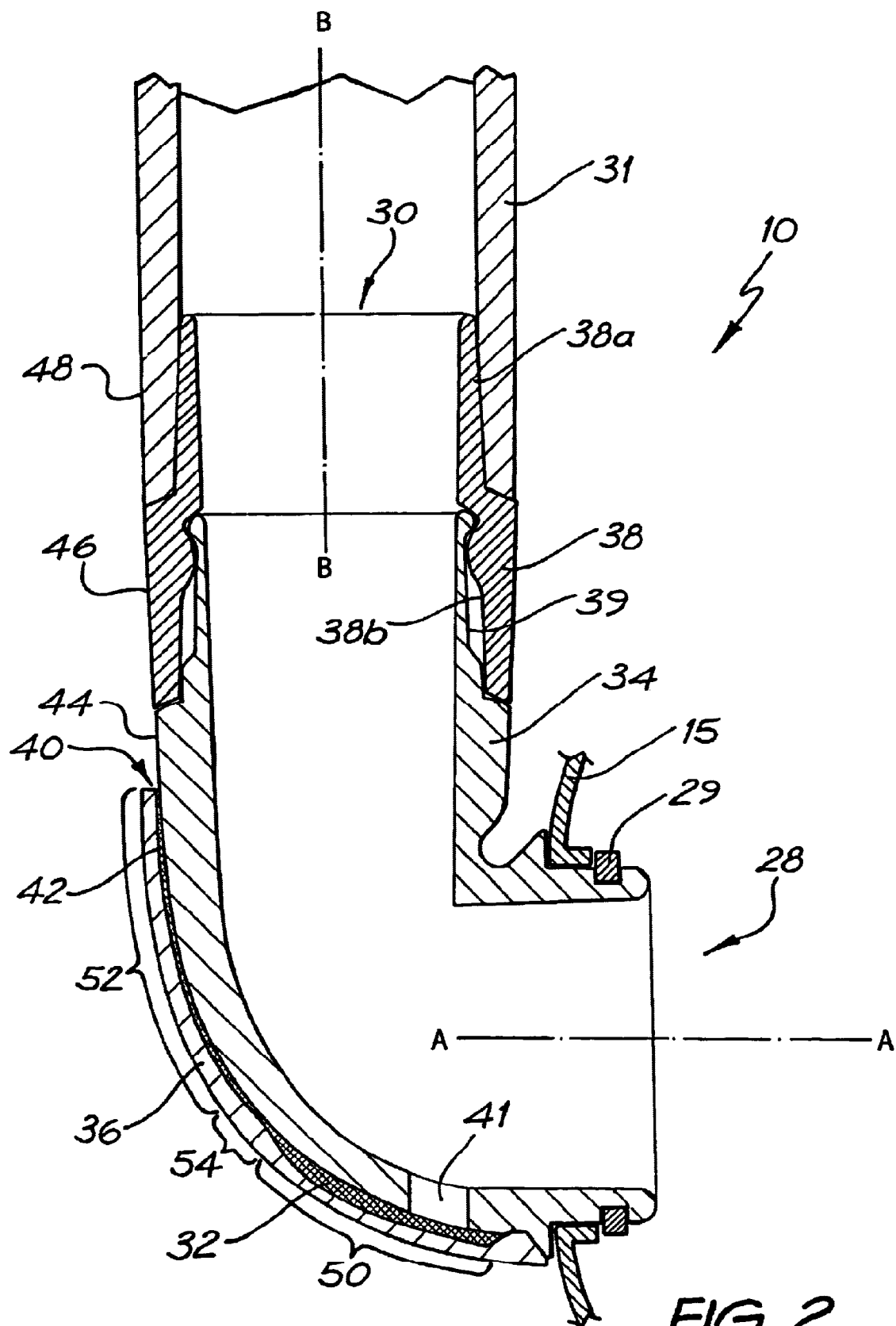
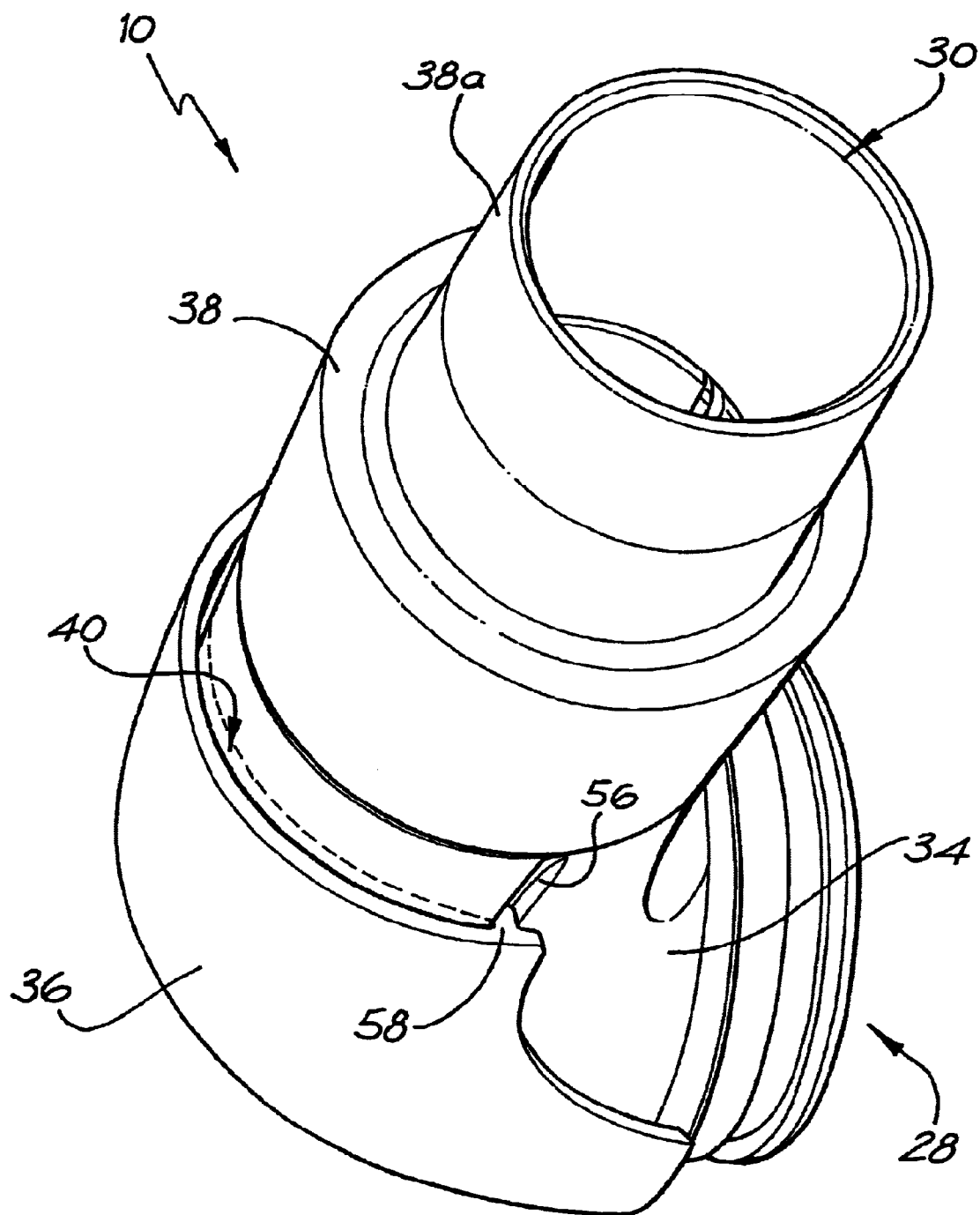
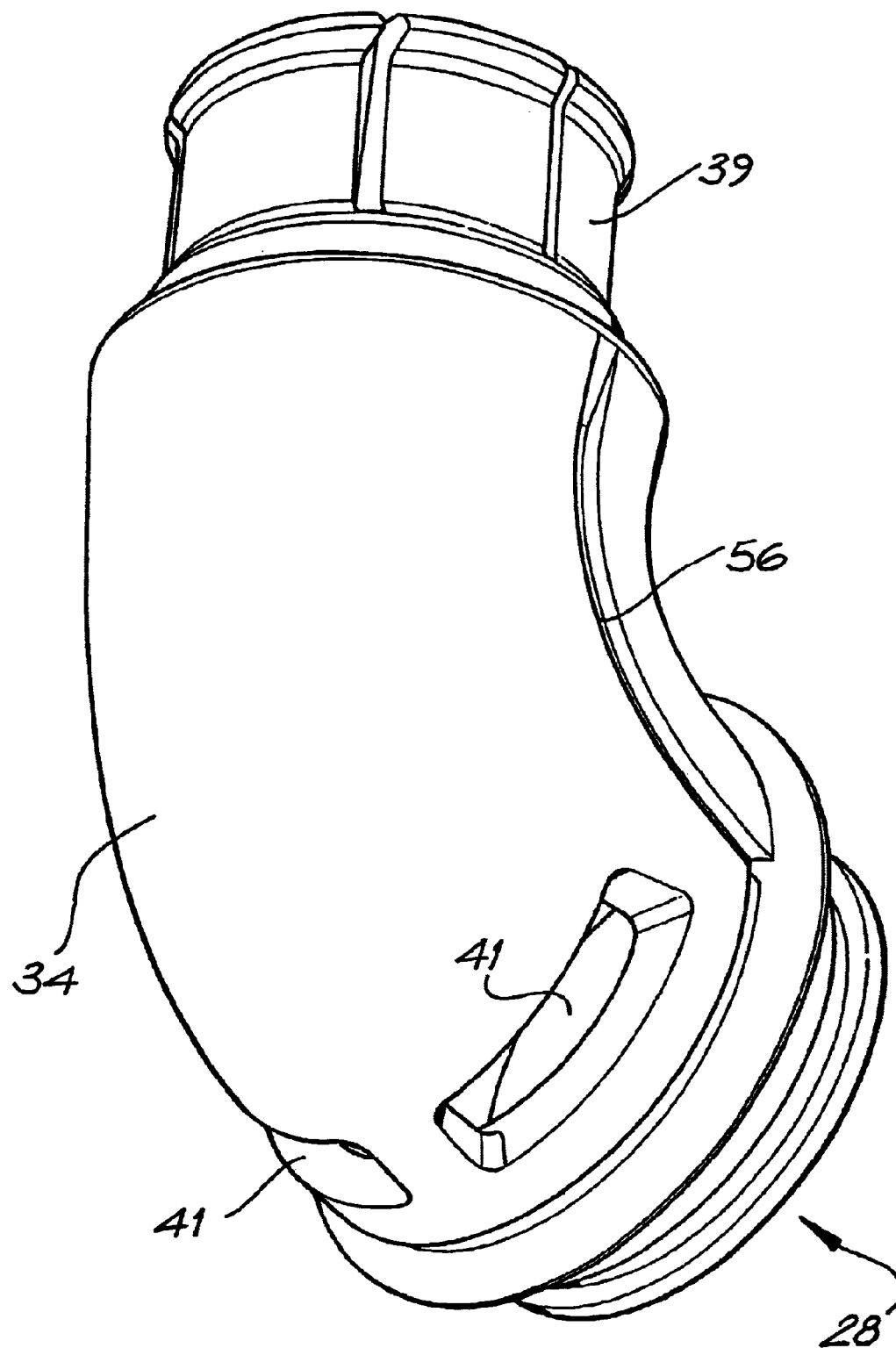

FIG. 2

**FIG. 3**

**FIG. 4**

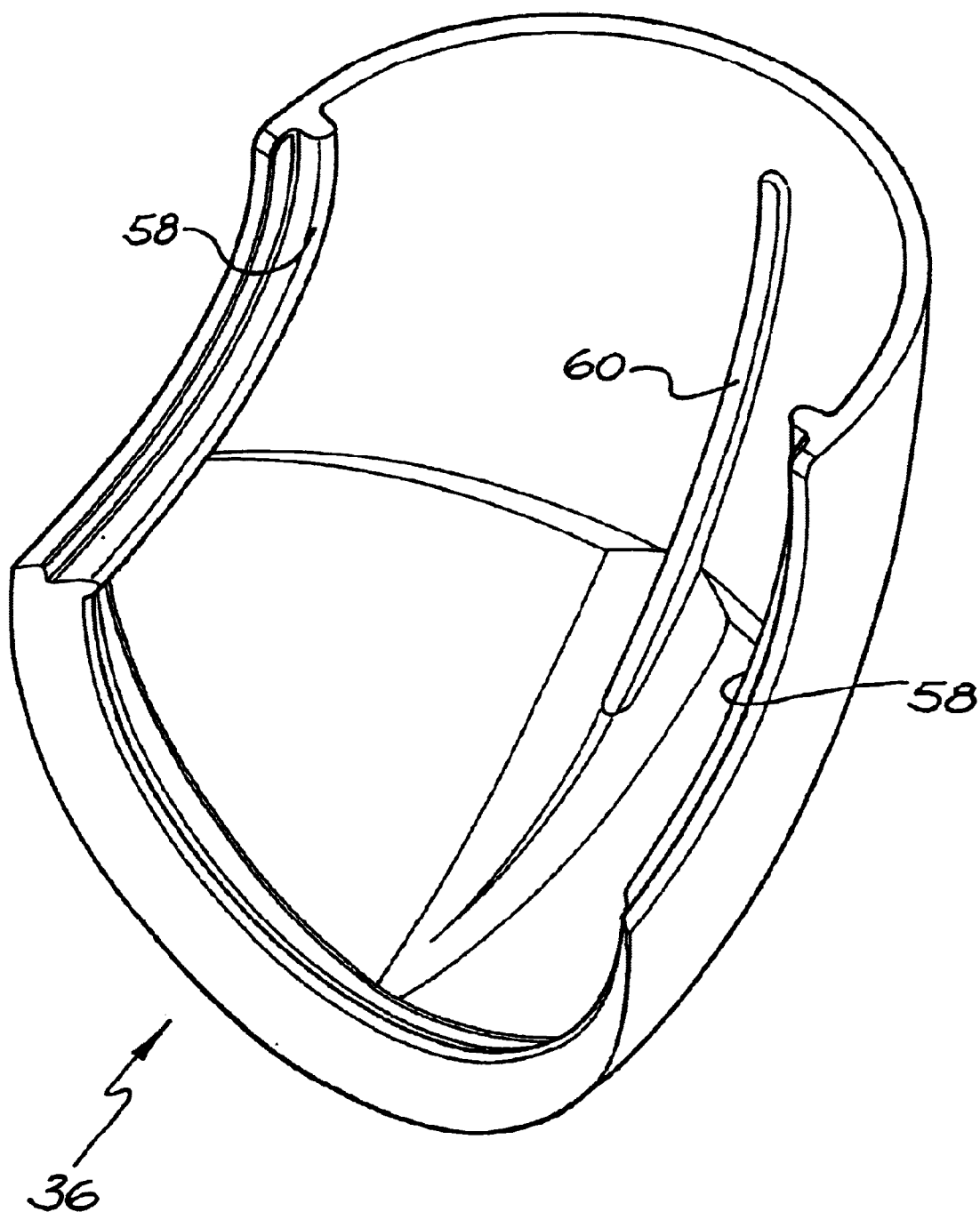
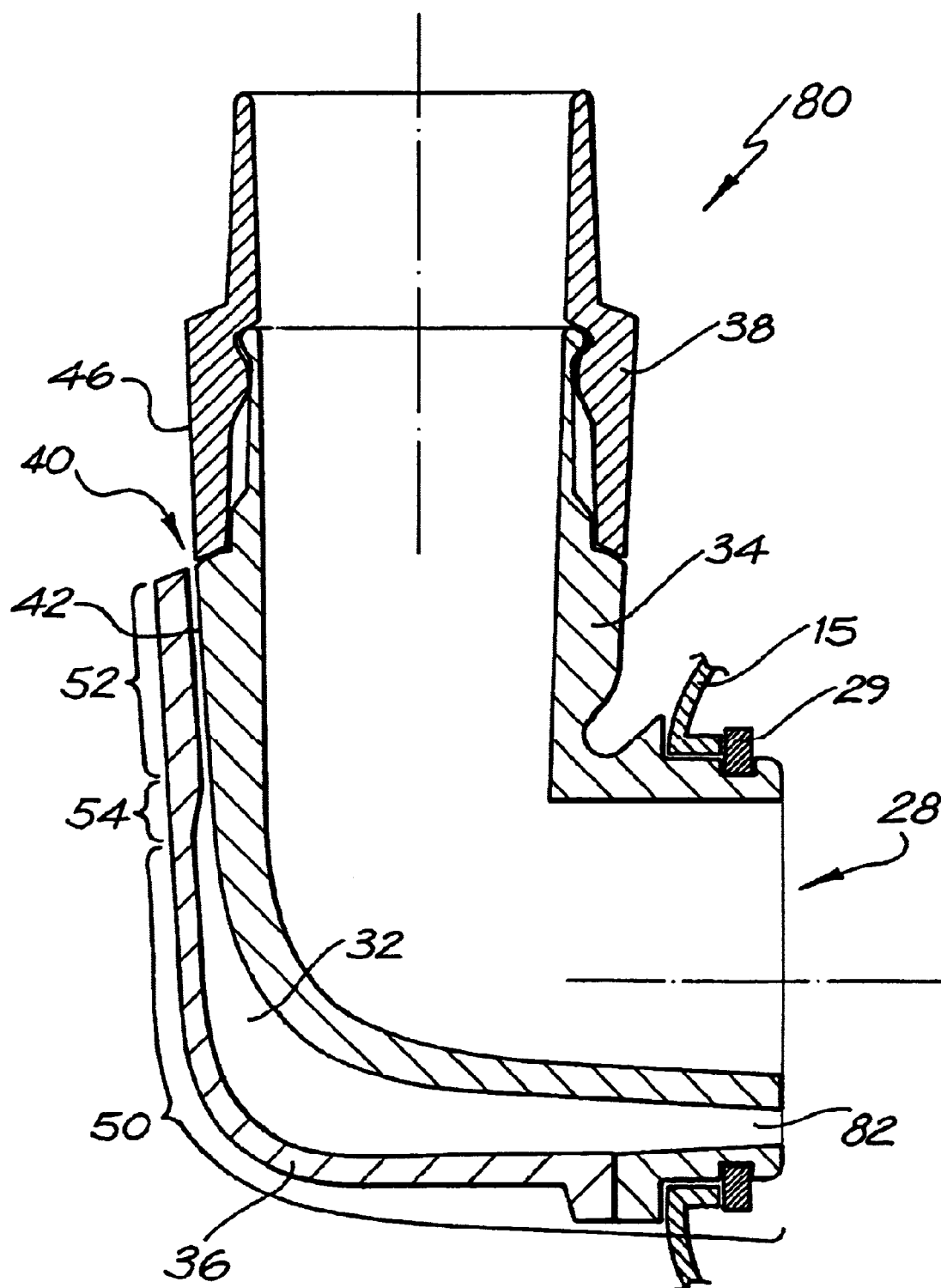

FIG. 5

**FIG. 6**

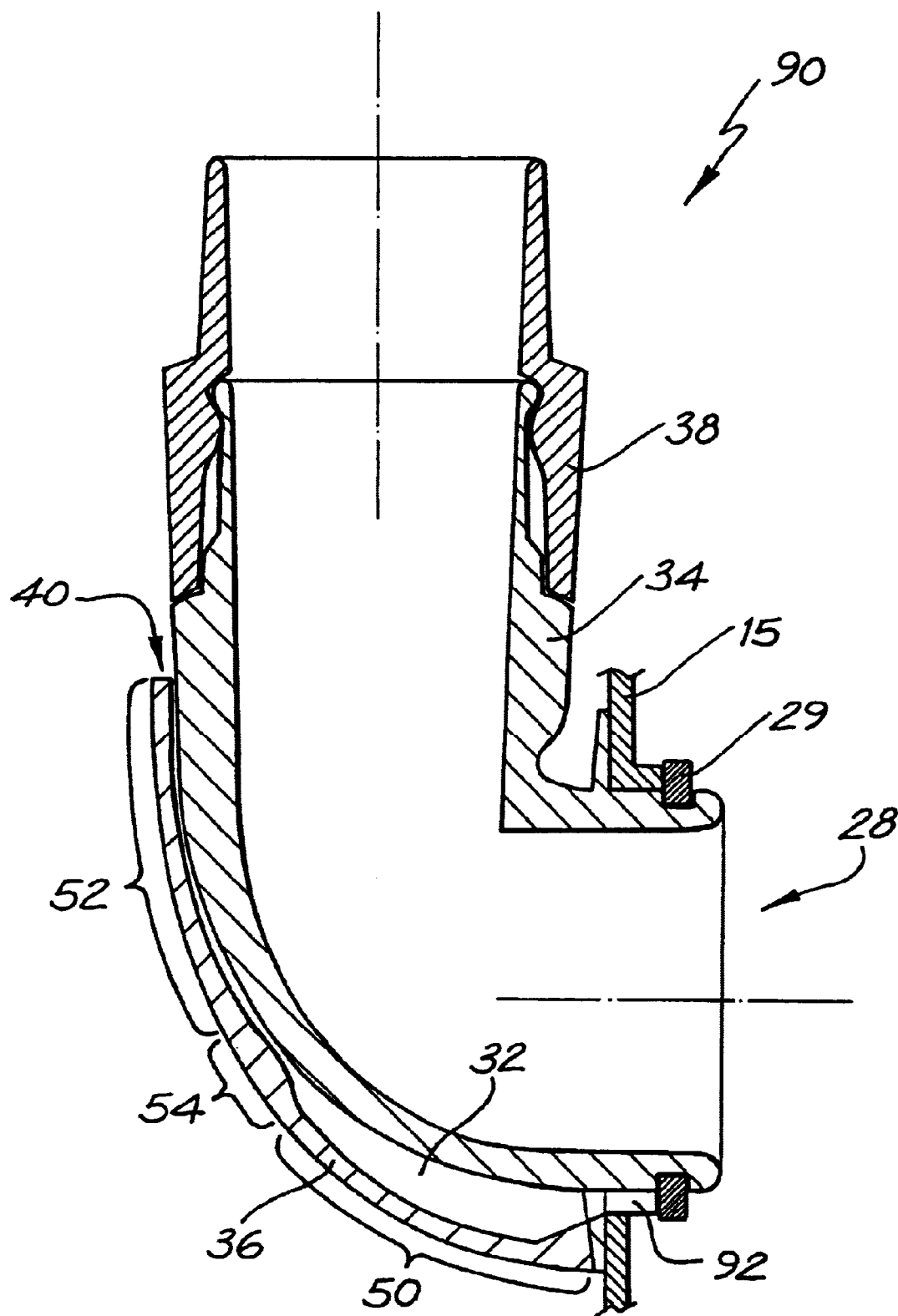

FIG. 7

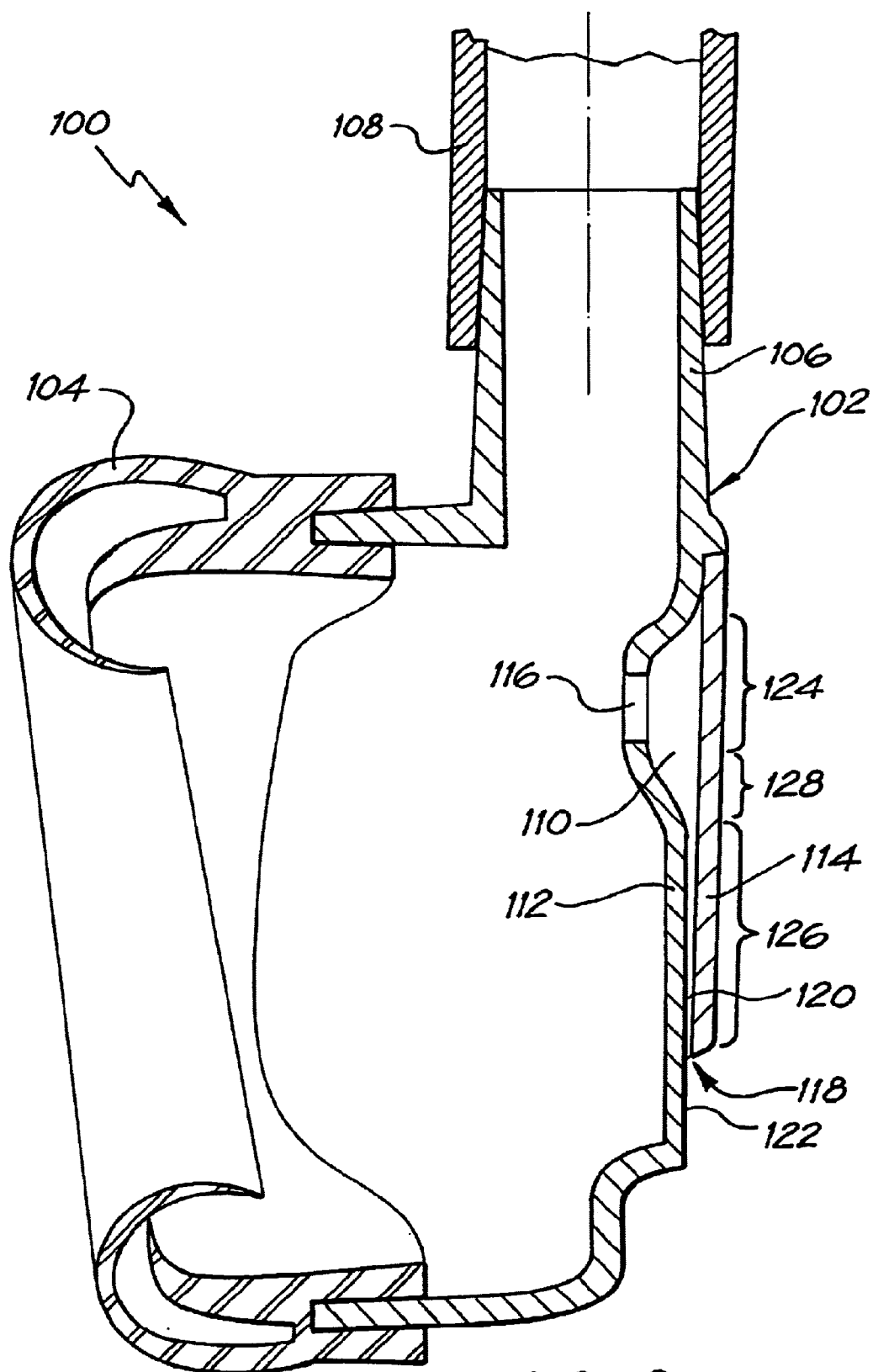
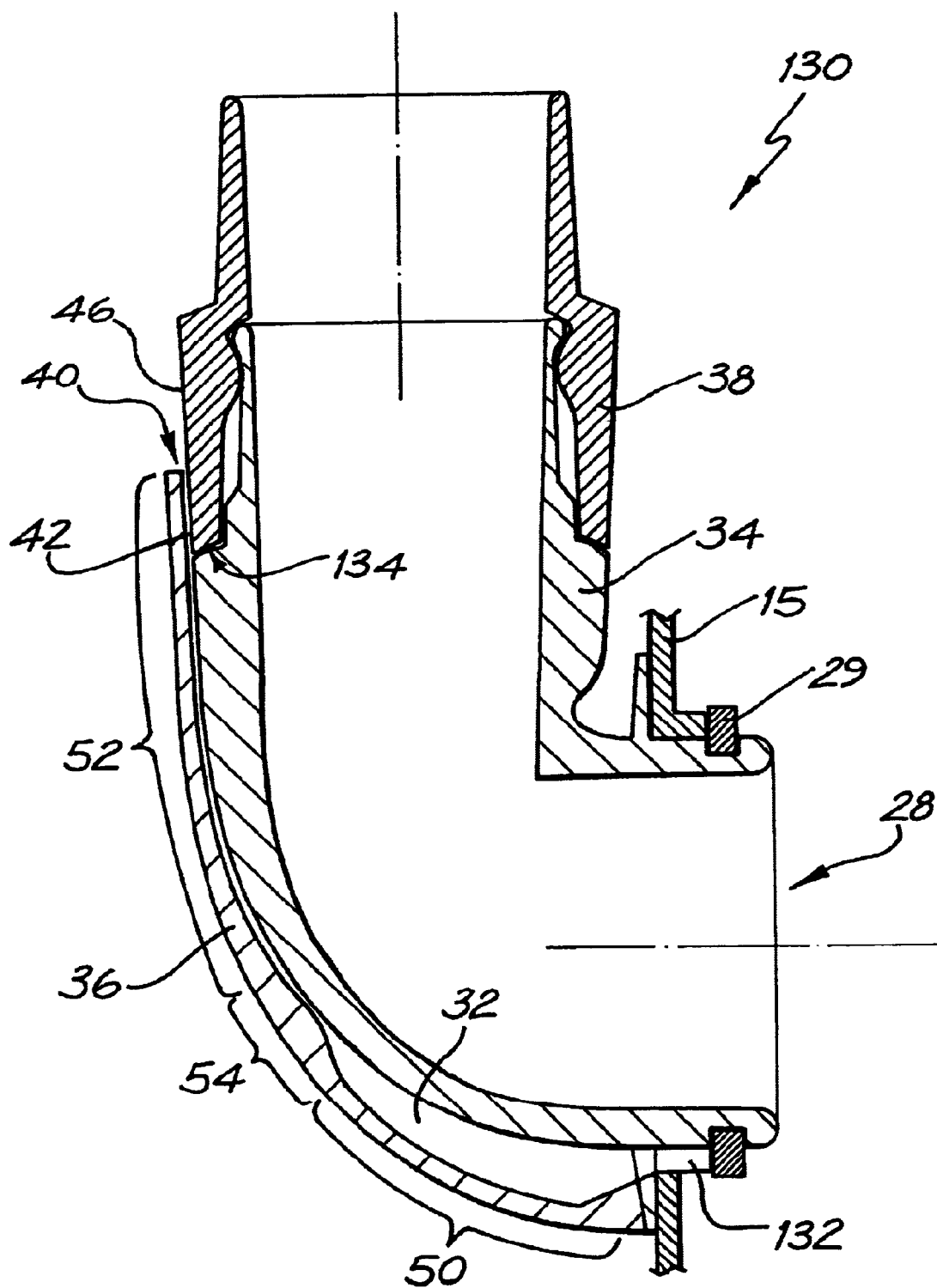

FIG. 8

**FIG. 9**

1

CONNECTOR FOR A RESPIRATORY MASK AND A RESPIRATORY MASK

BACKGROUND OF THE INVENTION

1. Field of Invention

The present invention relates to a connector for a respiratory mask and a respiratory mask.

The invention has been developed primarily for use with a breathable gas supply apparatus in Continuous Positive Airway Pressure (CPAP) treatment of, for example, Obstructive Sleep Apnea (OSA) and other ventilatory assistance treatments, such as Non Invasive Positive Pressure Ventilation (NIPPV) and will be described hereinafter with reference to these applications. However, it will be appreciated that the invention is not limited to these particular fields of use and also finds application in, for example, assisted respiration, mechanical ventilation and the like.

2. General Background and Related Art

CPAP treatment is a common ameliorative treatment for breathing disorders including OSA. CPAP treatment, as described in U.S. Pat. No. 4,944,310, provides pressurized air or other breathable gas to the entrance of a patient's airways at a pressure elevated above atmospheric pressure, typically in the range 3–20 cm H₂O.

It is also known for the level of treatment pressure to vary during a period of treatment in accordance with patient need, that form of CPAP being known as automatically adjusting nasal CPAP treatment, as described in U.S. Pat. No. 5,245,995.

NIPPV is another form of treatment for breathing disorders which can involve a relatively higher pressure of gas being provided in the patient mask during the inspiratory phase of respiration and a relatively lower pressure or atmospheric pressure being provided in the patient mask during the expiratory phase of respiration.

In other NIPPV modes, the pressure can be made to vary in a complex manner throughout the respiratory cycle. For example, the pressure at the mask during inspiration or expiration can be varied through the period of treatment, as disclosed in the applicant's international PCT patent application No. PCT/AU97/00631.

Typically, the ventilatory assistance for CPAP or NIPPV treatment is delivered to the patient by way of a respiratory, preferably nasal, mask. Alternatively, a mouth mask or full face mask can be used. In this specification any reference to a mask is to be understood as incorporating a reference to a nasal mask, mouth mask or full face mask, unless otherwise specifically indicated.

In this specification any reference to CPAP treatment is to be understood as embracing all of the above-described forms of ventilatory treatment or assistance.

Breathable gas supply apparatus broadly comprise a flow generator constituted by a continuous source of air or other breathable gas generally in the form of a blower driven by an electric motor. The electric motor driving the blower is typically controlled by a servo-controller under the control of a micro controller unit. A hospital piped supply can also be used. The gas supply is connected to a conduit or tube which, in turn, is connected to the patient's mask which incorporates, or has in close proximity, a gas washout vent for venting exhaled gases to the atmosphere. The gas washout vent is sometimes referred to as a CO₂ washout vent.

As CPAP and NIPPV treatments are normally administered while the patient is sleeping, minimization of the noise

2

is desirable for both the comfort of the patient and any bed partner. The exhausting of exhaled gas to the atmosphere through the gas washout vent creates noise due to turbulence generated at a shear layer between the moving vented gases and the still atmospheric air.

It is also desirable to locate the vent as close as possible to the mask in a location which encourages a circulation of flow within the mask so as to eliminate exhaled CO₂ through the vent and encourage inhalation of the supplied breathable gas. In this way, the retention of CO₂ within the mask is minimized. Further, by increasing the venting efficiency in this manner, the overall gas outflow is minimized, thereby reducing the opportunity for noise production.

One approach to minimize the noise generated by the venting of the exhaled gas is to direct the gas along an exterior surface which is a smooth prolongation of an interior surface of the outlet of the gas washout vent. This reduces the interaction between the vented gas and the still atmospheric air and, thus, the noise generated.

An example of the above approach is the AeroClick vent produced by MAP which has an annular vent passage that directs the exhaled gases along an adjacent cylindrical section of equal exterior diameter to the interior diameter of the annular vent. The AeroClick vent suffers from several disadvantages. Firstly, the annular vent is incorporated into a swivel mechanism which requires a certain amount of play or clearance in order to rotate freely. This play allows the components forming the interior and exterior surfaces of the annular vent passage to become misaligned and the size of the vent outlet being decreased from optimum in some regions and increased from optimum in other regions. The decreased area regions increase by the velocity of the gas flowing therethrough which increases noise and can produce an unpleasant whistling effect. Secondly, the flow of the gas from the vent outlet to a state where its velocity is in substantial equilibrium with the atmosphere is interrupted by an external shoulder closely downstream of the vent outlet. The shoulder is provided to locate the gas supply conduit. The stresses in the flow caused by the shoulder lead to the generation of noise. Additionally, the flow path from the gas conduit into the vent outlet is not smooth which introduces discontinuities into the flow which result in further noise generation.

Further, the AeroClick vent and other prior art devices that are of a substantially cylindrical in-line configuration, the exhaled gas must thus be forced a relatively large distance (typically around 60 mm) before reaching the outlet to the atmosphere. This reduces CO₂ washout efficiency, as noted above, and requires additional patient effort to force the gas against the direction of flow coming from the flow generator.

It is an object of the present invention to substantially overcome or at least ameliorate the prior art disadvantages and, in particular, to reduce the noise generated by venting exhaled gases to the atmosphere.

SUMMARY OF THE INVENTION

Accordingly, in a first aspect, the present invention provides a connector comprising:

- a mask end for connecting in fluid communication with the interior of a respiratory mask;
- a supply conduit end disposed at an angle to the mask end for connecting in fluid communication with the outlet of a breathable gas supply conduit; and
- a gas washout vent passage having an inlet adjacent to, or forming part of, the mask end in fluid communication

3

with the interior of the respiratory mask and an outlet in fluid communication with the atmosphere, the outlet including an interior surface that forms a smooth prolongation with an adjacent exterior surface of the connector, the vent outlet is disposed on the side of the connector remote the mask end, has a generally part-annular cross section and is adapted to direct the washout gas in a direction substantially perpendicular to the longitudinal axis of the mask end and substantially parallel to the longitudinal axis of the supply conduit end towards the supply conduit end.

The supply conduit end is preferably substantially perpendicular to the mask end. The supply conduit end can also be angled at approximately 135 degrees to the mask end.

Preferably, the connector includes a body portion and a cap portion, said body portion including said interior surface. The cap portion preferably also includes an interior surface spaced apart from the body portion interior surface, said body portion interior surface and said cap portion interior surface defining said vent passage therebetween.

The cap portion is desirably detachable from the body portion. The cap portion and body portion are also desirably rigid and fixed relative to each other when attached. The exterior of the body portion preferably includes grooves or ridges adapted to engage ridges or grooves respectively on the interior of the cap portion to attach the cap portion to the body portion. One of the body portion or cap portion preferably also includes a spacer extending between said cap portion interior surface and said body portion exterior surface.

In one form, the vent passage inlet is formed in the body portion adjacent to and downstream of the mask end, relative to the washout gas flow, and is in fluid communication with the mask interior via the body portion.

In another form, the vent passage inlet comprises part of the mask end and is in direct fluid communication with the mask interior.

The vent passage preferably comprises an inlet portion of relatively large cross-sectional area adjacent the vent passage inlet and an outlet portion of relatively small cross-sectional area adjacent the vent passage outlet.

The vent passage desirably comprises an inlet portion of constant cross-section, a relatively long outlet portion of constant cross-section and a relatively short transition portion of smoothly reducing cross-section extending from the inlet portion to the outlet portion. This shape reduces turbulence and affords a pressure drop from the interior of the mask to the outlet of the vent passage which reduces the pressure gradient at the outlet of the vent passage and, thus, reduces the noise generated.

The vent passage can also include internal ribs and/or an internal tortuous path to increase the pressure drop, if required.

The body portion is preferably of generally part toroidal shape. The cap portion is preferably of complimentary shape to a portion of the exterior of the body portion.

The vent passage preferably curves around the exterior of the body portion.

The connector desirably includes a swivel joiner at its supply conduit end, the exterior of the swivel joiner forming all, or a part, of said connector exterior surface.

In one form, the supply conduit end of the connector forms a smooth prolongation with the supply conduit. The supply conduit end and the supply conduit desirably have a substantially equal external diameter.

In another form, the swivel joiner forms a smooth prolongation with the supply conduit. The swivel joiner and the

4

supply conduit having a substantially equal external diameter. The swivel joiner preferably includes an end of reduced external diameter adapted to be received within the interior of the supply conduit.

In a second aspect, the present invention provides a respiratory mask comprising:

- a mask shell defining an interior of the respiratory mask;
- a mask inlet for connecting in fluid communication with the outlet of a breathable gas supply conduit; and
- a gas washout vent passage having an inlet forming part of the mask shell and in fluid communication with the interior of the respiratory mask and an outlet in fluid communication with the atmosphere, the outlet including an interior surface that forms a smooth prolongation with an adjacent exterior surface of the mask shell, the vent outlet is disposed on the side of the mask remote the mask interior and is adapted to direct the washout gas in a direction substantially parallel to the longitudinal axis of the mask inlet and away from the mask inlet.

Preferably, the mask shell includes a body portion and a cap portion, said body portion including said interior surface. The cap portion preferably also includes an interior surface spaced apart from the body portion interior surface, said body portion interior surface and said cap portion interior surface defining said vent passage therebetween.

The cap portion is desirably detachable from the body portion. The cap portion and body portion are also desirably rigid and fixed relative to each other when attached. The exterior of the body portion preferably includes grooves or ridges adapted to engage ridges or grooves respectively on the interior of the cap portion to attach the cap portion to the body portion. One of the body portion or cap portion preferably also includes a spacer extending between the interior surface of the cap portion and the exterior surface of the body portion.

The vent passage preferably comprises an inlet portion of a relatively large cross-sectional area adjacent the vent passage inlet and an outlet portion of a relatively small cross-sectional area adjacent the vent passage outlet.

The vent passage desirably comprises a relatively long inlet portion of constant cross-section, a relatively long outlet portion of constant cross-section and a transition portion of smoothly reducing cross-section extending from the inlet portion to the outlet portion.

The vent passage preferably substantially follows the shape of the exterior of the body portion.

BRIEF DESCRIPTION OF THE DRAWINGS

FIG. 1 is a side view of a first embodiment of a connector in accordance with the first aspect of the invention, shown attached to a nasal respiratory mask and forehead support;

FIG. 2 is a cross-sectional side view of the connector shown in FIG. 1;

FIG. 3 is a perspective view of the connector shown in FIG. 1;

FIG. 4 is a perspective view of the connector shown in FIG. 1 with the cap portion removed;

FIG. 5 is an underside perspective view of the cap portion of the connector shown in FIG. 1;

FIG. 6 is a cross-sectional side view of a second embodiment of a connector in accordance with the first aspect of the invention;

FIG. 7 is a cross-sectional side view of a third embodiment of the connector in accordance with the first aspect of the invention;

5

FIG. 8 is a cross-sectional side view of a first embodiment of a respiratory mask in accordance with the second aspect of the invention; and

FIG. 9 is a cross-sectional side view of a fourth embodiment of the connector in accordance with the first aspect of the invention

DETAILED DESCRIPTION OF THE PREFERRED EMBODIMENTS

FIGS. 1 to 5 show a first embodiment of the first aspect of the invention in the form of connector 10. The connector 10 is shown attached to a nasal respiratory mask 12 and forehead support device 14. The connector 10 is also suitable for use with a full face (i.e., nose and mouth) respiratory mask.

The mask 12 comprises a substantially rigid mask shell 15, a flexible mask cushion 16 and two slotted lower head strap connectors 18 (only one connector shown).

The forehead support device 14 includes a lower portion 20 which is pivotally mounted to an upper portion 22. The upper portion 22 includes forehead cushions 24 and two slotted upper head strap connectors 26 (only one cushion/connector shown).

As best shown in FIG. 2, the connector 10 includes a mask end 28 having a longitudinal axis A—A for connecting in fluid communication with the interior of the respiratory mask 12 and a supply conduit end 30 having a longitudinal axis B—B disposed substantially perpendicularly to the mask end 28 for connecting in fluid communication with the outlet of a breathable gas supply conduit 31. The mask end 28 is rotatably coupled to the mask shell 15 by a retaining ring 29. The close proximity of the inlet ports 41, and the vent passage 32 overall, to the interior of the mask 12 advantageously increases CO₂ washout efficiency.

The connector 10 also includes a gas washout vent passage, indicated generally by the reference numeral 32, a body portion 34, a detachable cap portion 36 and a detachable swivel joiner 38. The conduit 31 is a non-rotatable friction push fit over end 38a of the swivel joiner 38. The end 38b of the swivel joiner 38 is a rotatable snap-engage fit with reduced diameter portion 39 of the body portion 34. The portion 39 is formed from resilient fingers to allow flexing during snap-engagement with the swivel joiner 38.

The vent passage 32 includes a pair of inlet ports 41 (see FIG. 4) formed in the body portion 34 of the connector 10 adjacent the mask end 28. The inlet ports 41 are in fluid communication with the interior of the mask 12 via the mask end 28. The vent passage 32 also includes an outlet 40 opening to the atmosphere. The outlet 40 includes an interior surface 42 (comprising an exterior surface of the body portion 34) that forms a smooth prolongation with an adjacent exterior surface 44 of the body portion 34. The smooth prolongation between the interior surface 42 and exterior surface 44 reduces noise by allowing the exhaled gases to vent along a continuous surface, as previously described. In order to minimize interruptions or disturbances that could generate turbulence downstream of the outlet 40, and thus noise, the adjacent exterior surfaces 46, 48 of the swivel joiner 38 and the gas supply conduit 31 respectively are also formed as smooth prolongations of the interior surface 42 and adjacent exterior surface 44.

As best shown in FIG. 3, the vent passage outlet 40 forms an arc and is of generally semi-circular cross-section subtending an angle of approximately 180° and is located on the side of the connector 10 remote from the mask end 28 and, thus, the mask 12. The shape of the outlet 40 can also be

6

understood by FIG. 5, which shows the curved upper edge of the cap 36 that forms the outer portion of the vent passage 32. This ensures that gas is only vented along surfaces displaced, and facing away, from the mask 12 and the patient, which again minimizes the risk of the vented gases encountering noise-producing obstructions.

Returning to FIG. 2, it can be seen that the vent passage 32 comprises an inlet portion 50 of relatively large cross-sectional area compared to an outlet portion 52 of relatively small cross-sectional area. In this example, the distance between the interior surface 42 of the body portion 34 and the cap 36, which defines the vent passage 32, is larger at the inlet portion 50 than at the outlet portion 52. This provides a substantial pressure drop across the vent passage 32 and reduces the pressure drop between the outlet 40 and surrounding atmospheric air, again minimizing noise production. Also, the outlet portion 52 is relatively long in order to allow the gas to approach a laminar state and, thus, minimize turbulence before the gas exits to the atmosphere. A smooth tapering transition portion 54 is disposed between the inlet portion 50 and the outlet portion 52 which minimizes noise production by minimizing the introduction of any discontinuities into the gas flow.

As best shown in FIGS. 3 and 4, the body portion 34 includes grooves 56 which are adapted to engage with ridges 58 provided on the cap portion 36 to allow the cap portion 36 to be manually attachable/detachable to/from the body portion 34 for ease of cleaning and replacement. As best shown in FIG. 5, the cap portion 36 also includes an interior strengthening rib 60 to provide rigidity and ensure the cross-sectional area of the vent passage 32 is not reduced due to external pressure, as may be caused by the patient rolling over onto their face during sleep. The detachable cap portion 36 also makes disassembly for cleaning easier and allows cap portions of various sizes to be used with a single body portion 34, thereby allowing the size and shape of the vent passage to be easily and quickly varied for particular treatment applications.

Although the connector 10 has been described with reference to the swivel joiner 38 being interposed between the connector 10 and the breathable gas supply conduit 31, it will be appreciated that the conduit can be joined directly to the body portion 34 if the ability to swivel is not required or if a swivel is provided elsewhere in the gas supply circuit. In that case, it is, of course, desirable for the external diameter of the gas supply conduit 31 to be equal to the adjacent external diameter of the exterior surface of the body portion 34.

A second embodiment of connector 80 in accordance with the first aspect of the invention is shown in FIG. 6. Like reference numerals to those used in describing the first embodiment are used to indicate like features in the second embodiment.

The primary difference between the connector 10 and connector 80 is that the inlet ports 41 are omitted and an inlet port 82 of the gas washout vent passage 32 is incorporated into the mask end 28 of the connector 80. Thus providing direct fluid communication between the interior of the mask 12 and the vent passage 32 and further minimizing CO₂ retention. The inlet portion 50 of the vent passage 32 also provides a relatively long distance over which a gradual reduction in pressure can be achieved. Further, the interior surface of the vent passage outlet 40 forms a smooth prolongation with the adjacent exterior surface 46 of the swivel joiner 38 rather than the body portion 34, as with the first embodiment.

7

FIG. 7 shows a third embodiment of the connector **90** according to the first aspect of the invention. Like reference numerals to those used in describing the first embodiment will again be used to indicate like features in the third embodiment. The connector **90** also has the vent passage **32** in direct fluid communication with the interior of the mask **12**. However, in this embodiment, an inlet port **92** is formed in the mask shell **15**.

FIG. 9 shows a fourth embodiment of the connector **130** according to the first aspect of the invention. Like reference numerals to those used in describing the first embodiment will again be used to indicate like features in the fourth embodiment. The connector **130** also has an inlet port **132** formed in the mask shell **15**, similar to the third embodiment. However, in this embodiment, both the interior surface **42** and the smoothly prolongating adjacent exterior surface **46** are provided on the swivel joiner **38**. As the gas vents to the atmosphere downstream of the join **134** between the swivel joiner **38** and the body portion **34**, then any gas leaking through the join **134** cannot disturb the flow of gas at, or after, the outlet **40**. In this way, a further opportunity for turbulence, and thus noise generation, is eliminated.

FIG. 8 shows a first embodiment of a nasal respiratory mask **100** in accordance with the second aspect of the invention. The mask **100** includes a mask shell **102** and a mask cushion **104**. The mask shell **102** includes a mask inlet **106** for connecting in fluid communication with the outlet of the breathable gas supply conduit **108**. The mask **100** includes a gas washout vent passage indicated generally by the reference numeral **110**.

The mask shell **102** is comprised of a body portion **112** and a detachable/attachable cap portion **114**. The vent passage **110** includes an inlet port **116** formed in the body portion **112** of the mask shell **102**. The inlet port **116** is in direct fluid communication with the interior of the mask **100**. The vent passage **110** also includes an outlet **118** in fluid communication with the atmosphere. The outlet **118** includes an interior surface **120** on the exterior of the body portion **112** that forms a smooth prolongation with an adjacent surface **122** also provided on the exterior of the body portion **112**. The outlet **118** is adapted to direct the washout gas in a direction substantially parallel to the longitudinal axis of the mask inlet **106** and away from the mask inlet **106**.

As with earlier embodiments, the noise produced by venting the exhaled gas to the atmosphere is minimized by directing the vented gas on a smooth continuing surface before and after the outlet **118** and away from the mask **100**, the patient and other potential disturbances. Additionally, as with the earlier connector embodiments, the cap portion **114** is detachable from the body portion **112** for cleaning and or replacement with a cap portion of same, or different, size or shape. The vent passage **110** also similarly comprises an inlet portion **124** of relatively large cross-sectional area, a relatively long outlet portion **126** of relatively small cross-sectional area and a transition portion **128** of smoothly reducing cross-section extending from the inlet portion **124** to the outlet portion **126**.

Although the invention has been described with reference to the preferred embodiments, it will be appreciated by those skilled in the art that the invention may be embodied in many other forms.

We claim:

1. A connector comprising:

a mask end having a longitudinal axis for connecting in fluid communication with an interior of a respiratory mask;

8

a supply conduit end having a longitudinal axis and being disposed at an angle to the mask end for connecting in fluid communication with an outlet of a breathable gas supply conduit;

a gas washout vent passage having an inlet adjacent to, or forming part of, the mask end in fluid communication with the interior of the respiratory mask and an outlet in fluid communication with the atmosphere, the outlet including an interior surface that forms a smooth prolongation with an adjacent exterior surface of the connector, the outlet is disposed on a side of the connector remote from the mask end, is generally semi-circular when viewed in cross-section and is adapted to direct washout gas in a direction substantially perpendicular to the longitudinal axis of the mask end and substantially parallel to the longitudinal axis of the supply conduit end towards the supply conduit;

a body portion including an interior surface and an exterior surface; and

a cap portion including an interior surface spaced apart from the interior surface of the body portion, said interior surface of the body portion and said interior surface of the cap portion defining said vent passage therebetween, wherein the inlet of the vent passage comprises part of the mask end and is in direct fluid communication with the interior of the respiratory mask.

2. The connector as claimed in claim 1, wherein the vent passage comprises an inlet portion of a relatively large cross-sectional area adjacent the inlet of the vent passage and an outlet portion of a relatively small cross-sectional area adjacent the vent passage outlet.

3. The connector as claimed in claim 1, wherein the vent passage comprises an inlet portion of a substantially constant cross-section, a relatively long outlet portion of constant cross-section and a relatively short transition portion of smoothly reducing cross-section extending from the inlet portion to the outlet portion.

4. The connector as claimed in claim 1, wherein the vent passage includes internal ribs and/or an internal tortuous path.

5. The connector as claimed in claim 1, wherein the body portion is of generally part toroidal shape.

6. The connector as claimed in claim 1, wherein the cap portion is of complimentary shape to a portion of the exterior surface of the body portion.

7. The connector as claimed in claim 1, wherein the vent passage curves around the exterior surface of the body portion.

8. The connector as claimed in claim 1, wherein the supply conduit end of the connector forms a smooth prolongation with the supply conduit.

9. The connector as claimed in claim 1, wherein the supply conduit end and the supply conduit have a substantially equal external diameter.

10. A connector comprising:

a mask end having a longitudinal axis for connecting in fluid communication with an interior of a respiratory mask;

a supply conduit end having a longitudinal axis and being disposed at an angle to the mask end for connecting in fluid communication with an outlet of a breathable gas supply conduit;

9

a gas washout vent passage having an inlet adjacent to, or forming part of, the mask end in fluid communication with the interior of the respiratory mask and an outlet in fluid communication with the atmosphere, the outlet including an interior surface that forms a smooth prolongation with an adjacent exterior surface of the connector, the outlet is disposed on a side of the connector remote from the mask end, is generally semi-circular when viewed in cross-section and is adapted to direct washout gas in a direction substantially perpendicular to the longitudinal axis of the mask end and substantially parallel to the longitudinal axis of the supply conduit end towards the supply conduit;

a body portion including an interior surface and an exterior surface; and

a cap portion including an interior surface spaced apart from the interior surface of the body portion, said interior surface of the body portion and said interior surface of the cap portion defining said vent passage therebetween, further comprising a swivel joiner at the supply conduit end, an exterior surface of the swivel joiner forming at least a part of the exterior surface of the connector.

11. The connector as claimed in claim **10**, wherein the swivel joiner forms a smooth prolongation with the supply conduit.

12. The connector as claimed in claim **11**, wherein the swivel joiner and the supply conduit have a substantially equal external diameter.

13. The connector as claimed in claim **12**, wherein the swivel joiner includes an end of reduced external diameter adapted to be received within an interior of the supply conduit.

10

14. A respiratory mask comprising:

a mask shell defining an interior of the respiratory mask;
a mask inlet for connecting in fluid communication with an outlet of a breathable gas supply conduit;

a body portion connected to the mask inlet and including an interior surface and an exterior surface; and

a cap portion including an interior surface spaced apart from the interior surface of the body portion, said interior surface of the body portion and said interior surface of the cap portion defining a gas washout vent passage therebetween,

the gas washout vent passage having an inlet having a longitudinal axis and forming part of the mask shell and in fluid communication with the interior of the respiratory mask and an outlet having a longitudinal axis and being in fluid communication with atmosphere, the outlet including an interior surface that forms a smooth prolongation with an adjacent exterior surface of the mask shell, wherein the outlet is disposed on a side of the mask remote from the mask interior and is adapted to direct washout gas in a direction substantially parallel to the longitudinal axis of the mask inlet and away from the mask inlet;

wherein the vent passage comprises an inlet portion of a relatively large cross-sectional area adjacent the inlet of the vent passage and an outlet portion of a relatively small cross-sectional area adjacent the vent passage outlet, wherein the vent passage substantially follows the shape of the exterior surface of the body portion.

* * * * *