



RESMED

Manufactured by:

ResMed Ltd 97 Waterloo Road North Ryde NSW 2113 Australia
Tel: +1 (858) 746-2400 or 1-800-424-0737 (toll free) Fax: +1 (858) 746-2900 Email: reception@resmed.com.au
Tel: +61 (2) 9886 5000 or 1 800 658 169 (toll free) Fax: +61 (2) 9878 0120 Email: reception@resmed.com.au

ResMed Offices:

ResMed Corp 14040 Danielson Street Poway CA 92064-4857 USA
Tel: +1 (858) 746-2400 or 1-800-424-0737 (toll free) Fax: +1 (858) 746-2900 Email: reception@resmed.com

ResMed (UK) Ltd 65 Milton Park Abingdon Oxfordshire OX14 4RX UK
Tel: +44 (1235) 862 997 Fax: +44 (1235) 831 336 Email: reception@resmed.co.uk

ResMed Asia Pacific Ltd 97 Waterloo Road North Ryde NSW 2113 Australia
Tel: +61 (2) 9886 5000 or 1 800 658 169 (toll free) Fax: +61 (2) 9878 0120 Email: reception@resmed.com.au

ResMed Finland Niitykskatu 6 FIN 02200 ESPOO Suomi
Puh: +358 9 8676820 Faksi: +358 9 86768222 Sähköposti: reception@resmed.fi

ResMed GmbH & Co. KG Rudolfstraße 10 D-41068 Mönchengladbach Deutschland
Tel: +49 (0) 2161-3521-0 (Reception) +49 (0) 180 22 22 668 (Service-Telefon: 0,06 €/Anruf)
+49 (0) 180 22 66 888 (Wartungstelefon: 0,06 €/Anruf) Fax: +49 (0) 2161-3521-1499 Email: reception@resmed.de

ResMed Hong Kong Room 1714 Miramar Tower 132-134 Nathan Road Tsim Sha Tsui Hong Kong
Tel: +852 2366 0707 Fax: +852 2366 4546 Email: freddie@resmed.com.hk

ResMed Japan Nihonbashi Hiamatsu Bldg. 4F 2-28-1 Nihonbashi-Hamacho, Chuo-Ku, Tokyo 103-0007 Japan
Tel: +81 (3) 3662 5056 Fax: +81 (3) 3662 5040

ResMed Malaysia Sdn Bhd Suite E-10-20 Plaza Mont Kiara No 2, Jalan 17/9C, Mont Kiara 50480 Kuala Lumpur, Malaysia
Tel: +60 3 6201 7177 Fax: +60 3 6201 2177 Email: reception@resmed.com.my

ResMed NZ Ltd PO Box 51-048 Pakuranga Auckland New Zealand
Mob: +64 274 737 633 Fax: +64 9 239 0193 Email: reception@resmed.co.nz

ResMed SA Parc de la Bandonnière 2, rue Maurice Audibert 69800 Saint-Priest France
Tel: +33 (0) 4 37 251 251 Fax: +33 (0) 4 37 251 260 Email: reception@resmed.fr

ResMed Singapore Pte Ltd 17 Ubi Avenue 1 #07-09 Ubi Centre Singapore 408936
Tel: +65 284 1777 Fax: +65 284 7787 Email: reception@resmed.com.sg

ResMed Spain SL C/ Arturo Soria, 245 28033 Madrid España
Tel: +34 (93) 5908154 Fax: +34 (93) 5908153 Email: angel@resmed.es

ResMed Sweden AB Industrigatan 2 S-461 37 Trollhättan Sverige
Tel: +46 520 220 110 Fax: +46 520 397 15 Email: reception@resmed.se

Labhardt AG Thannerstrasse 37 CH-4054 Basel Schweiz
Tel: +41 (061) 307 9711 Fax: +41 (061) 307 9722 Email: info@labhardt.ch

US DESIGNATED AGENT: ResMed Corp
EU AUTHORIZED REPRESENTATIVE: ResMed (UK) Ltd

www.myresmed.com

Mirage Swift Nasal Pillows System
Protected by patents: AU 724360, US 6561191. Other patents and design registrations pending.

AutoSeal, Mirage, Mirage Swift and logo, and SmartStart are trademarks of ResMed Ltd.

Dove is a trademark of Unilever.

© 2004 ResMed Ltd.

www.myresmed.com Waking people up to sleep

60838r cover.pdf

Log on now to www.myresmed.com
to find useful tips on managing your treatment.

Mirage Swift™ Nasal Pillows System

Reorder No. 608281 / 04 05

USER'S GUIDE

English



© 2004 ResMed Ltd.

www.myresmed.com Waking people up to sleep

60838r cover.pdf

6/05/2004, 9:54 AM



ILLUSTRATIONS SHEET

Note: For complete instructions, read the text section in conjunction with the illustrations on this sheet.

A Parts of the Mirage Swift™

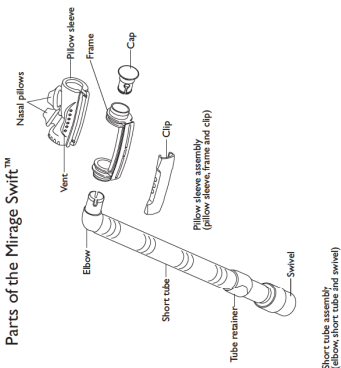

Headgear

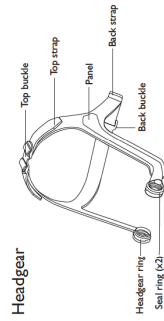

© 2004 ResMed Ltd.



B Fitting the Mirage Swift

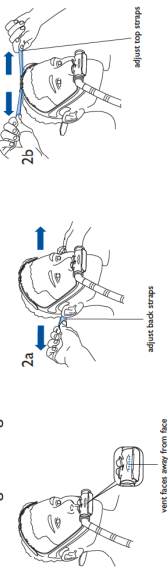

© 2004 ResMed Ltd.

C Disassembling for Cleaning

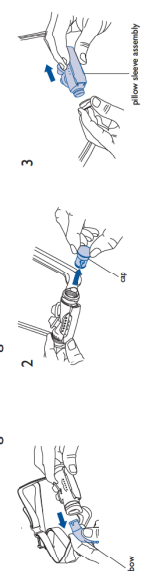

© 2004 ResMed Ltd.

D Reassembling the Mirage Swift

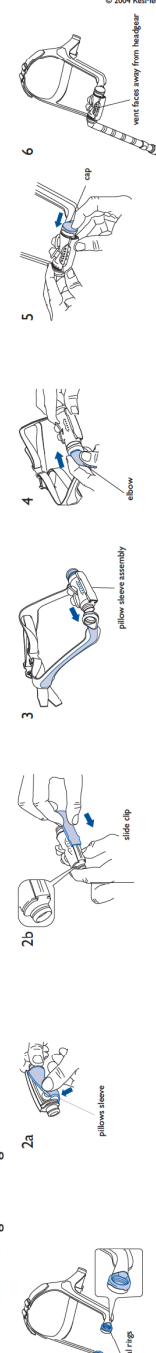

© 2004 ResMed Ltd.





Note: The headgear does not need to be taken apart for cleaning. Headgear assembly instructions are provided here as additional information.

E Reassembling the Headgear

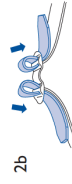
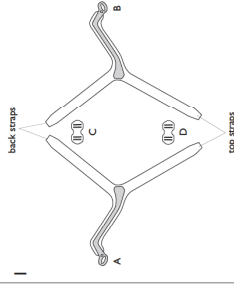

© 2004 ResMed Ltd.

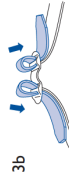

© 2004 ResMed Ltd.

F Pressure-Flow Curve

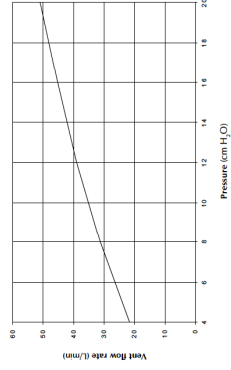

© 2004 ResMed Ltd.

Component of 609280 / 04 05

RESMED

ENGLISH

Mirage Swift™ Nasal Pillows System

Thank you for choosing ResMed's
MIRAGE SWIFT™ NASAL PILLOWS SYSTEM.

INTENDED USE

The MIRAGE SWIFT is an accessory to a non-continuous ventilator (respirator) intended for single patient multi use for adult patients prescribed continuous positive airway pressure (CPAP) or bilevel therapy in hospital, clinic, and/or home environments.

⚠ CAUTION

In the USA, federal law restricts this device to sale by, or on the order of, a physician.

MEDICAL INFORMATION

Note: The MIRAGE SWIFT does not contain latex materials. If you have ANY reaction to any part of the system, discontinue use and consult your sleep therapist.

⚠ WARNINGS & CAUTIONS

- This system should be used only with CPAP or bilevel systems recommended by your physician or respiratory therapist. It should not be used unless the CPAP or bilevel system is turned on and operating properly.

The vent holes should never be blocked.

Explanation of the Warning: CPAP or bilevel systems are intended to be used with special interfaces with connectors which have vent holes or separate exhalation devices to allow continuous flow of air out of the interface. When the CPAP or bilevel device is turned on and functioning properly, new air from the flow generator flushes the exhaled air out through the attached exhalation port. However, when the CPAP or bilevel device is not operating, enough fresh air will not be provided through the system, and exhaled air may be rebreathed. Rebreathing of exhaled air for longer than several minutes can in some circumstances lead to suffocation. This warning applies to most models of CPAP or bilevel systems.

- The exhaust vent flow is lower at lower system pressures (see Pressure/Flow Curve in section F of the illustrations sheet). If the system pressure during expiration is too low, there may not be enough exhaust vent flow to completely flush the air delivery hose of exhaled air before the start of the next inspiration.
- Discontinue using the MIRAGE SWIFT if you experience nasal irritation, and consult your physician.

ENGLISH

- If oxygen is used with the CPAP or bilevel device, the oxygen flow must be turned off when the flow generator is not operating.

Explanation of the Warning: When the CPAP or bilevel device is not in operation, and the oxygen flow is left on, oxygen delivered into the ventilator tubing may accumulate within the flow generator enclosure. Oxygen accumulated in the CPAP or bilevel device enclosure will create a risk of fire. This warning applies to most types of CPAP or bilevel flow generators.

- Please refrain from smoking while oxygen is in use.

Note: At a fixed flow rate of supplemental oxygen flow, the inhaled oxygen concentration will vary, depending on the pressure settings, patient breathing pattern, interface selection, and the leak rate.

PARTS OF THE MIRAGE SWIFT

Please refer to the illustrations in section A of the illustrations sheet.

FITTING THE MIRAGE SWIFT

Please refer to the illustrations in section B of the illustrations sheet.

- 1 Put the headgear on your head and place the nasal pillows below your nose. Make sure the top strap passes over the top of your head. **Make sure the vent on the pillow sleeve faces outwards; away from your face (B-1).**
- 2 Insert the nasal pillows into your nostrils. Gently tighten the headgear straps; first the back straps (B-2a) and then the top straps (B-2b). Alternate the adjustment of each strap, so that the headgear panels rest between the eye and the ear.

The pillow sleeve should rest comfortably above your upper lip.

- 3 Adjust the angle of the nasal pillows. To do this, rotate the pillow sleeve assembly forward or backward so that the nasal pillows sit comfortably inside your nostrils (B-3).

- 4 Tube Retainer (optional)
Use the tube retainer if you prefer to have the short tube assembly secured to the headgear in the up position (B-4).

- 5 The short tube assembly can be attached in four different ways (B-5).

Note: The short tube assembly and cap can be connected to either side of the pillow sleeve. See "Disassembling for Cleaning" and "Reassembling the Mirage Swift" for instructions on how to remove and attach the short tube assembly and cap.

- 6 Connect one end of the main air tubing to your flow generator and the other end to the swivel. Turn your flow generator on.

Notes:

- Select "Mirage" as the mask option when using the MIRAGE SWIFT with ResMed flow generators that have mask setting options.
- Disable SmartStart/Stop and Leak Alert when using the MIRAGE SWIFT with ResMed flow generators that have these options.

If you feel air leaks, readjust the angle of the nasal pillows to get a better seal. You may need to readjust the headgear straps. Do not over tighten the headgear straps.

If you are unable to resolve any leaks you may need an alternative pillow sleeve size.

- 7 Take time to adjust the following to achieve a secure and comfortable fit:
 - headgear straps.
 - angle of the pillow sleeve assembly.
 - position of the short tube assembly.

REMOVING THE MIRAGE SWIFT

To remove the MIRAGE SWIFT, pull the pillow sleeve assembly away from your nose and lift the headgear off your head. You do not need to loosen the headgear straps.

DISASSEMBLING FOR CLEANING

Please refer to the illustrations in section C of the illustrations sheet.

Before disassembling the MIRAGE SWIFT, disconnect the flow generator tubing. To do this, hold the swivel and pull it away from the flow generator tubing.

CAUTION

Do not pull on the short tube or the flow generator tubing as they may become damaged.

- To disassemble the MIRAGE SWIFT for daily cleaning, follow steps 1–3.
- To disassemble the MIRAGE SWIFT for weekly cleaning, follow steps 1–5.

- 1 Detach the short tube assembly. To do this, hold the elbow and pull it away from the seal ring (C-1).

Note: The short tube assembly cannot be taken apart.

- 2 Remove the cap by pulling it away from the seal ring (C-2).
- 3 Detach the pillow sleeve assembly. Simply pull the ends of the frame away from the headgear rings (C-3).

- 4 Disassemble the pillow sleeve assembly. To do this, slide off the clip (C-4a) and then peel the pillow sleeve off the frame (C-4b).
- 5 The seal rings do not need to be removed from the headgear (C-5).

CLEANING THE MIRAGE SWIFT

WARNING

The MIRAGE SWIFT is for single patient use. To avoid the risk of cross-infection, do not re-use between patients.

DAILY

Wash the pillow sleeve assembly, short tube assembly, and cap with warm, soapy water. Use pure soap (an example of pure soap is Dove® soap, unscented; made by Unilever). Rinse well and allow to air dry out of direct sunlight.

WEEKLY

Note: The headgear may be washed without being taken apart.

Hand wash the headgear, tube retainer, and components in warm, soapy water. Use pure soap. Rinse the components well and allow them to air dry out of direct sunlight.

CAUTIONS

- Do not use solutions containing bleach, chlorine, alcohol, aromatics, moisturizers, antibacterial agents, or scented oils to clean any part of the system or air tubing. These solutions may cause damage and reduce the life of the product.
- Do not expose any part of the system or tubing to direct sunlight as it may deteriorate.

- If any visible deterioration of a component is apparent (cracking, crazing, tears etc), the component should be discarded and replaced.

REASSEMBLING THE MIRAGE SWIFT

Please refer to the illustrations in section D of the illustrations sheet.

- 1 Make sure both seal rings are properly fitted to the headgear rings (D-1).
- 2 Assemble the pillow sleeve assembly. To do this:
 - a Wrap the pillow sleeve around the frame. Then insert the pillow sleeve edges into the groove of the frame (D-2a).
 - b Slide the clip onto the frame to secure the pillow sleeve in place (D-2b).

Note: If the clip does not slide easily, check that the pillow sleeve edge is fitted flush to the groove of the frame.

- 3 Attach the pillow sleeve assembly to the headgear. To do this, firmly push the ends of the frame into the headgear rings (D-3). When attaching the pillow sleeve assembly make sure:
 - the headgear panels are facing out
 - the nasal pillows are pointing upwards
 - the vent faces out away from the headgear.

Make sure the pillow sleeve assembly is properly fitted to the headgear before going on to the next step.

- 4 Attach the short tube assembly to your preferred side of the pillow sleeve assembly. To do this, push the elbow into the seal ring until clicks into place (D-4).

- 5 Insert the cap into the other seal ring until it clicks into place (D-5).
- 6 The assembled system should look like this (D-6). Make sure the vent faces out away from the headgear.

ADDITIONAL INFORMATION

REASSEMBLING THE HEADGEAR

Please refer to the illustrations in section E of the illustrations sheet.

If taken apart, the headgear has four parts:

A: Left strap; B: Right strap; C: Back buckle; D: Top buckle.

- 1 Lay out the four parts of the headgear as shown in (E-1). The panels must face up.

Note: Before threading the straps, make sure that the buckles are positioned as shown in (E-2) and (E-3).

- 2 Thread the back straps through the back buckle (part C) as shown in (E-2a) and (E-2b).
- 3 Thread the top straps through the top buckle (part D) as shown in (E-3a) and (E-3b).

TECHNICAL SPECIFICATIONS

PRESSURE–FLOW CURVE

Please refer to section F of the illustrations sheet.

DEAD SPACE INFORMATION

Explanation: Dead space is the empty volume of the pillow sleeve and short tube assembly up to the swivel.

The dead space of the MIRAGE SWIFT for all pillow sleeve sizes is 90 mL.

REPLACEMENT PARTS & ACCESSORIES

Part No.	Item
60505	Mirage Swift Nasal Pillow System
60520	Pillow sleeve, <i>Small</i> (1 pk.)
60521	Pillow sleeve, <i>Medium</i> (1 pk.)
60522	Pillow sleeve, <i>Large</i> (1 pk.)
60524	Seal ring (10 pk.)
60525	Cap (1 pk.)
60526	Headgear (4 pk.)
60527	Frame with Clip and Cap (1 pk.)
60528	Short tube assembly (1 pk.)
60530	Distal pressure port (1 pk.)
60531	Mirage Swift Bag (1 pk.)

LIMITED WARRANTY

ResMed warrants that your ResMed system, including its components—frame, pillow sleeve, headgear, tubing and other accessories ("Product")—shall be free from defects in material and workmanship for a period of ninety (90) days from the date of purchase by the initial consumer. For further details refer to the Warranty.

ENGLISH

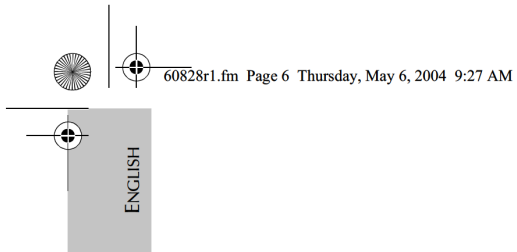

60828r1.fm Page 6 Thursday, May 6, 2004 9:27 AM

