



United States Patent [19]
Blacker et al.

[11] **Patent Number:** **6,161,724**
[45] **Date of Patent:** **Dec. 19, 2000**

[54] **INDICATING DEVICE**

[75] **Inventors:** **Richard Blacker; Daniel K. Engelbreth; James N. Schmidt**, all of London, Canada

[73] **Assignee:** **1263152 Ontario Inc.**, London, Canada

[21] **Appl. No.:** **09/149,708**

[22] **Filed:** **Sep. 8, 1998**

Related U.S. Application Data

[63] **Continuation-in-part of application No. 09/008,184, Jan. 16, 1998.**

[51] **Int. Cl.⁷** **B67D 5/06**

[52] **U.S. Cl.** **222/23; 222/30; 222/32**

[58] **Field of Search** **222/23, 30, 32, 222/36, 38**

[56] **References Cited**

U.S. PATENT DOCUMENTS

Re. 34,847 2/1995 Muderlak et al. .
165,054 6/1875 Baldwin .
498,851 6/1893 Jones .
1,219,858 3/1917 Patterson .
2,455,962 12/1948 Wheeler et al. .
2,580,292 12/1951 Geary et al. .
2,587,147 2/1952 Guion et al. .
2,630,027 3/1953 Wunderlich .

(List continued on next page.)

FOREIGN PATENT DOCUMENTS

598250 B2 6/1990 Australia .
535518 1/1957 Canada .
0 028 929 A2 5/1981 European Pat. Off. .
0 098 939 A2 1/1984 European Pat. Off. .
0 114 617 A2 8/1984 European Pat. Off. .
0 063 599 B1 6/1986 European Pat. Off. .
0 230 323 B1 7/1987 European Pat. Off. .
0 236 871 A2 9/1987 European Pat. Off. .
0 269 496 A2 6/1988 European Pat. Off. .
0 488 609 A1 6/1992 European Pat. Off. .
0 559 757 B1 9/1993 European Pat. Off. .

6 603 758 7/1969 Germany .
27 02 539 A1 1/1977 Germany .
3336486 A1 4/1984 Germany .
8 590 143 10/1985 Germany .
998148 7/1965 United Kingdom .
1058636 2/1967 United Kingdom .
1 290 484 9/1972 United Kingdom .
1317315 5/1973 United Kingdom .
2 063 075 6/1981 United Kingdom .
2 092 991 8/1982 United Kingdom .
2 104 393 3/1983 United Kingdom .
2 191 032 12/1987 United Kingdom .
2 195 544 4/1988 United Kingdom .
WO 86/02275 4/1986 WIPO .
WO 87/04354 7/1987 WIPO .
WO 90/10470 9/1990 WIPO .
WO 91/06334 5/1991 WIPO .
WO 92/07600 5/1992 WIPO .
WO 92/09324 6/1992 WIPO .
WO 92/15353 9/1992 WIPO .
WO 92/17231 10/1992 WIPO .
WO 93/24167 12/1993 WIPO .
WO 94/11272 5/1994 WIPO .
WO 95/34874 12/1995 WIPO .
WO 96/16687 6/1996 WIPO .

Primary Examiner—Kevin Shaver
Assistant Examiner—David Deal
Attorney, Agent, or Firm—Brinks Hofer Gilson & Lione

[57] **ABSTRACT**

An indicating device for use with a dispensing device that dispenses metered dosages of a medicament from a container having a valve moveable between an open and closed position. In a preferred embodiment, the container is reciprocally moveable within the housing along a longitudinal axis. The housing preferably has a well adapted to receive a valve stem and an exhaust port. The well communicates with the port such that the metered dosage of medicament is dispensed through the port when the valve is moved to the open position. An indicator assembly comprises an indicator member that includes dosage indicia visible to a user. In a preferred embodiment, the indicator assembly is provided in an indicator module. A method for dispensing measured dosages is also provided, along with a kit capable of being assembled as an inhalation device. A delivery system having a key member and a key entry passageway is also provided.

58 Claims, 14 Drawing Sheets

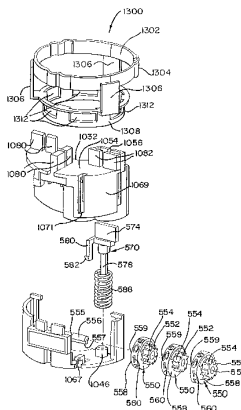

U.S. PATENT DOCUMENTS

2,644,452	7/1953	Brown .	4,489,834	12/1984	Thackrey .
2,767,680	10/1956	Lerner .	4,500,005	2/1985	Forrester .
2,883,086	4/1959	Davison et al. .	4,501,370	2/1985	Kelley .
2,939,597	6/1960	Greene .	4,511,150	4/1985	Séguenot .
2,943,730	7/1960	Tregilgas .	4,523,933	6/1985	Laush et al. .
2,953,242	9/1960	Shaw .	4,528,933	7/1985	Allen .
3,073,468	1/1963	Arneson .	4,534,345	8/1985	Wetterlin .
3,085,745	4/1963	Auberger .	4,538,744	9/1985	Weissenborn .
3,119,557	1/1964	Chapman 222/36 X	4,548,157	10/1985	Hevoyan .
3,120,318	2/1964	Rigor .	4,562,933	1/1986	Dennis .
3,148,801	9/1964	Radeloff et al. .	4,565,302	1/1986	Pfeiffer et al. .
3,151,599	10/1964	Livingston .	4,634,012	1/1987	Kelley .
3,170,597	2/1965	Reichenberger .	4,637,528	1/1987	Wachinski et al. .
3,187,963	6/1965	Anderson .	4,641,759	2/1987	Kelley .
3,191,867	6/1965	Helms .	4,646,936	3/1987	Frazier et al. .
3,334,731	8/1967	Dale .	4,662,520	5/1987	Griffin .
3,344,951	10/1967	Gervais .	4,664,107	5/1987	Wass .
3,419,187	12/1968	Bazarnic .	4,666,051	5/1987	Trick .
3,446,179	5/1969	Bender .	4,668,218	5/1987	Virtanen .
3,477,561	11/1969	Espinal .	4,677,975	7/1987	Edgar et al. .
3,495,567	2/1970	Hayes et al. .	4,693,399	9/1987	Hickman et al. .
3,511,409	5/1970	Huck .	4,705,182	11/1987	Newel-Lewis .
3,549,057	12/1970	Perez .	4,722,729	2/1988	Dettbarn et al. .
3,572,282	3/1971	Tump et al. .	4,723,673	2/1988	Tartaglia et al. .
3,589,563	6/1971	Carragan et al. .	4,727,886	3/1988	Conrardy et al. .
3,612,349	10/1971	Thomas .	4,736,871	4/1988	Luciani et al. .
3,655,952	4/1972	Johnson et al. .	4,749,093	6/1988	Trick .
3,688,945	9/1972	Harman, Jr. et al. .	4,753,189	6/1988	Mastman et al. .
3,753,417	8/1973	Garby .	4,756,423	7/1988	Holtsch .
3,766,882	10/1973	Babbitt, III .	4,782,966	11/1988	Thackrey .
3,796,348	3/1974	Zipper .	4,792,664	12/1988	Schwab .
3,797,748	3/1974	Nozawa et al. .	4,817,822	4/1989	Rand et al. .
3,802,608	4/1974	Gullett .	4,890,572	1/1990	Huang .
3,831,808	8/1974	Bender .	4,934,358	6/1990	Nilsson et al. .
3,831,812	8/1974	Dolan .	4,947,875	8/1990	Brooks et al. .
3,845,883	11/1974	Johnson et al. .	4,955,371	9/1990	Zamba et al. .
3,848,774	11/1974	Schimke .	4,969,578	11/1990	Gander et al. .
3,886,879	6/1975	Frost et al. .	4,984,158	1/1991	Hillsman .
3,887,099	6/1975	Gillman et al. .	5,009,338	4/1991	Barker .
3,921,568	11/1975	Fish .	5,011,032	4/1991	Rollman .
3,926,326	12/1975	Grau .	5,020,527	6/1991	Dessertine .
3,960,713	6/1976	Carey .	5,038,972	8/1991	Muderlak et al. .
3,977,554	8/1976	Costa .	5,069,204	12/1991	Smith et al. .
3,994,421	11/1976	Hansen .	5,082,129	1/1992	Kramer .
4,011,829	3/1977	Wachsmann et al. .	5,082,130	1/1992	Weinstein .
4,029,033	6/1977	Kerwin et al. .	5,115,929	5/1992	Buono .
4,034,757	7/1977	Glover .	5,174,473	12/1992	Marelli .
4,037,719	7/1977	Perlmutter .	5,184,761	2/1993	Lee .
4,069,935	1/1978	Hampel .	5,188,251	2/1993	Kusz .
4,069,942	1/1978	Marshall et al. .	5,190,643	3/1993	Duncan et al. .
4,078,661	3/1978	Thomas .	5,209,375	5/1993	Fuchs .
4,094,408	6/1978	Ford .	5,224,474	7/1993	Bloomfield .
4,162,746	7/1979	Anderson et al. .	5,227,764	7/1993	Umemoto .
4,164,301	8/1979	Thayer .	5,228,586	7/1993	Fuchs .
4,188,984	2/1980	Lyall .	5,242,067	9/1993	Garby et al. .
4,220,247	9/1980	Kramer .	5,243,970	9/1993	Ambrosio et al. .
4,291,688	9/1981	Kistler .	5,261,548	11/1993	Barker et al. .
4,300,548	11/1981	Jones .	5,263,475	11/1993	Altermatt et al. .
4,345,541	8/1982	Villa-Real .	5,284,133	2/1994	Burns et al. .
4,347,804	9/1982	Villa-Real .	5,289,946	3/1994	Fuchs .
4,347,853	9/1982	Gereg et al. .	5,299,701	4/1994	Barker et al. .
4,350,265	9/1982	Griffiths et al. .	5,300,042	4/1994	Kossoff et al. .
4,354,621	10/1982	Knickerbocker .	5,301,873	4/1994	Burke et al. .
4,357,192	11/1982	Moser .	5,328,597	7/1994	Boldt, Jr. et al. .
4,365,722	12/1982	Kramer .	5,331,953	7/1994	Andersson et al. .
4,405,045	9/1983	Villa-Real .	5,335,823	8/1994	Fuchs et al. .
4,419,016	12/1983	Zoltan .	5,349,945	9/1994	Wass et al. .
4,432,300	2/1984	Lyss .	5,356,012	10/1994	Tang et al. .
4,436,223	3/1984	Wilson .	5,363,842	11/1994	Mishelevich et al. .
4,440,306	4/1984	Van Buskirk et al. .	5,370,267	12/1994	Schroeder .
			5,382,243	1/1995	Mulholland .
			5,388,572	2/1995	Mulhauser et al. .

6,161,724

Page 3

5,392,768	2/1995	Johansson et al. .	5,611,444	3/1997	Garby et al. .
5,394,866	3/1995	Ritson et al. .	5,617,844	4/1997	King .
5,397,028	3/1995	Jesadanont .	5,622,163	4/1997	Jewett et al. .
5,411,173	5/1995	Weinstein .	5,625,334	4/1997	Compton .
5,421,482	6/1995	Garby et al. .	5,625,659	4/1997	Sears .
5,437,270	8/1995	Braithwaite .	5,638,970	6/1997	Garby et al. .
5,448,042	9/1995	Robinson et al. .	5,657,748	8/1997	Braithwaite .
5,482,030	1/1996	Klein .	5,676,129	10/1997	Rocci, Jr. et al. .
5,505,192	4/1996	Samiotes et al. .	5,687,710	11/1997	Ambrosio et al. .
5,505,195	4/1996	Wolf et al. .	5,694,882	12/1997	Marshall .
5,509,905	4/1996	Michel .	5,718,355	2/1998	Garby et al. .
5,519,197	5/1996	Robinson et al. .	5,724,957	3/1998	Rubsamen et al. .
5,520,166	5/1996	Ritson et al. .	5,732,836	3/1998	Barker et al. .
5,544,647	8/1996	Jewett et al. .	5,799,651	9/1998	Garby et al. .
5,549,101	8/1996	Trofast et al. .	6,029,659	2/2000	O'Connor .
5,564,414	10/1996	Walker et al. 222/36 X			

FIG. 1

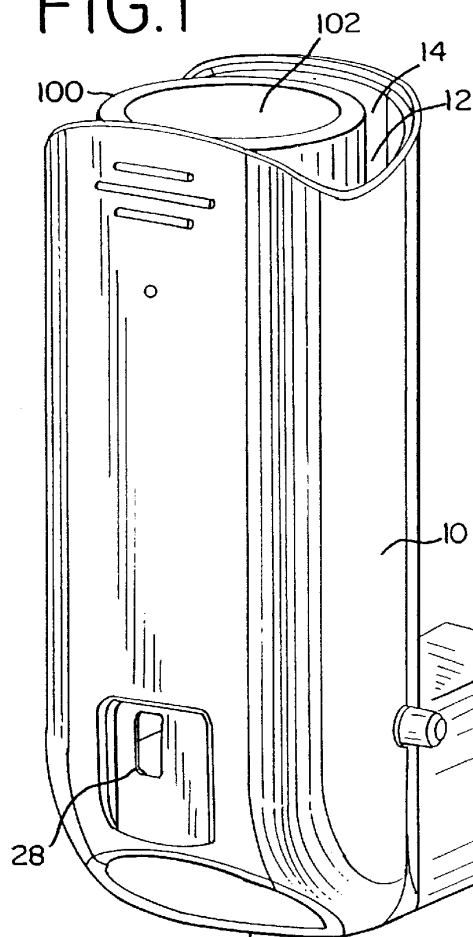

FIG. 2

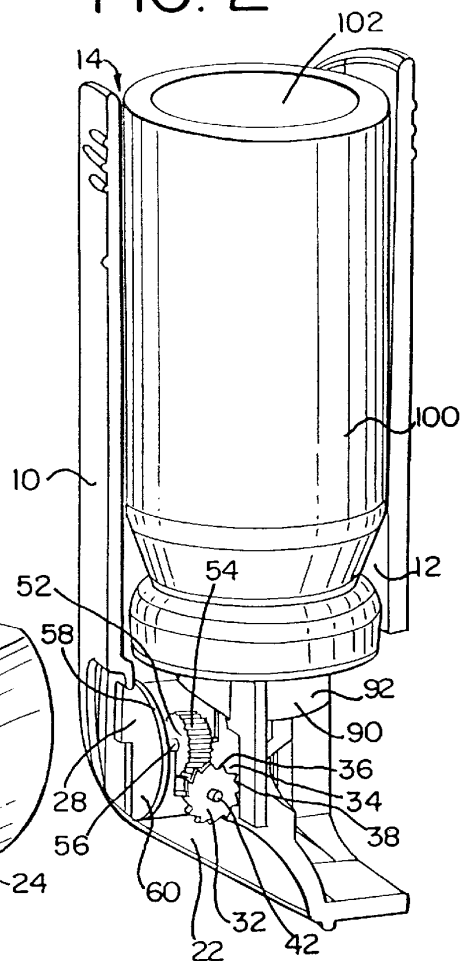

FIG. 3

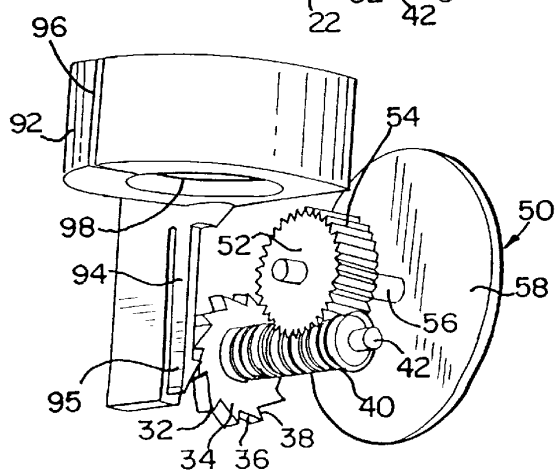

FIG. 4

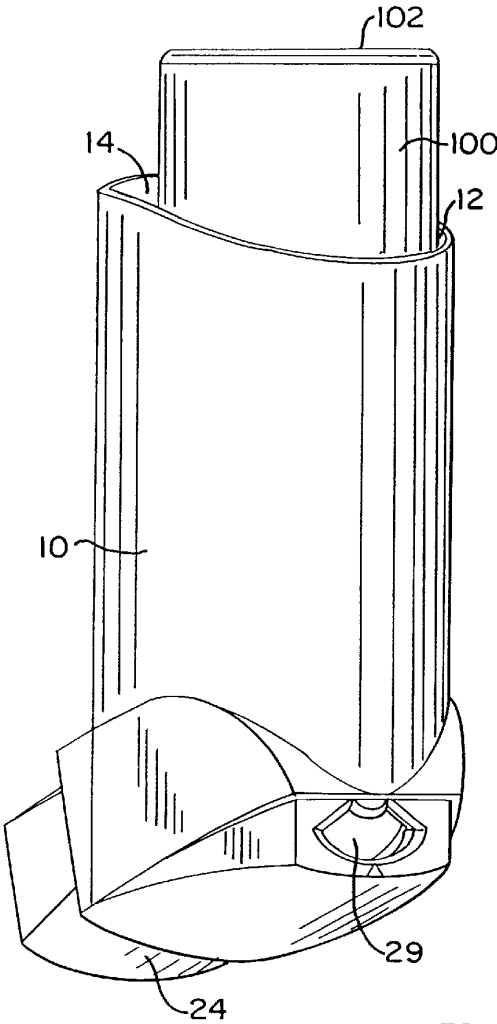

FIG. 5

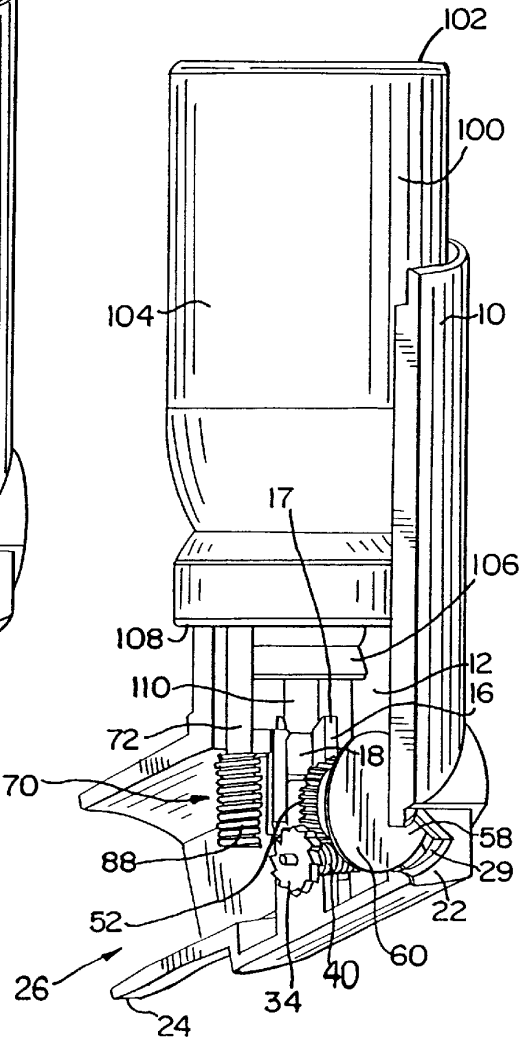

FIG. 6

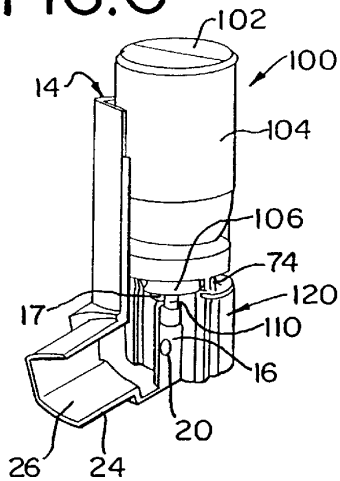

FIG. 7

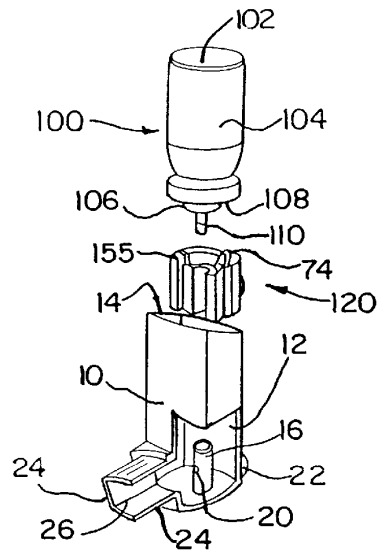

FIG. 8

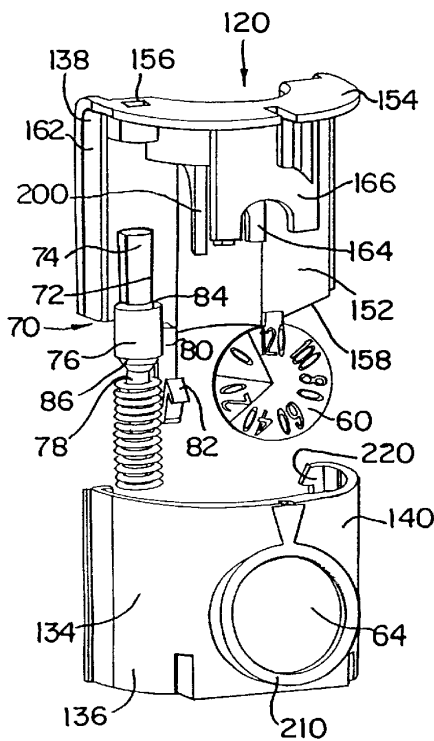

FIG. 9

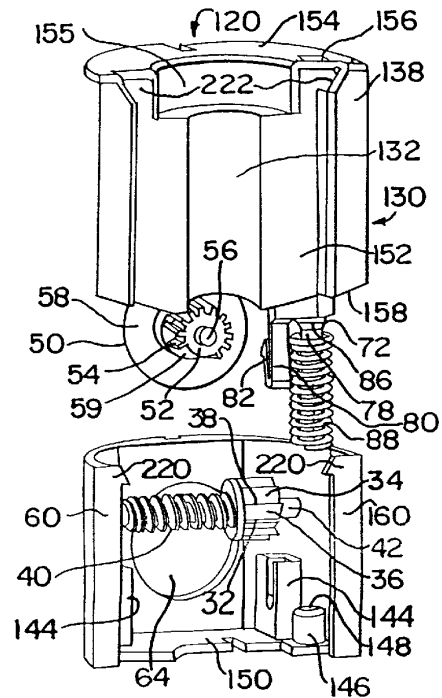

FIG. 10

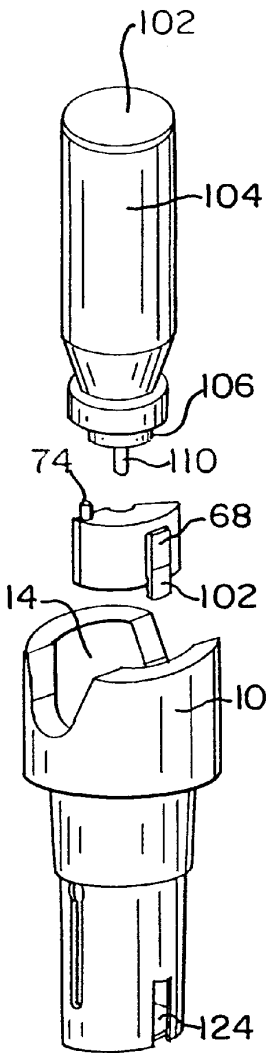

FIG. 11

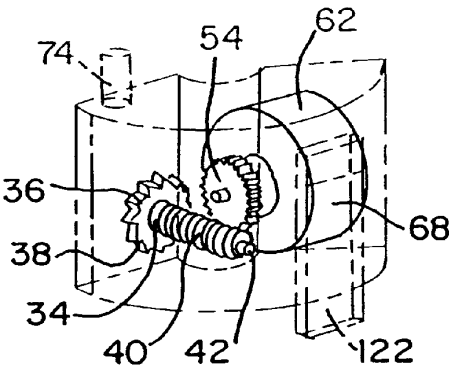
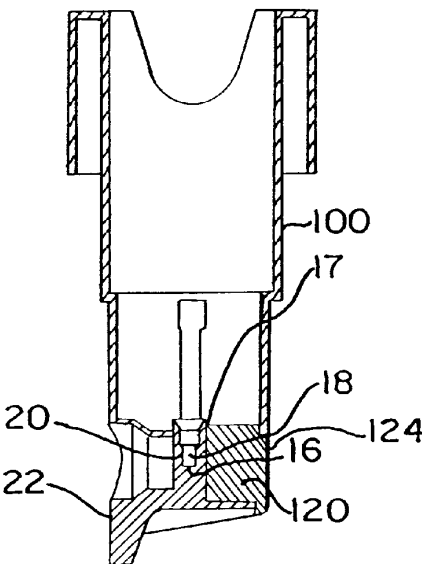

FIG. 12



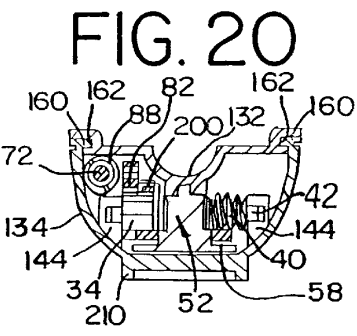
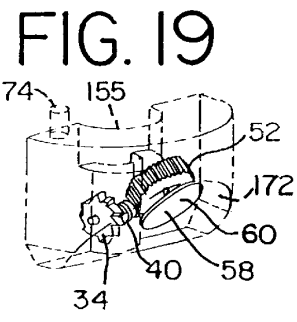
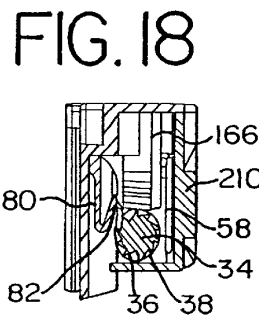
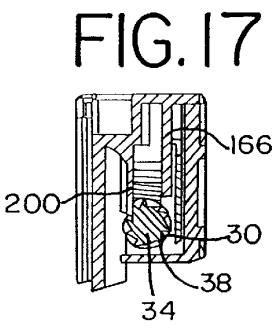
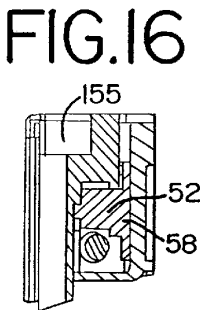
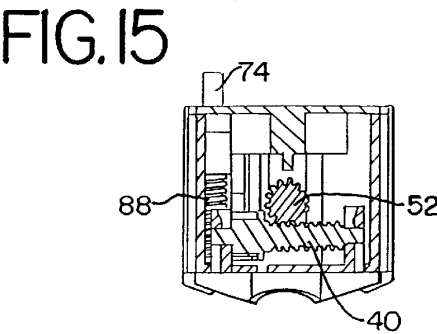
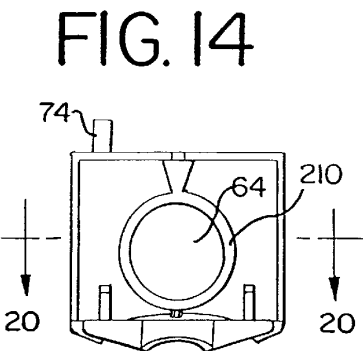
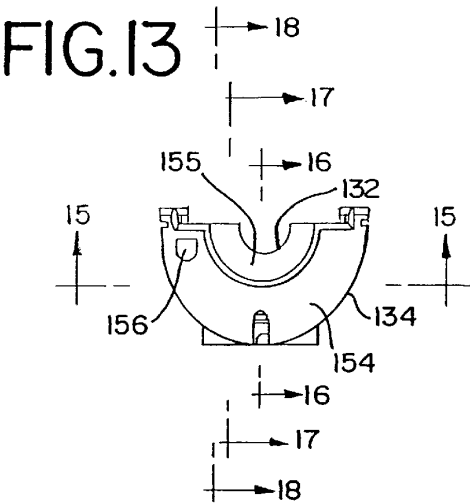

FIG. 25

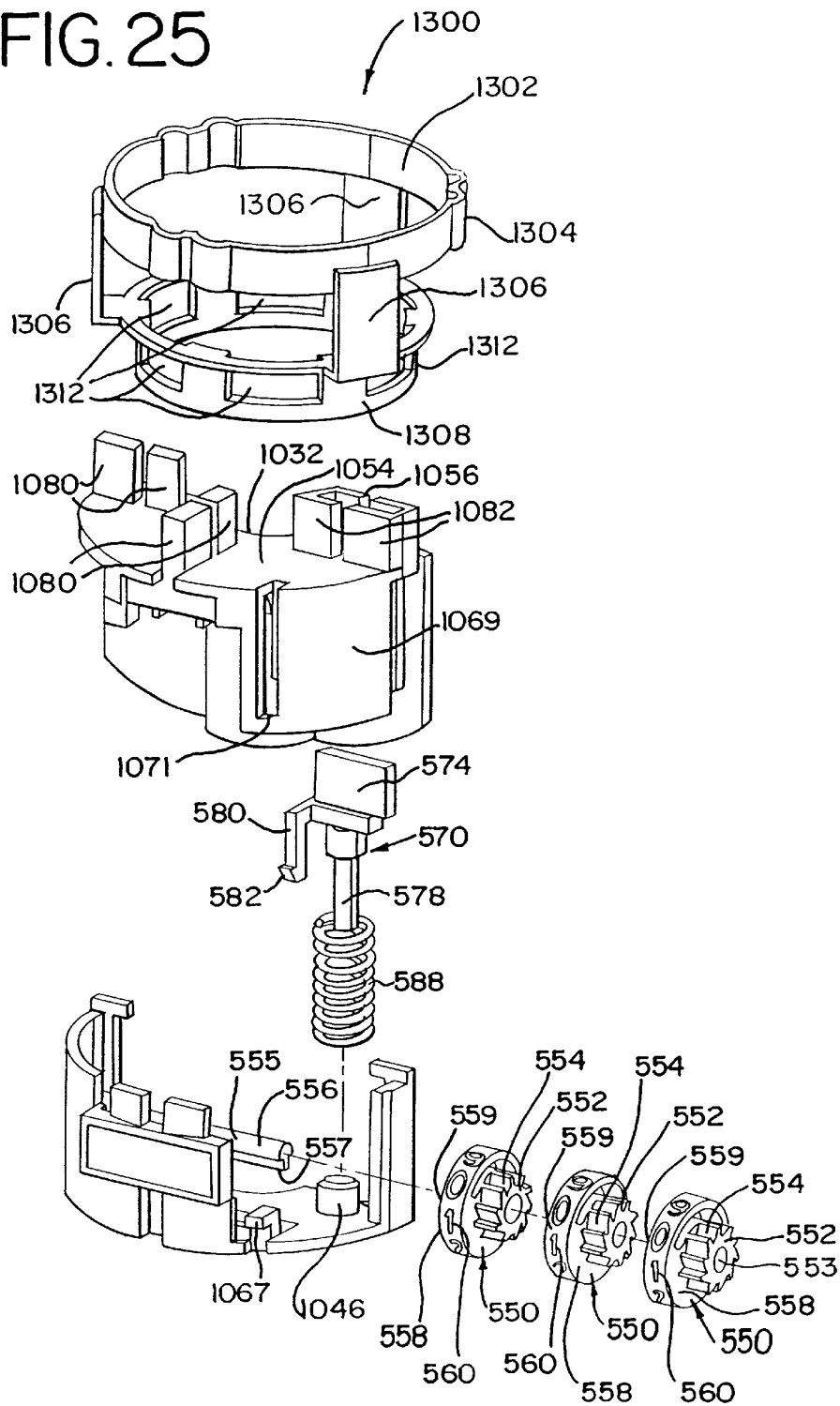

FIG. 26

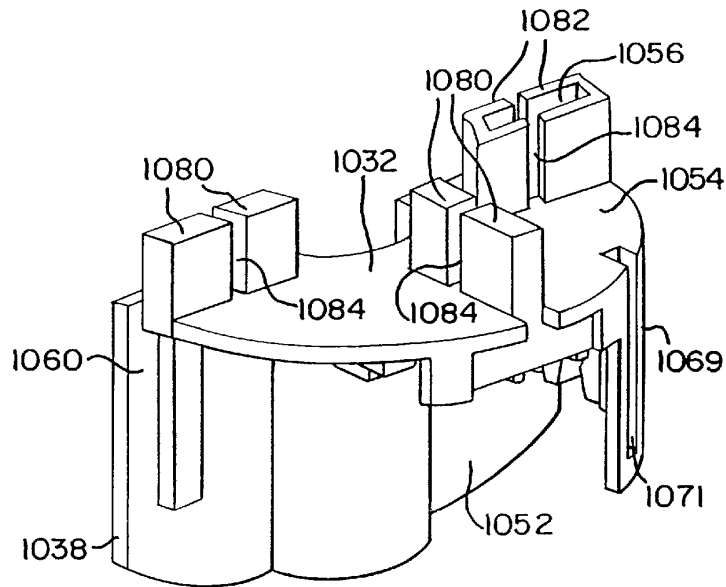

FIG. 27

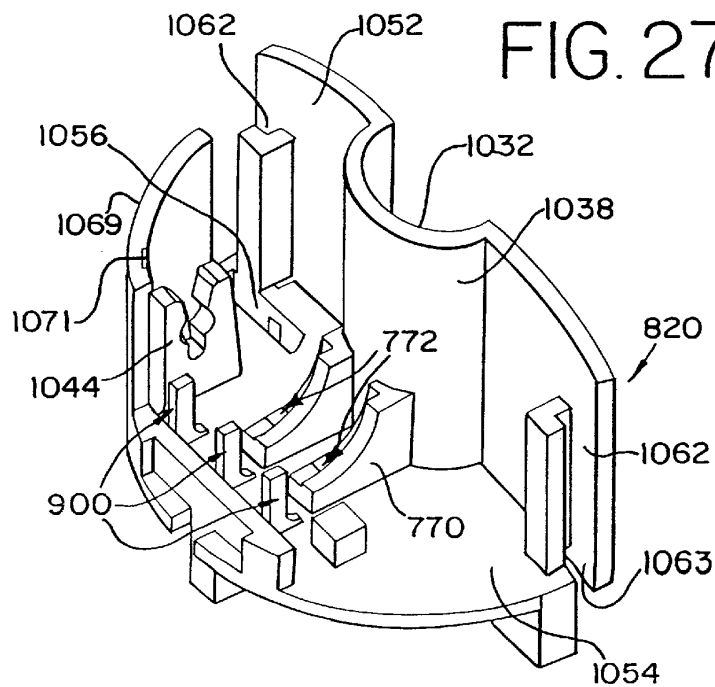

FIG. 28

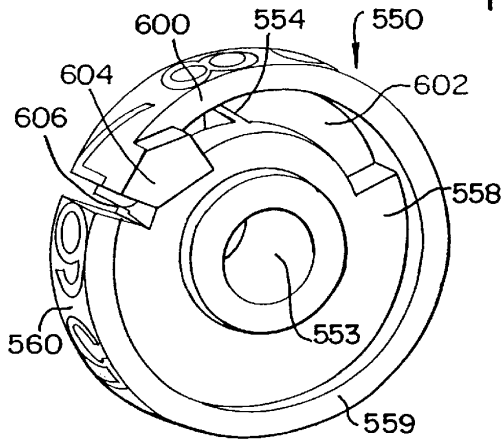

FIG.29

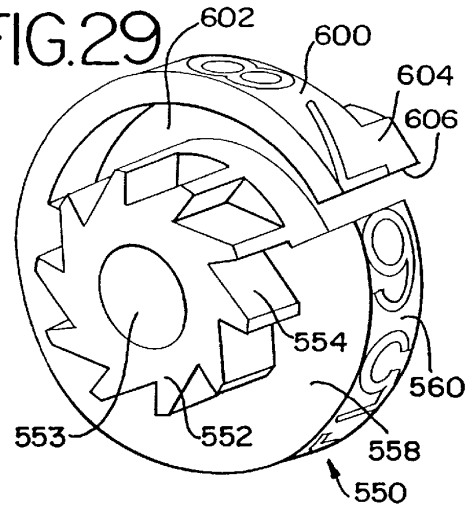

FIG.30

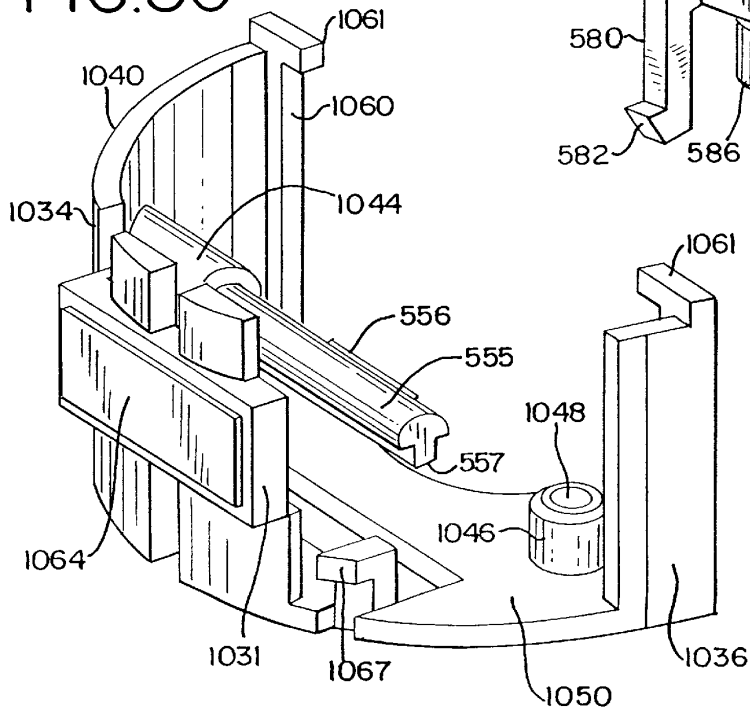

FIG. 31

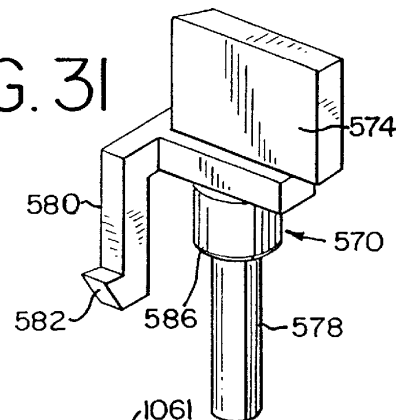

FIG. 32

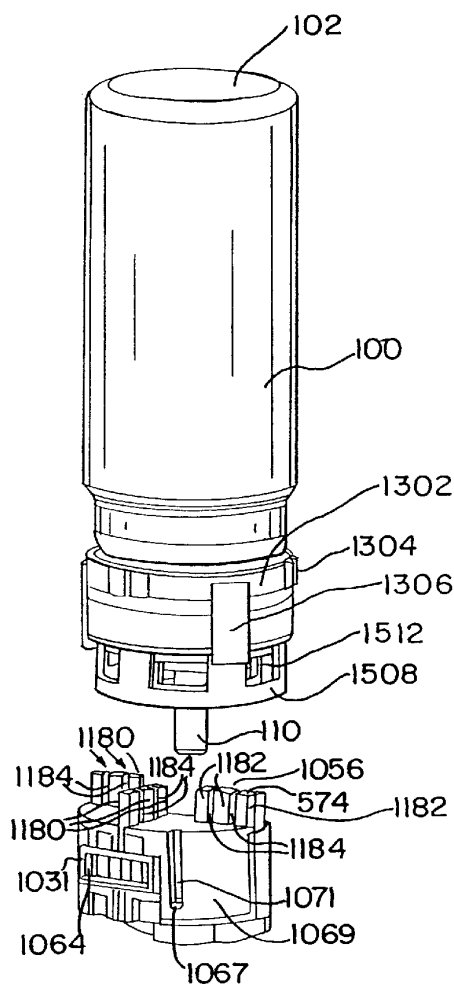

FIG. 34

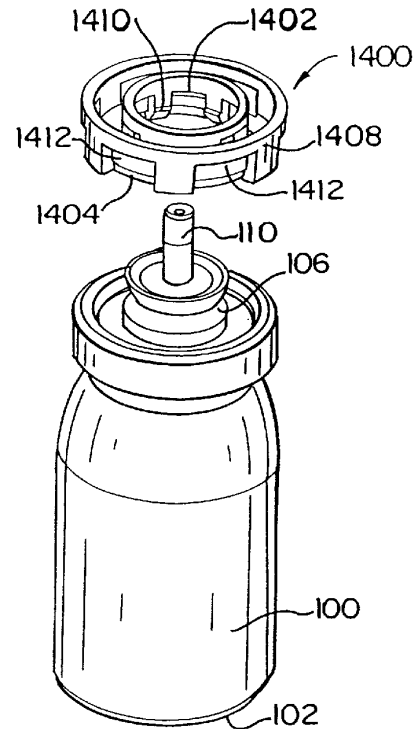
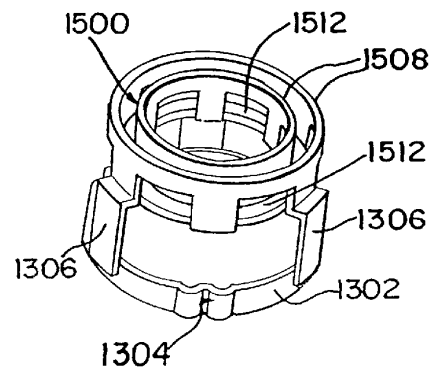

FIG. 33



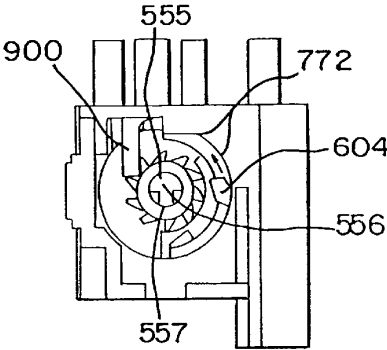

FIG. 35

FIG. 36

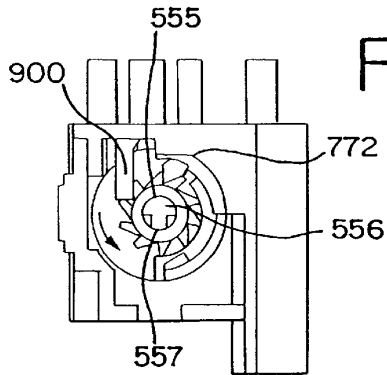
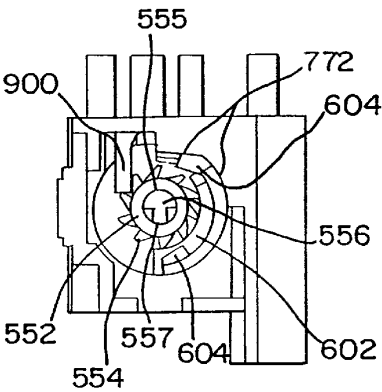

FIG. 37

FIG. 38

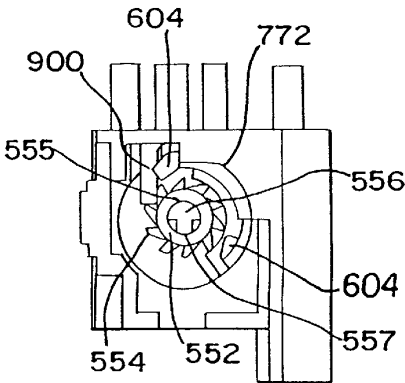

FIG. 39

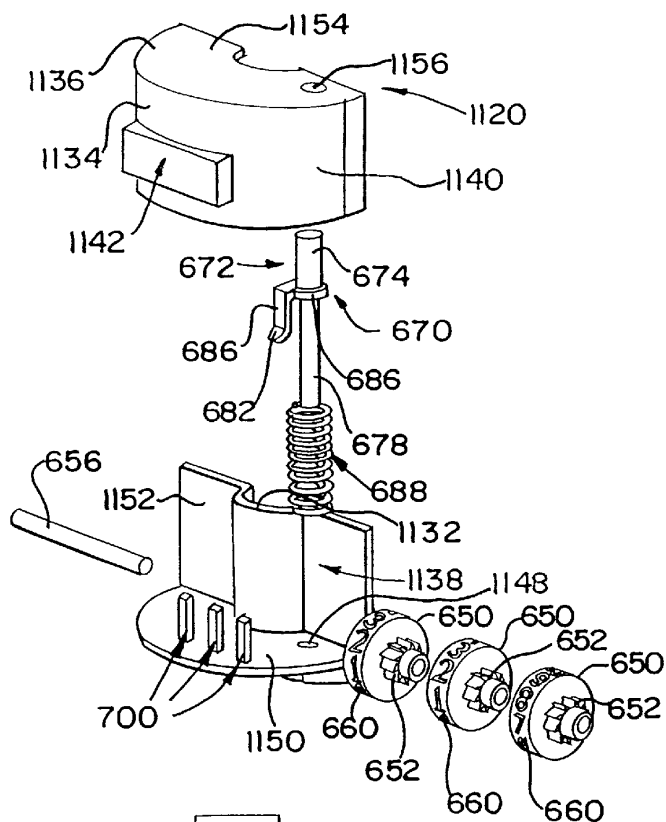

FIG. 40

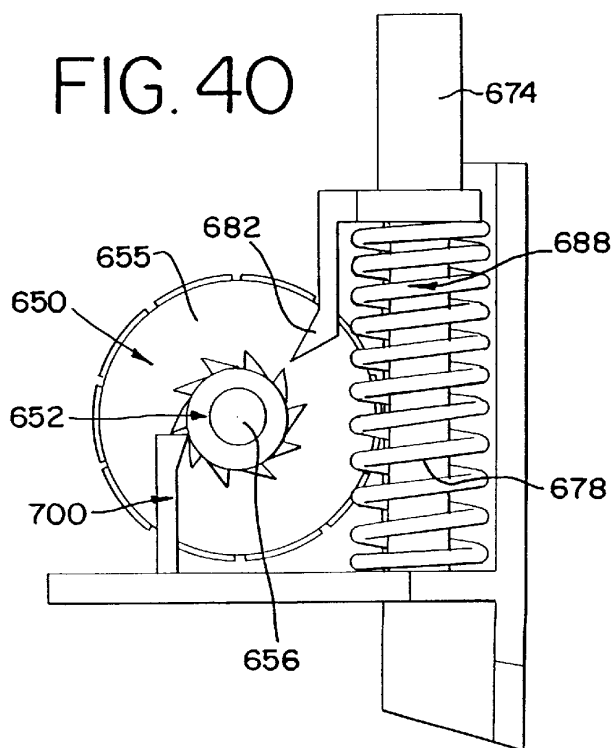

FIG. 41

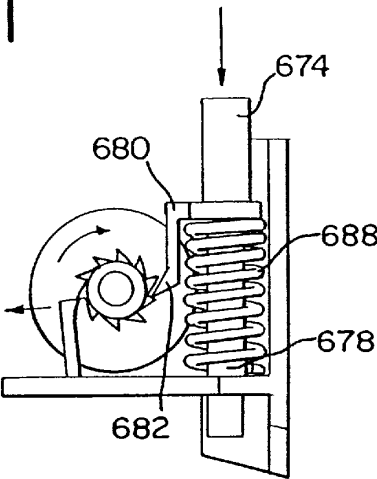

FIG. 42

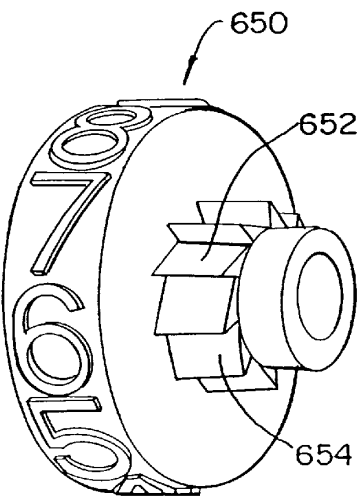

FIG. 43

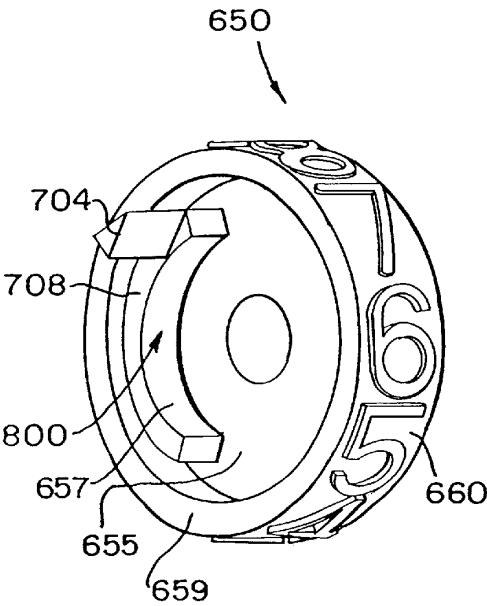

FIG. 44

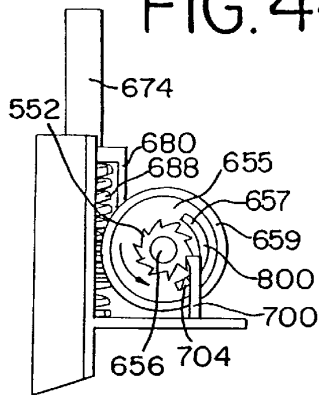

FIG. 45

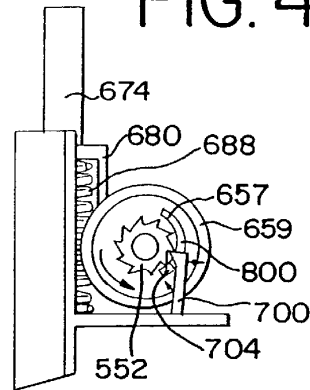

FIG. 46

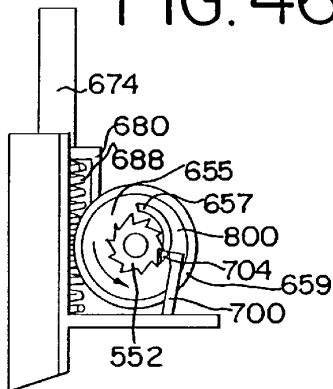

FIG. 47

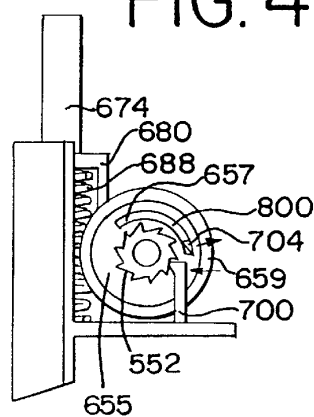
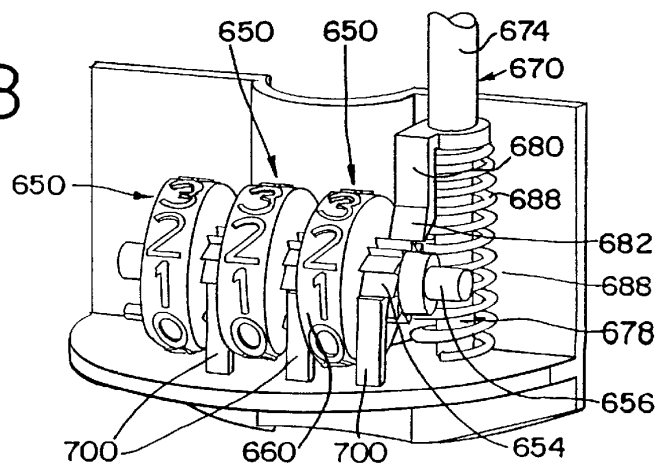

FIG. 48



1

INDICATING DEVICE

This application is a continuation-in-part of application Ser. No. 09/008,184, filed Jan. 16, 1998, and entitled Aerosol Dispensing Device, the disclosure of which is hereby incorporated herein by reference. No license, expressed or implied, is intended to be granted to application Ser. No. 09/008,184, or any patents issuing therefrom, by reason of the incorporation by reference herein.

BACKGROUND

The present invention relates generally to an indicating device, and in particular, to an indicating device for indicating the number of metered dosages of a substance, and in particular a medicament, that have been dispensed by, or remain in, a dispensing device.

Delivery systems, and in particular, dispensing devices, have been developed that include a counting or dose indicating device to indicate the number of metered doses of substance that have been dispensed from the delivery system, or to indicate the number of doses remaining therein. For example, patients have certain conditions that can be treated with medicaments dispersed in an aerosol and administered to the patient by inhalation. In one format, the aerosol and medicaments are contained in a container, and dispensed in metered, or measured, dosages with the dispensing device, which can include an actuator boot. In such an arrangement, it can be important for the patient to be able to ascertain the number of metered doses remaining in the container, either by an indication of the number remaining therein or by knowledge of the number already dispensed therefrom, such that the patient is not caught unaware with an empty container when in need of the medicament. Thus, it may be important for the dispensing device to provide an accurate indication of either the number of doses remaining in the container, or the number of doses already dispensed therefrom.

Typically, a conventional aerosol container includes a body and a valve stem which can be depressed relative to the body so as to emit the metered dose of aerosol and medicament. The container is usually supplied with a predetermined number of metered doses, e.g., on the order of about 200, such that the counting of the number of valve stem depressions, and corresponding number of dispensed metered doses, can be directly correlated with the number of doses remaining in the container.

In operation, the container is typically received within a housing of the dispensing device, wherein the valve is brought into engagement with a support block in the housing. The user administers the medicament by moving the container relative to the housing so as to depress the valve stem and internal valve and thereby release a metered dose, which is typically administered to the user through a port or mouthpiece extending from the housing. In an alternative delivery system, the metered dose can be first discharged into a chamber, and thereafter administered to the patient. After the metered dose is discharged from the container, the valve stem, which is typically spring loaded, biases the container away from the support block so as to again move the container relative to the housing. In this way, a metered dose of medicament is discharged by each cycle of linear reciprocal movement of the container relative to the housing.

Some dispensing devices have indicating devices that convert the linear reciprocal movement of the container relative to the housing into a one-way, or single-cycle,

2

movement of an indicator, wherein the indicator identifies the relative fullness of the container, the number of metered doses remaining therein or the number of doses already administered. Although these dispensing devices with indicators have provided the advantage of generally being able to keep track of the number of dosages, there remains room for improvement. For example, indicating devices of this nature may include complex moving parts which can be difficult to assemble and expensive to manufacture. Such devices may also be susceptible to counting inaccuracies due to the configuration of the indexing or mating parts, or require excessive amounts of space within the housing to accommodate the relatively large or numerous moving parts. Others still may impede or interfere with the airflow and medicament being dispensed from the inhalation device. Alternatively, some devices use electrical circuitry to count or record the dispersements. Such devices can be relatively expensive to manufacture, however, and typically require a power source which may be susceptible to damage in various environments, such as moist conditions.

SUMMARY

Briefly stated, in one aspect the invention is directed to a dispensing device having an indicating device. The dispensing device dispenses metered dosages of a substance from a container having a valve moveable between a closed position and an open position. The container dispenses a metered dosage when the valve, actuated by a valve stem, is moved to the open position. In an exemplary embodiment, the dispensing device includes a housing adapted to support the container reciprocally moveable within the housing along a longitudinal axis. The housing has a well adapted to receive the valve stem and an exhaust port. The well communicates with the port such that the metered dosage of substance is dispensed through the port when the valve stem is moved to the open position.

In one embodiment of the indicating device, an indicator assembly includes a worm rotatably mounted in the housing about an axis transverse to the longitudinal axis and responsive to the movement of the reciprocal movement of the container within the housing such that the longitudinal movement of the container relative to the housing causes the worm to rotate about its axis. An indicator member includes dosage indicia visible to a user and a circular gear mounted in the housing about an axis transverse to the axis of the worm and non-parallel to the longitudinal axis. The circular gear engages the worm.

In a preferred embodiment, the indicator assembly further includes a ratchet wheel rotatably mounted in the housing and adapted to be responsive to the reciprocal movement of the container relative to the housing along the longitudinal axis. The ratchet wheel is connected to the worm such that rotation of the ratchet causes the worm gear to rotate about its axis. In addition, an actuator member including an arm is preferably mounted within the housing and is adapted to move in response to the movement of the container and operably engage the ratchet wheel so as to rotate the wheel in response to the longitudinal movement of the container relative to the housing. Also in the preferred first embodiment, the indicator member includes an indicator wheel coaxially mounted with the circular gear on an axle defining the axis of rotation of the indicator member. The dosage indicia are applied to a surface of the indicator wheel.

In another embodiment of the indicating device, the housing comprises at least one engagement member and the

3

indicator assembly includes a plurality of indicator members, including at least a first and second indicator member. The plurality of indicator members are coaxially mounted in the housing. At least one of the first and second indicator members includes an advancement member, while at least the other of the first and second indicator members includes a plurality of teeth. In operation, the first indicator member is rotated relative to the second indicator member such that the engagement member selectively engages and biases the advancement member into operable engagement with at least one of the plurality of teeth so as to rotate the second indicator member an incremental amount.

In a preferred embodiment, an actuator member is mounted in the housing and is responsive to the movement of the container. The actuator member selectively engages at least one of the plurality of teeth on the first indicator member so as to advance the first indicator member an incremental amount in response to the movement of the container relative to said housing. A spring is preferably disposed in the housing to bias the actuator member into engagement with the container.

In another aspect of the invention, the indicator assembly, including the ratchet wheel, worm, actuator member and indicator member of the first embodiment, are mounted within an indicator module which is adapted to be mounted within the dispenser housing. Similarly, with respect to the second embodiment, the indicator assembly, including the plurality of indicator members, advancement member, spring and ratchet member, are supported in the indicator module. The module preferably includes a first and second member which are joined to form an enclosure or housing, and which support any one or more of the ratchet wheel, worm, actuator member and indicator member of the first embodiment therein, or the plurality of indicator members, advancement member, spring and actuator member of the second embodiment. In the second embodiment, the engagement members are also preferably disposed in the module housing.

In another aspect of the invention, a key member is mounted to one of the container and the housing and is shaped to be received in a passageway formed in the other of the housing and container.

In yet another aspect of the invention, a method is provided for dispensing measured dosages from the container. In one embodiment, the method includes the steps of moving the container along the longitudinal axis so as to move the valve stem, and valve, to the open position wherein a metered dosage is discharged. The longitudinal movement of the container within the housing causes the ratchet gear to rotate a predetermined angular amount, which, in turn, causes the worm to rotate about its axis. The worm then engages the circular worm gear of the indicator member so as to rotate the worm gear about its axis.

Alternatively, in a second embodiment, the first indicator member is rotated a predetermined amount in response to the movement of the valve between a closed and open position, or vice versa. Upon a predetermined number of movements of the valve, the first indicator member causes the second indicator member to rotate a predetermined amount.

In another aspect of the invention, a method is provided for assembling a dispenser comprising a housing, a container and an indicator module.

In yet another aspect of the invention, a kit includes components capable of being assembled as a dispensing device for dispensing metered dosages of a substance from

4

a container. The kit includes a housing, a container having a plurality of metered dosages of the substance and an indicator module having an indicator member.

The present invention provides significant advantages over other indicating devices. In particular, with respect to the first embodiment of the indicating device, the worm provides for a compact drive component that does not occupy excess space within the housing. Moreover, the worm provides for high gear reduction ratios while maintaining a continuous engagement with the circular worm gear. The continuous engagement of the worm and circular gear ensures that the accuracy of the counting device is maintained, while simultaneously simplifying the manufacturing and assembly process.

The use of a circular gear having an axis non-parallel, and preferably transverse or perpendicular to the longitudinal movement of the container within the housing, also provides several advantages. Importantly, the gear can be easily mounted to the housing with an inexpensive and easy-to-install axle. Thus, the circular gear provides for a compact single-cycle device that fits easily into the housing, and which maintains continuous engagement with the worm gear for improved and accurate indexing of the indicator member. Moreover, the components are arranged so as to not interfere with or otherwise impede the air flow from the valve stem to the exhaust port of the housing. In addition, the indicator wheel, which is preferably coaxially mounted with the worm gear, provides an ideal planar surface for displaying the dosage indicia. The indicia can be easily viewed by the user through the viewing window.

The second embodiment of the indicating device provides similar advantages. In particular, the plurality of indicator members can be mounted in a compact arrangement to provide accuracy and reliability under various operating conditions but which does not impede or obstruct the airflow to the user. Moreover, the various parts are relatively inexpensive to manufacture and assemble. The indicia, which are visible to the user through the viewing window, are easy to read and readily accessible to the user.

The indicator module, with any of the various embodiments of indicating assemblies disposed therein, also presents several advantages. In particular, the self-contained unit can be separately manufactured and installed as needed in any number of conventional types of dispensing devices with minimal modification thereof. Moreover, the module can be easily installed without interfering with or otherwise impeding the air flow from the valve stem to the exhaust port and ultimately to the user.

The key member also presents several advantages. In particular, differently configured key members and passageways can be installed between containers holding different substances such as medicaments and corresponding delivery system housings so as to prevent the user from interchanging various containers and housings so as to thereby alter the number of doses being counted. The key member and passageway can also prevent a user from using the wrong delivery system for a particular container having a particular substance, such as a medicament.

The present invention, together with further objects and advantages, will be best understood by reference to the following detailed description taken in conjunction with the accompanying drawings.

BRIEF DESCRIPTION OF THE DRAWINGS

FIG. 1 is a perspective view of a dispensing device with a viewing window revealing dosage indicia.

5

FIG. 2 is a perspective view of one embodiment of the dispensing device with a portion of the housing cut away.

FIG. 3 is a perspective view of one embodiment of the indicator assembly.

FIG. 4 is a perspective view of an alternative embodiment of the dispensing device.

FIG. 5 is a perspective view of the dispensing device shown in FIG. 4 with a portion of the housing cut away.

FIG. 6 is a perspective view of a container, a dispenser housing and one embodiment of an indicator module with a portion of the housing cut away.

FIG. 7 is an exploded perspective view of a container, a dispenser housing and one embodiment of the indicator module with a portion of the housing cut away.

FIG. 8 is an exploded perspective view of one embodiment of the indicator module.

FIG. 9 is an exploded perspective view of the indicator module from the opposite side as shown in FIG. 8.

FIG. 10 is an exploded perspective view of a container, and an alternative embodiment of the dispenser housing and the indicator module.

FIG. 11 is a perspective view of the alternative embodiment of the indicator module shown in FIG. 10.

FIG. 12 is a section cut of a housing and an indicator module mounted therein.

FIG. 13 is a top view of one embodiment of the indicator module.

FIG. 14 is a rear view of the indicator module shown in FIG. 13.

FIG. 15 is a cross-sectional view of the indicator module taken along line 15—15 of FIG. 13.

FIG. 16 is a cross-sectional view of the indicator module taken along line 16—16 of FIG. 13.

FIG. 17 is a cross-sectional view of the indicator module taken along line 17—17 of FIG. 13.

FIG. 18 is a cross-sectional view of the indicator module taken along line 18—18 of FIG. 13.

FIG. 19 is a perspective view of an alternative embodiment of the module.

FIG. 20 is a cross-sectional view of the indicator module taken along line 20—20 of FIG. 14.

FIG. 21 is an exploded view of a container, a key member and an indicator module.

FIG. 22 is a top view of the key member.

FIG. 23 is a cross-sectional view of the key member taken along line 23—23 of FIG. 22.

FIG. 24 is a perspective view of a container and an alternative embodiment of the indicator module mounted in a dispenser housing with a portion of the housing cut away.

FIG. 25 is an exploded perspective view of an alternative embodiment of an indicator module, key member and indicator assembly.

FIG. 26 is a top perspective view of a first member of one embodiment of the indicator module housing.

FIG. 27 is a bottom perspective view of the member shown in FIG. 26.

FIG. 28 is a perspective view of one embodiment of an indicator member.

FIG. 29 is an opposite perspective view of the indicator member shown in FIG. 28.

FIG. 30 is a top perspective view of a second member of one embodiment of the indicator module with an axle installed therein.

6

FIG. 31 is a perspective view of an actuator member.

FIG. 32 is a perspective view of a container with an alternative embodiment of a key member installed thereon positioned above one embodiment of an indicator module.

FIG. 33 is a perspective view of an alternative embodiment of the key member.

FIG. 34 is an exploded perspective view of an alternative embodiment of a key member being applied to a container.

FIG. 35 is a cross-sectional view of an indicator module showing an advancement member of a first indicator member, an engagement member and a second indicator member.

FIG. 36 is a cross-sectional view of the advancement member of the first indicator member as it is first engaged by the engagement member in the indicator module housing.

FIG. 37 is a cross-sectional view of the advancement member as it is biased by the engagement member into engagement with the second indicator member so as to rotate the second indicator member.

FIG. 38 is a cross-sectional view of the advancement member as it is released by the engagement member and disengages from the second indicator member.

FIG. 39 is an exploded perspective view of an alternative embodiment of an indicator module and indicator assembly.

FIG. 40 is an enlarged side view of an actuator member in a disengaged position adjacent a first indicator member.

FIG. 41 is a side view of the actuator member engaging the first indicator member with the non-return being biased outwardly.

FIG. 42 is a perspective side view of an alternative embodiment of an indicator member.

FIG. 43 is an opposite perspective side view of the indicator member of FIG. 42.

FIG. 44 is a cross-sectional view of an advancement member on a first indicator member, a second indicator member and an engagement member.

FIG. 45 is a cross-sectional view of the advancement member as it is first engaged by the engagement member.

FIG. 46 is a cross-sectional view of the advancement member as it is biased by the engagement member into engagement with the indicator member.

FIG. 47 is a cross-sectional view of the advancement member as it is further biased by the engagement member into engagement with the second indicator member.

FIG. 48 is a perspective view of an alternative embodiment of an indicator assembly disposed on a lower member of the module housing.

DETAILED DESCRIPTION OF THE PRESENTLY PREFERRED EMBODIMENTS

Referring to the drawings, and in particular FIGS. 1, 4, 6, 7 and 24, a delivery system, configured as a dispensing device, or dispenser, is shown as including a housing 10, or actuator boot, and a container 100 disposed therein. The housing 10 has a longitudinally extending cavity 12 shaped to receive the container. A top portion of the housing is generally open such that the container can be inserted in the housing through opening 14 and be installed therein with a bottom end 102 of the container protruding from the housing and exposed to the user for actuation.

It should be understood that the term “delivery system,” as used herein, is meant to include a system or apparatus for delivering a substance from a container, reservoir, or similar

repository, to a user, and includes but is not limited to the disclosed dispensing device, which delivers the substance to the user in the form of an aerosol that is inhaled by the user. The term "dispensing device," as used herein, is meant to include devices that extrude, spray or otherwise feed out or deliver a substance in convenient units, and includes, but is not limited to, the disclosed inhalation device which delivers metered dosages of a substance in aerosol form for inhalation by the user.

The term "longitudinal" as used herein is intended to indicate the direction of the reciprocal movement of the container relative to the housing. The terms "top," "bottom," "upwardly" and "downwardly" are intended to indicate directions when viewing the inhalation devices as shown in the Figures, but with the understanding that the container is inverted such that the top surface thereof is located adjacent the bottom of the housing and vice versa.

As shown in FIGS. 5, 6 and 7, a cylindrical support block 16 having a well 18 is formed in a bottom portion 22 of the housing. An orifice 20 penetrates the support block to communicate with a bottom portion of the well. A mouthpiece 24, intended for insertion into the mouth of a patient, forms an exhaust port 26 that communicates with the orifice and well. The mouthpiece 24 extends laterally from the housing so as to facilitate insertion of the mouthpiece into the mouth of the patient.

The container 100 is formed as a cylindrical canister 104 having a 106 hub disposed on a top surface 108 thereof. A valve stem 110 extends longitudinally from the hub. The valve stem extends coaxially from the canister and is biased outwardly therefrom by a spring (not shown) mounted within the canister. The container 100 is mounted in the housing by press fitting the valve stem 110 in the well 18 of the support block. It should be understood that the container can be configured in a variety of shapes and sizes, and that the substance contained therein can be released by any number of valve systems that are well known in the art. It should also be understood that the valve system can be actuated by a variety of actuators, including, but not limited to, various pumps, levers, actuator boots, buttons and the like. In such embodiments, the valve system can be actuated by an actuator moveable relative to the container and housing such that the container remains stationary relative to the housing.

In a preferred embodiment, the container 100 is filled with a substance which is dispensed therefrom in specific metered doses by depressing or moving the valve stem 110 from an extended closed position to a depressed open position, which in turn opens the valve or valve system. Preferably the substance is a medicament, although it should be understood that the container could be used to hold a variety of non-medicinal substances, including, but not limited to, various liquids, foams or aerosols that can be delivered by various delivery systems, and/or dispensing devices. A medicament is defined as a substance that can be used in therapy, such as for various therapeutic treatments, including the treatment of diseases (e.g., respiratory ailments) and for the relief of pain, and should be understood to include medicines and medicinal substances in general. A single metered dose is dispensed from the container by each reciprocal, longitudinal movement of the valve stem and attendant opening and closing of the valve. The medicament is typically delivered to the user, or patient, through their mouth and/or nose in the form of an aerosol, spray or liquid.

In operation, the opening of the valve stem and valve is effected by moving the container 100 reciprocally within the

housing 10 along a longitudinal axis, defined by the valve stem and the reciprocal movement of the container, by depressing the exposed bottom end 102 of the canister relative to the housing 10 so as to move the valve stem 110 to the open position as it is supported within the well by the support block. Alternatively, an actuator can be moved to open the valve system of the container, which can remain stationary with respect to a supporting housing, a cap and/or an indicating device mounted thereto. For example, the actuator can be attached to the end of the container in the form of a pump device or the like.

Referring to FIGS. 5-7, as the valve stem is moved to the open position, the container dispenses a metered dose of the substance in aerosol form through the well 18 and orifice 20 and into the exhaust port. The substance in aerosol form is then transmitted to the user through the exhaust port of the mouthpiece by way of either a self-generated or assisted airflow. Alternatively, metered doses of liquids and the like can be dispensed from the container.

In other delivery systems, which may also include a dispensing device, the housing and holder for the container are attached to a component having a chamber with an output end. Examples of these kinds of delivery systems and dispensing devices are shown for example in U.S. Pat. No. 5,012,803, issued May 7, 1991, and U.S. Pat. No. 4,460,412, issued Sep. 11, 1984, the entire disclosures of which are hereby incorporated herein by reference. (No license, expressed or implied, is intended to be granted to either of these patents by reason of the incorporation by reference herein.) In these kinds of delivery systems, the component having the chamber can be adapted to receive the mouthpiece of the housing, or it can be integrally connected with a holder supporting the container. In either embodiment, the metered dose of substance, preferably a medicament, in aerosol is first dispensed from the container into the chamber, and thereafter inhaled by the user.

In a preferred embodiment, the container 100 is intended to dispense a predetermined number of metered doses of substance. For example, conventional inhaler containers typically hold on the order of 100 to 200 metered doses. In operation, it is important that the user be aware of the number of metered doses remaining in the container such that the user is not caught unaware with an empty canister when in need of the substance, such as a medicament.

Now referring to FIGS. 2 and 3, a dispensing device, configured as an aerosol dispenser, is shown as including a housing, a container mounted therein as described above and an indicator assembly. The indicator assembly includes a ratchet gear 32 coaxially mounted with a worm 40 on an axle 42 in a lower portion of the housing. A plurality of teeth 34 are formed about the periphery of the ratchet gear. The teeth 34 are cut or formed with a tapered surface 36 and engagement surface 38. In a preferred embodiment, the ratchet and worm are formed out of a hard durable plastic. It should be understood, however, that other materials such as metal would also work. The ratchet and worm can be made as separate parts, or molded as a single integral member.

In a preferred embodiment, the axle 42 and worm 40 define an axis of rotation transverse, or perpendicular, to the longitudinal axis defined by the valve stem and reciprocal movement of the container relative to the housing. Opposite ends of the axle 42 are rotatably supported in the housing.

Also as shown in FIGS. 2 and 3, an indicator member 50 comprises a circular worm gear 52 and indicator wheel 58 coaxially mounted on an axle. In a preferred embodiment, the axle 56 defines an axis of rotation transverse to the axis

defined by the worm and also transverse to the longitudinal axis defined by the reciprocal movement of the container relative to the housing. The axle **56** is rotatably supported in the housing. Teeth **54** are formed around the periphery of the worm gear **52** and are shaped to permanently engage the worm **40**. As shown in FIG. 2, the indicator wheel **58** has a planar face **60** which is exposed to the patient through a viewing window **28** formed in the housing.

The ratchet gear **32**, worm **40**, worm gear **52** and indicator wheel **58** provide an ideal arrangement for indicating the number of doses remaining in the container, or the number dispensed therefrom. In particular, relatively high reduction ratios are made possible through use of the ratchet, worm and worm gear without the corresponding requirement of providing extremely fine teeth on one or more of the ratchet gear and worm gear. Moreover, the worm and worm gear interface avoids the associated inaccuracies introduced by the mating, and potential skipping, of conventional spur gears having fine teeth. Furthermore, the installation of the indicator member is effected by the installation of a simple axle which can be supported in a plurality of positions and angular orientations within the housing. Importantly, the high reduction ratio realized with the worm **40** allows for the worm gear **52** to have a relatively small diameter, such that it can be easily mounted within small spaces within the housing. Indeed, as shown in FIGS. 6 and 12, the entire indicator assembly can be mounted behind the support block **16** and below the upper surface **17** thereof such that the assembly does not interfere with the dispensing of the medicament from the orifice or with the airflow generated by the patient in administering the medicament.

Referring to FIG. 5, an actuator member **70** is configured as a post member **72** moveably supported in the housing along an axis parallel to the longitudinal axis defined by the reciprocal movement of the container within the housing. In an alternative embodiment shown in FIGS. 7-9, the post member includes an upper portion **74**, a middle portion **76** and a lower portion **78**. A resilient arm member **80** extends from the middle portion of the post member and terminates in a tapered hook member **82** shaped to selectively engage one of the ratchet wheel teeth. The middle portion **76** is defined by upper and lower stop surface **84**, **86**. A spring **88** is disposed about the lower portion **78** of the post member and engages the lower stop surface **86** so as to bias the actuator member upwardly against the top surface **108** of the canister as shown in FIG. 7. Although a compression spring is shown in the Figures, it should be understood that cantilever, torsion, leaf and tension springs, and the like, would also work to bias the actuator member upwardly into engagement with the container. The springs can be made of metal or plastic.

In an alternative embodiment, shown in FIGS. 2 and 3, actuator member **90** includes locking ring **92** and a resilient arm member **94** extending longitudinally downwardly therefrom. A longitudinal slit **96** is formed in the locking ring so as to allow for the locking ring **92** to be expanded and disposed around the hub **106** (shown in FIG. 5) of the canister in a snap fit configuration such that the valve stem of the container extends through opening **98** of the locking ring. A distal end of the resilient arm member terminates in a hook member **95** which is shaped to selectively engage the teeth of the ratchet wheel.

In the operation of the embodiment shown in FIGS. 6-9, 13-18 and 20, the container is moved longitudinally within the housing so as to depress the valve stem to the open position so as to open the valve as explained above. As the container is moved downwardly within the housing, the

actuator member **70** is moved longitudinally downward such that the hook member **82** engages the ratchet wheel and rotates it a predetermined angular amount corresponding to the pitch of the teeth. When the container is released by the user, the spring (not shown) within the container biases the container upwardly within the housing along the longitudinal axis such that the valve stem **110** is moved to the closed position within the container so as to close the valve. As the container moves upwardly, the resilient arm member **80** is biased laterally outward as a tapered end portion of the hook member **82** slides against the tapered surface **36** of one of the ratchet teeth. As the container and resilient arm member reach the top of the stroke, wherein the valve stem is moved completely to the closed position, the resilient arm member **80** returns to its normal straightened configuration as the hook member **82** slips past the tapered surface of one of the teeth so as to be positioned over the engagement surface **38** of that tooth **34** for the next cycle.

Alternatively, the operation of the ratchet wheel can be reversed as shown in FIG. 3. In this embodiment, the resilient arm member **94** is biased outwardly by the tapered surface of one of the ratchet gear teeth on the downstroke. At the bottom of the stroke, the hook member **95** slips into an underlying relationship with the engagement surface of the tooth. When the container is released by the user, the spring (not shown) within the canister biases the container upwardly within the housing along the longitudinal axis such that the valve stem is moved to the closed position within the container. As the container moves upwardly with respect to the housing, the resilient arm member **94** moves longitudinally upward such that the hook member **95** engages the engagement surface **38** of one of the teeth and thereby rotates the ratchet wheel an incremental amount.

In the embodiment shown in FIGS. 6-9, 13-18 and 20, it is the force of the spring **88** that moves the arm member **80** upwardly so as to return the actuator member in preparation for another cycle. In the alternative embodiment shown in FIGS. 2 and 3, it is the movement of the container, as it is biased upwardly by the internal spring acting on the valve stem, that causes the locking ring **92** and arm member **94** to move upwardly and thereby rotate the ratchet gear.

Referring to FIGS. 8 and 17, a resilient non-return member **200** engages the ratchet gear adjacent the hook member so as to ensure that the rotation of the ratchet gear is unidirectional. Alternatively, the non-return member can be positioned to engage the ratchet gear opposite the actuator arm member. The non-return member includes an end portion adapted to engage the engagement surface of the ratchet gear teeth. As the ratchet gear is rotated by the actuator, the non-return member slides along the tapered surface of one of the teeth of the ratchet wheel and does not interfere with the rotation thereof.

The rotation of the ratchet gear causes the worm **40** to rotate a desired predetermined amount. It should be understood that the desired amount of rotation is dependent upon the diameter of the ratchet wheel and the number of teeth positioned thereabout. Rotation of the worm, which permanently engages the teeth of the worm gear, causes the worm gear and indicator wheel to rotate a predetermined incremental amount. The amount of rotation of the indicator wheel is dependent upon the pitch of the worm, the number of worm threads and the pitch of the worm gear and the number of worm gear teeth. In a preferred embodiment, the worm has a single thread.

For ease of manufacturing, it is desirable to provide as coarse a pitch on each of the ratchet and worm gears as

possible, although the gears are still defined as fine-toothed gears. However, it is also intended that the indicator member make only a single revolution (single-cycle) corresponding to a complete evacuation of medicament from the container. Thus, when a large number of doses (on the order of 200 or more) are contained within the canister, it is important for the ratchet, worm and worm gear to provide a relatively high reduction ratio, such that 200 linear reciprocal movements of the actuator member correspond to one or less revolutions of the indicator member. Because the ratchet gear and worm rotate together, it should be understood that the number of teeth on the ratchet gear and worm gear, and the number of threads of the worm, determine the ultimate reduction ratio between the rotation of the ratchet gear and the rotation of the indicator wheel.

For example, when the container holds 240 metered doses, an acceptable ratio is realized if the ratchet is made relatively coarse with 10 teeth and the worm gear is provided with 28 teeth. In operation, the dispensing of 10 metered doses will cause the worm to make one complete revolution so as to thereby move the worm gear one tooth. After 240 linear reciprocal movements, the worm gear has been advanced by 24 teeth. Extra teeth are provided so that the starting and ending indicia, indicating a relative fullness or emptiness of the container respectively, are not labeled one on top of the other.

In a preferred embodiment, shown in FIGS. 9 and 15, the worm gear 52 has teeth formed around only a portion of its periphery so that a gap is formed between the teeth around the remaining portion of the periphery. In operation, the gears are configured so that the worm 40 disengages from the last tooth of the worm gear as the final prescribed dose of medicament is dispensed. In this position, the indicia on the indicator wheel 58 will indicate to the user that the canister is empty. Therefore, although the user can continue to move the container so as to open the valve, the resultant movement of the actuator 70, ratchet gear 32 and worm will not in turn rotate the indicator member as the gap in the teeth on the worm gear results in the disengagement of the worm and worm gear. In this way, the indicator wheel is prevented from being inadvertently rotated from a full to empty reading and then back again to a full reading, which could confuse the user about the number of doses remaining in the canister.

The indicator wheel 58, indicia 66 and viewing window 28 can be arranged in a variety of configurations for viewing by the user. For example, the viewing window 28, 124 can be configured as a rectangular shaped window as shown in FIG. 2 or 10 respectively, as an arcuate shaped window 29 as shown in FIG. 4, wherein approximately $\frac{1}{3}$ of the face of the indicator wheel is visible at any time, as a circular shaped window (not shown) or as any other shape allowing the user to view the indicator wheel and the indicia located thereon. In one embodiment, the indicia take the form of a color code, where, for example, a portion of the wheel is colored green to indicate the starting full position, a portion is colored yellow to indicate a medium fullness and a portion is colored red to indicate that the container is empty. Obviously, other colors, shading or alpha-numerical indicia can be provided on the indicator wheel to indicate the relative fullness or emptiness of the container.

In an alternative embodiment, the indicator wheel can be oriented within the housing such that either its planar face or its circumferential surface, with indicia applied thereto, are visible to the user through the exhaust port of the mouth-piece.

Referring to FIG. 25, an alternative embodiment of an indicator assembly is shown. The indicator assembly

includes three indicator members 550 coaxially mounted on an axle 556 and rotatable thereabout. As best shown in FIGS. 28 and 29, each of the indicator members includes an indicator wheel 558 having a circumferential skirt 559 with an outer circumferential surface 560 on which indicia (shown as numbers) are applied, and a ratchet gear 552 coaxially mounted with the indicator wheel. The indicator wheel and ratchet gear have an opening 553 shaped to receive the axle. The ratchet gear 552 includes a plurality of teeth 554 formed around its periphery. The ratchet gear is preferably integrally molded with the indicator wheel, although it should be understood that the gear and wheel can be made separately and thereafter attached one to the other by welding, adhesive and the like.

In one embodiment of the indicator member, a resilient advancement member 600 is formed from a portion of the circumferential skirt 559 by providing an elongated cutout 602 in the indicator wheel radially inward from and beneath the skirt. The advancement member 600 includes a laterally extending tooth portion 604 having an engagement surface 606. The three indicator members are coaxially mounted such that the tooth portion 604 of the advancement member of a first indicator member overlies the ratchet gear teeth 554 of the second indicator member, and such that the tooth portion 604 of the advancement member of the second indicator member overlies the ratchet gear teeth 554 of the third indicator member. When only three indicator members are used (as shown in FIG. 25), the third indicator member does not require an advancement member, although for the sake of simplicity in manufacturing, a modular indicator member with the same indicia applied thereto and the same advancement member formed thereon is preferably used for each of the first, second and third indicator members. It should be understood by one of skill in the art that one or more indicator members may be used to provide an indication of dosages used or available, and that the three indicator members shown in the Figures is meant to be illustrative, rather than limiting. In addition, it should be understood that a plurality of indicator members refers to any number of indicator members greater than one.

In an alternative embodiment of the indicator member 650, shown in FIGS. 39, 42 and 43, an advancement member 800 is disposed radially inward from a circumferential skirt 659 and includes a first end 657 connected to a planar side portion or hub 655 of the indicator wheel. The advancement member includes a curved resilient portion 708 having a free end with a tooth portion 704 extending laterally outward therefrom so as to extend laterally from beneath the skirt 659 of the indicator wheel such that it overlies the teeth of the ratchet gear of an adjacent indicator member coaxially mounted therewith as shown in FIG. 48. Indicia, preferably in the form of numbers, are applied to the circumferential surface 660 of the skirt. A ratchet gear 652, having a plurality of teeth 654 is coaxially mounted with the indicator wheel. As shown in FIG. 48, three indicator members are coaxially mounted on axle 656.

Referring to FIGS. 25 and 39, an actuator member 570, 670, otherwise referred to as a ratchet member, is shown as having an upper portion 574, 674 extending upwardly from a lower portion 578, 678 and a resilient arm member 580, 680 extending outwardly therefrom and terminating in a resilient hook member 582, 682 shaped to selectively engage at least one of the teeth of the ratchet gear of the first indicator member. A spring 588, 688 is disposed around the lower portion of the actuator member and biases the upper portion 574, 674 of the actuator member into engagement with the container.

13

Referring to FIG. 27, a housing 820 is shown as having a pair of engagement members 770 formed integrally with the housing and including ramped surfaces 772. A plurality of non-return members 900 extend from the housing and selectively engage the ratchet gear to ensure unidirectional rotation of the indicator member as shown in FIGS. 35–38. Although the engagement members and non-return members are shown as being formed in or extending from a module housing, as described below, one of skill in the art should understand that those members or equivalent features could also be formed in or connected to the dispenser housing or actuator boot that supports the container, or disposed on or connected to the container itself.

Referring to FIGS. 25 and 35–38, the operation of the indicator assembly shown in FIG. 25 is generally shown. In particular, the container is moved longitudinally within the housing 10 so as to depress the valve stem 110 to the open position so as to open the valve as explained above. As the container is moved downwardly within the housing, or downwardly with respect to the module housing described below, the actuator member 570 is moved longitudinally downward such that the hook member 582 is biased outwardly by the ratchet gear 552 on a first outer indicator member. At the bottom of the stroke, the hook member 582 slips into an underlying relationship with the teeth on the ratchet gear. When the container is released by the user, the spring (not shown) within the container biases the container upwardly within the housing along the longitudinal axis such that the valve stem 110 and valve are moved to the closed position within the container. As the container moves upwardly, the resilient arm member 580 moves longitudinally upward such that the hook member 582 rotates the first indicator member a predetermined angular or incremented amount corresponding to the pitch of the teeth disposed around the periphery of the ratchet gear. As the container and resilient arm member reach the top of the stroke, wherein the valve stem and valve are moved completely to the closed position, the resilient arm member 580 is positioned over the ratchet gear for the next cycle. Alternatively, the operation of the actuator member and ratchet gear can be reversed as explained above with respect to the embodiment shown in FIGS. 6–9.

Referring to FIGS. 39–41 and 44–48, a plurality of resilient arm members 700 are shown as extending from a module housing so as to be aligned with the ratchet gears on each of the indicator members. The arm members 700 each serve as a combined engagement member and non-return member. In particular, as shown in FIGS. 40 and 41, the arm member 700 functions as a non-return member and includes an end portion that is biased away from the teeth on the ratchet gear as the actuator member, or adjacent indicator member with its advancement member, is actuated to advance the ratchet gear. The operation of the actuator member 670 and ratchet gear is similar to the operation of the ratchet gear shown in FIGS. 6–9 as explained above. The arm member 700 snaps back so that the end portion engages one of the teeth of the ratchet gear so as to ensure that the rotation of the ratchet gear is unidirectional. As shown in FIGS. 44–47, the arm member 700 overlying the ratchet gears of the second and third indicator members also serves as an engagement member that selectively engages the advancement members connected to the indicator members.

In operation, the reciprocal movement of the container relative to the housing is repeated until the first indicator member 550, 650, and its ratchet gear, are rotated one complete revolution. The predetermined number of reciprocal movements required to advance the first indicator mem-

14

ber one revolution is equal to the number of teeth disposed about the periphery of the ratchet gear 552, 652. As the first indicator member is rotated by successive movements of the container relative to the housing, the advancement member 600, 800 of the first indicator member is brought into selective engagement with the engagement member, configured as the ramped surface 772 formed in the housing or as the upwardly extending arm member 700. In particular, the engagement member 700, 772 biases the tooth portion 604, 704 of the advancement member into engagement with one of the teeth 554, 654 of the ratchet gear on the second indicator member.

As the first indicator member is further rotated by successive movements of the container relative to the housing, whether it be the dispenser housing for the container or the module housing described below, the advancement member 600 engages one of the teeth on the ratchet wheel of the adjacent indicator member and advances the indicator member a predetermined incremental angular amount corresponding to the pitch of the ratchet gear teeth. The term incremental is meant to refer to the angular amount the indicator member is moved by the advancement of one actuation, which corresponds to the movement of one tooth, regardless of whether the indicating device is indicating the number of doses left (e.g., counting down) or indicating the number of doses administered (e.g., counting up).

As the resilient advancement member 600, 800 clears the engagement member 772, 700, it springs away from the ratchet gear such that further advancements of the first indicator member do not effect a rotation of the second indicator member until the first indicator member completes yet another cycle so as to again bring the advancement member into engagement with the next tooth of the second indicator member ratchet gear, and so on. The second indicator member 550, 650 with its advancement member 600, 800, similarly interacts with a second engagement member overlying the teeth of the third indicator member so as to selectively engage and advance the third indicator member a predetermined incremental amount for each complete rotation of the second indicator member. It should be understood that more indicator members could be similarly assembled to provide an incremental indicating device.

In a preferred embodiment of the dispensing device, shown in FIGS. 6–10, 13–18, 20, 24, 25 and 39, the indicator assembly is arranged in an indicator module 120, 1020, 1120. The indicator module 120, 1020, 1120 is shaped to be received within the housing where it is disposed around a portion of the support block 16. In particular, the support block is spaced apart from the wall of the dispenser housing, otherwise referred to as the actuator boot, so as to form a donut-shaped socket in the bottom of the housing. The module includes a module housing 130, 1030, 1130 having an inner concave surface 132, 1032, 1132 that is shaped to mate with an outer convex surface of the cylindrical support block and an outer convex 134, 1034, 1134 surface that is shaped to mate with the inner concave surface of the housing which is also generally cylindrical. In this way, the module housing is shaped to be received within the socket formed around the support block. Preferably, the module housing has a semicircular shape and fits around a portion of the support block opposite the orifice opening so as to not interfere with the dispensing of the medicament, or the airflow transmitting the medicament to the patient. In this way, the module is maintained rearwardly of the midpoint of the support block. One of skill in the art should understand, however, that the module, or module housing, can be configured in any number of different sizes and shapes so as to

15

be accommodated in a variety of housings or cap assemblies, with or without support blocks and the like.

As shown in FIGS. 8–9, one embodiment of the module preferably includes a face portion **210** that extends from the rear convex surface of the module and includes a module viewing window **64**. The face portion snaps into the housing viewing window opening (circular opening not shown) so as to secure the module thereto. As shown in an alternative embodiment in FIGS. 10–12, the face portion includes a vertically oriented rectangular viewing window **68** and a downwardly extending locking member **122** which extends through the dispenser viewing window opening **124** and engages a bottom wall of the housing. In yet other embodiments, shown for example in FIGS. 24 and 30, the face portion **1031**, **1131** and viewing window **1064**, **1164** have an elongated horizontal orientation so as to provide the user with a view of the plurality of indicator members mounted within the module. It should be understood, however, that the module can be secured within the housing by any number of conventional means, including the use of fasteners or adhesive. Alternatively, the module can simply be press fit into the socket formed between the support block and housing wall.

In the embodiment shown in FIG. 8, the circular viewing window **64** is provided in the module housing so as to expose a substantial portion of the planar indicator wheel. Numerical indicia, corresponding to the number of doses in the container, are provided on the face **60** of the indicator wheel. An arrow, or like indicator, is applied to the housing adjacent the viewing window and provides an indication of the number of doses remaining in the housing, or the number dispensed therefrom, as the indicator wheel is rotated.

In other alternative embodiments, shown for example in FIGS. 10, 11, 25 and 39, the indicia are applied to a circumferential surface **62**, **560**, **660** of the indicator wheel. The module viewing window **68**, **1064**, **1164**, which is preferably rectangular, and indicator wheel are arranged such that the circumference, or periphery, of the wheel, or wheels, is visible through the module and dispenser viewing windows. As with the other embodiments, the indicia can take the form of color coding, shading, alpha-numerical characters and the like.

In the embodiments shown in FIGS. 28–29 and 42–43, the indicia are preferably formed around the circumferential surface **560**, **660** of the indicator wheel in the form of numbers ranging from 0 to 9, with the ratchet gear on the indicator member having 10 teeth. In operation, it should be understood that the three, or more or less, indicator members can be preset to the maximum number of dosages contained within the container, with the indicia, or in this case numbers, arranged about the periphery of the indicator wheel, such that successive, sequential actuations of the container cause the indicator members to count down.

Alternatively, the indicator members are assembled such that the zero (0) of each indicator member is displayed in the viewing window to the user. The container is then actuated by the user such that the first indicator member rotates within the housing to sequentially display the number of doses that have been dispensed from 1 to 9. Upon the tenth actuation, the indicator member completes a single revolution, by virtue of the ten teeth preferably formed about the ratchet gear which correspond to the predetermined number of actuations, and causes the second indicator member to advance one number from 0 to 1 as the first indicator member again displays a 0 such that the two members together indicate that 10 dosages have been dispensed. The

16

first indicator member is again rotated by successive actuations until another single rotation is completed to further rotate the second indicator to reveal the 2, so as to indicate that 20 dosages have been dispensed. Upon a complete rotation of the second indicator member, corresponding to 100 actuations, the third indicator member is advanced to reveal a 1 in the viewing window with the first and second indicator members revealing a 0, and so on.

As shown in FIGS. 6–10, 13–18 and 20, one embodiment of the indicator assembly, including the worm, worm gear, ratchet gear and indicator member, is mounted within the module housing **130**. Similarly, the embodiments of the indicator assembly shown in FIGS. 25 and 39 are also preferably supported in a module housing **1030**, **1130**. The module housing is preferably formed from a first and second cover member **136**, **138**, **1036**, **1038**, **1136**, **1138** although it should be understood that a single, integral piece of material would also work, as would any plurality of members joined together. Referring to FIGS. 6–10, 30 and 39 the first cover member **136**, **1136**, **1036** has a vertical wall **140**, **1140**, **1040** defining at least a portion of the outer convex surface **134**, **1034**, **1134** shaped to mate with the inner surface of the housing as described above. The secondary viewing window **64**, **1064**, **1164** of the module is provided in the vertical wall **140**, **1040**, **1140** so as to be aligned with the viewing window of the housing when the module is installed therein. The viewing window is framed by the face portion. In one embodiment, shown in FIG. 9, the first member also includes a pair of opposing bearing seats **144** formed on an inner surface of the vertical wall. The bearing seats **144** are shaped to support the ends of axle **42**. Alternatively, as shown in FIGS. 27 and 30 a bearing seat or lug **1044** can be formed on each of the first and second cover members. As best shown in FIGS. 9 and 30, a post member **146**, **1046** extends upwardly from a base **150**, **1050** of the first member adjacent one of the bearing seats and has a socket **148**, **1048** formed coaxially therein. Alternatively, as best shown in FIG. 39, the base **1150** is formed as part of the second cover member and includes an opening **1148** shaped to receive the lower portion **678** of the actuator member.

Referring to FIGS. 8–9, the second cover member **138**, **1038**, **1138** mates with the first cover **136**, **1036**, **1136** to form an enclosure therebetween. The second cover member includes a vertical wall **152**, **1052**, **1152**, a portion of which defines the concave surface **132**, **1032**, **1132** shaped to mate with the outer surface of the support block. An upper horizontal flange **154**, **1054**, **1154** extends from the vertical wall **152**, **1052**, **1152** and mates with the vertical wall of the second member in overlying relationship therewith so as to close off the top of the module. In an alternate embodiment, the upper flange **1154** is formed as part of the first cover member. The upper flange **154**, **1054**, **1154** has an opening **156**, **1056**, **1156** formed therein which is shaped to receive the upper portion **74**, **574**, **674** of the post member. In one embodiment, the upper surface of the flange is maintained parallel with or below the top surface of the support block so as not to interfere with the container as it is depressed toward the support block. Alternatively, as shown in FIGS. 8 and 9, the module housing is provided with a semi-circular recess **155** shaped to receive the hub as the container is actuated whereby the surface **108** of the container engages the upper portion **74** of the actuator member and the surface **108** is positioned adjacent to the surface **154** of the module housing when the valve is moved to the open position. A bottom edge **158** of the vertical wall mates with the base **150** of the first cover member to close off the bottom of the module. As shown in FIGS. 8–9, 25–27 and 30, the cover

17

members are joined by slidably engaging vertical flanges **160, 1060** on the first cover member with grooves **162, 1062** formed on the second cover member. Inwardly extending tabs **220, 1061** snap fit into slots **222, 1063** formed in the second cover member. In the embodiment shown in FIGS. **26, 27** and **30**, a tab member **1067** engages opening **1071** formed in a wall member **1069** that further defines a portion of the outer concave surface of the module housing. Alternatively, it should be understood that the first and second cover members can be joined with fasteners, adhesive and the like.

As best shown in FIGS. **7, 15, 32** and **48**, when the cover members are assembled to form the module housing, the upper portion **74, 574, 674** of the post member extends through the opening in the upper flange of the first cover member and engages the top surface **108** of the container, which is inverted in the housing. Alternatively, the actuator member can be attached to the hub of the container with the locking ring as previously described. In such an embodiment, the arm member of the actuator member extends downwardly from the ring through the opening in the top of the first cover member and is positioned to selectively engage the ratchet gear. The insertion of the arm in the opening prevents the canister and attached locking ring from being rotated so as to move the arm member out of position for selective engagement with the ratchet gear.

As best shown in FIGS. **9** and **25**, the lower portion **78, 578** of the post member is moveably received within the socket **148, 1048** formed in the post member **146, 1040** extending from the base of the second cover member. Alternatively, the lower portion **678** is received in the opening **1148** as shown in FIG. **39**. Referring to FIGS. **9, 25** and **39**, spring **88, 588, 688** is disposed about the lower portion **78, 578, 678**, and in certain embodiments includes a lower end mounted on the post member **146, 1046**. The upper end of the spring engages the lower stop surface **86, 586, 686** of the post member **72, 572, 672**. The spring biases the post member upwardly within the housing such that the upper portion **74, 574, 674** protrudes through the opening and into engagement with the top surface of the container **108**.

In one embodiment, shown in FIGS. **8** and **9**, the worm **40** and ratchet gear **32** are rotatably supported on the bearing seats **144** formed in the second member. Preferably, opposite ends of axle **42** are snap fitted into the bearing seats. The indicator member **50** is rotatably supported by the second cover member such that the worm gear engages the worm when the cover members are joined together. In particular, the second cover includes a pair of downwardly opening lug members **164, 166**. The axle **56** of the indicator member is received in the first lug member **164** and a hub portion **59** positioned between the worm gear and the indicator wheel is received within the second lug member **166**. Preferably, the axle and hub are snap fitted into the lugs, but are permitted to freely rotate therein. When the cover members are joined, the indicator member, and in particular the worm gear, are trapped between the lug members and the worm.

In an alternative embodiment shown in FIGS. **25–27** and **30**, the axle **556** is supported on opposite ends by the lug portion **1044** extending from each of an upper and lower cover members **1036, 1038**. The axle **556** has a T-shaped cross-section formed as a result of a molding process, e.g., when the axle is integrally formed or molded with one or more of the module housing cover members. The shape of the axle also permits it to act as a key member when received in similarly shaped sockets formed in one or more of the lug portions. The axle extends outwardly from the lug portion.

18

The axle includes opposite curved surfaces **555, 557**, as best shown in FIGS. **35–38** that provide a supporting surface for the indicator members that are rotatably mounted thereon. One of skill in the art should understand that the axle could have a circular cross-section and could be rotatably mounted to the housing. In such an embodiment, at least one of the indicator members can be integrally formed with the axle, or all of the member can be separately mounted thereon.

It should be understood that in the alternative embodiment of FIGS. **2–5**, the supporting structure for the worm and ratchet, including the bearing seats or like supports, and the supporting structure for the indicator member, including the lug members, are similar to the structure provided in the module housing, but are integrally molded into the housing. Similarly, a post and socket member can be integrally molded into the bottom of the dispenser housing so as to support the actuator member and spring.

Similarly, although the indicator assembly embodiments of FIGS. **25** and **39** are shown as preferably being mounted in the indicator module, one of skill in the art should understand that the assembly, including the axle, indicator members, actuator member and spring could be mounted directly in the dispenser housing or actuator boot that supports the container. Similarly, the engagement member, or members, and non-return member, or members, could be formed in the dispenser housing that supports the container, otherwise referred to as the actuator boot.

In an alternative embodiment shown in FIG. **19**, a lower portion **172** of the outer vertical wall of the module housing is angled so as to mate with a housing having a similar angled planar bottom surface. As shown in FIG. **19**, the axis of rotation of the indicator member is oriented at an angle of approximately 45 degrees from the longitudinal axis so that the face of the indicator wheel **60** is substantially parallel to the angled surface of the housing. A viewing window is provided in the angled surface **172** and is aligned with a similar viewing window provided in the angled wall of the dispenser housing.

Now referring to FIGS. **21–23**, a key member **300** is shown as including a base portion **302** having a recess **304** shaped to receive the top of the container. The base portion is circular shaped and is open in the middle. The key member is mounted on the container by press fitting a circumferential flange **306**, which forms the recess, about the container such that the valve stem and hub passes through an opening **308** formed in the middle of the key member. Alternatively, the key member can be mounted to the container with adhesive or other fasteners. The key member also includes a key portion **310** extending downwardly from the base portion. The key portion is preferably configured as a circular flange member, although other shapes would also work.

In alternative embodiments shown in FIGS. **25** and **32–33**, the key member **1300** includes a mounting portion **1302**, configured as a hoop member having a plurality of ribbed portions **1304**. The mounting member **1302** is sized to fit over the end of the container such that the ribbed portions grip a portion of the container. A plurality of arm members **1306** secure a key portion **1308** to the mounting member.

In another alternative embodiment shown in FIG. **34**, the mounting member **1402** has a smaller diameter than the key portion, and is coaxially disposed with the key portion. A base member **1404** connects the mounting member and key portion. The mounting member includes a plurality of inwardly facing tab members **1410** that engage an outer tapered surface of the hub portion **106** of the container.

19

In the embodiments shown in FIGS. 25 and 34, the key portion 1308, 1408 is formed as a circular flange member having a plurality of openings 1312, 1412 formed therein about the circumference thereof so as to allow air to flow through the key member with less restriction. In the embodiment shown in FIGS. 32 and 33, the key portion 1508 includes two coaxially mounted key portions of different diameters, each with a plurality of openings 1512 to facilitate air flow therethrough.

The embodiment of the indicator module shown in FIG. 21 has a key entry passageway configured as a recess 312 formed in an upper surface of the module housing. Preferably, in this embodiment, the recess is formed as an arcuate shaped, or semi-circular, slot. The actuator member 314 extends upwardly from the module housing into the slot. The actuator member 314 is maintained substantially flush with or below the upper surface of the module 316. In this way, the actuator cannot be actuated by a user's finger or the like so as to inadvertently advance the indicator member and thereby provide an inaccurate reading of the number of dosages remaining in the container, or the number dispensed therefrom.

The shape or diameter of the key portion and corresponding entry passageway are configured so that the key portion communicates with and is received in the passageway formed in the module housing. When the container is mounted in the dispenser housing such that the valve stem is received in the well in the support block, the key portion is received in the passageway and engages the actuator member.

In an alternative embodiment of the dispensing device, with or without an indicator module or indicator assembly, a key entry passageway can be formed directly in the dispenser housing, e.g., in a bottom portion of the dispenser housing, wherein it receives a key portion disposed on the container. It should be understood that the term "housing," as used herein, can refer to the dispenser housing, the indicator module housing, or a combination of those housings.

In yet another alternative embodiment, the key portion and key entry passageway are reversed. In this embodiment, the key portion is formed on the housing, i.e., the indicator module housing, or the dispenser housing if the dispensing device lacks an indicator module and/or an indicator assembly, and the key entry passageway is formed in the container. For example, the module housing, or dispenser housing, can include a ring member that is received in a ring-shaped recess formed in the hub of the container. Or, the dispenser housing or module housing can be configured to include one or more protuberances that are received in one or more recesses formed in the container.

In this way, key members having differently shaped key portions can be applied to containers holding different types of substances, such as a medicament, so as to prevent the user from mixing up the containers and dispensers. In operation, a container having a certain key member with a specific key portion can be installed only in a dispenser housing having a passageway shaped to receive that key portion. If the key portion does not fit the recess, the key ring will engage the upper surface of the module housing so as to prevent the actuation of the container relative to the dispenser housing and the attendant opening of the valve. This in turn prevents a user from installing containers having different substances in different dispensers, which could thereby adversely affect the counting of doses dispensed from the container, or the counting of the number of doses

20

remaining therein. For example, a key member having a key portion with a thickness of 1 mm and an inner diameter of 13 mm is prevented from being installed in a passageway having a width of 1 mm and an inner diameter of 15 mm, and vice versa.

It should be understood that the mating key member and key entry passageway can also be used with various delivery systems that do not include an indicating device, as explained above. Often, delivery systems can be configured to deliver a specific type of substance. Because a differently configured delivery system may not maximize the delivery of the intended substance, such as a medicament, it may be important to ensure that a specific delivery system is used with a particular substance. In this way, a mating key member and key entry passageway can be mounted on one or the other of the container and housing, or similar structure, of the delivery system so as to ensure that the proper container is installed in the proper delivery system.

In the alternative embodiment of FIG. 25, the module housing includes three pairs of upstanding members 1080, 1082 forming a slot or recess 1084 between each pair. In addition, the upstanding members of one pair 1082 are formed as channels opening towards each other. The elongated recess 1056 formed between the pair of members is shaped to receive the upper portion of the actuator member 574. In operation, the key portion 1308 of the key member is shaped to be received in the various radially formed slots or recesses, or key entry passageways, so as to engage the actuator member disposed in the elongated recess. When the container is moved with respect to the module housing so as to move the valve to the open position, the hub of the container nests in a recess formed between the inner upstanding member of each pair.

In the embodiment shown in FIGS. 32 and 33, three sets of three upstanding members 1180, 1182 are provided, with each set of three having two slots 1184 formed between the members so as to be shaped to receive the two key portions 1508 of the key member 1500. Again, one set of three members 1182 forms an elongated passageway, or recess 1056, that is shaped to receive the actuator member. The two key portion configuration allows for multiple combinations of shapes and diameters of key portions so as to provide for a different key combination for each of the multiplicity of substances being dispensed from the various containers.

Although the circular configurations of the key portion and corresponding slots shaped to receive the key portion, as shown in the figures, are preferred since they allow the container to be rotated within the dispenser housing about its longitudinal axis, it should be understood that the key portion and slot, or like passageway or keyhole, can be shaped in any type of mating configuration and that the mating shapes are not limited to the circular configuration shown in the figures.

The indicator module provides an inexpensive and accurate device for counting dosages of medicament and the like. The module can be sized for easy installation as a separate unit in most conventional inhalation housings with minimal modification of the housing, including providing a viewing window in the housing in alignment with the module viewing window and the removal of any structure formed between the support block and outer wall of the housing. In addition, the module can be installed rearwardly of the support block so as not to interfere with or otherwise impede the air flow dispensing the medicament.

Although the present invention has been described with reference to preferred embodiments, those skilled in the art

will recognize that changes may be made in form and detail without departing from the spirit and scope of the invention. As such, it is intended that the foregoing detailed description be regarded as illustrative rather than limiting and that it is the appended claims, including all equivalents thereof, which are intended to define the scope of the invention.

What is claimed is:

1. An indicating device for a dispenser that dispenses metered dosages of a substance from a container having a valve moveable between a closed position and an open position, said container dispensing said metered dosage when said valve is moved to the open position, said indicating device comprising:

a housing comprising at least one engagement member; a plurality of indicator members coaxially mounted in said housing and comprising at least a first and second indicator member, at least one of said first and second indicator members having dosage indicia, at least one of said first and second indicator members comprising an advancement member and at least the other of said first and second indicator members comprising a plurality of teeth, wherein said engagement member is selectively engaged with said advancement member, wherein said engagement member biases said advancement member into operable engagement with at least one of said plurality of teeth of said at least the other of said first and second indicator members as said first indicator member is rotated relative to said second indicator member, whereby said advancement member causes said second indicator member to rotate an incremental amount.

2. The invention of claim 1 further comprising an actuator member mounted in said housing and responsive to said movement of said valve, and wherein said first indicator member comprises a plurality of teeth, said actuator member adapted to selectively engage at least one of said plurality of teeth on said first indicator member so as to advance said first indicator member an incremental amount in response to said movement of said valve.

3. The invention of claim 2 further comprising a spring disposed in said housing and adapted to bias said actuator member into engagement with said container.

4. The invention of claim 1 further comprising a third indicator member coaxially mounted in said housing with said first and second indicator members, wherein at least one of said second and third indicator members comprises a second advancement member and at least the other of said second and third indicator members comprises a plurality of teeth, and said housing further comprising at least a second engagement member, wherein said second engagement member is selectively engaged with said second advancement member, wherein said second engagement member biases said second advancement member into operable engagement with at least one of said plurality of teeth of said at least said other of said second and third indicator members as said second indicator member is rotated relative to said third indicator member, whereby said advancement member causes said third indicator member to rotate an incremental amount.

5. The invention of claim 1 wherein said housing further comprises at least one non-return member selectively engaged with at least one of said plurality of said teeth of at least one of said plurality of indicator members.

6. The invention of claim 5 wherein said engagement member and said non-return member are integrally formed as a single member.

7. The invention of claim 1 wherein said engagement member comprises a ramped surface.

8. The invention of claim 1 wherein said engagement member comprises a resilient arm member extending from said housing.

9. The invention of claim 1 wherein said housing comprises a first housing disposed in a second housing, wherein said plurality of indicator members are mounted in said first housing and wherein said second housing is adapted to support said container.

10. The invention of claim 1 wherein said housing comprises a dispenser housing adapted to support said container.

11. The invention of claim 1 wherein said housing comprises a viewing window, said indicia exposed to the user in said viewing window.

12. The invention of claim 1 wherein at least one of said indicator members comprises an indicator wheel having a circumferential surface, said dosage indicia applied to said circumferential surface.

13. The invention of claim 12 wherein said at least one of said plurality of indicator members further comprises a ratchet gear coaxially mounted with said indicator wheel and attached thereto, said ratchet gear comprising said plurality of teeth.

14. The invention of claim 1 wherein at least one of said indicator members comprises an indicator wheel having a circumferential skirt.

15. The invention of claim 14 wherein said advancement member is formed from a portion of said circumferential skirt.

16. The invention of claim 14 wherein said advancement member is disposed radially inward from said circumferential skirt.

17. The invention of claim 1 wherein said advancement member includes a tooth portion adapted to engage said at least one of said plurality of teeth of said adjacent indicator member.

18. The invention of claim 1 further comprising a key member having a key portion, said key member adapted to be mounted to said container, and wherein said housing comprises a passageway shaped to receive said key portion.

19. An indicator module adapted to be received within a dispenser housing, said indicator module comprising:

a module housing dimensioned to be received within said dispenser housing; and

a plurality of indicator members rotatably and coaxially mounted in said module housing, each of said indicator members comprising dosage indicia.

20. The invention of claim 19 further comprising an actuator member adapted to engage a container having a valve moveable between a closed position and an open position, said container dispensing a metered dosage of medicament when said valve is moved to the open position, said actuator member moveable within said module housing and selectively engaged with at least one of said indicator members to move said at least one indicator member in response to the movement of said valve.

21. The invention of claim 20 further comprising a spring disposed within said module housing and engaging said actuator member so as to bias said actuator member upwardly within said module housing.

22. The invention of claim 19 wherein said module housing comprises a first and second member joined to form an enclosure.

23. The invention of claim 19 further comprising a viewing window formed in said module housing.

24. The invention of claim 19 wherein said module housing has a key entry passageway formed therein, and further comprising a key member having a key portion, wherein said key portion is received in said key entry passageway.

23

25. The invention of claim 19 wherein said plurality of indicator members comprises at least a first and second indicator member, wherein at least one of said first and second indicator members comprises an advancement member and at least the other of said first and second indicator members comprises a plurality of teeth, and wherein said module housing comprises an engagement member, wherein said engagement member is selectively engaged with and biases said advancement member into operable engagement with at least one of said plurality of teeth of said other of said first and second indicator member as said first indicator member is rotated relative to said second indicator member.

26. The invention of claim 25 further comprising a third indicator member coaxially mounted in said module housing with said first and second indicator members, wherein at least one of said second and third indicator members comprises an advancement member and at least the other of said second and third indicator members comprises a plurality of teeth, and said module housing further comprising at least a second engagement member, wherein said second engagement member is selectively engaged with and biases said advancement member of said at least one of said second and third indicator members into operable engagement with at least one of said plurality of teeth of said other of said second and third indicator members as said second indicator member is rotated relative to said third indicator member, whereby said advancement member causes said third indicator member to rotate an incremental amount.

27. The invention of claim 25 wherein said module housing further comprises at least one non-return member selectively engaged with at least one of said plurality of teeth of said at least said other of said plurality of indicator members.

28. The invention of claim 27 wherein said engagement member and said non-return member are integrally formed as a single member.

29. The invention of claim 25 wherein said engagement member comprises a ramped surface.

30. The invention of claim 25 wherein said engagement member comprises a resilient arm member extending from said module housing.

31. The invention of claim 25 wherein at least one of said indicator members comprises an indicator wheel having a circumferential skirt, wherein said advancement member is formed from a portion of said circumferential skirt.

32. The invention of claim 31 wherein said advancement member is disposed radially inward from said circumferential skirt.

33. An indicating device for a dispenser that dispenses metered dosages of a medicament from a container having a valve moveable between a closed position and an open position, said container dispensing said metered dosage when said valve is moved to the open position, said indicating device comprising:

a housing;

a plurality of indicator members coaxially mounted in said housing and comprising at least a first and second indicator member; and

means for advancing said second indicator member relative to said first indicator member.

34. The invention of claim 33 wherein said housing is adapted to moveably support said container, and further comprising means for advancing said first indicator member in response to the movement of said container relative to said housing.

35. The invention of claim 33 wherein said means for advancing is disposed in an indicator module, said indicator module disposed in said housing.

24

36. An indicating device for a dispensing device that dispenses metered dosages of a medicament from a container having a valve stem extending longitudinally therefrom and moveable between a closed position and an open position, said container dispensing said metered dosage when said valve stem is moved to the open position, said indicating device comprising:

a housing adapted to move relative to said container as said container is moved between said open and closed positions;

a plurality of indicator members coaxially and rotatably mounted in said housing, each of said indicator members comprising indicia applied to a circumferential surface thereof and visible to the user, said plurality of indicator members selectively and operably connected such that successive movements of said container relative to said housing causes at least one of said indicator members to rotate, whereby said indicia visible to the user is changed to indicate the dispensing of at least one metered dosage.

37. The invention of claim 36 wherein said housing comprises a module housing disposed in a dispenser housing, said dispenser housing adapted to moveably support the container.

38. The invention of claim 36 wherein said housing comprises a dispenser housing adapted to support the container.

39. The invention of claim 36 wherein said plurality of indicator members comprises at least a first and second indicator member, said first indicator member selectively and operably engaged with said second indicator member upon successive rotations of said first indicator member so as to rotate said second indicator member an incremental amount for each successive rotation of said first indicator member.

40. The invention of claim 39 further comprising an actuator member operably engaged with said container, wherein said actuator member rotates said first indicator member an incremental amount in response to said movement of said container relative to said housing.

41. A dispenser for dispensing metered dosages of a substance from a container having a valve moveable between a closed position and an open position, said container dispensing said metered dosage when said valve is moved to the open position, said dispenser comprising:

a dispenser housing shaped to receive the container;

an indicator housing disposed in said dispenser housing, said indicator housing comprising at least one engagement member;

a plurality of indicator members coaxially mounted in said indicator housing and comprising at least a first and second indicator member, said first and second indicator members comprising dosage indicia, said first indicator member comprising an advancement member and said second indicator member comprising a plurality of teeth, said engagement member intermittently engaged with said advancement member, wherein said engagement member biases said advancement member into operable engagement with at least one of said plurality of teeth on said second indicator member as said first indicator member is rotated relative to said second indicator member.

42. The invention of claim 41 wherein said first indicator member comprises a plurality of teeth and further comprising an actuator member moveably mounted to said indicator housing, said actuator member selectively engaged with at least one of said plurality of teeth on said first indicator member.

25

43. The invention of claim 41 wherein said plurality of indicator members further comprises a third indicator member coaxially mounted with said first and second indicator members in said indicator housing, said third indicator member comprising a plurality of teeth, and wherein said second indicator member comprises a second advancement member, and wherein said indicator housing further comprises a second engagement member, said second engagement member intermittently engaged with said second advancement member, wherein said second engagement member biases said second advancement member into operable engagement with at least one of said plurality of teeth on said third indicator member as said second indicator member is rotated relative to said third indicator member.

44. The invention of claim 41 wherein said first and second indicator members comprise indicator wheels, and wherein said advancement member comprises a curved resilient portion terminating in an end portion, wherein said end portion operably engages at least one of said plurality of teeth on said second indicator wheel.

45. The invention of claim 41 wherein said engagement member comprises a ramped surface.

46. The invention of claim 41 wherein said engagement member comprises a resilient member extending from said indicator housing.

47. The invention of claim 41 wherein said engagement member further defines a non-return member selectively engaged with at least one of said plurality of teeth of said second indicator member.

48. The invention of claim 41 wherein said dispenser housing has a cavity and comprises a top portion having an opening dimensioned to receive said container and a bottom portion comprising an exhaust port, wherein said opening provides access to said cavity, and wherein said indicator housing is disposed in said cavity in said bottom portion of said dispenser housing.

49. The invention of claim 48 wherein said bottom portion further comprises a support block extending upwardly into said cavity, wherein said support block comprises an orifice in flow communication with said exhaust port, wherein said module housing is disposed in said cavity adjacent said support block without blocking said orifice.

50. A dispenser for dispensing metered dosages of a substance from a container having a valve moveable between a closed position and an open position, said container dispensing said metered dosage when said valve is moved to the open position, said dispenser comprising:

a dispenser housing comprising a bottom, a top, a wall defining a longitudinally extending cavity open at said top, and a support block extending from said bottom into said cavity, wherein said support block is spaced from said wall;

an indicator housing at least a portion of which is disposed in said cavity between said support block and said wall; and

26

a plurality of indicator members coaxially mounted in said indicator housing and comprising at least a first and second indicator member, said first and second indicator members comprising dosage indicia.

51. The invention of claim 50 wherein said indicator housing comprises at least one engagement member and wherein said first indicator member comprises an advancement member and said second indicator member comprises a plurality of teeth, said engagement member intermittently engaged with said advancement member, wherein said engagement member biases said advancement member into operable engagement with at least one of said plurality of teeth on said second indicator member as said first indicator member is rotated relative to said second indicator member.

52. The invention of claim 51 wherein said first indicator member comprises a plurality of teeth and further comprising an actuator member moveably mounted to said indicator housing, said actuator member selectively engaged with at least one of said plurality of teeth on said first indicator member.

53. The invention of claim 51 wherein said plurality of indicator members further comprises a third indicator member coaxially mounted with said first and second indicator members in said indicator housing, said third indicator member comprising a plurality of teeth, and wherein said second indicator member comprises a second advancement member, and wherein said indicator housing further comprises a second engagement member, said second engagement member intermittently engaged with said second advancement member, wherein said second engagement member biases said second advancement member into operable engagement with at least one of said plurality of teeth on said third indicator member as said second indicator member is rotated relative to said third indicator member.

54. The invention of claim 51 wherein said first and second indicator members comprise indicator wheels, and wherein said advancement member comprises a curved resilient portion terminating in an end portion, wherein said end portion operably engages at least one of said plurality of teeth on said second indicator wheel.

55. The invention of claim 51 wherein said engagement member comprises a ramped surface.

56. The invention of claim 51 wherein said engagement member comprises a resilient member extending from said indicator housing.

57. The invention of claim 51 wherein said engagement member further defines a non-return member selectively engaged with at least one of said plurality of teeth of said second indicator member.

58. The invention of claim 50 wherein said module housing comprises a first and second member connected to form an enclosure.

* * * * *