



US006929226B1

(12) **United States Patent**
Philistine

(10) **Patent No.:** **US 6,929,226 B1**

(45) **Date of Patent:** **Aug. 16, 2005**

(54) **TWIST LOCK MOUNTING SYSTEM**

(75) **Inventor:** **John J. Philistine**, Rising Sun, MD
(US)

(73) **Assignee:** **The United States of America as
represented by the Secretary of the
Army**, Washington, DC (US)

(*) **Notice:** Subject to any disclaimer, the term of this
patent is extended or adjusted under 35
U.S.C. 154(b) by 0 days.

(21) **Appl. No.:** **10/638,736**

(22) **Filed:** **Aug. 11, 2003**

(51) **Int. Cl.⁷** **F21V 35/00**

(52) **U.S. Cl.** **248/222.52; 248/222.12;**
248/224.61

(58) **Field of Search** 248/222.52, 222.51,
248/317, 323, 223.41, 223.51, 223.61, 222.12;
403/387, 329, 326, 348

(56) **References Cited**

U.S. PATENT DOCUMENTS

362,767 A * 5/1887 McNair 403/350
1,810,229 A * 6/1931 Stirrup 248/222.52
2,859,710 A * 11/1958 Elsner 248/502
2,931,471 A * 4/1960 Howard, Jr. 403/22
3,461,637 A * 8/1969 Jansson 52/716.6
3,722,910 A * 3/1973 Heckenlaible 410/107

4,222,508 A * 9/1980 Bott 224/324
4,342,139 A * 8/1982 Tanaka 24/292
4,436,269 A * 3/1984 Dirksing et al. 248/214
4,787,767 A * 11/1988 Wendt 403/187
4,840,525 A * 6/1989 Rebentisch 411/85
4,903,934 A * 2/1990 Fremstad 248/551
5,199,836 A * 4/1993 Gogarty 411/84
5,628,598 A * 5/1997 Hofle 411/85
5,836,035 A * 11/1998 McElfish et al. 15/160
6,511,028 B1 * 1/2003 Gretz 248/222.52

* cited by examiner

Primary Examiner—Korie Chan

(74) *Attorney, Agent, or Firm*—Ulysses John Biffoni

(57) **ABSTRACT**

A twist lock mount for quick mounting and positioning a device to a support includes a mount receiving member attachable to or integral with the support and a mounting member attachable to or integral with a device to be mounted. The receiving member provides a channel covered by flanges that further define a narrower channel or slot. The mounting member is configured to slide into the channel when it is in one rotational orientation and to lock securely into place when it is in another. A rotation in the opposite direction will unlock the device so that the mount can be slid out of the channel quickly and easily. The twist lock mount simply and effectively prevents movement in the longitudinal, transverse and axial directions and is well suited for use in harsh, high vibration environments.

39 Claims, 2 Drawing Sheets

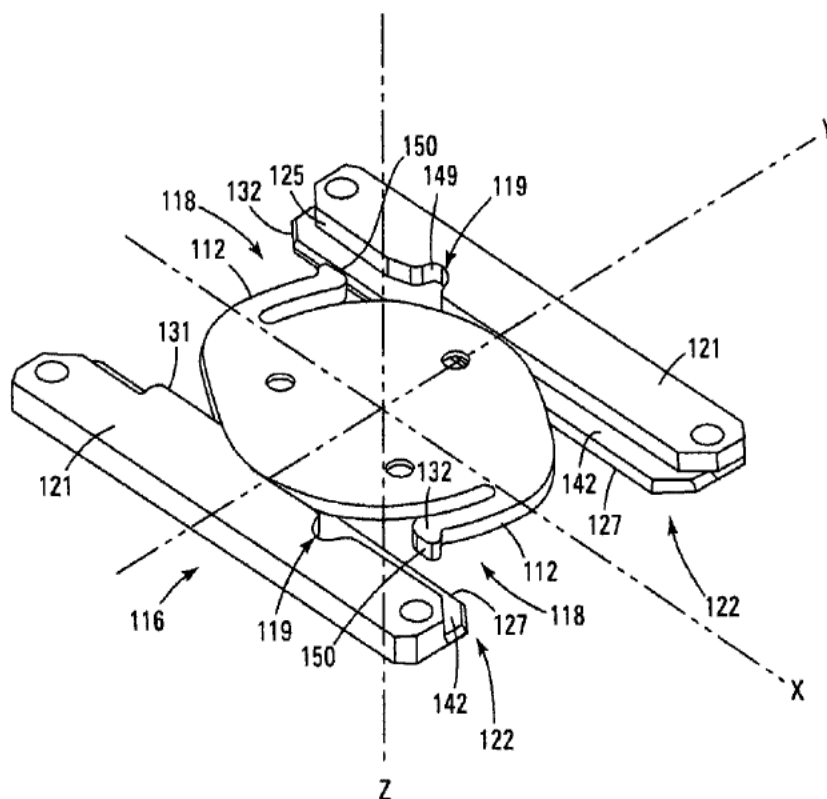

DJI-1026

IPR2019-00846

U.S. Patent No. 9,260,184

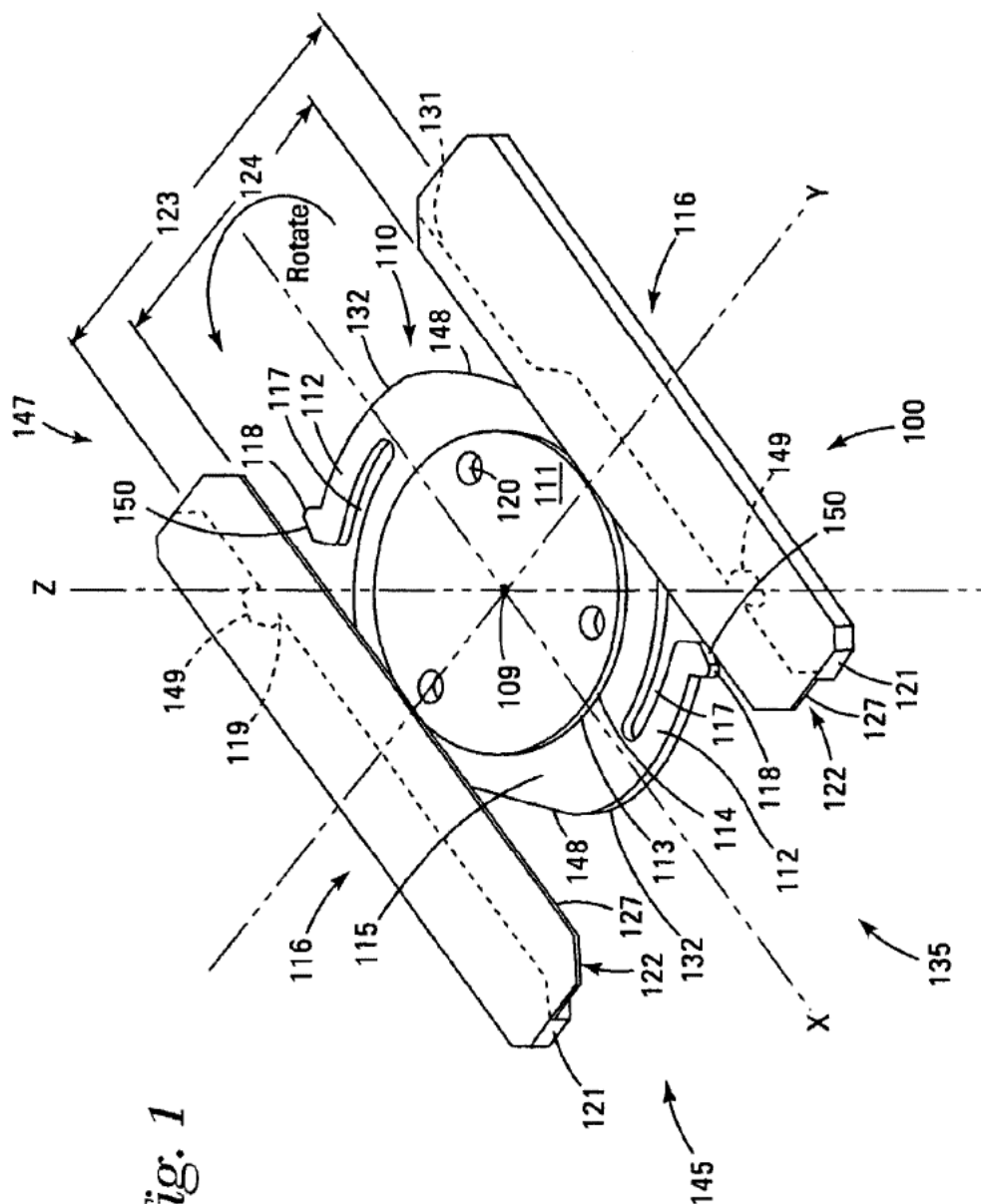

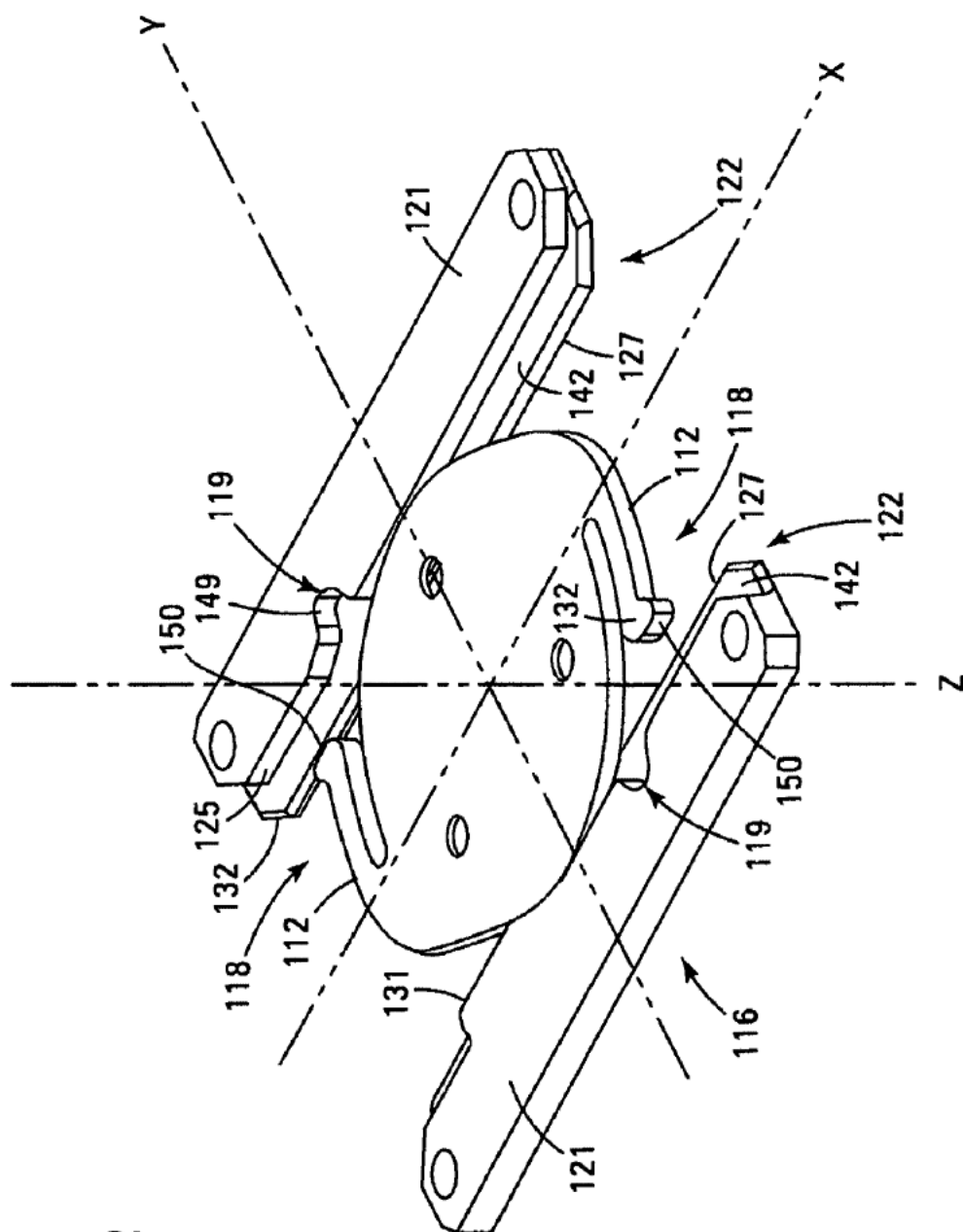

Fig. 2

1

TWIST LOCK MOUNTING SYSTEM

GOVERNMENT INTEREST

The invention described herein may be manufactured, 5
licensed, and used by or for the U.S. Government.

TECHNICAL FIELD

The present invention relates generally to a mounting 10
system and more specifically to a twist lock mounting
system for rapid and secure attachment and detachment of a
variety of devices to various surfaces.

BACKGROUND

The present invention was developed to address the
problem of mounting and dismounting of the M48 Light-
weight Motor Blower (LWMB) to the airframe of the
AH-64A Apache helicopter. The LWMB is part of the M48 20
Chemical-Biological Aircraft Mask system and provides
filtered, breathable air to aircraft personnel. The LWMB
must be securely mounted to the aircraft during flight
operations and must be quickly and easily removable when
aircraft personnel depart the aircraft. The mounting mecha- 25
nism for the LWMB must be easy to operate and also be
capable of performing in harsh environments where extreme
vibration and shock loading is expected.

SUMMARY

In general, in one aspect, a twist lock mount for mounting
and positioning a device to a support includes a mount
receiving member and a mounting member. The mount
receiving member includes parallel guide rails having
opposing inner guide surfaces that define a channel therebe- 35
tween, a pair of flanges projecting transversely from the
guide rails over the channel and having edges that define a
narrowed channel opening, a means for locking a mounting
member, and a positioning stop to provide longitudinal
positioning for the mounting member in the channel. In 40
accordance with another aspect, the mounting member
includes a hub having a rim adapted to slidably engage the
mount receiving member flanges, and a lip extending radi-
ally outwardly from the hub, the lip including opposing
peripheral edges dimensioned to slidably engage the oppos- 45
ing inner guide surfaces of the mount receiving member
when the mounting member is in a first rotational orientation
and further including a complementary locking mechanism
to engaging the locking mechanism when the mounting 50
member is positioned against the positioning stop and
rotated to a second rotational orientation.

In general, in another aspect, the locking mechanism
includes one or more recesses in the walls of the channel and
the complementary locking mechanism includes one or 55
more protrusions from a peripheral edge of the lip of the
mounting member. In accordance with another aspect the
protrusions include springably mounted lugs positioned on
the lip of the mounting member. In general, in another
aspect, the recesses include pockets with one or more 60
chamfered edges to mate with complementarily chamfered
edges of the lugs.

In another aspect, the springably mounted lug is formed
integrally with the lip and is comprised of a flexible plastic
material. In yet another aspect, the mounting member is 65
manufactured of a flexible plastic material in a single shot
injection molding process.

2

In another aspect, a twist lock mount for mounting a
device to a support includes a mount receiving member
having a T-slot channel with an open end and a means for
locking a mounting member in the channel. In another
aspect, the mounting member is adapted to slide into the
open end of the T-slot channel when it is in a first rotational
orientation and includes a means for locking, adapted to be
engaged by the means for locking of the mount receiving
member when the mounting member is rotated in the
channel into a second rotational orientation.

BRIEF DESCRIPTION OF THE DRAWINGS

FIG. 1 is a perspective view from the top of one embodi-
ment of a quick release mount; and 15

FIG. 2 is a perspective view from the bottom of one
embodiment of a quick release mount.

DETAILED DESCRIPTION

In the following detailed description of the preferred
embodiments, reference is made to the accompanying draw-
ings that form a part hereof, and in which are shown by way
of illustration specific embodiments in which the invention,
as claimed, may be practiced. This invention may, however,
be embodied in many different forms and should not be
construed as limited to the embodiments set forth; rather,
these embodiments are provided so that this disclosure will
be thorough and complete, and will fully convey the scope
of the invention to those skilled in the art. As will be
appreciated by one of skill in the art, the present invention
may be embodied in methods and devices.

FIGS. 1 and 2 show perspective views from the top and
bottom, respectively, of an embodiment of a twist lock
mount **100** according to the present invention. The twist lock
mount **100** includes two basic components, a mounting
member **110** that is secured to or integrated with a device to
be mounted, and a receiving member **116** that is secured to
or integrated with a mounting surface or support. Receiving
member **116** provides a channel **123** for receiving and
engaging mounting member **110**. Mounting member **110** is
configured to slide into the channel **123** when it is in one
rotational orientation and to lock securely into place when it
is in another. To mount a device with the twist lock mount
100, the user needs only to orient the mounting member so
that it will slide into the channel and then to rotate the device
in the channel until it locks securely in place. A rotation in
the opposite direction will unlock the device so that the
mount can be slid out of the channel quickly and easily.

As shown in FIGS. 1 and 2, receiving member **116**
provides a channel **123** that is defined by a pair of opposing,
parallel guide rails **121**. Guide rails **121** extend longitudi-
nally (in the x direction) and provide inner guide surfaces
125 that make up the walls of channel **123**. Guide surfaces
125 extend axially (in the z direction) from the plane of the
mounting surface or support (not shown) to the inner sur-
faces **142** of a pair of flanges **122** which project transversely
over the channel **123** and prevent movement of the mounting
member **110** in the axial direction (z). Flanges **122** terminate
at parallel edges **127** which define a narrowed channel
opening or slot **124**. Thus channel **123** together with flanges
122 form a channel that is generally T-slot shaped.

Channel **123** has an open end **145** for receiving mounting
member **110** and a stop end **147** which is blocked or partially
blocked to prevent the passage of mounting member **110** and
which provides for precise longitudinal positioning of
mounting member **110** in the channel. In this example, a

3

positioning stop **131** projects transversely into the channel **123** from one of the guide surfaces **125** proximate to the stop end **147** of the channel **123**. As can be seen from FIGS. **1** and **2**, embodiments of twist lock mount **100** can provide a very low profile to facilitate surface mounting of devices in confined spaces.

The present invention locks the mounting member **110** in the receiving member **116** after it has been slid into the channel **123**. In general, a locking mechanism such as an elastic or spring biased protrusion seats into a recess or pocket when the mounting member **110** is rotated into a lock position. In the embodiment shown in FIGS. **1** and **2** receiving member **116** includes a pair of recesses **119** in guide surfaces **125**. In general, recesses **119** are cut to match the shape of protrusions such as lugs, teeth, or keys, positioned about the circumference of mounting member **110**. The protrusions are longitudinally staggered to be equidistant from the axis of rotation (z axis) of mounting member **110** when it is positioned against positioning stop **131**. To facilitate locking and unlocking chamfered mating surfaces **149** of recesses **119** may be provided.

Mounting member **110** has two basic aspects, a low profile disc shaped hub **111** centered on an axis **109** (z axis), and an eccentric or oblong lip **115** extending radially outwardly from the hub **111**. The circumference of hub **111** is bounded by a rim **113**, which fits complementarily into the narrowed channel opening **124** of receiving member **116** and slidably engages edges **127** of flanges **122** as the mounting member **110** is inserted into the channel **123**. In this embodiment, hub **111** includes three mounting holes **120** for inserting screws, bolts or rivets to secure the device to be mounted. Other embodiments may use other attachment means such as an adhesive to secure the device to be mounted to mounting member **110**.

The eccentric lip **115** of mounting member **110** is defined generally by a narrow axis and a wide axis. The narrow axis terminates at parallel peripheral edges **148** which slidably engage inner guide surfaces **125** of the receiving member **116** as the mounting member **110** is inserted into the channel **123**. A locking mechanism is positioned on either or both ends of the wide axis of the lip **115**. The locking mechanism includes a pair of protrusions **118** which are configured to complementarily seat in recesses **119** of the receiving member **116** when the mounting member **110** is positioned against the positioning stop **131** and rotated to a lock position. In this embodiment, protrusions **118** include nubs or lugs **150** positioned at the ends of elastically flexible arms **112**. Arms **112** curve circumferentially around the hub **111** and are offset from the lip **115** by gaps **117** to allow clearance for the arms **112** to flex inwardly as the protrusions **118** slidably engage the guide surfaces **125**. In this embodiment arms **112** curve around the hub **111** in the direction of rotation (counterclockwise with respect to FIG. **1**) so that protrusions **118** will seat in recesses **119** after approximately one-quarter turn. In other embodiments arms **112** may be positioned around the circumference of lip **115** to curve in a direction opposite to the direction of rotation. In addition, other rotational securing mechanisms may likewise be used in other embodiments of the present invention. For example, protrusions **118** may include one or more spring biased ball bearings or nubs, teeth, lugs, catches, and the like, positioned along the outer surfaces of lip **115** to positively engage recesses **119** when the mounting member is rotated in the channel **123** against the positioning stop **131**. In still other embodiments, lip **115** may provide one or more

4

recesses into which protrusions from guide surfaces **125** will seat after rotation of the mounting member to a lock position.

Operation of the twist lock mount **100** will now be described. To engage the twist lock mount **100**, mounting member **110**, which is attached to a device to be mounted, such as the LWMB, is inserted into the open end **145** of receiving member **116**, shown on the left side of FIG. **1**. The rotational position of mounting member **110** is aligned so that the narrow axis of lip **115** is in a direction transverse with respect to the channel **123**, with the arms **112** in a forward and aft positions of the mounting member **110**, so that opposing peripheral edges **148** can slide along guide surfaces **125** of the receiving member **112**. The lip **115** thus acts as a retainer and a guide as the mounting member **110** is inserted between the guide rails **121** of receiving member **116**. In this rotational orientation, mounting member **110** slides longitudinally into the channel **124** until it comes to rest against positioning stop **131**. Mounting member **110** is then rotated in a counterclockwise direction (with respect to FIG. **1**). As mounting member **100** is rotated, a user may observe a slight resistance as the protrusions **118** press against the inner guide surfaces **125** and the arms **112** flex radially inwardly. After approximately one-quarter turn, lugs **150** or other protrusions will be positioned over recesses **119**, and the elastic arms **112** will urge the lugs **150** into recesses **119** so that they are seated securely. At this point the mounting member **110** is locked into position and will resist further rotation in the counterclockwise direction. Additionally, the locked mounting member **110** will resist movement in the lateral, axial and transverse directions. The twist lock mount **100** may provide a positive indication to the user that it has locked into position such as by providing an audible or tactile snap or click. In environments such as the high vibration environment of a helicopter, it may be desirable to provide an electrical or optical signal to indicate the locked or unlocked status of the twist lock mount **100**.

A twisting force in the opposite direction (clockwise with respect to FIG. **1**) and rotation of about a quarter turn is all that is needed to unseat lugs **150** from recesses **119** and free the mounting member **110** so that it can slide out of the open end **145** of channel **123**. The amount of force to lock and unlock the mounting can be adjusted to suit the requirements of different applications. As will be appreciated, the twisting force required to operate twist lock mount **100** may be calibrated to provide for easy locking and unlocking in different operating environments while still ensuring that the mount will not spontaneously unlock. In some applications, it may be desirable to configure the twist lock mount **100** to lock permanently into position in one operation, such as by squaring the edges **149** of recesses **119** so that the lugs **150** will remain permanently seated.

Vibration can be a problem for sensitive equipment such as aircraft instruments and avionics. In another aspect of the present invention, twist lock mount **100** may advantageously provide vibration damping for devices to be mounted. For example, the mating surfaces of the twist lock mount **100** may be configured to dampen and dissipate vibrations at frequencies likely to be encountered in high vibration environments such as an aircraft, as would be readily understood to those of skill in the art.

It will be appreciated that embodiments of the present invention can be manufactured in a variety of ways, and from a wide variety of materials. In most embodiments the two principal components can be of an inexpensive, unitary, molded manufacture, utilizing a widely available plastic material such as nylon. Selection of the material for mount-

5

ing member 110 will depend on the material's ability to flex within its elastic limits. In applications where mechanical stresses and shock loading are a factor it is preferred that both the mounting member 110 and the receiving member 116 be manufactured of a flexible, tough grade impact modified nylon. The parts may be manufactured in a single shot injection molding or extrusion process. Other plastic molding techniques, such as, for example, casting and compression molding which are familiar to persons skilled in the art may also be employed. Where metal is chosen as the material of construction for one or more components of a twist lock mount according to the invention, those skilled in that art will recognize die casting as a preferred method of fabrication. Regardless of the method of manufacture, it is viewed as greatly preferable to produce components such as the mounting member 110, as unitary pieces in the various embodiments of the present invention. However, the elements of this invention may also be separately manufactured and assembled into a complete device by adhesives or by mechanical means, which will be readily apparent to those knowledgeable in the art of the material of fabrication.

The present invention thus provides a low profile and lightweight mounting configuration that is simple to manufacture, install and operate. The present invention may be scaled to accommodate various device and equipment sizes, thus facilitating adaptability in a wide variety of commercial, consumer and military applications.

CONCLUSION

As has been shown, embodiments of twist lock mounting systems according to the present invention provide simple, ergonomic, easily securable, quickly releasable, low profile, mounting mechanisms for a variety of equipment, components and devices in a number of different working environments. For example, embodiments of the twist lock mounting system can advantageously be deployed in harsh environments where extreme vibration and shock loading is expected. The ease of operation, simplicity of manufacture and scalability of the present invention will enable embodiments to be used in many other applications, particularly where there is a need for a mounting system that provides rapid and secure manual attachment and detachment of devices and components in confined spaces. In addition, embodiments of twist lock mounting systems precisely define the position of the mounted part relative to the holding part, lock the part securely into place and unlock the same with a simple twist of the wrist. While the invention is simple to fabricate and to assemble at the same time it provides a high degree of stability, uniformity, and durability.

A number of embodiments of the invention defined by the following claims have been described. Nevertheless, it will be understood that various modifications to the described embodiments may be made without departing from the spirit and scope of the claimed invention. For example, while some embodiments described above provide recesses in guide surfaces of the receiving member and protrusions on the mounting member for engaging the pockets, in other embodiments protrusions may be positioned on the guide surfaces of the receiving member and recesses for receiving the protrusions may be provided in the mounting member. Additionally, in some embodiments, simple weight reduction modifications may be made such as the removal of material in the mount receiving members and hub of the mounting member. In other embodiments, electrical contacts may be integrated into the mounting. For example, an

6

electrical, magnetic or optical contact, sensor, or switch may be integrated into the mounting to indicate when the device is in a locked or unlocked position.

Accordingly, other embodiments are within the scope of the invention, which is limited only by the following claims.

What is claimed is:

1. A twist-lock mount for mounting and positioning a device to a support, comprising:

a receiving member comprising parallel guide rails having opposing inner guide surfaces that define a channel therebetween, a pair of flanges projecting transversely from said guide rails over said channel and having edges that define a narrowed channel opening, a means for locking a mounting member, and a positioning stop to provide longitudinal positioning for said mounting member in said channel; and

wherein said mounting member comprises a hub having a rim adapted to slidably engage said edges of said receiving member flanges, a lip extending radially outwardly from said hub, said lip including opposing peripheral edges dimensioned to slidably engage said opposing inner guide surfaces of said receiving member when said hub is in a first rotational orientation, and further including a complementary locking mechanism to engage said locking means of said receiving member when said mounting member is positioned against said positioning stop and rotated to a second rotational orientation.

2. The twist-lock mount of claim 1, wherein said receiving member means for locking a mounting member comprises at least one recess in a wall of said parallel guide rails inner guide surfaces.

3. The twist-lock mount of claim 2, wherein said mounting member complementary locking mechanism comprises a protrusion from a peripheral edge of said lip to engage said recess.

4. The twist-lock mount of claim 2, wherein said recess includes a chamfered edge.

5. The twist-lock mount of claims 3, wherein said protrusion includes a chamfered edge.

6. The twist-lock mount of claim 3, wherein said protrusion is springably attached to said lip.

7. The twist-lock mount of claim 6, wherein said protrusion comprises a lug mounted on the end of an arm.

8. The twist-lock mount of claim 7, wherein a radial bias is placed on said arm as said mounting member is rotated from the first rotational orientation to the second rotational orientation.

9. The twist-lock mount of claim 7, wherein said mounting member is formed integrally of a flexible plastic material in an injection molding process.

10. The twist-lock mount of claim 1, wherein said mounting member is manufactured of a flexible plastic material in an injection molding process.

11. The twist-lock mount of claim 1, wherein said mounting member is adapted to be secured to a blower motor of a Chemical-Biological Aircraft Mask system and said receiving member is adapted to be secured to an aircraft.

12. The twist-lock mount of claim 7, wherein a rotation from the first rotational orientation in the direction of the second rotational orientation effects a bias on said arm that urges said lug into said recess when the second rotational orientation is reached.

13. The twist-lock mount of claim 1, further comprising an elastic arm formed integrally with the mounting member of a flexible plastic material.

14. The twist-lock mount of claim 1, further comprising said positioning stop comprising an inward projection from at least one of said parallel guide rails inner guide surfaces to engage said peripheral edges of said mounting member lip.

15. A twist-lock mount, comprising:

(a) a receiving member adapted to be secured to a mounting surface, the receiving member comprising:

- (i) a channel comprising a first pair of opposing longitudinal guide surfaces defining a first channel width and a second pair of opposing longitudinal guide surfaces positioned above the first pair of opposing longitudinal guide surfaces and defining a second channel width that is narrower than the first;
- (ii) a recess in at least one of said first pair of longitudinal guide surfaces; and
- (iii) a positioning stop comprising an inward projection from at least one of said first pair of opposing longitudinal guide surfaces; and

(b) a mounting member to be engaged by said receiving member and adapted to be secured to a device to be mounted, said mounting member comprising:

- (i) a hub comprising a rim adapted to slidably engage said second pair of opposing longitudinal guide surfaces;
- (ii) a lip extending radially from said hub, said lip including peripheral edges adapted to slidably engage said first pair of longitudinal guide surfaces in a first rotational orientation of said hub; and
- (iii) a locking mechanism adapted to be lockingly engaged in said recess of said receiving member when said hub is rotated into a second rotational orientation while positioned against said positioning stop.

16. The twist-lock mount of claim 15, wherein said locking mechanism comprises at least one lug at the end of an arm springably mounted to said lip and said recess comprises at least one lug pocket for receiving said lug.

17. The twist-lock mount of claim 16, wherein a spring or bias force is stored in said arm when said hub is rotated from the first rotational orientation in the direction of the second rotational orientation thus securing said lug in said recess.

18. The twist-lock mount of claim 17, wherein said stored spring or bias force is at least partially released when said hub is positioned in the second rotational orientation.

19. The twist-lock mount of claim 15, wherein said locking mechanism comprises a pair of springably mounted arms extending circumferentially around said lip and wherein a force is stored in said springably mounted arms when said hub is rotated from the first rotational orientation in the direction of the second rotational orientation.

20. The twist-lock mount of claim 15, wherein said mounting member is manufactured as a unitary component of a flexible plastic material.

21. The twist-lock mount of claim 15, wherein said mounting member is adapted to be secured to a light weight blower motor of a Chemical-Biological Aircraft Mask system and said receiving member is adapted to be secured to an aircraft.

22. The twist-lock mount of claim 15, wherein one or more components of said mount are adapted to provide vibration damping for devices to be mounted.

23. A twist-lock mount, comprising:

(a) a receiving member adapted to be secured to a mounting surface, said receiving member comprising:

- (i) an elongate channel comprising a first pair of opposing guide surfaces defining a first channel

width and a second pair of opposing guide surfaces defining a second channel width narrower than the first;

(ii) a recess in at least one of said first pair of opposing guide surfaces adapted to lockingly receiving a locking mechanism; and

(iii) a positioning stop comprising an inward projection from at least one of said first pair of opposing guide surfaces; and

(b) a mounting member for securing to a device to be mounted, adapted to be engaged by said receiving member, said mounting member, comprising:

(i) a hub comprising a rim adapted to slidably engage said second pair of opposing guide surfaces;

(ii) an oblong lip extending radially outwardly from said hub, said lip comprising perimeter edges adapted to slidably engage said first pair of opposing guide surfaces in a first rotational orientation of said hub; and

(iii) at least one locking mechanism adapted to lockingly engage in said recess in a second rotational orientation of said hub.

24. The twist-lock mount of claim 23, wherein said at least one locking mechanism comprises a springably mounted lug.

25. The twist-lock mount of claim 24, wherein said springably mounted lug is positioned at an end of an arm.

26. The twist-lock mount of claim 25, wherein said arm extends in a circumferential direction around said lip.

27. The twist-lock mount of claim 23, further comprising means to indicate when the mount is locked into position.

28. The twist-lock mount of claim 23, further comprising one or more electrical contacts.

29. The twist-lock mount of claim 28, wherein said electrical contacts are adapted to indicate when said twist lock mount is locked into position.

30. A mounting device, comprising:

a mount receiving member having a pair of parallel opposing guide rails defining an elongated opening and a pair of flanges projecting inwardly over the elongated opening and defining a pair of opposing flange edges, a pair of opposing recesses positioned in the guide rails; and

a mounting member having a hub that provides a first rim surface for engaging the opposing flange edges and a lip that extends radially outwardly from the hub providing opposing surfaces for engaging the guide rails in a first rotational orientation of the hub and providing a pair of springably mounted lugs extending outwardly from the lip and positioned to engage the recess in the guide rails when the hub is in a second rotational orientation.

31. The mounting device of claim 30, wherein the springably mounted lugs are positioned at the ends of opposingly mounting arms that curve circumferentially around the hub.

32. The mounting device of claim 31, wherein the opposing recesses are longitudinally staggered.

33. A twist-lock mount system, comprising:

means for receiving a mounting means, the receiving means adapted to be secured to a mounting surface and comprising:

first guide surface means defining a first channel opening and for slidably engaging the mounting means;

second guide surface means defining a second channel opening that is narrower than the first for slidably engaging the mounting means;

9

a recess in at least one of the guide surface means for lockingly engaging the mounting means; and mounting means to be engaged by the receiving means and adapted to be secured to a device to be mounted, the mounting means comprising:

hub means adapted to slidably engage the second guide surface means;

lip means extending outwardly from the hub means and comprising opposing guide surfaces and a locking means oriented approximately 90 degrees rotationally about the hub means from the opposing guide surfaces, the lip means adapted to slidably engage the first guide surface means in a first rotational orientation of the hub, and adapted to lockingly engage the locking means into the recess in a second rotational orientation of the hub.

34. The twist-lock mount system of claim **33**, further comprising a position stop means for determining the longitudinal orientation of the mounting means in the channel.

35. The twist-lock mount system of claim **33**, wherein the locking means comprises a spring.

36. The twist-lock mount system of claim **33**, wherein the locking means comprises a lug mounted at the end of an arm.

37. A method of securing a device, comprising:

providing an elongated channel having an open end and a stop end for receiving and securing a mounting member, the elongated channel comprising a pair of first opposing guide surfaces defining longitudinal channel walls, a pair of second opposing guide surfaces defining a narrowed channel opening, a recess in at least one of the guide surface for lockingly engaging a locking means on the mounting member, and a positioning stop for longitudinally positioning the mounting member in the channel;

providing a mounting member having a hub adapted to slidably engage the second opposing guide surfaces and an lip extending outwardly from the hub, the lip adapted to slidably engage the first guide surfaces in a

10

first rotational orientation of the hub and to lockingly engage the recess in at least one of the guide surfaces in a second rotational orientation of the hub; positioning the mount so that the hub is in the first rotational orientation;

sliding the mount longitudinally into the open end of the channel until it rests against the positioning stop; and rotating the mount into the second rotational orientation of the hub to lock the mount into the channel.

38. A twist-lock mount for mounting and dismounting of a light weight blower motor of a Chemical-Biological Aircraft Mask system to an aircraft, comprising a mounting member and a mount receiving member, the mount receiving member comprising:

parallel opposing guide rails defining an elongated channel, a pair of flanges projecting inwardly over the elongated channel, a pair of chamfered lug pockets recessed in the guide rails and adapted to engage complementary lugs on the mounting member, and a positioning stop to longitudinally position the mounting member in the channel; and,

the mounting member comprising:

a hub having a rim adapted to slidably engage the flanges, and an oblong lip extending outwardly from the hub, the lip including opposing peripheral edges for slidably engaging the guide rails when the hub is in a first rotational orientation and a pair of lugs mounted on the free ends of elastic arms extending circumferentially from the lip, the lugs adapted to complementarily seat in the lug pockets when the hub is in a second rotational orientation and positioned against the positioning stop.

39. The twist-lock mount of claim **38**, wherein the mounting member is comprised of a flexible plastic material of unitary construction and manufactured in a single shot injection molding process.

* * * * *