



US005209051A

United States Patent [19][11] **Patent Number:** **5,209,051****Langdon**[45] **Date of Patent:** **May 11, 1993**[54] **LAWN MOWERS INCLUDING PUSH HANDLES**[76] **Inventor:** **Christopher D. Langdon**, P.O. Box 904, Tryon, N.C. 28782[21] **Appl. No.:** **872,065**[22] **Filed:** **Apr. 22, 1992****Related U.S. Application Data**

[63] Continuation-in-part of Ser. No. 666,573, Mar. 8, 1991, Pat. No. 5,136,830.

[51] **Int. Cl.⁵** **A01D 34/68**[52] **U.S. Cl.** **56/16.7; 56/320.1; 56/DIG. 18; 16/111 A**[58] **Field of Search** **56/16.7, 320.1, 320.2, 56/DIG. 9, DIG. 18, DIG. 20, DIG. 24; 294/15, 26; 16/110 R, 111 A, 111 R; 280/655.1**[56] **References Cited****U.S. PATENT DOCUMENTS**

3,204,272	9/1965	Greene et al.	16/111 A X
3,423,103	1/1969	Maltarp	16/111 A X
3,462,924	8/1969	Price et al.	56/320.1
3,534,432	10/1970	Davies, III et al.	16/111 A
3,855,763	12/1974	Seifert et al.	280/655.1 X

FOREIGN PATENT DOCUMENTS

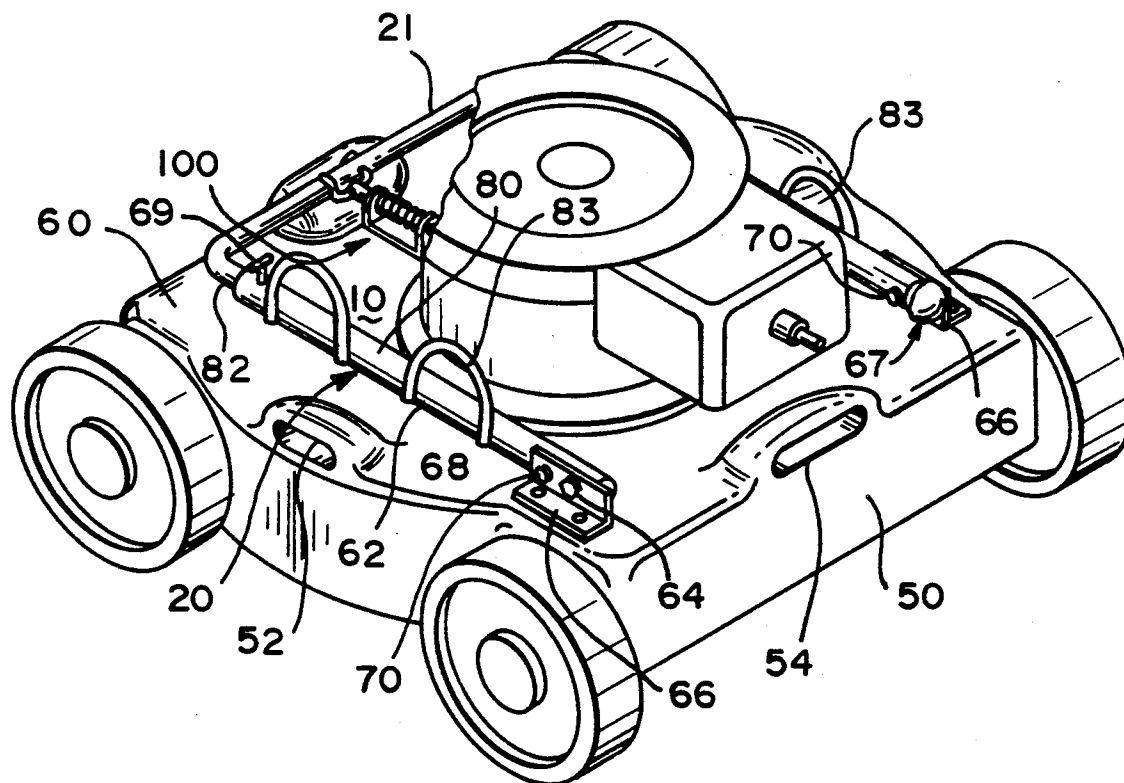
2063635 6/1981 United Kingdom 56/DIG. 18

Primary Examiner—Terry Lee Melius*Attorney, Agent, or Firm*—John K. Donaghy

[57]

ABSTRACT

A rotary lawn mower adapted to be moved over a surface to mow vegetation; said lawn mower includes a mower deck, a motor, rotary cutting means and a push handle assembly; said mower deck including a top portion adapted to support said motor and downwardly extending edge portions; said motor being affixed to the central portion of said mower deck and coupled to drive said rotary cutter means positioned underneath said mower deck substantially parallel to said surface, said push handle assembly having telescoping or pivotal members and being pivotally attached to the deck such that the push handles may be folded over said motor and attached to said mower deck forward of the motor thus permitting a user of said mower to selectively grasp said push handle assembly to lift and move said rotary mower from one location to another.

7 Claims, 5 Drawing Sheets

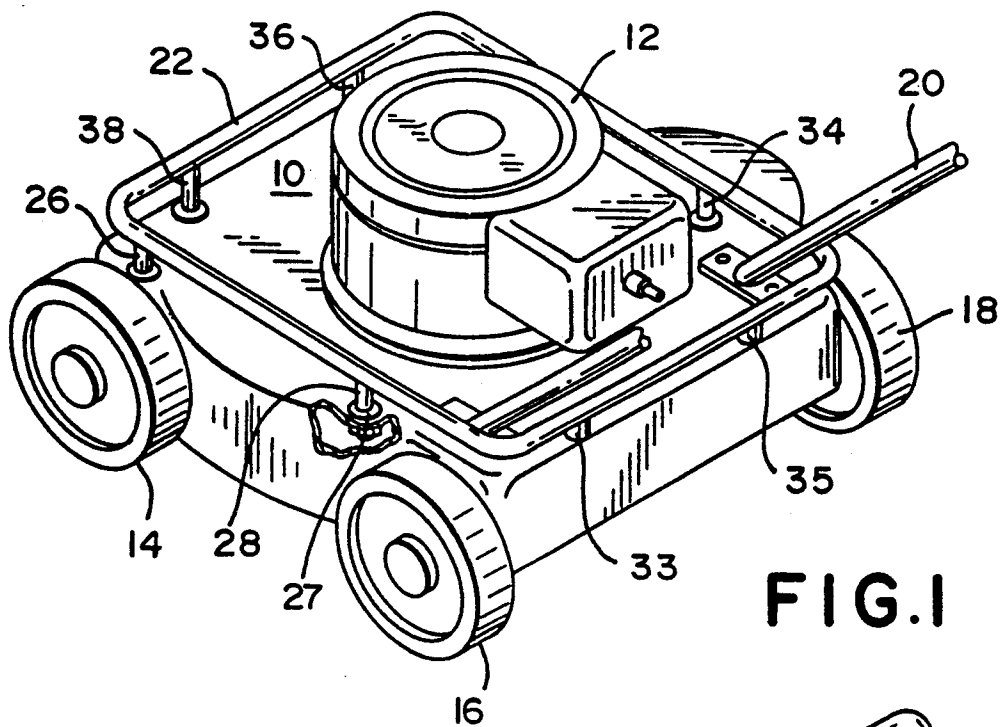


FIG. 1

FIG. 2

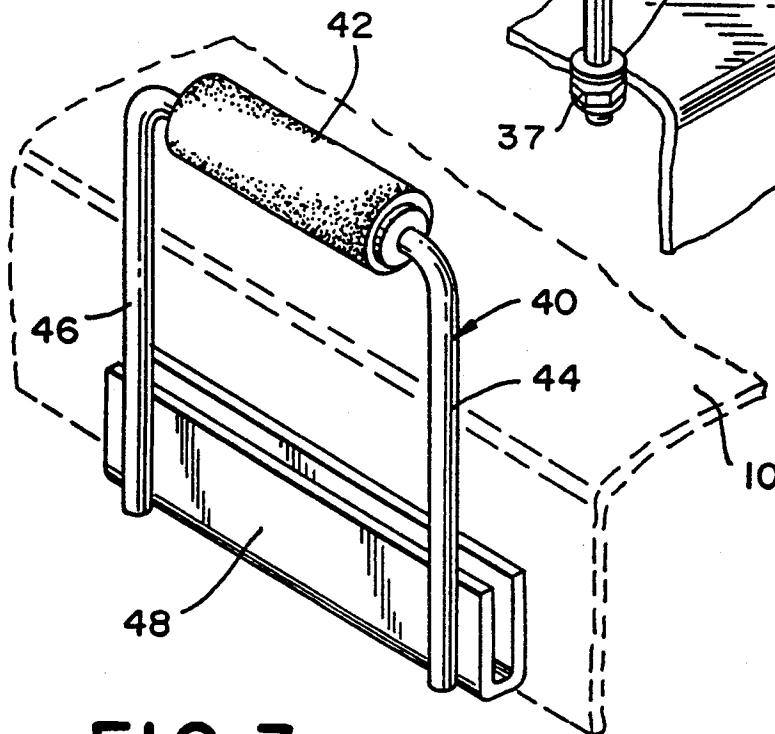
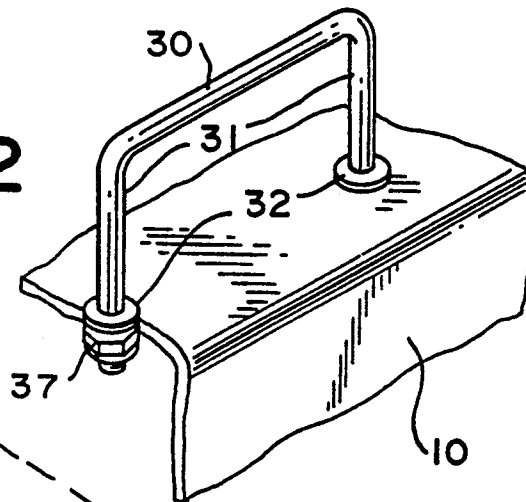
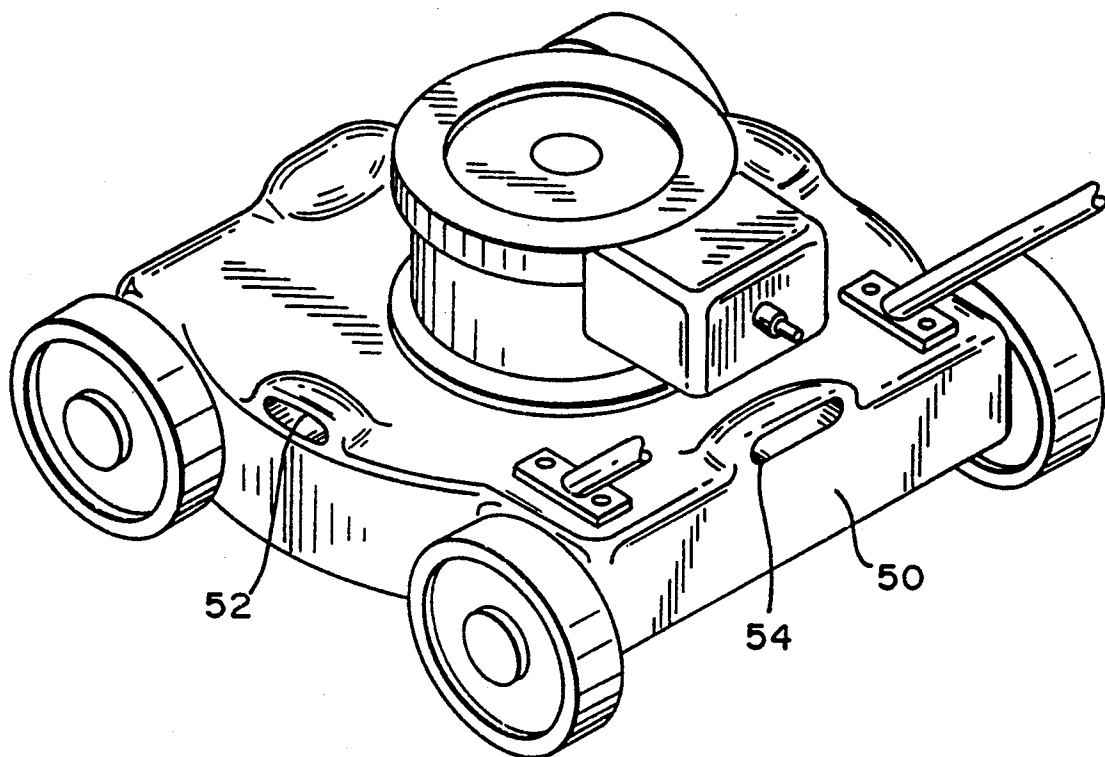


FIG. 3

**FIG. 4**

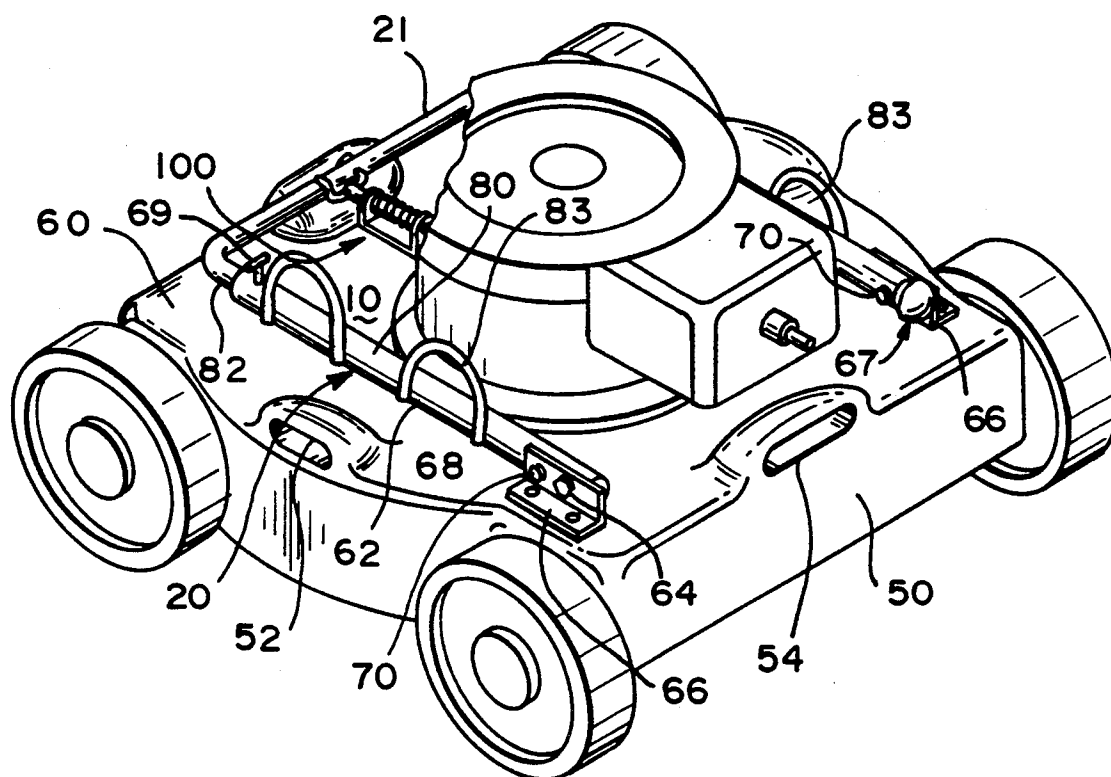
**FIG. 5**

FIG. 7

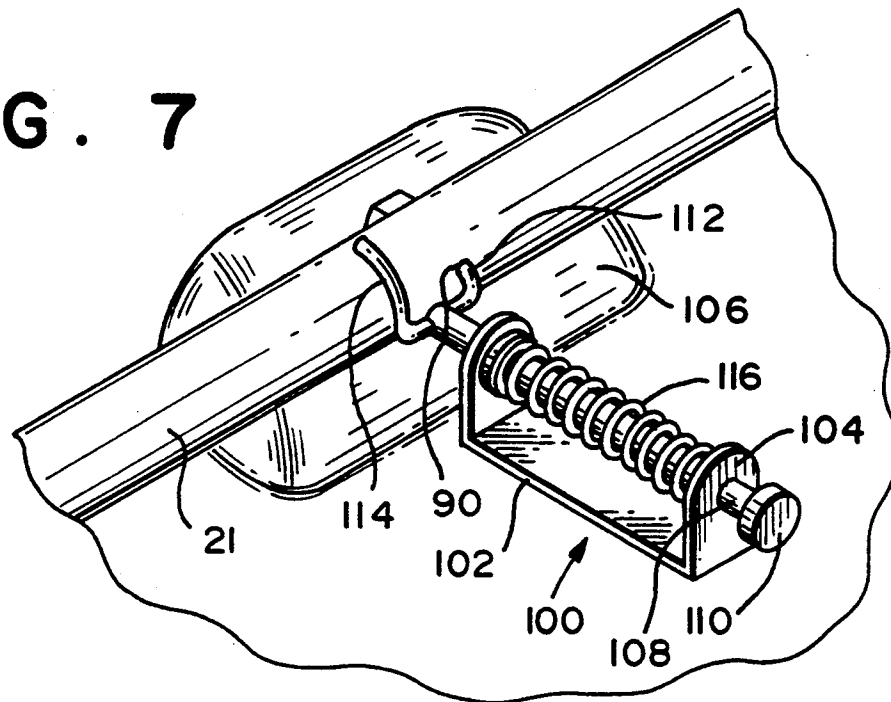
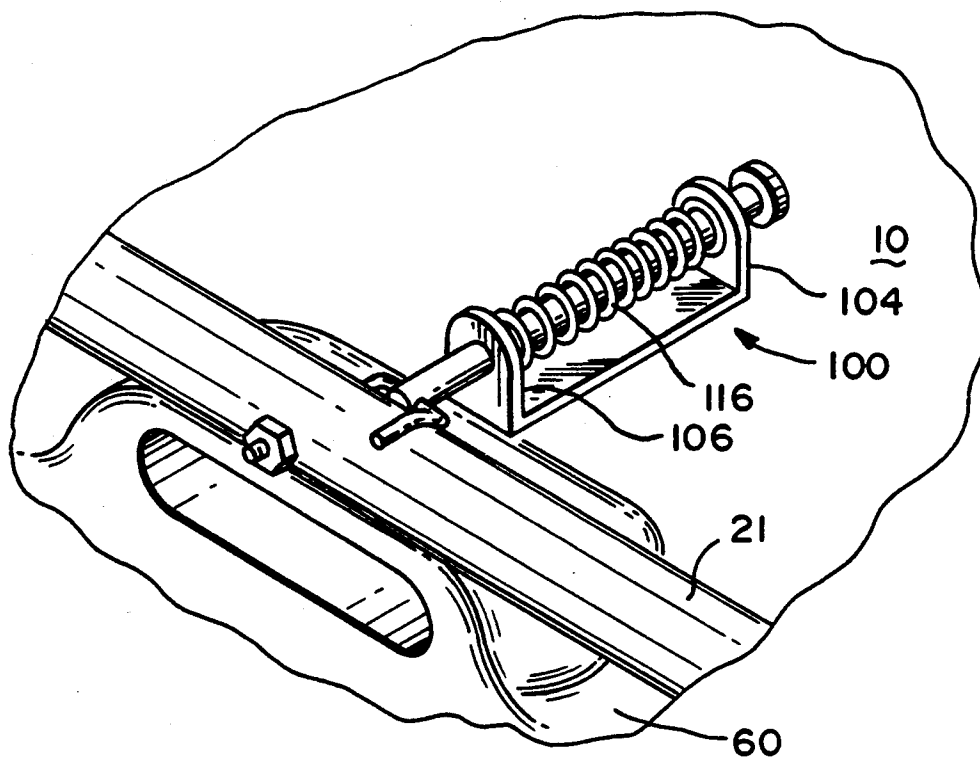
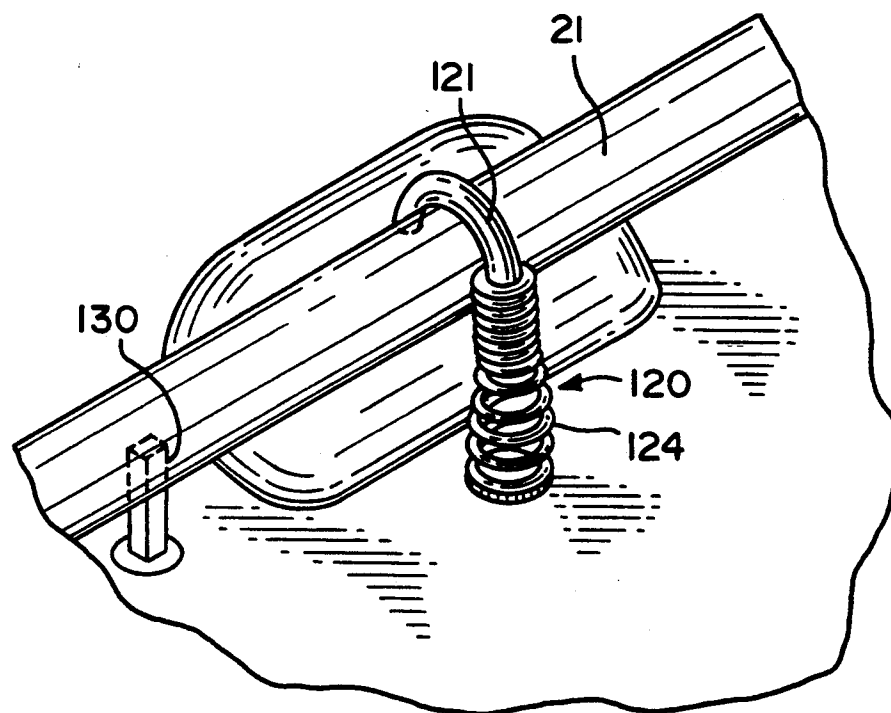


FIG. 6



**FIG. 8**

LAWN MOWERS INCLUDING PUSH HANDLES

This application is a continuation-in-part of Ser. No. 07/666,573 (filed Mar. 8, 1991), now U.S. Pat. No. 5,136,830.

This invention relates to lawn mowers and, more particularly, to rotary lawn mowers including push handles assembly which function as lift handles for the lawn mower.

BACKGROUND OF THE INVENTION

The invention relates to lawn mowers and, more particularly, to rotary lawn mowers including a lift handle assembly affixed to the mower deck.

DESCRIPTION OF THE PRIOR ART

Rotary type lawn mowers are widely used and well known in the prior art. In general, the prior art rotary lawn mowers have included a mower deck having a top surface for supporting the motor. Also the mower deck generally included downwardly extending edges. A cutting blade coupled to the motor shaft rotates between the mower deck and the ground. Wheels were attached to the deck using a variety of techniques. A push handle was generally provided to permit the user to propel the mower along the ground to mow vegetation. Some push handles are foldable so as to provide for easy storage. U.S. Pat. Nos. 3,423,103; 3,462,924; and 3,534,432 show some of these structures. None of these prior art mowers included lift handle means permitting one or more persons to lift the mower to conveniently place the mower in storage or in a vehicle for transportation, for example.

The invention provides a rotary lawn mower including a mower deck, a motor, cutting means and a lift handle assembly. More specifically, the mower deck includes downwardly extending edge portions and a top portion adapted to support the motor. The motor is affixed to the central portion of the mower deck and coupled to drive the rotary cutter positioned underneath the mower deck and substantially parallel to the ground. A lift assembly means is provided which extends above the top surface of the mower deck a convenient distance, permitting one or more persons to conveniently lift the mower to place it in storage or in any other location desired. Alternately, the lift handles may be molded as a part of the mower deck. Further, alternately, the lift handles may be push handles, foldable over the deck and secured to the deck by any means.

DESCRIPTION OF THE DRAWINGS

FIG. 1 is a pictorial drawing illustrating a first embodiment of the invention.

FIG. 2 illustrates an alternate embodiment of the lift handle assembly.

FIG. 3 illustrates a second alternate lift handle assembly.

FIG. 4 illustrates another embodiment of the invention in which the handles are molded as a part of the mower deck.

FIG. 5 is a perspective view of another embodiment of the invention wherein the push handles fold over the mower and are latched to the forward deck.

FIG. 6 is perspective front view of the latching mechanism.

FIG. 7 is a perspective side view of the latching mechanism without the handles.

FIG. 8 is an alternate latching mechanism.

FIG. 1 is a pictorial view of one embodiment of the invention. Generally, the rotary lawn mower includes a mower deck 10 having a substantially flat upper portion and downwardly extending edge portions. A motor 12 is affixed to the top surface of the mower deck 10 with the drive shaft extending vertically and downwardly through the upper flat portion of the mower deck 10. A rotary blade is affixed to the lower end of the drive shaft in a conventional manner. Four wheels with three of the wheels typically illustrated at reference numerals 14, 16 and 18 are affixed to opposite edges of the mower deck. The fourth wheel is not visible in this view. In operation, the operator pushes on a handle 20 to propel the mower along the ground to mow vegetation. Further, detailed illustrations of the wheels is not required because these features are typical of the prior art.

In accordance with the invention, a lift handle assembly including a rail-like handle member 22, is affixed by any suitable means to and positioned above the upper surface of the mower deck 10. In the illustrated embodiment, the rail-like handle member 22 has its ends attached together, extends around the central portion of the mower and has a generally rectangular inner perimeter. Proper balance of the mower requires that the center of mass of the mower be positioned within the inner perimeter of the rail-like member 22. When so designed, the user can grasp the lift handle means 22 along opposed edges of the mower and lift the mower to position it in any convenient location, such as the trunk of an automobile or in a suitable storage location.

More specifically, the lift handle assembly 22 includes an elongated rail-like member 22 having a circular cross-section. A plurality of downwardly extending vertical support portions 26, 28, 33, 35, 34, 36 and 38 are attached to the rail-like member 22. Each of these vertical support portions includes a shoulder 27. Suitable openings are provided in the top portion of the mower deck 10 such that the vertical support portions extend therethrough with the shoulders mating with the upper surface of the mower deck 10. Suitable means, such as a conventional nut, mates with the vertical support portions to hold the lift handle assembly 22 in the desired position with respect to the mower deck 10.

When it is desired to physically move the entire lawn mower from one location to another, the lift handles assembly 22 may be grasped at one or more locations and the mower lifted to move the mower as required. For example, if during the move it is desired to independently control the positions of opposed sides of the mower, the lift handle assembly 22 is grasped at two locations along opposed sides of the mower such that the mower is substantially balanced. Proper balance is assured to the relationship between the rail-like member 22 of the lift handle assembly and the center of mass of the mower described above. Two or more individuals may similarly use the lift handles to move the mower. Also the lift handle assembly may be gripped at a single location and used to move the mower when it is not necessary or desirable to independently control the position of opposed edges of the mower deck 10. That is, when the lift handle assembly is grasped at a single location the mower will tend to rotate around the point at which the lift handle assembly is grasped. Under these circumstances, the degree of rotation will be determined by the weight distribution of the mower.

FIG. 2 illustrates an alternate embodiment of the lift handle assembly. In this embodiment, the lift handle

assembly includes a plurality of generally "U" shaped lift handles each including a substantially straight top portion 30 and two downwardly extending side portions 31. Each of the downwardly extending side portions 31 includes a shoulder collectively illustrated at reference numeral 32. Suitable openings are provided in the mower deck 10 for the side portions of the lift handle means to extend therethrough such that the shoulder 32 mates with the top surface of the mower deck 10. Suitable means, such as a conventional nut 37, are utilized to secure the lift handle 30 in the desired location.

In utilizing this embodiment of the invention, a lift handle of the type illustrated at reference numeral 30 is selectively placed at strategic locations along the upper surface of the mower deck 10 to form the lift handle assembly. That is, the lift handle may be placed along two sides of the mower deck or at any other desired location or locations. The exact location of each of the lift handles comprising the lift handle assembly is selected to maintain the proper balance of the mower as it is lifted using the lift handles.

By so placing the lift handles 30 to form a lift handle assembly, it is obvious that a plurality of these lift handles will collectively function in a substantially identical manner to the embodiment illustrated in FIG. 1 and described above.

FIG. 3 illustrates still another alternate embodiment of the invention. In this embodiment, the lift handle assembly comprises a plurality of lift handles typically illustrated at reference 40. Each of the lift handles includes a substantially flat top portion surrounded by a grip 42. The material for the grip is selected to increase the comfort in using the lift handles. Functionally, the grip 42 may increase the size of the lift handle to increase the comfort of the user. Additionally, the material of the grip may be selected to be soft to further increase the comfort of the user. Other comfort features may also be included.

Additionally, the lift handle 40 also includes two downwardly extending side portions 44 and 46 which are attached using any convenient means to a generally "U" shaped horizontal channel member 48. Horizontal channel member 48 generally extends substantially parallel to the upper portion 42 and is adapted to mate with the downwardly extending edge portions of the mower deck 10 permitting these lift handles to be utilized to conveniently lift the mower. That is, when not in use the lift handles comprising this embodiment of the invention can be removed from the mower deck.

In this embodiment of the invention, a plurality of lift handles 42 is positioned at strategic locations around the mower deck 30. It is obvious that a lift handle assembly so formed functions in a substantially identical manner to the lift handle assembly illustrated in FIG. 1.

FIG. 4 illustrates an alternate embodiment of the invention in which lift handles comprising the lift handle assembly are molded into the mower deck 50. Generally, it is contemplated that the mower deck 50 will be molded of a light material such as aluminum. Suitable lift handles, typically illustrated at reference numerals 52 and 54 are positioned along the edges of the mower deck 50. In FIG. 4 a single lift handle has been illustrated along each edge of the mower deck 50. It is obvious that additional lift may be provided along each of the sides. A plurality of lift handles comprise a lift handle assembly which functions as the lift handle assembly illustrated in FIG. 1.

FIG. 5 shows a lawn mower deck 10 having a forward deck portion 60. The push handles 20 comprise a lower tubular portion 62 pivotally attached by pivot means 64 to brackets 66 mounted on the deck 10. The pivot means may be a ball 67 rotatable in a socket, not shown, in the bracket 66. Suitable locking means 69 such as a spring biased pin to lock the handles in operative push position. Alternatively, the bracket 66 may have a vertical side 68 having latch means 70 permitting the lower tubular portion 62 to be secured in place either in the push position or in a forward collapsed position as shown at 80. The upper hand gripping portion 21 of the handles 20 comprise tubular members 82, one shown, which are telescoped upwardly and inwardly into tubular member 62. By this construction, the upper push handle portion 82 is pushed into lower member 62 thereby shortening the overall length of the push handles attached to the deck 10. When collapsed as shown at 80, the push handle is approximately the length of the deck.

Alternatively, the push handles 20 may be pivoted at the center half sections and folded over the deck. U.S. Pat. No. 3,534,432 shows this arrangement.

The push handles 20 have at least one indentation or handle 83 in each of the portions 62 to serve as hand grips whereby one or two people may grip the handles 83 and lift the lawn mower easily.

The hand grip portion 21, FIGS. 5, 6 and 7, is provided with an aperture 90 to receive a latch member. The forward deck portion 60 has a latching mechanism 100 for securing the grip handle 21 to the deck whereby the handle 20 may be used to lift or carry the lawn mower.

The latching mechanism 100, FIGS. 6 and 7, comprises a base 102 which is fastened to the deck by any suitable means such as by bolts or the like or by welding. The base 102 has upstanding ears 104 and 106 with apertures therein to slidably receive a rod 108 having a bulbous head 110. The rod 108 has an end comprising a finger 112 for insertion into aperture 90 and a finger 114 for engaging over the hand grip portion 21. A spring 116 maintains the rod 108 biased in the forward direction.

It will be apparent that the rod 108 may be pulled back whereby the fingers 112 and 114 disengage from their respective positions whereby the push handles may be lifted and returned to their operative position.

FIG. 8 shows an alternative latching mechanism 120 which comprises a hook portion 121 straddling the hand grip portion 21. The other end of the hook portion has a spring 124 which is attached to the deck 60 by any suitable means. It will be appreciated that the spring 124 is a heavy duty spring so that, when the handles are used to lift the lawn mower, the weight of the mower does not stretch the spring.

Other latch mechanisms 130 such as a bolt extending through the deck and hand grip portion 21 is contemplated as are releasable gates.

What I claim is:

1. A rotary lawn mower adapted to be moved over a surface to mow vegetation; said lawn mower includes a mower deck, a motor, rotary cutting means and a push handle assembly having a hand grip; said mower deck including a top portion adapted to support said motor and downwardly extending edge portions; said motor being affixed to the central portion of said mower deck and coupled to drive rotary cutter means positioned underneath said mower deck and substantially parallel

5

to said surface, said push handle assembly being pivotally secured to said mower deck at one side behind said motor means and adapted to be pivoted forwardly to lie on said mower deck and means, remote from said one side to secure the push handle to the mower deck thus permitting a user of said mower to selectively grasp said push handle assembly to move said rotary mower from one location to another.

2. A rotary lawn mower in accordance with claim 1 wherein: said push handle assembly comprises an upper portion and a lower portion adjustable with respect to each other and folded forwardly to lie on said mower deck and fastened thereto by means thereby permitting a user of said lawn mower to grasp said push handle assembly to lift and move said mower from place to place.

3. A rotary lawn mower in accordance with claim 2 wherein: said upper portion includes a hand grip fastened to the mower deck forward of the mower where the handle assembly lies on the mower deck whereby a user of said lawn mower may grasp the push handle

6

assembly to lift and move the lawn mower from place to place.

4. A rotary lawn mower in accordance with claim 1 wherein: said securing means comprises a latch having a first finger engaging an aperture in the hand grip and a second finger for engaging over the hand grip thereby securing the push handle assembly to the mower deck.

5. A rotary lawn mower in accordance with claim 1 wherein: said securing means comprises a hook for engaging the hand grip at one end and secured to the deck at the other end.

6. A rotary lawn mower in accordance with claim 5, and: spring means on the hook at said other end and secured to the deck at the other end whereby said hook is biased into contact with said hand grip.

7. A rotary lawn mower in accordance with claim 1, and: at least one hand grip on the push handle assembly on opposite sides of said motor whereby said lawn mower may be lifted and moved from one location to another.

* * * * *

25

30

35

40

45

50

55

60

65