

SERVICE AREA MAP LOCATOR

INDEX

The following list shows the cadastral map number, advice letter number and date of filing for all service area maps filed with the California Public Utilities Commission. These maps are under separate cover, and this index is for control and reference purposes.

<u>Map Number</u>	<u>Advice Letter Number</u>	<u>Date of Filing</u>
36	194	December 31, 1986
37	269	April 28, 1994
50	194	December 31, 1986
52	270	May 18, 1994
53	291	September 10, 1997
66	194	December 31, 1986
69	295	October 29, 1997
80	194	December 31, 1986
81	194	December 31, 1986
82	194	December 31, 1986
84	199	June 5, 1987
85	445	December 7, 2012
95	271	December 19, 1994
96	284	March 14, 1997
100	205	December 4, 1987
110	215	December 15, 1988
111	203	August 28, 1987
115	205	December 4, 1987
116	205	December 4, 1987
125	347	April 26, 2004
126	259	October 22, 1993
128	205	December 4, 1987
129	205	December 4, 1987
138	259	October 22, 1993
139	458	March 27, 2014
140	316	June 3, 1999
141	283	January 31, 1997
142	288	July 17, 1997
143	210	June 9, 1988
151	215	December 15, 1988
152	451	August 26, 2013
154	215	December 15, 1988
155	279	August 15, 1996
156	210	June 9, 1988
166	451	September 27, 2013
169	210	June 9, 1988
181	369	August 25, 2006

(T)

(To be inserted by utility)

Issued by

(To be inserted by Cal. P.U.C.)

Advice No. 458

PALLE JENSEN

Date Filed MAR 27 2014

Dec. No. \_\_\_\_\_

Senior Vice President,  
Regulatory Affairs

Effective APR 26 2014

Resolution No. \_\_\_\_\_

TITLE

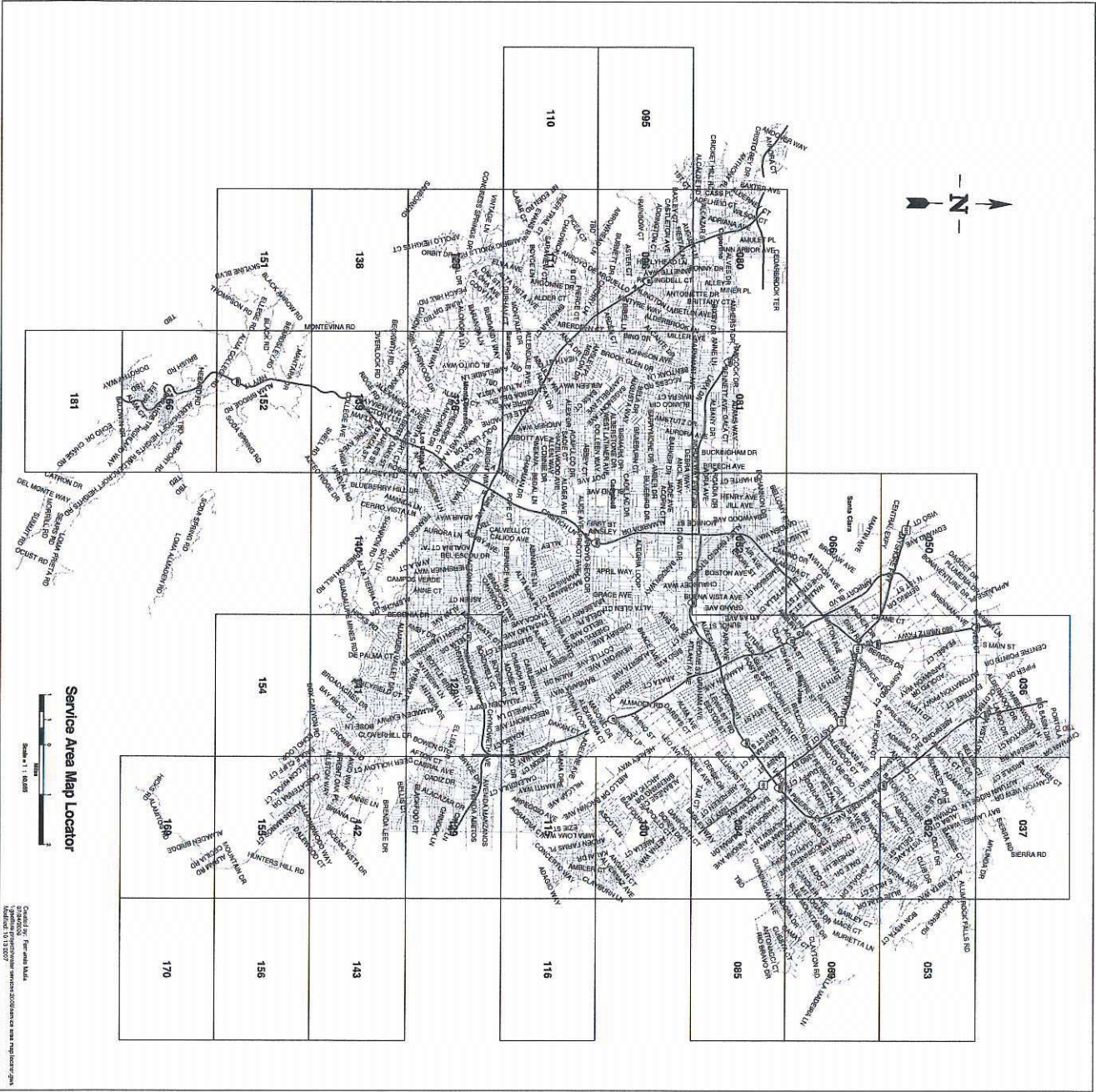

Service Area Map Locator



Copyright © 2008 by the City of San Jose. All rights reserved. This map is a service area map and is not a legal document. For more information, please contact the City of San Jose, Planning Department, 500 Alameda Street, San Jose, CA 95131. Phone: (408) 287-3000. Fax: (408) 287-3001. Email: planning@cityofsanjose.org. Website: www.cityofsanjose.org. Date: 10/13/2007